

STATE CORPORATION COMMISSION OF KANSAS
OIL & GAS CONSERVATION DIVISION
WELL COMPLETION FORM
ACO-1 WELL HISTORY
DESCRIPTION OF WELL AND LEASE

Operator: License # 5208

Name: Mobil Oil Corporation

Address P.O. Box 2173

2319 North Kansas Avenue

City/State/Zip Liberal, KS 67905-2173

Purchaser: N/A

Operator Contact Person: Sharon Cook

Phone (316) 626-1142

Contractor: Name: Catholic Protection Services

License: 31474

Wellsite Geologist: _____

Designate Type of Completion
 New Well Re-Entry Workover

Oil SWD SLOW Temp. Abd.
 Gas ENHR SIGW
 Dry Other (CoCo, USW, Explr, Cathodic, etc)

If Workover:

Operator: _____

Well Name: _____

Comp. Date _____ Old Total Depth _____

Deepening Re-perf. Conv. to Inj/SWD
 Plug Back PBDT
 Commingled Docket No. _____
 Dual Completion Docket No. _____
 Other (SWD or Inj?) Docket No. _____

1/11/95 1/11/95 1/11/95
Spud Date Date Reached TD Completion Date

API NO. 15- 189-21824-00-00 ORIGINAL

County STEVENS

- - E/2 - NE Sec. 11 Twp. 34 Rge. 38 X E

3960 FSL Feet from S/N (circle one) Line of Section

1220 FEL Feet from E/W (circle one) Line of Section

Footages Calculated from Nearest Outside Section Corner:
NE, SE, NW or SW (circle one)

Lease Name CP- GREENWOOD Well # 1

Field Name Hugoton

Producing Formation NA [ANODE REPOSITORY]

Elevation: Ground 3173 KB NA

Total Depth 100 PBDT NA

Amount of Surface Pipe Set and Cemented at None Feet

Multiple Stage Cementing Collar Used? NA Yes NA No

If yes, show depth set NA Feet

If Alternate II completion, cement circulated from NA

feet depth to NA w/ NA sx cmt.

Drilling Fluid Management Plan ALT 3 JPH 10-18-95
(Data must be collected from the Reserve Pit)

Chloride content NA ppm Fluid volume NA bbls

Dewatering method used NA

Location of fluid disposal if hauled offsite: _____

Operator Name NA

Lease Name NA License No. _____

NA Quarter Sec. NA Twp. NA S Rng. NA E/W

County NA Docket No. NA

INSTRUCTIONS: An original and two copies of this form shall be filed with the Kansas Corporation Commission, 200 Colorado Derby Building, Wichita, Kansas 67202, within 120 days of the spud date, recompletion, workover or conversion of a well. Rule 82-3-130, 82-3-106 and 82-3-107 apply. Information on side two of this form will be held confidential for a period of 12 months if requested in writing and submitted with the form (see rule 82-3-107 for confidentiality in excess of 12 months). One copy of all wireline logs and geologist well report shall be attached with this form. ALL CEMENTING TICKETS MUST BE ATTACHED. Submit CP-4 form with all plugged wells. Submit CP-111 form with all temporarily abandoned wells.

All requirements of the statutes, rules and regulations promulgated to regulate the oil and gas industry have been fully complied with and the statements herein are complete and correct to the best of my knowledge.

Signature Sharon A. Cook Sharon A. Cook

Title Regulatory Assistant Date 2-13-95

Subscribed and sworn to before me this 13th day of February, 19 95.

Notary Public Kathleen R. Poulton

Date Commission Expires AUGUST 18, 1998

DEW95097.SAC

NOTARY PUBLIC - State of Kansas
KATHLEEN R. POULTON
My Appt. Exp. 08-18-98

K.C.C. OFFICE USE ONLY
F Letter of Confidentiality Attached
C Wireline Log Received
C Geologist Report Received
Distribution
 KCC SWD/Rep NGPA
 KGS Plug Other
(Specify)

Form ACO-1 (7-91)
STATE CORPORATION COMMISSION

FEB 17 1995
CONSERVATION DIVISION
WICHITA, KANSAS

Operator Name Mobil Oil Corporation Lease Name CP- GREENWOOD Well # 1
 Sec. 11 Twp. 34 Rge. 38 East West
 County STEVENS

INSTRUCTIONS: Show important tops and base of formations penetrated. Detail all cores. Report all drill stem tests giving interval tested, time tool open and closed, flowing and shut-in pressures, whether shut-in pressure reached static level, hydrostatic pressures, bottom hole temperature, fluid recovery, and flow rates if gas to surface during test. Attach extra sheet if more space is needed. Attach copy of log.

Drill Stem Tests Taken Yes No
 (Attach Additional Sheets.)
 Samples Sent to Geological Survey Yes No
 Cores Taken Yes No
 Electric Log Run Yes No
 (Submit Copy.)
 List All E.Logs Run:
 Electric Resistance Log - Attached

Log Sample
 Formation (Top), Depth and Datum
 Name Top Datum

SEE ATTACHED DRILLER'S LOG

CASING RECORD <input type="checkbox"/> New <input type="checkbox"/> Used							
Report all strings set-conductor, surface, intermediate, production, etc.							
Purpose of String	Size Hole Drilled	Size Casing Set (In O.D.)	Weight Lbs./Ft.	Setting Depth	Type of Cement	# Sacks Used	Type and Percent Additives

ADDITIONAL CEMENTING/SQUEEZE RECORD				
Purpose:	Depth Top Bottom	Type of Cement	#Sacks Used	Type and Percent Additives
<input type="checkbox"/> Perforate				
<input type="checkbox"/> Protect Casing				
<input type="checkbox"/> Plug Back TD				
<input checked="" type="checkbox"/> Plug Off Zone	(1) First plug - Bentonite set at 13' - 3' plug.			
	(2) Second plug - Bentonite set at 37' - 35' plug.			

Shots Per Foot	PERFORATION RECORD - Bridge Plugs Set/Type Specify Footage of Each Interval Perforated	Acid, Fracture, Shot, Cement Squeeze Record (Amount and Kind of Material Used)	Depth
First anode set at	90', second anode at 80', third anode at 70'.		

TUBING RECORD		Size	Set At	Packer At	Liner Run	NA <input type="checkbox"/> Yes <input type="checkbox"/> No	
1" PVC vent from TD to 3' above surface.							
Date of First, Resumed Production, SWD or Inj. Installed 1/11/95			Producing Method <input type="checkbox"/> NA <input type="checkbox"/> Flowing <input type="checkbox"/> Pumping <input type="checkbox"/> Gas Lift <input type="checkbox"/> Other (Explain)				
Estimated Production Per 24 Hours	Oil Bbls. NA	Gas Mcf NA	Water Bbls. NA	Gas-Oil Ratio	Gravity		

Disposition of Gas: Vented Sold Used on Lease (If vented, submit ACO-18.)

METHOD OF COMPLETION Open Hole Perf. Dually Comp. Commingled

Production Interval Other (Specify) _____

DATA SHEET

COMPANY MOBILE & P JOB No. 80100370 DATE: 1-11-95
 WELL: GREENWOOD 1 PIPELINE:
 LOCATION: SEC. 11 TWP. 34 RGE. 38 CO. STEVENS STATE KS
 ANODE TYPE: LIDA ONE FT: ROTARY 100 FT: CASING _____ FT.

DEEP GROUND BED LOGGING DATA

DRILL. DEPTH LOG (FT)	ANODE TO STRUCTURE		ANODES		DRILL DEPTH LOG (FT)	ANODE TO STRUCTURE		ANODES	
	EXPLOR OHM	FINAL OHM	NO	TOP DEPTH		EXPLOR OHM	FINAL OHM	NO	TOP DEPTH
5					205				
HOLE PLUG 10				3'-13'	210				
EARTH FILL 15				13'-35'	215				
20					220				
25					225				
HOLE PLUG 30	.210			35'-37'	230				
35	.250				235				
40	.300				240				
45	.290				245				
50	.280				250				
55	.230				255				
60	.270				260				
65	.310				265				
70	.450		3		270				
75	.320				275				
80	.330		2		280				
85	.530				285				
90	.920		1		290				
95					295				
100					300				
105					305				
110					310				
115					315				
120					320				
125					325				
130					330				
135					335				
140					340				
145					345				
150					350				
155					355				
160					360				
165					365				
170					370				
175					375				
180					380				
185					385				
190					390				
195					395				
200					400				

PIT CLOSED 1-11-95 HOLE PLUG SET 1-11-95

GREENWOOD 1 11-34-38 Stevens
3960 PSL 1320FEL
Elec? No Crop none

10-35 Clay
35-45 sand
45-80 Clay
80-100 sand/stone

ORIGINAL

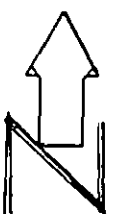

1-11-93
34

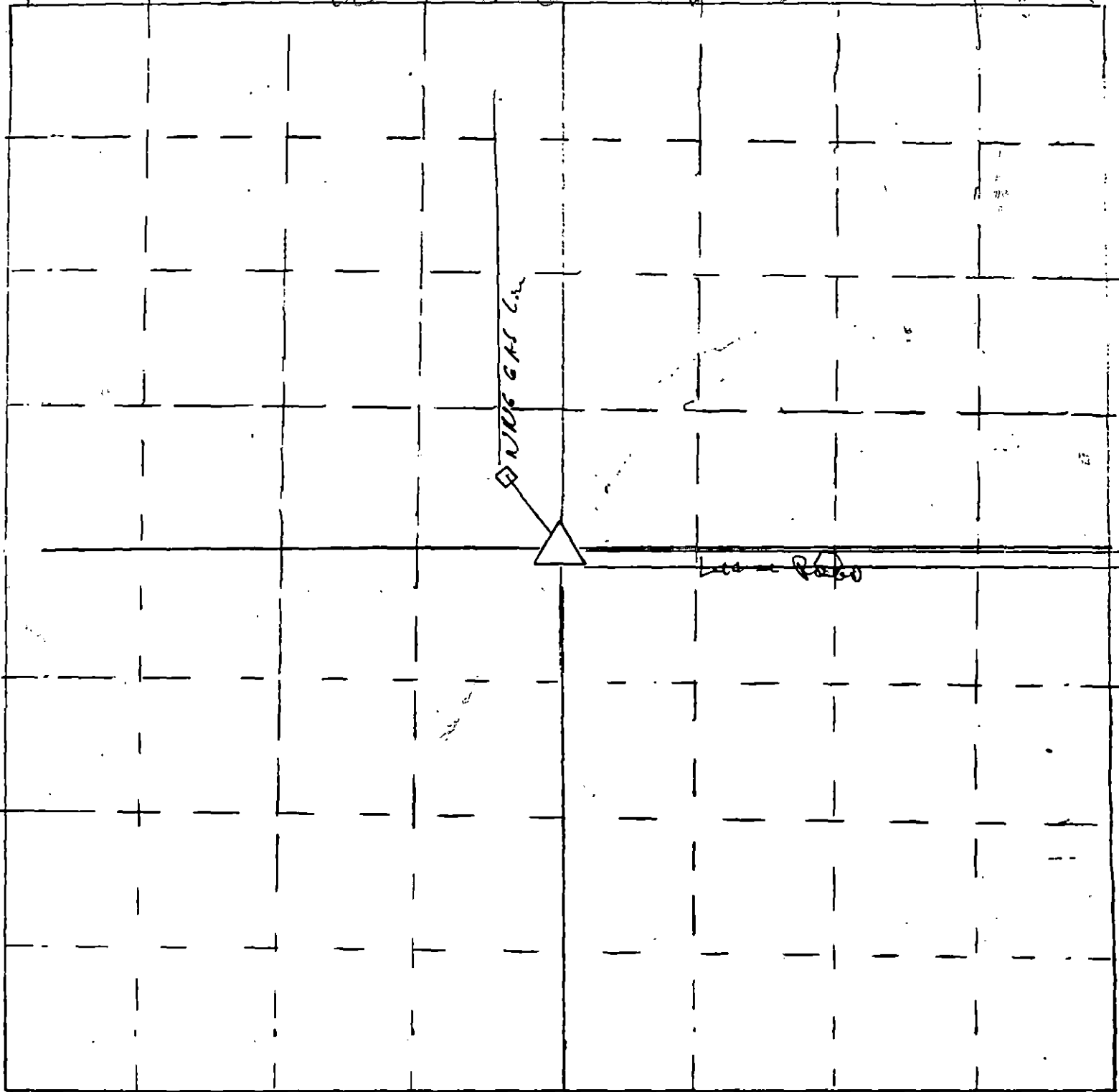

△ = gas well location
◻ = cathodic deep well location

Scale = 1" = 50'
◻ = Meter house