

STATE CORPORATION COMMISSION OF KANSAS  
OIL & GAS CONSERVATION DIVISION  
WELL COMPLETION OR RECOMPLETION FORM  
ACO-1 WELL HISTORY  
DESCRIPTION OF WELL AND LEASE

API NO. 15-189-21,289-00-00  
County.....Stevens  
.....SW ..NW ..NW Sec. 17.. Twp. 34S. Rge. 38.. East  
..... West

Operator: License # 4549  
Name Anadarko Petroleum Corp.  
Address P. O. Box 351  
City/State/Zip Liberal, Kansas 67905-0351

.....4030..... Ft North from Southeast Corner of Section  
.....4880..... Ft West from Southeast Corner of Section  
(Note: Locate well in section plat below)

Purchaser Panhandle Eastern Pipe Line Co.  
(Transporter)

Lease Name.....Taylor "G".....Well #.....1H.....

Operator Contact Person M. L Pease  
Phone (316) 624-6253

Field Name.....Hugoton.....

Producing Formation.....Chase.....

Elevation: Ground.....3263.5.....KB.....NA.....

Contractor: License # 5842  
Name Gabbert-Jones, Inc.

Wellsite Geologist.....NA  
Phone.....

Designate Type of Completion  
 New Well  Re-Entry  Workover  
 Oil  SWD  Temp Abd  
 Gas  Inj  Delayed Comp.  
 Dry  Other (Core, Water Supply etc.)

If OWWO: old well info as follows:  
Operator .....  
Well Name .....  
Comp. Date ..... Old Total Depth.....

RECEIVED  
STATE CORPORATION COMMISSION  
MAR 21 1989  
CONSERVATION DIVISION  
Wichita, Kansas

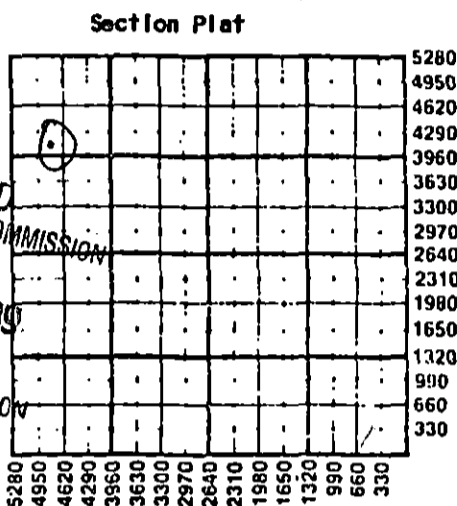

WATER SUPPLY INFORMATION  
Disposition of Produced Water:  Disposal  
Docket # .....  Repressuring

Questions on this portion of the ACO-1 call:  
Water Resources Board (913) 296-3717  
Source of Water:  
Division of Water Resources Permit #.....  
 Groundwater.....Ft North from Southeast Corner  
(Well) .....Ft West from Southeast Corner of  
Sec Twp Rge East West  
 Surface Water.....Ft North from Southeast Corner  
(Stream, pond etc).....Ft West from Southeast Corner  
Sec Twp Rge East West  
 Other (explain)..... Contractor provided water  
(purchased from city, R.W.D. #)

WELL HISTORY  
Drilling Method:  
 Mud Rotary  Air Rotary  Cable  
.....11/26/88.....11/29/88.....  
Spud Date Date Reached TD Completion Date  
.....3025.....3003.....  
Total Depth PBDT  
Amount of Surface Pipe Set and Cemented at 602 feet  
Multiple Stage Cementing Collar Used?  Yes  No  
If yes, show depth set.....feet  
If alternate 2 completion, cement circulated  
from.....feet depth to.....w/.....SX cmt  
Cement Company Name Halliburton Services.....  
Invoice # 730815

INSTRUCTIONS: This form shall be completed in triplicate and filed with the Kansas Corporation Commission, 200 Colorado Derby Building, Wichita, Kansas 67202, within 120 days of the spud date of any well. Rule 82-3-130, 82-3-107 and 82-3-106 apply. Information on side two of this form will be held confidential for a period of 12 months if requested in writing and submitted with the form. See rule 82-3-107 for confidentiality in excess of 12 months. One copy of all wireline logs and drillers time log shall be attached with this form. Submit CP-4 form with all plugged wells. Submit CP-111 form with all temporarily abandoned wells.

All requirements of the statutes, rules and regulations promulgated to regulate the oil and gas industry have been fully complied with and the statements herein are complete and correct to the best of my knowledge.

Signature.....  
M. L Pease  
Title..... Division Production Manager Date.....

Subscribed and sworn to before me this 20th day of March 1989  
Notary Public.....

Date Commission Expires.....

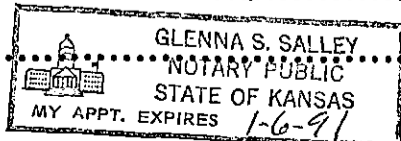

K.C.C. OFFICE USE ONLY  
F  Letter of Confidentiality Attached  
C  Wireline Log Received  
C  Drillers Timelog Received  
Distribution  
 KCC  SWD/Rep  NGPA  
 KGS  Plug  Other  
(Specify)  
3-21-89  
Form ACO-1 (5-86)

Sec. 17 Twp. 34 Rge. 38

Operator Name ..... Anadarko Petroleum Corp. ..... Lease Name..... Taylor "G" ..... Well #..... 1H

Sec..... 17 ..... Twp..... 34S ..... Rge..... 38 .....  East  West ..... County..... Stevens

WELL LOG

INSTRUCTIONS: Show important tops and base of formations penetrated. Detail all cores. Report all drill stem tests giving interval tested, time tool open and closed, flowing and shut-in pressures, whether shut-in pressure reached static level, hydrostatic pressures, bottom hole temperature, fluid recovery, and flow rates if gas to surface during test. Attach extra sheet if more space is needed. Attach copy of log.

Drill Stem Tests Taken  Yes  No  
 Samples Sent to Geological Survey  Yes  No  
 Cores Taken  Yes  No

Formation Description  
 Log  Sample

Name	Top	Bottom
Sand, Clay	0'	475'
Redbed	475	1275
Glorietta Sand	1275	1445
Redbed	1445	2435
Lime, Shale	2435	2980
Lime	2980	3025
TD		3025

MINERAL RIGHTS  
 STATE OF OKLAHOMA  
 COUNTY OF STEVENS  
 TOWNSHIP 34S  
 RANGE 38E  
 SECTION 17

CASING RECORD  Now  Used  
 Report all strings set-conductor, surface, intermediate, production, etc.

Purpose of String	Size Hole Drilled	Size Casing Set (in O.D.)	Weight Lbs/Ft.	Setting Depth	Type of Cement	#Sacks Used	Type and Percent Additives
Surface	12-1/4"	8-5/8"	24.0	602	Pozmix & Common	345	3% CC
Production	7-7/8"	5-1/2"	14.0	3025	Class C	255	10% DCD, 20% DCD

Shots Per Foot	Specify Footage of Each Interval Perforated	Acid, Fracture, Shot, Cement Squeeze Record (Amount and Kind of Material Used)	Depth
.....	.....	.....	.....
.....	.....	.....	.....
.....	.....	.....	.....
.....	.....	.....	.....

TUBING RECORD Size Set At Packer at Liner Run  Yes  No

Date of First Production Producing Method  
 Flowing  Pumping  Gas Lift  Other (explain).....

Estimated Production Per 24 Hours	Oil Bbls	Gas MCF	Water Bbls	Gas-Oil Ratio CFPB	Gravity
.....	.....	.....	.....	.....	.....

METHOD OF COMPLETION

Production Interval

Disposition of gas:  Vented  Open Hole  Perforation Delayed  
 Sold  Other (Specify) .....  
 Used on Lease  Dually Completed .....  
 Commingled .....

# HALLIBURTON SERVICES

P.O. BOX 651046  
DALLAS, TX 75265

INVOICE

A Halliburton Company

INVOICE NO.	DATE
730815	11/26/1988

WELL LEASE NO./PLANT NAME		WELL/PLANT LOCATION		STATE	WELL/PLANT OWNER
TAYLOR G-1H		STEVENS		KS	SAME
SERVICE LOCATION		CONTRACTOR	JOB PURPOSE		TICKET DATE
LIBERAL		GABBERT & JONES #9	CEMENT SURFACE CASING		11/26/1988
ACCT. NO.	CUSTOMER AGENT	VENDOR NO.	CUSTOMER P.O. NUMBER	SHIPPED VIA	FILE NO.
019595	DAVID GILMORE		33876	COMPANY TRUCK	68452

RECEIVED  
STATE CORPORATION COMMISSION

ANADARKO PETROLEUM CORP  
P. O. BOX 351  
LIBERAL, KS 67905-0351

DIRECT CORRESPONDENCE TO:  
SUITE 600  
COLORADO DERBY BUILDING  
WICHITA, KS 67202-0000

CONSERVATION DIVISION  
Wichita Kansas

PRICE REF. NO.	DESCRIPTION	QUANTITY	U/M	UNIT PRICE	AMOUNT
000-117	MILEAGE	12	MI	2.20	26.40
		1	UNT		
001-016	CEMENTING CASING PUMP CHARGE	611	FT	519.40	519.40
		1	UNT		
030-018	TYPE 5W, PLASTIC TOP PLUG	8 5/8	IN	82.00	82.00 *
		1	EA		
504-043	PREMIUM CEMENT	146	SK	6.85	1,000.10 *
506-105	POZMIX A	49	SK	3.91	191.59 *
504-043	PREMIUM CEMENT	150	SK	6.85	1,027.50 *
507-210	FLOCELE	86	LB	1.21	104.06 *
509-406	ANHYDROUS CALCIUM CHLORIDE	7	SK	25.75	180.25 *
500-207	BULK SERVICE CHARGE	359	CFT	.95	341.05 *
500-306	MILEAGE	192.612	TMI	.70	134.83 *
INVOICE SUBTOTAL					3,607.18
DISCOUNT-(BID)					685.31-
INVOICE BID AMOUNT					2,921.87
*-KANSAS STATE SALES TAX					99.19
*-SEWARD COUNTY SALES TAX					24.78
INVOICE TOTAL - PLEASE PAY THIS AMOUNT					\$3,045.84

4447-2041  
16128

LIBERAL OPERATIONS RECEIVED  
DEC 03 1988

OPERATIONS

RECEIVED  
STATE CORPORATION COMMISSION  
MAR 21 1989  
CONSERVATION DIVISION  
Wichita, Kansas

TERMS INVOICES PAYABLE NET BY THE 20TH OF THE FOLLOWING MONTH AFTER DATE OF INVOICE. UPON CUSTOMER'S DEFAULT IN PAYMENT OF CUSTOMER'S ACCOUNT BY THE LAST DAY OF THE MONTH FOLLOWING THE MONTH IN WHICH THE INVOICE IS DATED, CUSTOMER AGREES TO PAY INTEREST THEREON AFTER DEFAULT AT THE HIGHEST LAWFUL CONTRACT RATE APPLICABLE BUT NEVER TO EXCEED 18% PER ANNUM. IN THE EVENT IT BECOMES NECESSARY TO EMPLOY AN ATTORNEY TO ENFORCE COLLECTION OF SAID ACCOUNT, CUSTOMER AGREES TO PAY ALL COLLECTION COSTS AND ATTORNEY FEES IN THE AMOUNT OF 20% OF THE AMOUNT OF THE UNPAID ACCOUNT.

GABBERT-JONES  
DRILLERS WELL LOG

TAYLOR "G" 1H  
SEC. 17-34S-38W  
STEVENS COUNTY, KANSAS

Commenced: 11-26-88  
Completed: 11-29-88  
Operator: ANADARKO PETROLEUM CORP.

Depth		Formation	Remarks
From	To		
0	475	Sand - Clay	Ran 14 jts of 24# 8 5/8"
475	1275	Redbed	LD @ 602' w/195 sks 25/75
1275	1445	Glorita Sand	Posmix - 2% CC - 1/4# FS
1445	2435	Redbed	150 sks Common - 3% CC
2435	2980	Lime - Shale	1/4# FS
2980	3025	Lime	PD @ 5:45 PM 11-26-88
	3025 TD		Ran 74 jts of 14# 5 1/2" csg
			LD @ 3025' w/215 sks
			Class C - 20% DCD - 2% CC
			1/4# CF - 40 sks Class C
			10% DCD - 2% CC - 1/4# CF
			PD @ 6:30 AM 11-29-88
			RR @ 7:30 AM 11-29-88

RECEIVED  
STATE CORPORATION COMMISSION

MAR 21 1989

CONSERVATION DIVISION  
Wichita, Kansas

State of Kansas  
County of Sedgwick

) I, the undersigned, being duly sworn on oath, state  
) that the above Drillers Well Log is true and correct  
) to the best of my knowledge and belief and according  
) to the records of this office.

GABBERT-JONES, INC.

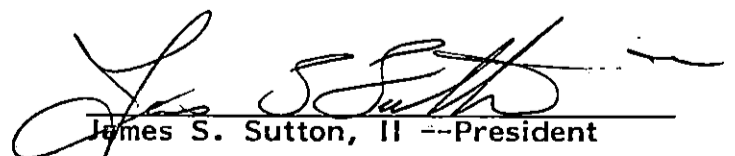
  
James S. Sutton, II -- President

Subscribed & sworn to before me this  
6th day of DECEMBER 1988

  
Lola Lenore Costa

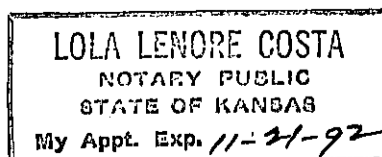

My Commission expires Nov. 21, 1992