

STATE CORPORATION COMMISSION OF KANSAS
OIL & GAS CONSERVATION DIVISION

WELL COMPLETION OR RECOMPLETION FORM
ACO-1 WELL HISTORY

DESCRIPTION OF WELL AND LEASE

Operator: license # 5447
name Cities Service Oil & Gas Corp.
address 3545 NW 58th Street
City/State/Zip Oklahoma City, OK 73112

Operator Contact Person Raymond Hui
Phone (405) 949-4400

Contractor: license # 5141
name Zenith Drilling Corp.

Wellsite Geologist Calvin Clay
Phone (405) 949-4400

Purchaser: Citgo Petroleum Corp.

Designate Type of Completion

New Well Re-Entry Workover

Oil SWD Temp Abd
 Gas Inj Delayed Comp.
 Dry Other (Core, Water Supply etc.)

OWWO: old well info as follows:

Operator
Well Name
Comp. Date Old Total Depth

WELL HISTORY

Drilling Method: Mud Rotary Air Rotary Cable

10-12-84 10-26-84 12-4-84
Start Date Date Reached TD Completion Date
6650' 6590'
Total Depth PBTD

Amount of Surface Pipe Set and Cemented at 1759' KB feet

Multiple Stage Cementing Collar Used? Yes No

If Yes, Show Depth Set feet

Alternate 2 completion, cement circulated
from feet depth to w/ SX cmt

RECEIVED
STATE CORPORATION COMMISSION

JAN 08 1985

INSTRUCTIONS: This form shall be completed in duplicate and filed with the Kansas Corporation Commission, 200 Colorado Derby Building, Wichita, Kansas 67202, within 90 days after completion or recompletion of any well. Rules 82-3-130 and 82-3-107 apply.

Information on side two of this form will be held confidential for a period of 12 months if requested in writing and submitted with the form. See rule 82-3-107 for confidentiality in excess of 12 months.

One copy of all wireline logs and drillers time log shall be attached with this form. Submit CP-4 form with all plugged wells. Submit CP-111 form with all temporarily abandoned wells.

If requirements of the statutes, rules, and regulations promulgated to regulate the oil and gas industry have been fully complied with and the statements herein are complete and correct to the best of my knowledge.

Signature D.G. Oliver
Title Engineering Manager Date 1-7-85

Subscribed and sworn to before me this 7th day of January 19 85.

Notary Public
Notary Commission Expires 6-17-88

API NO. 15-189-20778-00-00

County Stevens

C SE SE NW Sec 25 Twp 34 Rge 35 XXW

(location) 2310' FNL, 2310' FWL

2970 Ft North from Southeast Corner of Sect

2970 Ft West from Southeast Corner of Sect

(Note: locate well in section plat below)

Lease Name Grant B Well# 1

Field Name Kinney Lower Chester

Producing Formation Lower Chester

Elevation: Ground 2958' KB

DF: 2967'

attributable acreage outlined

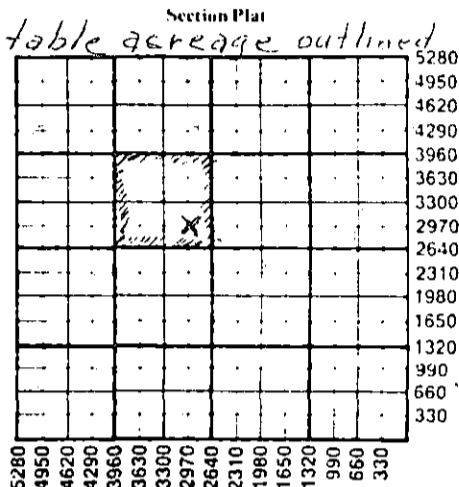

WATER SUPPLY INFORMATION

Source of Water:

Division of Water Resources Permit # T84-219

Groundwater 3475 Ft North From Southeast Corner (Well) 835 Ft West From Southeast Corner Sec 25 Twp 34 Rge 35 East West

Surface Water Ft North From Southeast Corner (Stream, Pond etc.) Ft West From Southeast Corner Sec Twp Rge East West

Other (explain)

(purchased from city, R.W.D.#)

Disposition of Produced Water: Disposal Repressuring
Green D #2 SWD

Docket # 57710

K.C.C. OFFICE USE ONLY
 Letter of Confidentiality Attached
 Wireline Log Received
 Drillers Timelog Received
Distribution
 KCC SWD/Rep NGPA
 KGS Plug Other (Specify)

Form ACO-1
(This form supercedes
previous forms
ACO-1 & C-10)

Operator Name Cities Service Oil & Gas Corp Lease Name Grant B Well# 1 SEC. 25 TWP. 34S RGE. 35 East West

WELL LOG

INSTRUCTIONS: Show important tops and base of formations penetrated. Detail all cores. Report all drill stem tests giving interval tested, time tool open and closed, flowing and shut-in pressures, whether shut-in pressure reached static level, hydrostatic pressures, bottom hole temperature, fluid recovery, and flow rates if gas to surface during test. Attach extra sheet if more space is needed. Attach copy of log.

Drill Stem Tests Taken Yes No
 Samples Sent to Geological Survey Yes No
 Cores Taken Yes No

Electric Logs: (Dresser Atlas)
 DIL-SFL w/GR & SP, CNL-FDC
 w/GR & Caliper, Microlog
 w/GR.

Name	Formation Description	
	Top	Bottom
Sand	0	40'
Sand & Red Bed	40	430'
Anhydrite	430	1055'
Red Bed & Glorietta	1055	1415'
Red Bed & Anhydrite	1415	1760'
Anhydrite	1760	2945'
Anhydrite & Dolomite	2945	3135'
Dolomite	3135	3680'
Lime & Shale	3680	6650'

RELEASED

JUN 05 1986

FROM CONFIDENTIAL

CASING RECORD <input checked="" type="checkbox"/> new <input type="checkbox"/> used							
Report all strings set - conductor, surface, intermediate, production, etc.							
Purpose of string	size hole drilled	size casing set (in O.D.)	weight lbs/ft.	setting depth	type of cement	# sacks used	type and percent additives
Surface	12-1/4"	8-5/8"	24#	1759' KB	65/35 Poz. Class "H"	650	2% CaCl ₂ 1/2# floc
Production	7-7/8"	5-1/2"	15.5 14	6630' KB	50/50 Poz.	175	1/2# floc 3% CaCl ₂ 18% salt, 1/2# f. 8% CFR-2
PERFORATION RECORD				Acid, Fracture, Shot, Cement Squeeze Record			
shots per foot	specify footage of each interval perforated			(amount and kind of material used)			Depth
2	6559-69' Lower Chester			1000 gals. diesel oil w/I-5			6559-69'
2	6512-42' Lower Chester			3000 gals. diesel oil w/I-5			6512-42'
				Frac. trtd. w/38,000 gals. gelled diesel & 42,000 # 20/40 sand & 24,500# 10/20 sand			6512-69'
							6512-69'
TUBING RECORD				Liner Run <input type="checkbox"/> Yes <input checked="" type="checkbox"/> No			
Date of First Production		Producing method					
12-3-84		<input type="checkbox"/> flowing <input checked="" type="checkbox"/> pumping <input type="checkbox"/> gas lift <input type="checkbox"/> Other (explain)					
Estimated Production Per 24 Hours	Oil	Gas	Water	Gas-Oil Ratio		Gravity	
	130 Bbls	211 MCF	1 Bbls	1623 CFPB		40	

Disposition of gas: vented sold used on lease

METHOD OF COMPLETION: open hole perforation other (specify) _____

PRODUCTION INTERVAL: 6512-42 & 6559-69' Lower Chester

Dually Completed. Commingled