

STATE CORPORATION COMMISSION OF KANSAS
OIL & GAS CONSERVATION DIVISION
WELL COMPLETION OR RECOMPLETION FORM
ACO-1 WELL HISTORY
DESCRIPTION OF WELL AND LEASE

Operator: License # 09736
Name: Dorchester Hugoton, Ltd.
Address: 9696 Skillman Street
Suite 320-LB42
City/State/Zip: Dallas, Texas 75243-8200

Purchaser: Gastrak Corp.

Operator Contact Person: Howard C. Wadsworth
Phone: (214) 739-2002

Contractor: License # 03363
Name: Service Drilling Co.
Box 5320, Borger, TX 79007

Wellsite Geologist: John Dannelley
Phone: (806) 353-2161

Designate Type of Completion
 New Well Re-Entry Workover
 Oil SWD Temp Abd
 Gas Inj Delayed Comp
 Dry Other (Core, Water Supply etc.)

If ~~OWD~~ old well info as follows:
Operator
Well Name
Comp. Date
Old Total Depth

WELL HISTORY

Drilling Method: Mud Rotary Air Rotary Cable
8/7/89 8/11/89 9/29/89
Spud Date Date Reached TD Completion Date
2950 2901
Total Depth PBSD

Amount of Surface Pipe Set and Cemented at 623 feet
Multiple Stage Cementing Collar Used? Yes No
If yes, show depth set
If alternate 2 completion, cement circulated from feet depth to w/ SX cmt
Cement Company Name
Invoice #

API NO. 15-189-21,355-00-00-1-5-1991

County: Stevens
NW/4 SE/4 SE/4 Sec. 35 Twp. 34 Rge. 39 East West

1250 Ft North from Southeast Corner of Section
1250 Ft West from Southeast Corner of Section
(Note: Locate well in section plat below)

Lease Name: Rawlings Well #: I-2

Field Name: Hugoton

Producing Formation: Chase

Elevation: Ground 3286.10 KB 3295.6

Section Plat

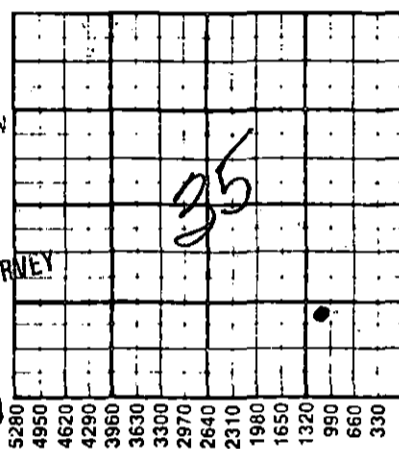

RECEIVED
DEC 4 - 1989
CONSERVATION DIVISION
Wichita, Kansas
KANSAS GEOLOGICAL SURVEY
WICHITA BRANCH

DEC 07 1989

WATER SUPPLY INFORMATION

Disposition of Produced Water: Disposal
Docket # Repressuring

Questions on this portion of the ACO-1 call:
Water Resources Board (913) 296-3717

Source of Water:
Division of Water Resources Permit #

Groundwater: Ft North from Southeast Corner (Well) Ft West from Southeast Corner of Sec Twp Rge East West

Surface Water: Ft North from Southeast Corner (Stream, pond etc.) Ft West from Southeast Corner Sec Twp Rge East West

Other (explain) ..Furnished by Drilling Contractor (purchased from city, R.W.D. #)

INSTRUCTIONS: This form shall be completed in triplicate and filed with the Kansas Corporation Commission, 200 Colorado Derby Building, Wichita, Kansas 67202, within 120 days of the spud date of any well. Rule 82-3-130, 82-3-107 and 82-3-106 apply. Information on side two of this form will be held confidential for a period of 12 months if requested in writing and submitted with the form. See rule 82-3-107 for confidentiality in excess of 12 months. One copy of all wireline logs and drillers time log shall be attached with this form. Submit CP-4 form with all plugged wells. Submit CP-111 form with all temporarily abandoned wells.

All requirements of the statutes, rules and regulations promulgated to regulate the oil and gas industry have been fully complied with and the statements herein are complete and correct to the best of my knowledge.

Signature: *Jimmy L. Both*
Title: Land and Lease Administrator Date: 11/30/89

Subscribed and sworn to before me this 30th day of November 1989.
Notary Public: *Martha Gardner*
Date Commission Expires: 7/11/93

K.C.C. OFFICE USE ONLY
 Letter of Confidentiality Attached
 Wireline Log Received
 Drillers Timelog Received
Distribution
 KCC SWD/Rep NGPA
 KGS Plug Other (Specify)

Operator Name Dorchester Hugoton, Ltd. Lease Name Rawlings Well # I-2

Sec. 35 Twp. 34S Rge. 39 East West County Stevens **RELEASED**

JAN 15 1991

WELL LOG

FROM CONFIDENTIAL

INSTRUCTIONS: Show important tops and base of formations penetrated. Detail all cores. Report all drill stem tests giving interval tested, time tool open and closed, flowing and shut-in pressures, whether shut-in pressure reached static level, hydrostatic pressures, bottom hole temperature, fluid recovery, and flow rates if gas to surface during test. Attach extra sheet if more space is needed. Attach copy of log.

Drill Stem Tests Taken Yes No
 Samples Sent to Geological Survey Yes No
 Cores Taken Yes No

Formation Description
 Log Sample

Name	Top	Bottom
Herrington	2624	2654
Krider	2654	2724
Winfield	2724	2750
U. Ft. Riley	2770	2804
L. Ft. Riley	2828	2928

CASING RECORD <input checked="" type="checkbox"/> New <input type="checkbox"/> Used Report all strings set-conductor, surface, intermediate, production, etc.							
Purpose of String	Size Hole Drilled	Size Casing Set (In O.D.)	Weight Lbs/Ft.	Setting Depth	Type of Cement	#Sacks Used	Type and Percent Additives
Surface	12 1/4"	8 5/8"	24	623	"C&H"	300	2% CaCl ₂
Production	7 7/8"	5 1/2"	14	2948	"C&H"	425	5% KCL
PERFORATION RECORD				Acid, Fracture, Shot, Cement Squeeze Record			
Shots Per Foot	Specify Footage of Each Interval Perforated			(Amount and Kind of Material Used)		Depth	
2	2830 - 50; 2772 - 2800;			2250 Gal Acid 30,000 Gal		2830-50	
	2726 - 2740; 2708 - 2716;			70% N2W/24000# 20/40 SD			
	2663 - 2687; 2626 - 2632			8050 Gal Acid - 100,000 Gal		2626 - 2800	
				Cross Link GW W/187,500#		12-20 SD	
TUBING RECORD		Size	Set At	Packer at	Liner Run	<input type="checkbox"/> Yes <input type="checkbox"/> No	
Date of First Production		Producing Method					
SI W/O PL		<input checked="" type="checkbox"/> Flowing <input type="checkbox"/> Pumping <input type="checkbox"/> Gas Lift <input type="checkbox"/> Other (explain).....					
Estimated Production Per 24 Hours		Oil	Gas	Water	Gas-Oil Ratio	Gravity	
➔		Bbls	500 MCF	Bbls	CFPB		

METHOD OF COMPLETION

Production Interval

Disposition of gas: Vented Open Hole Perforation
 Sold Other (Specify)
 Used on Lease Dually Completed Conmingled

2626-2850
 RELEASED

ORIGINAL

RELEASED

DORCHESTER HUGOTON, LTD.
DRILLING PROGNOSIS
RAWLINGS NO. I-2

JAN 15 1991

FROM CONFIDENTIAL

Location: SE/4 Section 35-T34S-R39W, Stevens County, KS

Drilling Contractor: Service Drilling, Inc.

Ph: (806) 273-7573

Mud: M-I Drilling Fluids Company

Ph: (316) 624-0122

Cementing: Halliburton Services

Ph: (316) 624-3879

Logging: Halliburton Logging Services, Inc.

Ph: (316) 624-8123

Drill & Set 8-5/8" OD Surface Casing

1. Drill 12-1/4" Hole to 610' +/- -- Spud Mud: 9.0 - 9.4 MW; 30-34 Vis
 - a. Slope Test @ 300' +/- & TD -- Max Deviation 1 degree
 - b. Samples: 550' - TD -- Save 30' Samples
2. Run 8-5/8" OD 24# J-55 ST&C Casing W/regular guide shoe & IFV W/Auto Fill Assy. in first collar. Torque 2400 Ft-Lb +/-.
 - a. Howco Weld-A GS & First Collar
 - b. Install 3 centralizers: 10' Above GS, 2nd, & 4th collars
 - c. Circulate w/8-5/8" on bottom
3. Set 8-5/8" 1' below GL and Cement to Surface using 200 SXS Halliburton Light Premium Plus and tail-in w/100 SXS Premium Plus. Both blends to contain 2% CACL2 and 1/4#/SX Flocele.
 - a. Run top wooden plug only -- OK to wash up on plug
 - b. WOC 12 hours

Drill & Set 5-1/2" OD Production Casing

1. Drill 7-7/8" hole to 3100' +/- TD
 - a. Slope test @ 700' +/- intervals -- max deviation 2 degrees @ TD and 1 degree between surveys
 - b. Mud Properties

650'-1200'	Native Mud	8.6-9.0 MW; 26-30 Vis
1200'-1400'	Low Solids	8.5-9.1 MW; 34-38 Vis CS Hulls & Paper
1400'-2500'	Low Solids	9.0-9.2 MW; 30-34 Vis CS Hulls
2500'-TD	Low Solids	9.0-9.2 MW; 38-42 Vis 12-10 CC WL CS Hulls

RECEIVED
STATE CORPORATION COMMISSION

DEC 4 - 1989

CONSERVATION DIVISION
Wichita, Kansas

ORIGINAL

RELEASED

JAN 15 1991

FROM CONFIDENTIAL

- c. L.C. in Glorietta Sand - 1200' - 1400'
Limit drilling rate to 45 Sec. to 1 Min/Ft &
pump rate to 150 FPM +/- around drill collars. Use
8-10#/BB1 CS hulls and paper to prevent L.C.
- d. Samples: 1700'-2600' Save 30' Samples
2600' - TD Save 10' Samples
2. Drilling Time: Geolograph 0'-TD
3. Logging: Run DIL, CNDL/GR Caliper - detail 500'
Note: Make 10-15 stand short trip for logging --
Circ 30-45 min, Pull to 1600 +/- and Circulate
30-45 min before TOH for logs.
4. Run 5-1/2" OD 14# J-55 ST&C Casing w/GS, IFV w/Auto Fill
assy. in first collar. Torque 1700 Ft-Lb +/-.
Note: Repeat circulating procedure in step 3 above
before TOH to run production casing.
 - a. Install 8 centralizers: 10' above GS, 2nd, 4th, 6th
8th, 10th, 12th, & 14th collars.
 - b. Install 20 cable type wall cleaners -- space 15'
apart through zone of interest.
 - c. Circulate w/5-1/2" on bottom -- reciprocate casing
on 20' stroke for free pipe on bottom and during
cementing before plug is bumped.
 - d. Set and cement 1' off bottom using 200 SXS
Halliburton Light Premium Plus w/1/4#/SX Flocele
and tail-in with 225 SXS Premium Cement with 5% KCL
and 0.8% Halad-322 FLA.
 - (1) Precede cement w/500 Gals. mud flush.
 - (2) Mix and displace cement at 6-7 BPM.
 - (3) Run 2 plugs -- Do not wash up on plug.
5. Set slips, cut off casing and release rig.

John L. Dannelley
8-1-89

RECEIVED
STATE CORPORATION COMMISSION

DEC 4 - 1989

CONSERVATION DEPARTMENT
WICHITA, KANSAS

ORIGINAL

RELEASED

JAN 15 1991

DRILL REPORT

Rawlings I-2

FROM CONFIDENTIAL

- 8/5/89 Location 1250' from South and East line Sec 35 T34S R39W Stevens Co. KS- Gr. Ele 3286.10
Build location & road - move in & rig up Service Drilling Co. Rig No. 2 - KB-9.5' KB Ele 3295.5
- 8/6/89 Shut down over Sunday.
- 8/7/89 Drill rat hole - Spud 12 1/4" hole @ 12:15PM
Drill to 625' - circ 15 min - P.O.H. - ST 1/4 degree @ 625'-Run 14 Jts (611.36') 8 5/8" outside diameter 24# J-55 ST&C casing w/ GS. IFV @ 568', 3 centralizers - set & cemented @ 623' w/200 sx Cl "C" (12.3 Ppg) & 100sx Cl "H" (14.8 Ppg) w/2% Cacl2 & 1/4#/sx Flocele - Mix & pump 5 Bpm - Displace w/37 BW - cement circulated o.k. - Pp 0-250 - Bumped plug @ 800# plug held ok - job complete @ 9 PM - W.O.C.
- 8/8/89 625' - RB -0- footage WOC will drill out @ 9AM
- 8/9/89 2002 Drilling ahead anhy & shale 1377' last 24 hrs 9.4# 34 VIS 6WL LCM ST 1/2 degree @1300'
- 8/10/89 2763' Dolo & Sh 761'/24 hrs Mud: 9.3# 44 vis 8 WL 2 LCM 2/32 FC 1900 chlorides - ST 3/4 degree @ 2045
- 8/11/89 2950 TD 187' Dolo & Sh reached TD @ 1:15PM ST 1 degree @2950' Circ 30 Min - 10 Std Shortrip - circ 45 min - TOH for logging - Halliburton Logging Services - Ran dual induction 2943-620' - log TD @ 2947 & Comp. N-D log & Gr CAC 2944-2500' TIH, circ 45 min TOH LD DP & DC comp 3:15 AM 8/11/89. Ran 70 lts (2943.04') 3 1/2" 14# J-55 ST&C Casing w/GS. IFV @ 2905' 8 centralizers, 20 cable wipers -circ & reciprocate casing - pump 500 gal mud flush - Set & cemented @ 2948' w/200 sx Cl "C" of 1/4#/Sx Flocele & tail-in w/225 sx Cl "H" w/5% KCL & 0.8% Halad 322 FLA - Mix & pump @ 6' BPM - PP 0-1000# Bumped plug @1500# Held Ok. Set slips - Rel rig @ 7AM 8/11/89. W.O.C.

RECEIVED
STATE CORPORATION COMMISSION

DEC 4 - 1989

CONSERVATION DIVISION
Wichita, Kansas