

RELEASED
2-16-91
FEB 28 1991

SIDE ONE

STATE CORPORATION COMMISSION OF KANSAS
OIL & GAS CONSERVATION DIVISION
WELL COMPLETION OR RECOMPLETION FORM
ACO-1 WELL HISTORY
DESCRIPTION OF WELL AND LEASE

API NO. 15-129-20,939-00-00

County... Morton FROM CONFIDENTIAL

NW SE SE Sec. 11 Twp. 34S Rge. 40 East
West

1250 Ft North from Southeast Corner of Section
1250 Ft West from Southeast Corner of Section
(Note: Locate well in section plat below)

Lease Name... Markillie "A" Well #... 1H

Field Name... Hugoton

Producing Formation... Chase

Elevation: Ground... 3328.6 KB... NA

Operator: License # 5598
Name... APX Corporation
Address... P.O. Box 351
City/State/Zip... Liberal, Kansas 67905-0351

Purchaser... Panhandle Eastern Pipe Line Co.
(Transporter)

Operator Contact Person... M. L. Pease
Phone... (316) 624-6253

Contractor: License # 5842
Name... Gabbert-Jones, Inc.

Wellsite Geologist... NA
Phone...

Designate Type of Completion
 New Well Re-Entry Workover
 Oil SWD Temp Abd
 Gas Inj Delayed Comp.
 Dry Other (Core, Water Supply etc.)

If OWHO: old well info as follows:
Operator
Well Name
Comp. Date
Old Total Depth

WELL HISTORY
Drilling Method:
 Mud Rotary Air Rotary Cable
11-3-88 11-6-88 1-5-89
Spud Date Date Reached TD Completion Date
2842 2829
Total Depth PBTD
Amount of Surface Pipe Set and Cemented at 520 feet
Multiple Stage Cementing Collar Used? Yes No
If yes, show depth set... feet
If alternate 2 completion, cement circulated
from... feet depth to... w/... SX cmt
Cement Company Name Halliburton Services
Invoice # 720894

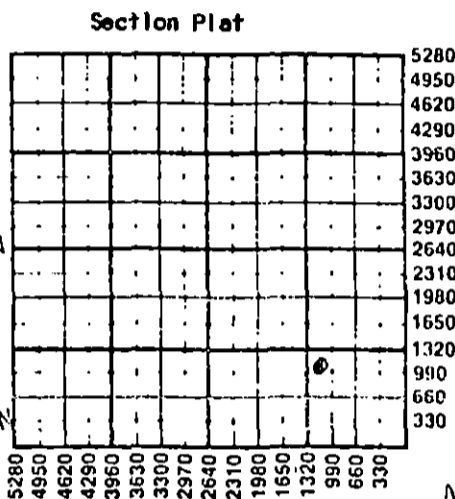

RECEIVED
STATE CORPORATION COMMISSION
FEB 16 1989
CONSERVATION DIVISION
Wichita, Kansas

ART 2
2-18-91

WATER SUPPLY INFORMATION

Disposition of Produced Water: Disposal
Docket # Repressuring

Questions on this portion of the ACO-1 call:
Water Resources Board (913) 296-3717
Source of Water:
Division of Water Resources Permit #
 Groundwater... Ft North from Southeast Corner
(Well) ... Ft West from Southeast Corner of
Sec Twp Rge East West
 Surface Water... Ft North from Southeast Corner
(Stream, pond etc)... Ft West from Southeast Corner
Sec Twp Rge East West
 Other (explain) Contractor provided water...
(purchased from city, R.W.D. #)

INSTRUCTIONS: This form shall be completed in triplicate and filed with the Kansas Corporation Commission, 200 Colorado Derby Building, Wichita, Kansas 67202, within 120 days of the spud date of any well. Rule 82-3-130, 82-3-107 and 82-3-106 apply. Information on side two of this form will be held confidential for a period of 12 months if requested in writing and submitted with the form. See rule 82-3-107 for confidentiality in excess of 12 months. One copy of all wireline logs and drillers time log shall be attached with this form. Submit OP-4 form with all plugged wells. Submit CP-1 form with all temporarily abandoned wells.

All requirements of the statutes, rules and regulations promulgated to regulate the oil and gas industry have been fully complied with and the statements herein are complete and correct to the best of my knowledge.

Signature... M. L. Pease
Title... Division Production Manager Date 2/14/89
KANSAS GEOLOGICAL SURVEY FEB 17 1989
WICHITA BRANCH
Subscribed and sworn to before me this 15th day of Feb. 1989
Notary Public... Glenn S. Sallee

GLENN S. SALLEY
NOTARY PUBLIC
STATE OF KANSAS
MY APPT. EXPIRES 1-6-91

K.C.C. OFFICE USE ONLY
 Letter of Confidentiality Attached
 Wireline Log Received
 Drillers Time Log Received
Distribution
 KCC SWD/Rep NGPA
 KGS Plug Other
(Specify)

Sec. 11 Twp. 34 Rge. 40

PI

Operator Name APX Corporation Lease Name Markillie "A" Well # 1H

Sec. 11 Twp. 34S Rge. 40 East West County Morton RELEASED

FEB 28 1991

WELL LOG

INSTRUCTIONS: Show important tops and base of formations penetrated. Detail all cores. Report all stem tests giving interval tested, time tool open and closed, flowing and shut-in pressures, whether shut-in pressure reached static level, hydrostatic pressures, bottom hole temperature, fluid recovery, and flow rates if gas to surface during test. Attach extra sheet if more space is needed. Attach copy of log.

FROM CONFIDENTIAL

Drill Stem Tests Taken Yes No
 Samples Sent to Geological Survey Yes No
 Cores Taken Yes No

Formation Description
 Log Sample

Name	Top	Bottom
Sand, Clay	0'	490'
Redbed	490	1242
Glorietta Sand	1242	1400
Redbed	1400	2490
Lime	2490	2842
TD		2842

CASING RECORD <input checked="" type="checkbox"/> Now <input type="checkbox"/> Used Report all strings set-conductor, surface, intermediate, production, etc.							
Purpose of String	Size Hole Drilled	Size Casing Set (In O.D.)	Weight Lbs/Ft.	Setting Depth	Type of Cement	#Sacks Used	Type and Percent Additives
Surface	12-1/4"	8-5/8"	24.0	520	Pozmix & Common	350	3% CC
Production	7-7/8"	5-1/2"	14.0	2842	Class C	245	10% DCD, 20% DCD
PERFORATION RECORD Shots Per Foot Specify Footage of Each Interval Perforated				Acid, Fracture, Shot, Cement Squeeze Record (Amount and Kind of Material Used) Depth			
2 2558-2590, 2500-2531, 2474-2485				Brk dwn w/9400 gal 2% KCL wtr. Frac w/38,500 gal foam gelled 2% KCL wtr & 100,000# 12/20 sand. 2474-2590 OA			
TUBING RECORD Size Set At Packer at		Liner Run <input type="checkbox"/> Yes <input checked="" type="checkbox"/> No					
Date of First Production 1-24-89		Producing Method <input checked="" type="checkbox"/> Flowing <input type="checkbox"/> Pumping <input type="checkbox"/> Gas Lift <input type="checkbox"/> Other (explain).....					
Estimated Production Per 24 Hours		Oil Bbls	Gas 1540 MCF @ 90 psig	Water Bbls	Gas-Oil Ratio CFPB	Gravity	

METHOD OF COMPLETION

Production Interval

Disposition of gas: Vented Sold Used on Lease
 Open Hole Perforation Other (Specify) 2474-2590 OA
 Dually Completed Conmingled

GABBERT-JONES
DRILLERS WELL LOG

RELEASED

FEB 2 8 1991

MARKILLIE "A" 1H
SEC. 11-34S-40W
MORTON COUNTY, KANSAS

FROM CONFIDENTIAL

Commenced: 11-3-88
Completed: 11-6-88
Operator: ANADARKO PETROLEUM CORPORATION

Depth		Formation	Remarks
From	To		
0	490	Sand - Clay	Ran 12 jts of 24# 8 5/8" csg LD @ 520' w/200 sks 25/75 Posmix - 2% CC - 1/4# FS 150 sks Common - 3% CC - 1/4# FS PD @ 7:45 PM 11-3-88.
490	1242	Redbed	
1242	1400	Glorita Sand	
1400	2490	Redbed	
2490	2842	Lime	Ran 69 jts of 14# 5 1/2" csg LD @ 2841' w/205 sks class C - 20% DCD - 2% CC 1/4# FS - 40 sks Class C 10% DCD - 2% CC - 1/4# FS PD @ 5:30 AM 11-6-88. Rig Released @ 6:30 AM 11-6-88.
	2842 TD		

RECEIVED
STATE CORPORATION COMMISSION
FEB 16 1989
CONSERVATION DIVISION
Wichita Kansas

State of Kansas)
County of Sedgwick) I, the undersigned, being duly sworn on oath, state that the above Drillers ' Well Log is true and correct to the best of my knowledge and belief and according to the records of this office.

GABBERT-JONES, INC.

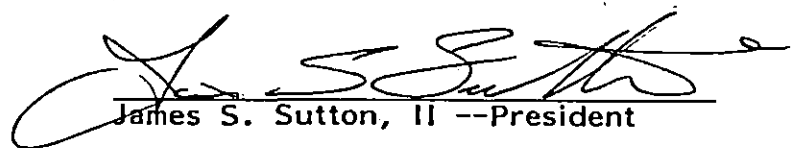
James S. Sutton, II --President

KANSAS GEOLOGICAL SURVEY
WICHITA BRANCH

Subscribed & sworn to before me this
10th day of November 1988

Lela Lenore Costa

My Commission expires Nov. 21, 1988

API # 15 129 20,939
Markillie "A" Well #1H
NW:SE SE 11 34 40W

RELEASED

FEB 28 1991

FROM CONFIDENTIAL

<u>NAME</u>	<u>TOP</u>	<u>BOTTOM</u>
Blaine	1104	1190
Cedar Hills	1234	1390
Stone Corral	1660	1706
Chase	2462	2787
Panoma Council Grove	2787	NA
TD		2842

RECEIVED
STATE CORPORATIONS COMMISSION

FEB 18 1991

CONSERVATION DIVISION
Wichita, Kansas



P.O. BOX 651046
DALLAS, TX 75265

INVOICE

HALLIBURTON SERVICES

A Halliburton Company

RELEASED

INVOICE NO.	DATE
720894	11/03/1988

WELL LEASE NO./PLANT NAME		WELL/PLANT LOCATION		STATE	WELL/PLANT OWNER	
MARKILLIE A-1H		MORTON		20	SAME	
SERVICE LOCATION		CONTRACTOR		JOB PURPOSE		TICKET DATE
LIBERAL		GABBERT & JONES #9		CEMENT SURFACE CASING		11/03/1988
ACCT. NO.	CUSTOMER AGENT	VENDOR NO.	CUSTOMER P.O. NUMBER		SHIPPED VIA	FILE NO.
001527	JOHN SHILLING				COMPANY TRUCK	67666

APX CORPORATION
P. O. BOX 351
LIBERAL, KS 67905-0351

DIRECT CORRESPONDENCE TO:
SUITE 600
COLORADO DERBY BUILDING
WICHITA, KS 67202-0000

PRICE REF. NO.	DESCRIPTION	QUANTITY	U/M	UNIT PRICE	AMOUNT
000-117	MILEAGE	50	MI	2.20	110.00
		1	UNT		
001-016	CEMENTING CASING PUMP CHARGE	529	FT	486.60	486.60
		1	UNT		
030-018	TYPE SW, PLASTIC TOP PLUG	8	5/8 IN	82.00	82.00 *
		1	EA		
504-043	PREMIUM CEMENT	150	SK	6.85	1,027.50 *
506-105	POZMIX A	50	SK	3.91	195.50 *
504-043	PREMIUM CEMENT	150	SK	6.85	1,027.50 *
509-406	ANHYDROUS CALCIUM CHLORIDE	8	SK	25.75	206.00 *
507-210	FLOCELE	88	LB	1.21	106.48 *
500-207	BULK SERVICE CHARGE	366	CFT	.95	347.70 *
500-306	MILEAGE	293.652	TMI	.70	205.56 *

INVOICE SUBTOTAL 3,794.84

DISCOUNT-(BID) 720.99-

INVOICE BID AMOUNT 3,073.85

*-KANSAS STATE SALES TAX 103.62

*-SEWARD COUNTY SALES TAX 25.90

2110-2041

K-11-15

FINAL APPROVAL	
FILE #	LOCATION
LIBERAL OPERATIONS RECEIVED	
NOV 14 1988	
APPROVED	IDC
DATE	TERMS
CODE BY	OPERATIONS

RECEIVED
STATE CORPORATION COMMISSION
FEB 16 1989
CONSERVATION DIVISION
Wichita, Kansas

INVOICE TOTAL - PLEASE PAY THIS AMOUNT =====> \$3,203.37

TERMS INVOICES PAYABLE NET BY THE 20TH OF THE FOLLOWING MONTH AFTER DATE OF INVOICE, UPON CUSTOMER'S DEFAULT IN PAYMENT OF CUSTOMER'S ACCOUNT BY THE LAST DAY OF THE MONTH FOLLOWING THE MONTH IN WHICH THE INVOICE IS DATED, CUSTOMER AGREES TO PAY INTEREST THEREON AFTER DEFAULT AT THE HIGHEST LAWFUL CONTRACT RATE APPLICABLE BUT NEVER TO EXCEED 18% PER ANNUM, IN THE EVENT IT BECOMES NECESSARY TO EMPLOY AN ATTORNEY TO ENFORCE COLLECTION OF SAID ACCOUNT, CUSTOMER AGREES TO PAY ALL COLLECTION COSTS AND ATTORNEY FEES IN THE AMOUNT OF 20% OF THE AMOUNT OF THE UNPAID ACCOUNT.