

STATE CORPORATION COMMISSION OF KANSAS
OIL & GAS CONSERVATION DIVISION

WELL COMPLETION OR RECOMPLETION FORM
ACO-1 WELL HISTORY

DESCRIPTION OF WELL AND LEASE

Operator: License # 9783
Name Santa Fe Minerals, Inc.
Address Two Galleria Tower
13455 Noel Rd., Suite 1100
City/State/Zip Dallas, Texas 75240

Purchaser Oklahoma Gas Pipeline Co.

Operator Contact Person Jim LaFevers
Phone (214) 701-7588

Contractor: License # 05382
Name Cheyenne Drilling Co.

Wellsite Geologist Gayle Tapp
Phone (918) 561-7206

Designate Type of Completion
 New Well Re-Entry Workover
 Oil SWD Temp Abd
 Gas Inj Delayed Comp.
 Dry Other (Core, Water Supply etc.)

If OWWO: old well info as follows:
Operator
Well Name
Comp. Date Old Total Depth

WELL HISTORY

Drilling Method: Mud Rotary Air Rotary Cable
11/22/87 11/25/87 3/28/88
Spud Date Date Reached TD Completion Date
2850' 2828'
Total Depth PBTD
Amount of Surface Pipe Set and Cemented at 755' feet
Multiple Stage Cementing Collar Used? Yes No
If yes, show depth set...feet
If alternate 2 completion, cement circulated
from...feet depth to...w/...SX cmt
A/I

API NO. 15-175-20986-00-00

County Seward
N W 4 Sec. 30 Twp. 34S Rge. 34 East West

4025 Ft North from Southeast Corner of Section
3958 Ft West from Southeast Corner of Section
(Note: Locate well in section plat below)

Lease Name Alberta Mueller Well # 2

Field Name Hugoton

Producing Formation Chase

Elevation: Ground 2957 KB 2966

Section Plat

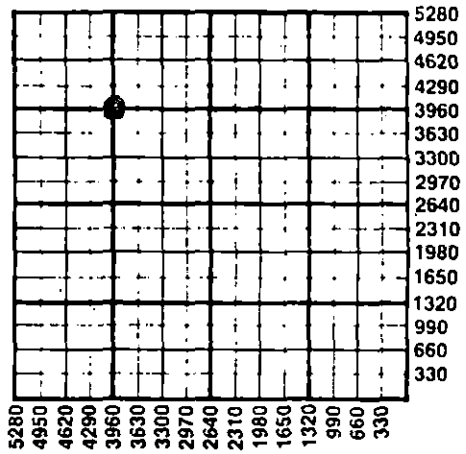

WATER SUPPLY INFORMATION
Disposition of Produced Water: Disposal Repressuring
Docket #

Questions on this portion of the ACO-1 call:
Water Resources Board (913) 296-3717

Source of Water:
Division of Water Resources Permit #
 Groundwater...Ft North from Southeast Corner (Well) ...Ft West from Southeast Corner of Sec Twp Rge East West
 Surface Water...Ft North from Southeast Corner (Stream, pond etc.)...Ft West from Southeast Corner Sec Twp Rge East West
 Other (explain) hauled in (purchased from city, R.W.D. #)

INSTRUCTIONS: This form shall be completed in duplicate and filed with the Kansas Corporation Commission, 200 Colorado Derby Building, Wichita, Kansas 67202, within 90 days after completion or recompletion of any well. Rule 82-3-130 and 82-3-107 apply. Information on side two of this form will be held confidential for a period of 12 months if requested in writing and submitted with the form. See rule 82-3-107 for confidentiality in excess of 12 months. One copy of all wireline logs and drillers time log shall be attached with this form. Submit CP-4 form with all plugged wells. Submit CP-111 form with all temporarily abandoned wells.

All requirements of the statutes, rules and regulations promulgated to regulate the oil and gas industry have been fully complied with and the statements herein are complete and correct to the best of my knowledge.

Signature James B. L...
Title Engineering Technician Date 2/18/88

Subscribed and sworn to before me this 18th day of April 1988
Notary Public Barbara D. Anderson
BARBARA D. ANDERSON
Notary Public, State of Texas
My Commission Expires June 29, 1989

K.C.C. OFFICE USE ONLY
F Letter of Confidentiality Attached
C Wireline Log Received
C Drillers Time Log Received
Distribution
 KCC SWD/Rep NGPA
 KGS Plug Other (Specify)
4-25-88

Sec. 30 Twp. 34 Rge. 34W

SIDE TWO

Operator Name Santa Fe Minerals, Inc. Lease Name..... Alberta Mueller Well #..... 2

Sec. 30 Twp. 34S Rge. 34 East West County... Seward

WELL LOG

INSTRUCTIONS: Show important tops and base of formations penetrated. Detail all cores. Report all drill stem tests giving interval tested, time tool open and closed, flowing and shut-in pressures, whether shut-in pressure reached static level, hydrostatic pressures, bottom hole temperature, fluid recovery, and flow rates if gas to surface during test. Attach extra sheet if more space is needed. Attach copy of log.

Drill Stem Tests Taken Yes No
 Samples Sent to Geological Survey Yes No
 Cores Taken Yes No

Formation Description
 Log Sample

Name	Top	Bottom
Blaine Gypsum	980	
Glorietta	1160	
Tubb	1630	
Red Cave	1695	
Wellington	2250	
Chase Group	2630	

CASING RECORD <input checked="" type="checkbox"/> New <input type="checkbox"/> Used								
Report all strings set-conductor, surface, intermediate, production, etc.								
Purpose of String	Size Hole Drilled	Size Casing Set (in O.D.)	Weight Lbs/Ft.	Setting Depth	Type of Cement	#Sacks Used	Type and Percent Additives	
Surface	12-1/4	8-5/8	24	755'	Class "C"	250	2% CaCl	
Production	7-7/8	5-1/2	15.5	2850'	Class "C"	120	2% CaCl	
					Class "C"	370	2% CaCl	
					Class "H"	130	5% KCL	
PERFORATION RECORD				Acid, Fracture, Shot, Cement Squeeze Record				
Shots Per Foot	Specify Footage of Each Interval Perforated			(Amount and Kind of Material Used)			Depth	
2	Chase 2786-2646			17,600 gal. 28% HCL			2786-	
				3,000 gal. 15% HCL			2646	
TUBING RECORD		Size	Set At	Packer at	Liner Run	<input type="checkbox"/> Yes <input type="checkbox"/> No		
		2-3/8"	2803'	None				
Date of First Production		Producing Method						
3/23/88		<input type="checkbox"/> Flowing <input type="checkbox"/> Pumping <input checked="" type="checkbox"/> Gas Lift <input type="checkbox"/> Other (explain).....						
Estimated Production Per 24 Hours	Oil		Gas		Water		Gas-Oil Ratio	Gravity
	0	Bbls	609	MCF	0	Bbls	-	CFPB -

METHOD OF COMPLETION

Production Interval

Disposition of gas: Vented Sold Used on Lease
 Open Hole Perforation Other (Specify)
 Dually Completed Commingled

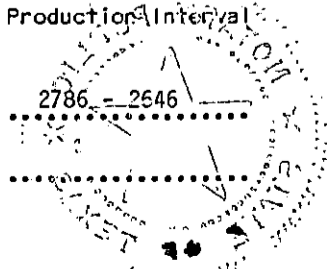

TOPOGRAPHIC LAND SURVEYORS

Surveying and Mapping for the Energy Industry

1006 E. 17TH ST. • HAYS, KANSAS 67601

TELEPHONES: LOCAL (913) 625-2683 • OKLA. WATS (800) 522-4273 • OUT OF STATE WATS (800) 854-3219

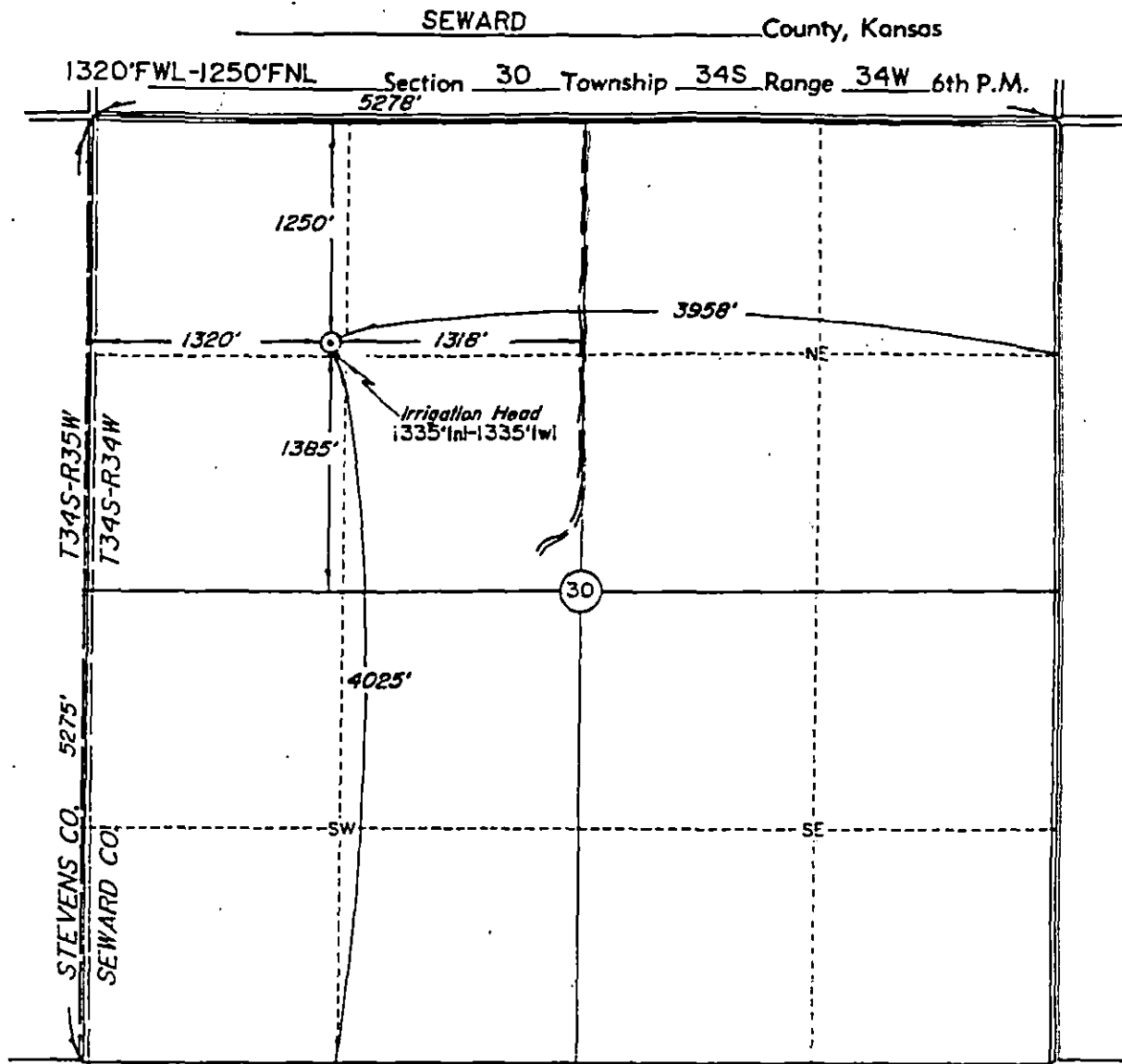

Scale: 1" = 1000'

Date Staked October 28, 1987

This location has been very carefully staked on the ground according to the best official survey records, maps, and photographs available to us, but its accuracy is not guaranteed.

Review this plat and notify us immediately of any possible discrepancy.

Operator: SANTA FE MINERALS

ELEVATION:

2957' Gr. of Stake

Lease Name: ALBERTA Mueller Well No: 2

Topography & Vegetation Location fell in alfalfa.

RECEIVED
STATE CORPORATION COMMISSION

Good Drill Site? Yes Reference Stakes or Alternate Location Stakes Set: none

APR 25 1988

Best Accessibility to Location From West.

CONSERVATION DIVISION
WICHITA, KANSAS

Distance & Direction from Hwy Jct or Town From Jct. US 83 & US 270 & Tucker Road (North of Liberal), go 8 miles West on Tucker Road to the Northwest Corner of Section 30, T34S-R34W.

CERTIFICATE:

I, Roger R. Rowe a Registered Land Surveyor and an authorized agent of Topographic Land Surveyors, do hereby certify that the above described well location was surveyed and staked on the ground as shown herein.

Roger R. Rowe

Kansas Reg. No. 839

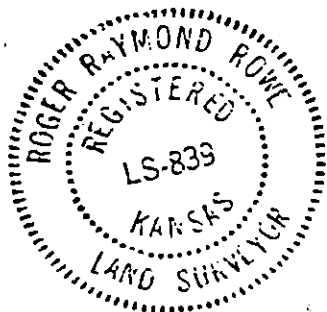

DRILLERS LOG

SANTA FE MINERALS, INC.
ALBERTA MJELLER #2
SECTION 30-T34S-R34W
SEWARD COUNTY, KANSAS

COMMENCED: 11-22-87
COMPLETED: 11-25-87

SURFACE CASING: 755' OF 8 5/8"
CMTD. W/370 SX HLC "C" 2% C.C.
1/4# FLOCELE, TAILED IN W/130 SX
THIXSET 5%, KCL 5# GELSONITE

FORMATION	DEPTH
CONDUCTOR CASING	0- 50
SURFACE HOLE	50- 755
SAND & RED BED	755-1402
SAND, RED BED, & ANHYDRITE	1402-1970
LIME & SHALE	1970-2358
LIMESTONE & SHALE	2358-2680
LIME & SHALE	2680-2850 RTD

I DO HEREBY CERTIFY THAT THE FOREGOING STATEMENTS ARE TRUE AND CORRECT TO THE BEST OF MY KNOWLEDGE AND BELIEF.

CHEYENNE DRILLING, INC.

A. J. JACQUES

STATE OF KANSAS :ss:

SUBSCRIBED AND SWORN TO BEFORE ME THIS 30TH DAY OF NOVEMBER, 1987.

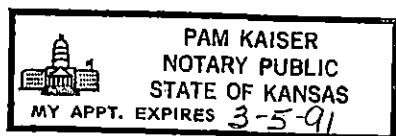

PAM KAISER, NOTARY PUBLIC

RECEIVED
COMMISSION

DEC 8 1987

CONSERVATION DIVISION
Wichita, Kansas