

STATE CORPORATION COMMISSION OF KANSAS
OIL & GAS CONSERVATION DIVISION
WELL COMPLETION FORM
ACO-1 WELL HISTORY
DESCRIPTION OF WELL AND LEASE

Operator: License # 5208

Name: Mobil Oil Corporation

Address P.O. Box 2173

2319 North Kansas Avenue

City/State/Zip Liberal, KS 67905-2173

Purchaser: NA

Operator Contact Person: Sharon Cook

Phone (316) 626-1142

Contractor: Name: Catholic Protection Services

License: 31474

Wellsite Geologist: _____

Designate Type of Completion
 New Well Re-Entry Workover

Oil SWD SLOW Temp. Abd.
 Gas ENHR SIGW
 Dry Other (Core, WSW, Expl., Cathodic, etc)

If Workover:

Operator: _____

Well Name: _____

Comp. Date _____ Old Total Depth _____

Deepening Re-perf. Conv. to Inj/SWD
 Plug Back PBDT
 Commingled Docket No. _____
 Dual Completion Docket No. _____
 Other (SWD or Inj?) Docket No. _____

1/18/95 1/18/95 1/18/95
Spud Date Date Reached TD Completion Date

API NO. 15- 189-21880-0000 ORIGINAL

County STEVENS

- SW - NE - NW Sec. 2 Twp. 34 Rge. 36 E

4030 FSL Feet from S/W (circle one) Line of Section

3930 FEL Feet from E/W (circle one) Line of Section

Footages Calculated from Nearest Outside Section Corner:
NE, SP, NW or SW (circle one)

Lease Name CP- LEWIS Well # 1-3

Field Name Hugoton

Producing Formation NA [ANODE REPOSITORY]

Elevation: Ground 3034 KB NA

Total Depth 100 PBDT NA

Amount of Surface Pipe Set and Cemented at None Feet

Multiple Stage Cementing Collar Used? NA Yes NA No

If yes, show depth set NA Feet

If Alternate II completion, cement circulated from NA

feet depth to NA w/ NA sx cmt.

Drilling Fluid Management Plan ALT 3 2/27 10-18-95
(Data must be collected from the Reserve Pit)

Chloride content NA ppm Fluid volume NA bbls

Dewatering method used NA

Location of fluid disposal if hauled offsite:

Operator Name NA

Lease Name NA License No. _____

NA Quarter Sec. NA Twp. NA S Rng. NA E/W

County NA Docket No. NA

INSTRUCTIONS: An original and two copies of this form shall be filed with the Kansas Corporation Commission, 200 Colorado Derby Building, Wichita, Kansas 67202, within 120 days of the spud date, recompletion, workover or conversion of a well. Rule 82-3-130, 82-3-106 and 82-3-107 apply. Information on side two of this form will be held confidential for a period of 12 months if requested in writing and submitted with the form (see rule 82-3-107 for confidentiality in excess of 12 months). One copy of all wireline logs and geologist well report shall be attached with this form. ALL CEMENTING TICKETS MUST BE ATTACHED. Submit CP-4 form with all plugged wells. Submit CP-111 form with all temporarily abandoned wells.

All requirements of the statutes, rules and regulations promulgated to regulate the oil and gas industry have been fully complied with and the statements herein are complete and correct to the best of my knowledge.

Signature Sharon A. Cook Sharon A. Cook

Title Regulatory Assistant Date 2-13-95

Subscribed and sworn to before me this 13th day of February, 19 95.

Notary Public Kathleen R. Poulton

Date Commission Expires AUGUST 18, 1998

DEW95097.SAC



K.C.C. OFFICE USE ONLY
F Letter of Confidentiality Attached
C Wireline Log Received
C Geologist Report Received
Distribution
 KCC SWD/Rep NGPA
 KGS Plug Other
(Specify)

Form ACO-1 (7-91)

STATE CORPORATION COMMISSION
FEB 17 1995

SIDE TWO

Operator Name Mobil Oil Corporation Lease Name CP- LEWIS Well # 1-3
 Sec. 2 Twp. 34 Rge. 36 East West
 County STEVENS

INSTRUCTIONS: Show important tops and base of formations penetrated. Detail all cores. Report all drill stem tests giving interval tested, time tool open and closed, flowing and shut-in pressures, whether shut-in pressure reached static level, hydrostatic pressures, bottom hole temperature, fluid recovery, and flow rates if gas to surface during test. Attach extra sheet if more space is needed. Attach copy of log.

Drill Stem Tests Taken (Attach Additional Sheets.)	<input type="checkbox"/> Yes <input checked="" type="checkbox"/> No	<input checked="" type="checkbox"/> Log	Formation (Top), Depth and Datums	<input type="checkbox"/> Sample
Samples Sent to Geological Survey	<input type="checkbox"/> Yes <input checked="" type="checkbox"/> No	Name	Top	Datum
Cores Taken	<input type="checkbox"/> Yes <input checked="" type="checkbox"/> No	SEE ATTACHED DRILLER'S LOG		
Electric Log Run (Submit Copy.)	<input type="checkbox"/> Yes <input checked="" type="checkbox"/> No			
List All E.Logs Run:				
Electric Resistance Log - Attached				

CASING RECORD <input type="checkbox"/> New <input type="checkbox"/> Used							
Report all strings set-conductor, surface, intermediate, production, etc.							
Purpose of String	Size Hole Drilled	Size Casing Set (In O.D.)	Weight Lbs./Ft.	Setting Depth	Type of Cement	# Sacks Used	Type and Percent Additives

ADDITIONAL CEMENTING/SQUEEZE RECORD				
Purpose:	Depth Top Bottom	Type of Cement	#Sacks Used	Type and Percent Additives
<input type="checkbox"/> Perforate				
<input type="checkbox"/> Protect Casing				
<input type="checkbox"/> Plug Back TD				
<input checked="" type="checkbox"/> Plug Off Zone	(1) First plug - Bentonite set at 13' - 3' plug.			
	(2) Second plug - Bentonite set at 28' - 26' plug.			

Shots Per Foot	PERFORATION RECORD - Bridge Plugs Set/Type Specify Footage of Each Interval Perforated	Acid, Fracture, Shot, Cement Squeeze Record (Amount and Kind of Material Used)	Depth
First anode set at	90', second anode at 70', third anode at 60'.		

TUBING RECORD		Size	Set At	Packer At	Liner Run	<input type="checkbox"/> Yes <input type="checkbox"/> No
1" PVC vent from TD to 3' above surface.					NA	
Date of First, Resumed Production, SMD or Inj. Installed 1/18/95			Producing Method			
			NA <input type="checkbox"/> Flowing <input type="checkbox"/> Pumping <input type="checkbox"/> Gas Lift <input type="checkbox"/> Other (Explain)			
Estimated Production Per 24 Hours	Oil Bbls. NA	Gas NA	Mcf NA	Water NA	Bbls.	Gas-Oil Ratio Gravity

Disposition of Gas: **METHOD OF COMPLETION** Production Interval

Vented Sold Used on Lease Open Hole Perf. Dually Comp. Commingled

(If vented, submit ACO-18.) Other (Specify) _____

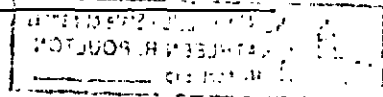

DATA SHEET

COMPANY MOBILE E+P JOB No. 80100370 DATE: 1-18-95
 WELL: LEWIS 1-3 PIPELINE: _____
 LOCATION: SEC. 2 TWP. 34 RGE. 36 CO. STEVENS STATE KS
 ANODE TYPE LIDA ONE FT: ROTARY 100 FT: CASING _____ FT.

DEEP GROUND BED LOGGING DATA

DRILL. DEPTH LOG (FT)	ANODE TO			DRILL DEPTH LOG (FT)	ANODE TO		
	STRUCTURE		ANODES NO		STRUCTURE		ANODES NO
	EXPLOR OHM	FINAL OHM			EXPLOR OHM	FINAL OHM	
5				205			
HOLE PLUG 10				210			
EARTH FILL 15				215			
20				220			
HOLE PLUG 25				225			
30	.850			230			
35	.740			235			
40	.420			240			
45	.380			245			
50	.300			250			
55	.800			255			
60	1.10		3	260			
65	1.06			265			
70	.850		2	270			
75	.780			275			
80	.540			280			
85	.500			285			
90	.770		1	290			
95				295			
100				300			
105				305			
110				310			
115				315			
120				320			
125				325			
130				330			
135				335			
140				340			
145				345			
150				350			
155				355			
160				360			
165				365			
170				370			
175				375			
180				380			
185				385			
190				390			
195				395			
200				400			

PIT CLOSED 1-18-95 HOLE PLUG SET 1-18-95

GROUND BED RESISTANCE: (1) VOLTS _____ ÷ AMPS _____ = _____ OHMS (2) VIBROGROUND _____ OHMS

0-45 - Clay
45-65 - Sand
65-100 - Clay ORIGINAL

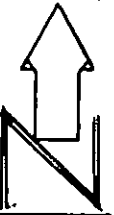

19

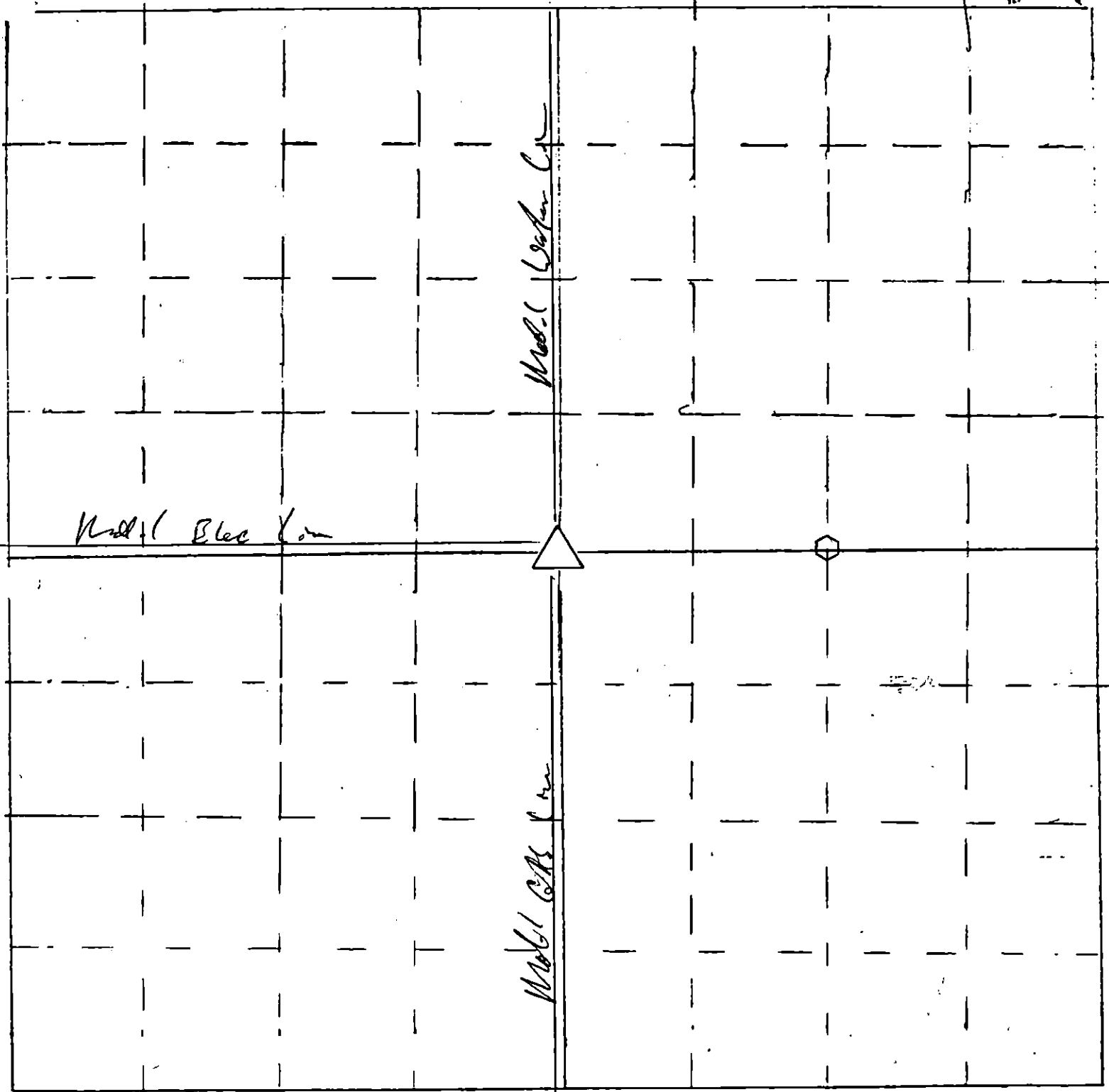

- △ = gas well location
- ⬡ = cathodic deep well location

Scale = 1" = 50'
□ = Meter house

120