

STATE CORPORATION COMMISSION OF KANSAS OIL & GAS CONSERVATION DIVISION WELL COMPLETION OR RECOMPLETION FORM ACO-1 WELL HISTORY DESCRIPTION OF WELL AND LEASE

D/W KCC

Operator: License # 4549 Name: Anadarko Petroleum Corporation Address: P.O. Box 351 City/State/Zip: Liberal, KS 67905-0351

Purchaser: NA

Operator Contact Person: M. L. Pease Phone: (316) 624-6253

Contractor: License # 5842 Name: Gabbert-Jones, Inc.

Wellsite Geologist: Greg Smith Phone: (303) 223-1842

Designate Type of Completion: [X] New Well [] Re-Entry [] Workover

Oil [] SWD [] Temp Abd Gas [] Inj [X] Delayed Comp. Dry [] Other (Core, Water Supply etc.)

If OWNO: old well Info as follows: Operator Well Name Comp. Date Old Total Depth

WELL HISTORY

Drilling Method: [X] Mud Rotary [] Air Rotary [] Cable

Spud Date: 6/18/89 Date Reached TD: 7/1/89 Completion Date: NA

Total Depth: 6750 PBDT: 3015

Amount of Surface Pipe Set and Cemented at: 1750 feet Multiple Stage Cementing Collar Used? Yes [X] No If yes, show depth set: feet If alternate 2 completion, cement circulated from: feet depth to: w/ SX cmt Cement Company Name: BJ-Titan Company Invoice #: TW115

API NO. 15-189-21,348-06.00

County: Stevens Ap Ne Nw FROM CONFIDENTIAL NW SE SW Sec. 4 Twp. 34S Rge. 37 East West

4030' 1250' 3780' Ft North from Southeast Corner of Section Ft West from Southeast Corner of Section (Note: Locate well in section plat below)

Lease Name: MATAGORDA "A" Well #: 1

Field Name: Condor Prospect

Producing Formation: NA

Elevation: Ground: 3136.6 KB 3148.6

Section Plat

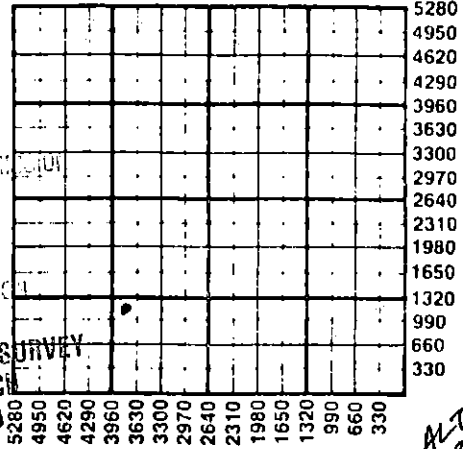

RECEIVED SEP 28 1989 9-28-89 KANSAS GEOLOGICAL SURVEY WICHITA BRANCH SEP 26 1989

MT 10-30-90

WATER SUPPLY INFORMATION

Disposition of Produced Water: [] Disposal [] Repressuring

Questions on this portion of the ACO-1 call: Water Resources Board (913) 296-3717

Source of Water: Division of Water Resources Permit #

Groundwater: Ft North from Southeast Corner (Well) Ft West from Southeast Corner of Sec Twp Rge East West

Surface Water: Ft North from Southeast Corner (Stream, pond etc) Ft West from Southeast Corner Sec Twp Rge East West

[X] Other (explain): Contractor provided water. (purchased from city, R.W.D. #)

INSTRUCTIONS: This form shall be completed in triplicate and filed with the Kansas Corporation Commission, 200 Colorado Derby Building, Wichita, Kansas 67202, within 120 days of the spud date of any well. Rule 82-3-130, 82-3-107 and 82-3-106 apply. Information on side two of this form will be held confidential for a period of 12 months if requested in writing and submitted with the form. See rule 82-3-107 for confidentiality in excess of 12 months. One copy of all wireline logs and drillers time log shall be attached with this form. Submit CP-4 form with all plugged wells. Submit CP-111 form with all temporarily abandoned wells.

All requirements of the statutes, rules and regulations promulgated to regulate the oil and gas industry have been fully complied with and the statements herein are complete and correct to the best of my knowledge.

Signature: M. L. Pease Title: Division Production Manager Date: 9/21/89

Subscribed and sworn to before me this 27th day of September 1989. Notary Public: Cheryl Steers

Date Commission Expires: CHERYL STEERS My Appt. Expires 6-1-93

K.C.C. OFFICE USE ONLY Letter of Confidentiality Attached [X] Wireline Log Received [X] Drillers Timelog Received Distribution: [X] KCC [X] KGS [] SWD/Rep [] Plug [] NGPA [] Other (Specify)

PI

Operator Name Anadarko Petroleum Corporation Lease Name MATAGORDA "A" Well # 1

Sec. 4 Twp. 34S Rge. 37 East West County STEVENS

RELEASED

MAY 02 1991

WELL LOG

FROM CONFIDENTIAL

INSTRUCTIONS: Show important tops and base of formations penetrated. Detail all cores. Report all drill stem tests giving interval tested, time tool open and closed, flowing and shut-in pressures, whether shut-in pressure reached static level, hydrostatic pressures, bottom hole temperature, fluid recovery, and flow rates if gas to surface during test. Attach extra sheet if more space is needed. Attach copy of log.

Drill Stem Tests Taken Yes No
 Samples Sent to Geological Survey Yes No
 Cores Taken Yes No

Formation Description
 Log Sample

DST #1 6573-6623 (St. Louis)
 30-60-60-120
 IHP 3375
 IFP 55-83
 ISIP 102
 FFP 55-55
 FSIP 72
 FHP 3133
 Recover 6' drilling mud

Name	Top	Bottom
Sand-Redbed	0	870
Redbed-Sand	870	1765
Lime-Shale	1765	6750
TD		6750

See ATTACHED Fm. Tops.

CASING RECORD <input checked="" type="checkbox"/> New <input type="checkbox"/> Used							
Report all strings set-conductor, surface, intermediate, production, etc.							
Purpose of String	Size Hole Drilled	Size Casing Set (In O.D.)	Weight Lbs/Ft.	Setting Depth	Type of Cement	#Sacks Used	Type and Percent Additives
Surface	12 1/4"	8 5/8"	24	1759	Poz/Com.	625/200	4% gel, 2% cc
Production	7 7/8"	5 1/2"	14	3015	Class "C"	160/40	20% Diacel D, 10% Diacel D
PERFORATION RECORD				Acid, Fracture, Shot, Cement Squeeze Record			
Shots Per Foot	Specify Footage of Each Interval Perforated			Amount and Kind of Material Used			Depth
	NA						
TUBING RECORD				Size	Set At	Packer at	Liner Run <input type="checkbox"/> Yes <input checked="" type="checkbox"/> No
Date of First Production		Producing Method <input type="checkbox"/> Flowing <input type="checkbox"/> Pumping <input type="checkbox"/> Gas Lift <input type="checkbox"/> Other (explain).....					
NA							
Estimated Production Per 24 Hours		Oil	Gas	Water	Gas-Oil Ratio	Gravity	
		Bbls	MCF	Bbls	CFPB		

METHOD OF COMPLETION

Production Interval

Disposition of gas: Vented Sold Used on Lease

Open Hole Perforation Other (Specify) Delayed..

Quality Completed
 Commingled

ORIGINAL

ORIGINAL

ATTACHMENT

MATAGORDA "A" NO. 1
SECTION 4-34S-37W
STEVENS COUNTY, KANSAS

API #15-189-21,348

RELEASED

JAN 02 1991

FROM CONFIDENTIAL

<u>FORAMTION</u>	<u>DEPTH</u>	<u>SUBSEA (GL 3137)</u>
BASE STONE CORRAL	1760	+1377
TOP CHASE GROUP	2604	+533
TOP COUNCIL GROVE	2954	+183
TOP ADMIRE	3182	-45
TOP WABAUNSEE	3370	-233
TOP TOPEKA	3645	-508
TOP HEEBNER	4204	-1067
TOP TORONTO	4232	-1095
TOP LANSING	4346	-1209
TOP KANSAS CITY	4794	-1657
TOP MARMATON	5072 ✓	-1835
TOP CHEROKEE	5304 ✓	-2167
TOP MORROW	5838 ✓	-2701
TOP CHESTER	6285 ✓	-3148
TOP STE. GENEVIEVE	6426 ✓	-3289
TOP ST. LOUIS	6570	-3433

RECEIVED
STATE CORPORATION COMMISSION

DEC 7 1990

CONSERVATION DIVISION
Wichita, Kansas

ORIGINAL

GABBERT-JONES, INC.

MATAGORDA "A" #1
SEC. 4-34S-37W
STEVENS COUNTY, KANSAS

Drillers Well Log

RELEASED

COMMENCED: 6-18-89

JAN 02 1991

COMPLETED: 7-2-89

FROM CONFIDENTIAL

OPERATOR: ANADARKO PETROLEUM CORPORATION

DEPTH		FORMATION	REMARKS
From	To		
0	870	Sand-Redbed	Ran 43 jts of 24# 8 5/8" csg LD @ 1759' w/625 sks Posmix - 4% Gel 2% CC - 200 sks Common 2% CC PD @ 5:00 PM 6-19-89.
870	1765	Redbed-Sand	
1765	6750	Lime-Shale	
	6750 TD		Ran 70 jts of 14# 5 1/2" csg LD @ 3015' w/160 sks class C - 20% DCD 2% CC - 1/4# FS - 40 sks Class C - 10% DCD 2% CC - 1/4# FS PD @ 10:00 AM 7-2-89. RR @ 11:00 AM 7-2-89.

RECEIVED
STATE CONSERVATION COMMISSION
SEP 28 1989
CONSERVATION DIVISION
Wichita, Kansas

STATE OF KANSAS]
]]
COUNTY OF SEDGWICK]

I, the undersigned, being duly sworn on oath, state that the above Drillers Well Log is true and correct to the best of my knowledge and belief and according to the records of this office.

GABBERT- JONES, INC.

James S. Sutton, II
James S. Sutton, II - President

Subscribed & sworn to before me this
12th day of July, 1989.

Lola Lenore Costa
Lola Lenore Costa

LOLA LENORE COSTA
NOTARY PUBLIC
STATE OF KANSAS
My Appt. Exp. 11/22/92

INVOICE DATE
05/19/89

DIRECT BILLING INQUIRIES TO: 713-895-5821	TERMS NET AMOUNT DUE 30 DAYS FROM DATE OF INVOICE	REMIT TO: BJ-TITAN SERVICES P.O. BOX 100806 HOUSTON, TX 77212
--	--	--

PAGE 1	INVOICE NO. TW115
-----------	----------------------

ANADARKO PETROLEUM CORP.

P.O. BOX 351

LIBERAL

KS 67901

WELL NUMBER : A-1

CUSTOMER PROJECT ~~CONFIDENTIAL~~ 5030

4348-2071
JUN 02 1989

AUTHORIZED BY 512508

PURCH. ORDER REF. NO.

LEASE NAME AND NUMBER MATAGORDA	STATE 14	COUNTY/PARISH	CITY	DISTRICT NAME PERRYTON	DISTR. NO. 3345
JOB LOCATION/FIELD	MTA DISTRICT	DATE OF JOB 06/19/89	TYPE OF SERVICE LAND-CONDUCTOR/SURFACE		

PRODUCT NUMBER	QUANTITY	DESCRIPTION	UNIT PRICE	U/M	EXTENDED PRICE
10410505	513.00	CLASS H CEMENT	6.46	CF	3,313.98
10109005	10.00	MILEAGE CHRG, FROM NEAREST BAS	1.10		11.00
10880001	897.02	MIXING SEVICE CHRG DRY MATERIA	0.95		852.17
10940101	187.00	DRAYAGE, PER TON MILE	0.70		130.90
10100315	1.00	CEMENTING CASING 1500 TO 3000	875.00		875.00
10415018	313.00	FLY ASH	3.44	CF	1,076.72
10420105	625.00	BJ-TITAN GEL, BENTONITE, 1% TH	0.37	CF	231.25
10415048	17.82	CALCIUM CHLORIDE, FLAKE	25.75	SK	458.87
10430536	1.00	2-5/8" TOP RUBBER PLUG	100.00	EA	100.00

KANSAS GEOLOGICAL SURVEY
WICHITA BRANCH

RECEIVED
STATE OPERATIONS DIVISION

SEP 28 1989

CONSERVATION DIVISION
Wichita, Kansas

APPROVED	LOCATION
DATE	6-27-89
OPERATIONS RECEIVED	

SUBTOTAL	7,049.89
DISCOUNT	2,304.46

ACCOUNT	JUN 26 1989	00000% STATE TAX	3487.30	139.49
---------	-------------	------------------	---------	--------

TAX EXEMPTION STATUS:

PAY THIS AMOUNT

4,884.92