

STATE CORPORATION COMMISSION OF KANSAS
OIL & GAS CONSERVATION DIVISION
WELL COMPLETION OR RECOMPLETION FORM
ACO-1 WELL HISTORY
DESCRIPTION OF WELL AND LEASE

5

OWWO

15-175-10190-0001

API No. 15-.....
County..... SEWARD
..... C NE NW Sec. 16 Twp. 34 Rge. 32 East
..... West

Operator: License # 9682
Name Harry A. Spring
Address P.O. Box 1788
City/State/Zip Ardmore, OK 73402

..... 4620 Ft North from Southeast Corner of Section
..... 3300 Ft West from Southeast Corner of Section
(Note: Locate well in section plat below)

Purchaser..... Koch Oil Co.
..... P.O. Box 2256
..... Wichita, Kansas 67201

Lease Name..... Johnson Well #..... 3
Field Name..... Evelyn Condit NE

Operator Contact Person Tom Spring
Phone (303)-771-1809

Producing Formation..... Toronto
Elevation: Ground..... 2772' 2784' KB

Contractor: License # None
Name

Wellsite Geologist..... None
Phone

Designate Type of Completion
New Well Re-Entry Workover

Oil SWD Temp Abd
 Gas Inj Delayed Comp.
 Dry Other (Core, Water Supply etc.)

If OWWO: old well info as follows:
Operator Kansas Petroleum Inc.
Well Name Johnson #1
Comp. Date 9/12/63 Old Total Depth 6406

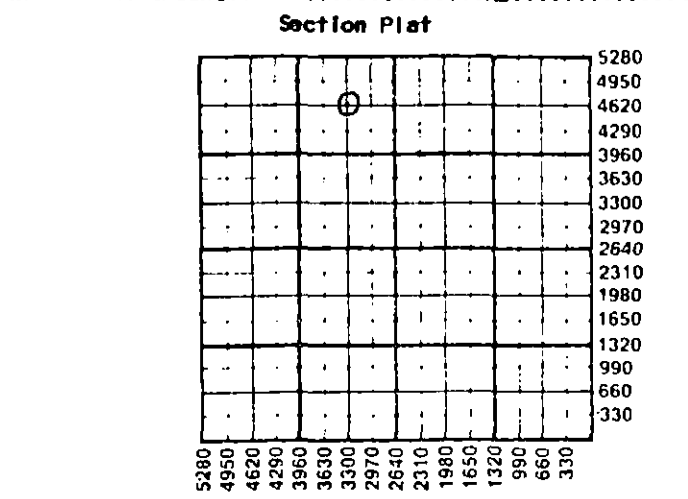

WATER SUPPLY INFORMATION
Disposition of Produced Water: Disposal
Docket # Repressuring

WELL HISTORY

Drilling Method:
 Mud Rotary Air Rotary Cable

8/11/82 8/13/82 6/4/86
Spud Date Date Reached TD Completion Date
6406 4915
Total Depth PBD

Amount of Surface Pipe Set and Cemented at 1440 feet
Multiple Stage Cementing Collar Used? Yes No
If yes, show depth set..... feet
If alternate 2 completion, cement circulated from (in place) feet depth to.....w/.....SX cmt
Cement Company Name
Invoice #

Questions on this portion of the ACO-1 call:
Water Resources Board (913) 296-3717
Source of Water:
Division of Water Resources Permit #.....
 Groundwater.....Ft North from Southeast Corner (Well)Ft West from Southeast Corner of Sec Twp Rge East West
 Surface Water.....Ft North from Southeast Corner (Stream, pond etc).....Ft West from Southeast Corner Sec Twp Rge East West
 Other (explain).....
(purchased from city, R.W.D. #)

INSTRUCTIONS: This form shall be completed in triplicate and filed with the Kansas Corporation Commission, 200 Colorado Derby Building, Wichita, Kansas 67202, within 120 days of the spud date of any well. Rule 82-3-130, 82-3-107 and 82-3-106 apply.
Information on side two of this form will be held confidential for a period of 12 months if requested in writing and submitted with the form. See rule 82-3-107 for confidentiality in excess of 12 months.
One copy of all wireline logs and drillers time log shall be attached with this form. Submit CP-4 form with all plugged wells. Submit CP-111 form with all temporarily abandoned wells.

All requirements of the statutes, rules and regulations promulgated to regulate the oil and gas industry have been fully complied with and the statements herein are complete and correct to the best of my knowledge.

Signature Thomas L. Spring
Thomas L. Spring
Agent
Title..... Date 9-18-86

Subscribed and sworn to before me this 18th day of September 1986
Notary Public Carol A. Knäpke
Date Commission Expires 12-12-87

K.C.C. OFFICE USE ONLY
F Letter of Confidentiality Attached
C Wireline Log Received
C Drillers Time Log Received
Distribution
KCC SWD/Rep NGPA
KGS Plug Other
(Specify)

Sec 16 Twp 34 Rge 32

9-22-86
SEP 22

Operator Name Harry A. Spring Lease Name..... Johnson..... Well #..... 3

Sec. 16 Twp. 34 Rge. 32 East West County..... Seward

WELL LOG

INSTRUCTIONS: Show important tops and base of formations penetrated. Detail all cores. Report all drill stem tests giving interval tested, time tool open and closed, flowing and shut-in pressures, whether shut-in pressure reached static level, hydrostatic pressures, bottom hole temperature, fluid recovery, and flow rates if gas to surface during test. Attach extra sheet if more space is needed. Attach copy of log.

Drill Stem Tests Taken Yes No
 Samples Sent to Geological Survey Yes No
 Cores Taken Yes No

Formation Description
 Log Sample

Name Top Bottom

Well was originally drilled by Kansas Petroleum Inc. in 1963 and P & A'd. In July 1982, Tucker Production Corp. reentered well, drilled out plugs to TD, ran pipe and cemented 4 1/2" casing. Then the well was temporarily abandoned. Harry A. Spring acquired well and completed. All logs, tests, formation descriptions are already in your files.

CASING RECORD <input checked="" type="checkbox"/> New <input type="checkbox"/> Used							
Report all strings set-conductor, surface, intermediate, production, etc.							
Purpose of String	Size Hole Drilled	Size Casing Set (in O.D.)	Weight Lbs/Ft.	Setting Depth	Type of Cement Pozmix	#Sacks Used	Type and Percent Additives
Surface	12 1/4	8 5/8	24	1440	Class H	200	6% gel/2% KCl
Production	7 2/8	4 1/2	10.5	6406	Pozmix	170	18% salt 10#/sk
Full opening	cementer	4429		DV@5287	Class H	75	3/4% CFR2
PERFORATION RECORD				Acid, Fracture, Shot, Cement Squeeze Record			
Shots Per Foot	Specify Footage of Each Interval Perforated			(Amount and Kind of Material Used)		Depth	
2	5200-5204			Opened FO Cementer & Squeezed 100 sx Class H 5% KCl 4/10% Halad 500 gal. 15% MCA Set CIBP @ 4915'		w/ 4429 322	
2	4394-4408			1500 gal. 15% MCA		5200 snabbed salt water 4394	
TUBING RECORD				Liner Run <input type="checkbox"/> Yes <input checked="" type="checkbox"/> No			
Date of First Production		Producing Method					
6/2/86		<input type="checkbox"/> Flowing <input checked="" type="checkbox"/> Pumping <input type="checkbox"/> Gas Lift <input type="checkbox"/> Other (explain).....					
Estimated Production Per 24 Hours		Oil	Gas	Water	Gas-Oil Ratio	Gravity	
20 Bbls			MCF	65 Bbls	CFPB	39°	

18% salt 2% gel

METHOD OF COMPLETION

Production Interval

Disposition of gas: Vented Open Hole Perforation
 Sold Other (Specify)
 Used on Lease Dually Completed
 Conmngled

4394-4408

STATE CORPORATION COMMISSION OF KANSAS
OIL & GAS CONSERVATION DIVISION
WELL COMPLETION OR RECOMPLETION FORM
ACO-1 WELL HISTORY
DESCRIPTION OF WELL AND LEASE

Operator: License # 9682
Name Harry A. Spring
Address P.O. Box 1788
City/State/Zip Ardmore, OK 73402

Purchaser Koch Oil Co.
P.O. Box 2256
Wichita, Kansas 67201

Operator Contact Person Tom Spring
Phone (303) 771-1889

Contractor: License # None
Name

Wellsite Geologist None
Phone

Designate Type of Completion
New Well Re-Entry Workover
 Oil SWD Temp Abd
 Gas Inj Delayed Comp.
 Dry Other (Core, Water Supply etc.)

If OWWO: old well info as follows:
Operator Kansas Petroleum Inc.
Well Name Johnson #1
Comp. Date 9/12/63 Old Total Depth 6406

WELL HISTORY

Drilling Method:
 Mud Rotary Air Rotary Cable

8/11/82 8/13/82 6/4/86
Spud Date Date Reached TD Completion Date
6406 4915
Total Depth PBD

Amount of Surface Pipe Set and Cemented at 1440 feet
Multiple Stage Cementing Collar Used? Yes No
If yes, show depth set feet
If alternate 2 completion, cement circulated from (in place) feet depth to w/ SX cmt
Cement Company Name
Invoice #

API NO. 15- OWWO
County SEWARD
C NE NW 16 34 32 East
Sec Twp Rge West

4620 Ft North from Southeast Corner of Section
3300 Ft West from Southeast Corner of Section
(Note: Locate well in section plat below)

Lease Name Johnson Well # 3

Field Name Evelyn Condit NE

Producing Formation Toronto

Elevation: Ground 2772' KB 2784'

Section Plat

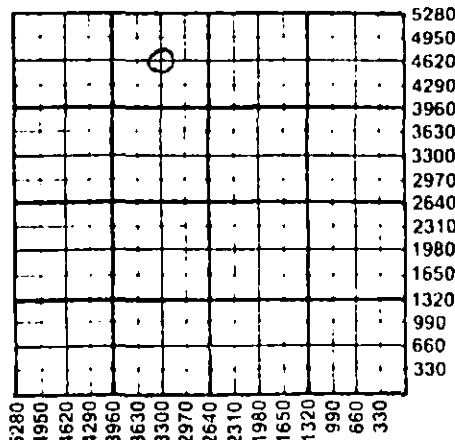

WATER SUPPLY INFORMATION

Disposition of Produced Water: Disposal
Docket # Repressuring

Questions on this portion of the ACO-1 call:
Water Resources Board (913) 296-3717

Source of Water:
Division of Water Resources Permit #

Groundwater Ft North from Southeast Corner
(Well) Ft West from Southeast Corner of
Sec Twp Rge East West

Surface Water Ft North from Southeast Corner
(Stream, pond etc) Ft West from Southeast Corner
Sec Twp Rge East West

Other (explain)
(purchased from city, R.W.D. #)

INSTRUCTIONS: This form shall be completed in triplicate and filed with the Kansas Corporation Commission, 200 Colorado Derby Building, Wichita, Kansas 67202, within 120 days of the spud date of any well. Rule 82-3-130, 82-3-107 and 82-3-106 apply. Information on side two of this form will be held confidential for a period of 12 months if requested in writing and submitted with the form. See rule 82-3-107 for confidentiality in excess of 12 months. One copy of all wireline logs and drillers time log shall be attached with this form. Submit CP-4 form with all plugged wells. Submit CP-111 form with all temporarily abandoned wells.

All requirements of the statutes, rules and regulations promulgated to regulate the oil and gas industry have been fully complied with and the statements herein are complete and correct to the best of my knowledge.

Signature Thomas L. Spring
Agent
Title Date 9-18-86

Subscribed and sworn to before me this 18th day of September 1986
Notary Public Carol A. Knapke
Date Commission Expires 12-12-87

K.C.C. OFFICE USE ONLY
F Letter of Confidentiality Attached
C Wireline Log Received
C Drillers Timelog Received
Distribution
KCC SWD/Rep NGPA
KGS Plug Other
(Specify)

SEP 29

Operator Name Harry A. Spring Lease Name..... Johnson Well #..... 3.....

Sec..... 16 Twp..... 34 Rge..... 32 East West County..... Seward

WELL LOG

INSTRUCTIONS: Show important tops and base of formations penetrated. Detail all cores. Report all drill stem tests giving interval tested, time tool open and closed, flowing and shut-in pressures, whether shut-in pressure reached static level, hydrostatic pressures, bottom hole temperature, fluid recovery, and flow rates if gas to surface during test. Attach extra sheet if more space is needed. Attach copy of log.

Drill Stem Tests Taken Yes No
 Samples Sent to Geological Survey Yes No
 Cores Taken Yes No

Formation Description
 Log Sample

Name Top Bottom

Well was originally drilled by Kansas Petroleum Inc. in 1963 and P & A'd. In July 1982, Tucker PROduction Corp. reentered well, drilled out plugs to TD, ran pipe and cemented 4 1/2" casing. Then the well was temporarily abandoned. Harry a. Spring acquired well and completed. All logs tests, formation descriptions are already in your files.

CASING RECORD <input type="checkbox"/> New <input type="checkbox"/> Used							
Report all strings set-conductor, surface, intermediate, production, etc.							
Purpose of String	Size Hole Drilled	Size Casing Set (in O.D.)	Weight Lbs/Ft.	Setting Depth	Type of Cement	#Sacks Used	Type and Percent Additives
Surface	12 1/4	8 5/8	24	1440	Class H	200	6% gel, 2% KCl
Production	7 2/8	4 1/2	10.5	6406	Pozmix	170	18% salt, 10#/sk
Full opening	cementer @4429			DVE5287	Class H none	75	3/4% CFR2
PERFORATION RECORD				Acid, Fracture, Shot, Cement Squeeze Record			
Shots Per Foot	Specify Footage of Each Interval Perforated			(Amount and Kind of Material Used)			Depth
2	5200-5204			Opened FO Cements & Squeezed w/4429 100 sx Class H 5% KCl 4/10% Halad 500 gal. 15% MCA			322
2	4394-4408			Set CIRP @ 4195' 1500 gal. 15% MCA			5200 snabbed salt water 4394
TUBING RECORD				Liner Run <input type="checkbox"/> Yes <input checked="" type="checkbox"/> No			
Date of First Production		Producing Method <input type="checkbox"/> Flowing <input checked="" type="checkbox"/> Pumping <input type="checkbox"/> Gas Lift <input type="checkbox"/> Other (explain).....					
6/2/86							
Estimated Production Per 24 Hours		Oil	Gas	Water	Gas-Oil Ratio	Gravity	
20 Bbls		-	MCF	65 Bbls	CFPB	39°	

18% salt 2% gel

METHOD OF COMPLETION

Production Interval

Disposition of gas: Vented Open Hole Perforation
 Sold Other (Specify)
 Used on Lease Dually Completed Commingled

4393-4408
