

STATE CORPORATION COMMISSION OF KANSAS
OIL & GAS CONSERVATION DIVISION
WELL COMPLETION OR RECOMPLETION FORM
ACO-1 WELL HISTORY
DESCRIPTION OF WELL AND LEASE

API NO. 15-175-21,069-00-00
County Seward
C SW SW Sec 14 34S 33 East
..... X West
660 Ft North from Southeast Corner of Section
4620 Ft West from Southeast Corner of Section
(Note: Locate well in section plat below)

Lease Name Salley "J" Well # 1
Field Name Hugoton
Producing Formation Chase
Elevation: Ground 2829.6 KB NA

Operator: License # 4549
Name Anadarko Petroleum Corporation
Address P.O. Box 351
City/State/Zip Liberal, KS 67905-0351

Purchaser NA

Operator Contact Person M. L. Pease
Phone (316) 624-6253

Contractor: License # 5842
Name Gabbert-Jones, Inc.

Wellsite Geologist Ed Nichols
Phone

Designate Type of Completion
 New Well Re-Entry Workover

Oil SWD Temp Abd
 Gas Inj Delayed Comp
 Dry Other (Core, Water Supply etc.)

If OWHO: old well info as follows:
Operator
Well Name
Comp. Date Old Total Depth

WELL HISTORY
Drilling Method:
 Mud Rotary Air Rotary Cable
12-29-88 1-9-89 NA
Spud Date Date Reached TD Completion Date
6670 2888
Total Depth PBTD

Amount of Surface Pipe Set and Cemented at 1576 feet
Multiple Stage Cementing Collar Used? Yes No
If yes, show depth set.....feet
If alternate 2 completion, cement circulated
from.....feet depth to.....w/.....SX cmt
Cement Company Name Dowell Schlumberger, Inc.
Invoice # 03-12-1381
AIR I

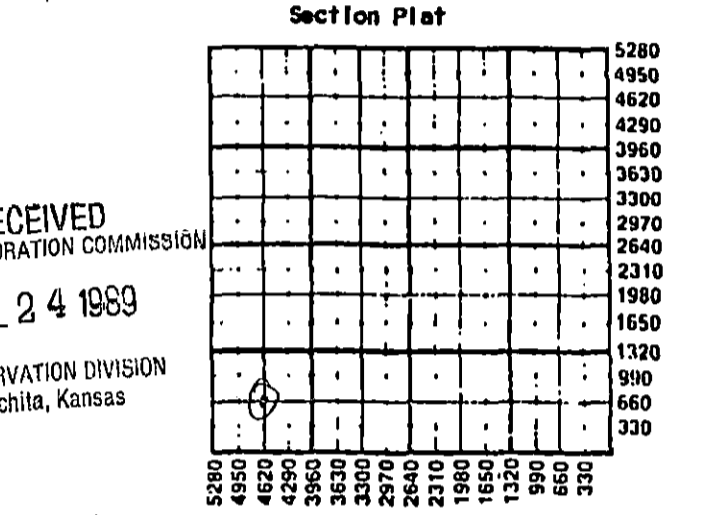

WATER SUPPLY INFORMATION
Disposition of Produced Water: Disposal
Docket # Repressuring

Questions on this portion of the ACO-1 call:
Water Resources Board (913) 296-3717
Source of Water:
Division of Water Resources Permit #
 Groundwater.....Ft North from Southeast Corner
(Well)Ft West from Southeast Corner of
Sec Twp Rge East West
 Surface Water.....Ft North from Southeast Corner
(Stream, pond etc).....Ft West from Southeast Corner
Sec Twp Rge East West
 Other (explain) Contractor provided water..
(purchased from city, R.W.D. #)

INSTRUCTIONS: This form shall be completed in triplicate and filed with the Kansas Corporation Commission, 200 Colorado Derby Building, Wichita, Kansas 67202, within 120 days of the spud date of any well. Rule 82-3-130, 82-3-107 and 82-3-106 apply.
Information on side two of this form will be held confidential for a period of 12 months if requested in writing and submitted with the form. See rule 82-3-107 for confidentiality in excess of 12 months.
One copy of all wireline logs and drillers time log shall be attached with this form. Submit CP-4 form with all plugged wells. Submit CP-111 form with all temporarily abandoned wells.

All requirements of the statutes, rules and regulations promulgated to regulate the oil and gas industry have been fully complied with and the statements herein are complete and correct to the best of my knowledge.

Signature M. L. Pease
Title Division Production Manager Date 7/21/89

Subscribed and sworn to before me this 21st day of July 1989
Notary Public Kathryn A. Rowley

Date Commission Expires
KATHRYN A. ROWLEY
Notary Public - State of Kansas
My Appt. Expires 8-1-92

K.C.C. OFFICE USE ONLY
F Letter of Confidentiality Attached
C Wireline Log Received
C Drillers Timelog Received
Distribution
 KCC SWD/Rep NGPA
 KGS Plug Other
(Specify)

Sec 14 Twp 34 Rge 33W

Operator Name Anadarko Petroleum Corporation Lease Name..... SALLEY "J" Well #..... 1.....

Sec..... 14 Twp..... 34S Rge..... 33 East West County..... Seward

WELL LOG

INSTRUCTIONS: Show important tops and base of formations penetrated. Detail all cores. Report all drill stem tests giving interval tested, time tool open and closed, flowing and shut-in pressures, whether shut-in pressure reached static level, hydrostatic pressures, bottom hole temperature, fluid recovery, and flow rates if gas to surface during test. Attach extra sheet if more space is needed. Attach copy of log.

Drill Stem Tests Taken Yes No
 Samples Sent to Geological Survey Yes No
 Cores Taken Yes No

Formation Description
 Log Sample

Name	Top	Bottom
Sand-Redbed	0	380
Redbed	380	1577
Shale	1577	1777
Shale Lime	1777	2631
Lime-Shale	2631	6670
TD		6670

CASING RECORD <input checked="" type="checkbox"/> Now <input type="checkbox"/> Used							
Report all strings set-conductor, surface, intermediate, production, etc.							
Purpose of String	Size Hole Drilled	Size Casing Set (in O.D.)	Weight Lbs/Ft.	Setting Depth	Type of Cement	#Sacks Used	Type and Percent Additives
Surface.....	12 1/4"	8 5/8"	24	1576	"H"	750	2% cc
Production.....	7 7/8"	5 1/2"	14	2898	"C"	100	10% DCD 2% cc
.....
.....
.....
.....
PERFORATION RECORD				Acid, Fracture, Shot, Cement Squeeze Record			
Shots Per Foot	Specify Footage of Each Interval Perforated			(Amount and Kind of Material Used)		Depth	
.....	
.....	
.....	
.....	
TUBING RECORD				Liner Run <input type="checkbox"/> Yes <input checked="" type="checkbox"/> No			
Size	Set At	Packer at					
.....					
Date of First Production		Producing Method					
NA		<input type="checkbox"/> Flowing <input type="checkbox"/> Pumping <input type="checkbox"/> Gas Lift <input type="checkbox"/> Other (explain).....					
Estimated Production Per 24 Hours	Oil	Gas	Water	Gas-Oil Ratio	Gravity		
	bbls	MCF	Bbls	CFPB			

METHOD OF COMPLETION

Production Interval

Disposition of gas: Vented Open Hole Perforation
 Sold Other (Specify)

Used on Lease

Dually Completed
 Dually Completed

GABBERT-JONES
DRILLERS WELL LOG

RECEIVED
STATE CORPORATION COMMISSION

JUL 24 1989

SALLY J #1
C SW SW SEC. 14-34S-33W
SEWARD COUNTY, KANSAS

CONSERVATION DIVISION
Wichita, Kansas

Commenced: 12-29-88

Completed: 1-10-89

Operator: ANADARKO PETROLEUM CORPORATION

Depth		Formation	Remarks
From	To		
0	380	Sand - Redbed	Ran 37 jts of 24# 8 5/8" csg LD @ 1576' w/550 sks Posmix - 4% Gel - 2% CC 200 sks Class H - 2% CC PD @ 10:15 PM 12-30-88. 1" w/100 sks Class H Complete @ 1:30 AM 12-31-88.
380	1577	Redbed	
1577	1777	Shale	
1777	2631	Shale - Lime	
2631	6670	Lime - Shale	
	6670 TD		Ran 69 jts of 14# 5 1/2" csg LD @ 2898' w/100 sks Class C - 10% Diacell D 2% CC PD @ 11:30 PM 1-10-89.

State of Kansas)
County of Sedgwick) I, the undersigned, being duly sworn on oath, state that the above Drillers ' Well Log is true and correct to the best of my knowledge and belief and according to the records of this office.

GABBERT-JONES, INC.

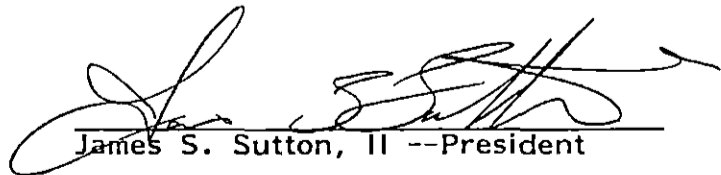
James S. Sutton, II --President

Subscribed & sworn to before me this
19th day of January 1989

Lola Lenore Costa

LOLA LENORE COSTA
NOTARY PUBLIC
STATE OF KANSAS
My Appt. Exp. 11-21-92

My Commission expires Nov. 21, 1992



DOWELL SCHLUMBERGER INCORPORATED

JAA ORIGINAL

INVOICE

REMIT TO: P O BOX 201556
HOUSTON TX 77214

INVOICE DATE
12/31/88

8312

917111 ARX CORPORATION P O BOX 351 LIBERAL KS 67965	PAGE	INVOICE NUMBER
	1	03-12-1381
	TYPE SERVICE	
CEMENTING SURFACE/CONDUCTO		

WELL NAME / JOB SITE	STATE	COUNTY / CITY	SERVICE FROM LOCATION	SHIPPED VIA	CUSTOMER P.O. NO./REF.
SALLY J #1	KS	SEWARD	ULYSSES KS	DS	
LOCATION / PLANT ADDRESS			DATE OF SERVICE ORDER	CUSTOMER OR AUTHORIZED REPRESENTATIVE	
SEC 14-34S-33W			12/30/88	DAVID GILMORE	

ITEM CODE	DESCRIPTION	UOM	QTY	UNIT PRICE	AMOUNT
		RECEIVED STATE CORPORATION COMMISSION JUL 24 1989 CONSERVATION DIVISION Wichita, Kansas			
948213000	CASING CENTR 1500-1997 FT.	HR	1	856.0000	856.00
059200001	MILEAGE, EACH SERVICE TRUCK	MI	5	2.2000	11.00
049192000	TRANSPORTATION CHNT TON MILE	MI	784	.7500	588.00
049100000	SERVICE CHG CEMENT MATL LAND	CFT	776	1.0000	776.00
059697000	PACR TREAT ANALYSIS RECORDER	JOB	1	100.0000	100.00
048501085	PLUG CENG 8-5/8" WOODEN BODY	EA	1	63.0000	63.00
100997125	D863, LIGHTWEIGHT V CEMENT-P	CFT	559	4.8000	2,640.00
040015000	D909, CEMENT CLASS H	CFT	200	6.8000	1,360.00
000401002	D20, BENTONITE BLD-1-4Z	CFT	550	.3900	214.50
067005100	S1, CALCIUM CHLORIDE	LBS	1300	.2700	351.00
040015000	D909, CEMENT CLASS H	CFT	150	6.8000	1,020.00
067005100	S1, CALCIUM CHLORIDE	LBS	282	.2700	76.14
049102000	TRANSPORTATION CHNT TON MILE	MI	165	.7500	123.75
049100000	SERVICE CHG CEMENT MATL LAND	CFT	156	1.0000	156.00
	DISCOUNT - MATERIAL				1,492.99-
	DISCOUNT - SERVICE				680.68-
				SUB TOTAL --	6,161.72
M C	STATE TAX ON			- 4,231.79	169.27
M C C	LOCAL TAX ON			4,231.79	42.32
				AMOUNT DUE --	6,373.31

FINAL APPROVAL

Jim Stewart

LIBERAL OPERATIONS RECEIVED

JAN 11 1989

APPROVED	IOC
DATE 1-11-89	TANCHILE
CREATED BY	OPERATOR

2116-2041
KJ 1/12/89

WITH QUESTIONS CALL 316-356-1272

FEDERAL TAX ID # 38-239-7173

TERMS - NET 30 DAYS DUE ON OR BEFORE JAN 30, 1989

THANK YOU. WE APPRECIATE YOUR BUSINESS.

K J JOHNSTON