

STATE CORPORATION COMMISSION OF KANSAS
OIL & GAS CONSERVATION DIVISION
WELL COMPLETION OR RECOMPLETION FORM
ACO-1 WELL HISTORY
DESCRIPTION OF WELL AND LEASE

API NO. 15-175-21-051-00-00
County Seward
C... NE... SE... Sec. 26... Twp. 34... Rge. 33... East
X West

Operator: License # 7123
Name H.I. INC
Address P.O. BOX 2526
LIBERAL, KANSAS 67905
City/State/Zip

1880 Ft North from Southeast Corner of Section
660 Ft West from Southeast Corner of Section
(Note: Locate well in section plat below)

Purchaser Panhandle Trading Co.

Lease Name Box Well # 3

Operator Contact Person Frank Burke
Phone 316-625-0750

Field Name Evelyn Condit, SW

Producing Formation Basel Marrow

Contractor: License # 9087
Name R & C Drilling Co., Inc.

Elevation: Ground 2792' 2804 KB

Wellsite Geologist
Phone

RECEIVED
STATE CORPORATION COMMISSION
JAN 27 1989

Designate Type of Completion
X New Well Re-Entry Workover
X Oil SHD Temp Abd
X Gas Inj Delayed Comp.
Dry Other (Core, Water Supply etc.)

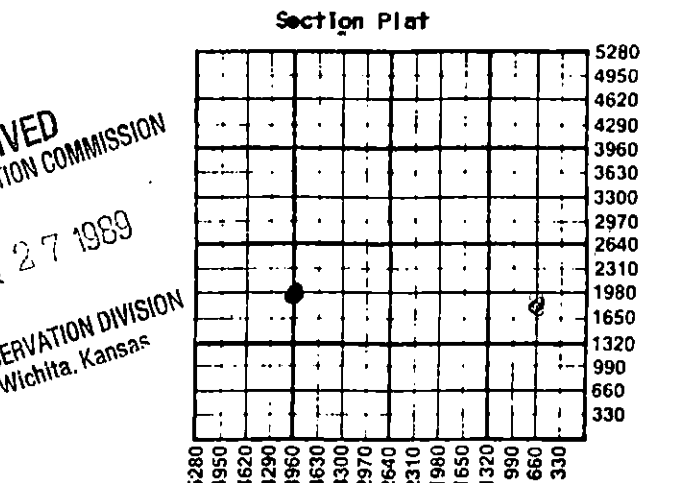

If OWNED: old well info as follows:
Operator
Well Name
Comp. Date Old Total Depth

WATER SUPPLY INFORMATION
Disposition of Produced Water: Disposal
Docket # Repressuring

WELL HISTORY

Drilling Method:
X Mud Rotary Air Rotary Cable
10/20/88 11/2/88 12/15/88
Spud Date Date Reached TD Completion Date
6580' 6195'
Total Depth PBTD

Questions on this portion of the ACO-1 call:
Water Resources Board (913) 296-3717
Source of Water:
Division of Water Resources Permit #
Groundwater Ft North from Southeast Corner (Well) Ft West from Southeast Corner of Sec Twp Rge East West
Surface Water Ft North from Southeast Corner (Stream, pond etc) Ft West from Southeast Corner Sec Twp Rge East West
Other (explain) (purchased from city, R.W.D. #)

Amount of Surface Pipe Set and Cemented at 1600' feet
Multiple Stage Cementing Collar Used? Yes X No
If yes, show depth set feet
If alternate 2 completion, cement circulated from 1600 feet depth to surface SX cmt
Cement Company Name Globe
Invoice # N/A

INSTRUCTIONS: This form shall be completed in triplicate and filed with the Kansas Corporation Commission, 200 Colorado Derby Building, Wichita, Kansas 67202, within 120 days of the spud date of any well. Rule 82-3-130, 82-3-107 and 82-3-106 apply.
Information on side two of this form will be held confidential for a period of 12 months if requested in writing and submitted with the form. See rule 82-3-107 for confidentiality in excess of 12 months.
One copy of all wireline logs and drillers time log shall be attached with this form. Submit CP-4 form with all plugged wells. Submit CP-111 form with all temporarily abandoned wells.

All requirements of the statutes, rules and regulations promulgated to regulate the oil and gas industry have been fully complied with and the statements herein are complete and correct to the best of my knowledge.

Signature Harold E. Rupp
Title President Date 1/26/89

Subscribed and sworn to before me this 21th day of January 1989
Notary Public Terri L. Daugherty
Date Commission Expires Oct. 20, 1991

TERRI L. DAUGHERTY
NOTARY PUBLIC
STATE OF KANSAS
MY APPT. EXPIRES 10/20/91

K.C.C. OFFICE USE ONLY
F Letter of Confidentiality Attached
C Wireline Log Received
C Drillers Timelog Received
Distribution
KCC SWD/Rep NGPA
KGS Plug Other (Specify)
1-27-89
Form ACO-1 (5-86)

Section 24 Rge 33

Operator Name H.I., INC. Lease Name..... BOX Well #..... 3

Sec... 26 ... Twp... 34 ... Rge... 33 ... East West County... SEWARD

WELL LOG

INSTRUCTIONS: Show important tops and base of formations penetrated. Detail all cores. Report all drill stem tests giving interval tested, time tool open and closed, flowing and shut-in pressures, whether shut-in pressure reached static level, hydrostatic pressures, bottom hole temperature, fluid recovery, and flow rates if gas to surface during test. Attach extra sheet if more space is needed. Attach copy of log.

Drill Stem Tests Taken Yes No
 Samples Sent to Geological Survey Yes No
 Cores Taken Yes No

Formation Description
 Log Sample

DST #1

5088-5305/30-30-60-60/
 REC 420' gasie mud oil spec.
 SIP 1691-1694/FP 205-391/
 HP 2608-2533

Name	Top	Bottom
HEEBNER SHALE	4324	
LANSING	4470	
MARMATON	5194	
LOWER OSWEGO	5418	
MORROW SHALE	5818	
MORROW 'PAY' SAND	6024	
CHESTER LIME	6073	
CHESTER 'PAY' SAND B	6311	
ST. GEN.	6450	

CASING RECORD <input checked="" type="checkbox"/> New <input type="checkbox"/> Used							
Report all strings set-conductor, surface, intermediate, production, etc.							
Purpose of String	Size Hole Drilled	Size Casing Set (In O.D.)	Weight Lbs/Ft.	Setting Depth	Type of Cement	#Sacks Used	Type and Percent Additives
Surface	12 1/2"	8-5/8"	25#	1602'	Common	150	3cc
Production	7 7/8"	4 1/2"	10.5#	6257'	Large	500	3cc
						50	H-8% gel 10% salt
						400	5 sks gilsonite 50/50 poz-10% salt
PERFORATION RECORD				Acid, Fracture, Shot, Cement Squeeze Record			
Shots Per Foot	Specify Footage of Each Interval Perforated			(Amount and Kind of Material Used)		Depth	
2	6018-6028			Acid 1000 gal 7 1/2%		6050-54	
				Frac 50,000 Sand 20/40		6050-54	
				30,000 nitro treat			
TUBING RECORD				Liner Run <input type="checkbox"/> Yes <input checked="" type="checkbox"/> No			
	Size 2 3/8	Set At 6010	Packer at none				
Date of First Production		Producing Method					
01/01/89		<input checked="" type="checkbox"/> Flowing <input type="checkbox"/> Pumping <input type="checkbox"/> Gas Lift <input type="checkbox"/> Other (explain).....					
Estimated Production Per 24 Hours		Oil	Gas	Water	Gas-Oil Ratio	Gravity	
		Bbls	2,200 MCF	Bbls	CFPB		

METHOD OF COMPLETION

Production Interval

Disposition of gas: Vented Open Hole Perforation
 Sold Other (Specify) 6018
 Used on Lease Dually Completed 6028
 Commingled