

ORIGINAL

COPY

RELEASED
6117119
SEP 17 1990

SIDE ONE

STATE CORPORATION COMMISSION OF KANSAS
OIL & GAS CONSERVATION DIVISION
WELL COMPLETION OR RECOMPLETION FORM
ACO-1 WELL HISTORY
DESCRIPTION OF WELL AND LEASE

Operator: License # 4549
Name Anadarko Petroleum Corporation
Address P.O. Box 351
City/State/Zip Liberal, Kansas 67905-0351

Purchaser NA

Operator Contact Person M. L. Pease
Phone 316-624-6253

Contractor: License # 5842
Name Gabbert-Iones, Inc.

Wellsite Geologist Ed Nichols
Phone 316-624-2623

Designate Type of Completion
 New Well Re-Entry Workover
 Oil SWD Temp Abd
 Gas Inj Delayed Comp.
 Dry Other (Core, Water Supply etc.)

If OWWO: old well info as follows:
Operator
Well Name
Comp. Date
Old Total Depth

WELL HISTORY

Drilling Method:
 Mud Rotary Air Rotary Cable
4-17-88 4-26-88 5-13-88
Spud Date Date Reached TD Completion Date
6550 6177
Total Depth PBTD

Amount of Surface Pipe Set and Cemented at 1709 feet
Multiple Stage Cementing Collar Used? Yes No
If yes, show depth set 3028 feet
If alternate 2 completion, cement circulated
from feet depth to w/ SX cmt
Cement Company Name
Invoice #

API NO. 15-189 - 21,182 - 00 - 00 FROM CONFIDENTIAL

County Stevens
SW NE NE Sec. 25 Twp. 33 Rge. 35 East
West

4030 Ft North from Southeast Corner of Section
1250 Ft West from Southeast Corner of Section
(Note: Locate well in section plat below)

Lease Name Myrick "A" Well # 1

Field Name Shuck

Producing Formation L. Morrow

Elevation: Ground 2950 KB 2962

RECEIVED

STATE CORPORATION COMMISSION

CONSERVATION DIVISION
Wichita, Kansas

JUN 17 1988

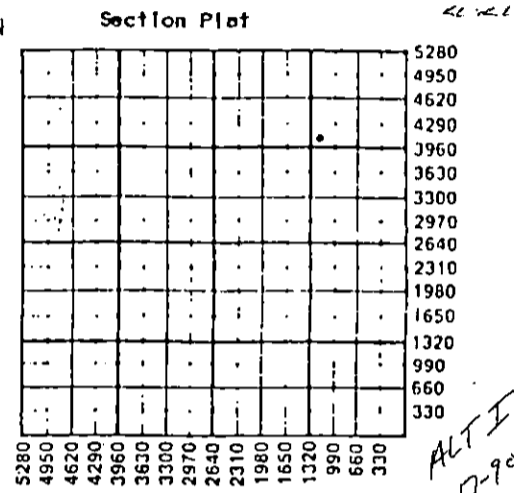

ALT I
9-17-90

WATER SUPPLY INFORMATION

Disposition of Produced Water: Disposal
Docket # NA Repressuring

Questions on this portion of the ACO-1 call:
Water Resources Board (913) 296-3717
Source of Water:
Division of Water Resources Permit #
 Groundwater.....Ft North from Southeast Corner
(Well)Ft West from Southeast Corner of
Sec Twp Rge East West
 Surface Water.....Ft North from Southeast Corner
(Stream, pond etc).....Ft West from Southeast Corner
Sec Twp Rge East West
 Other (explain) Contractor furnished water
(purchased from city, R.W.D. #)

INSTRUCTIONS: This form shall be completed in triplicate and filed with the Kansas Corporation Commission, 200 Colorado Derby Building, Wichita, Kansas 67202, within 120 days of the spud date of any well. Rule 82-3-130, 82-3-107 and 82-3-106 apply. Information on side two of this form will be held confidential for a period of 12 months if requested in writing and submitted with the form. See rule 82-3-107 for confidentiality in excess of 12 months. One copy of all wireline logs and drillers time log shall be attached with this form. Submit CP-4 form with all plugged wells. Submit CP-111 form with all temporarily abandoned wells.

All requirements of the statutes, rules and regulations promulgated to regulate the oil and gas industry have been fully complied with and the statements herein are complete and correct to the best of my knowledge.

Signature M. L. Pease
Title Division Production Manager Date 6/16/88

Subscribed and sworn to before me this 16th day of June 1988
Notary Public Glenna S. Salley

Date Commission Expires

K.C.C. OFFICE USE ONLY
 Letter of Confidentiality Attached
 Wireline Log Received
 Drillers Timelog Received
Distribution
 KCC SWD/Rap NGPA
 KGS Plug Other
Oil Gas Prod (Specify)

Sec 25 Twp 33 Rge 35

JUN 22 1988

GLENN S. SALLEY
NOTARY PUBLIC
STATE OF KANSAS
MY APPL. EXPIRES 1-6-91

Operator Name Anadarko Petroleum Corp. Lease Name Myrick "A" Well # 1

Sec. 25 Twp. 33S Rge. 35 East West County Stevens

WELL LOG

INSTRUCTIONS: Show important tops and base of formations penetrated. Detail all cores. Report all drill stem tests giving interval tested, time tool open and closed, flowing and shut-in pressures, whether shut-in pressure reached static level, hydrostatic pressures, bottom hole temperature, fluid recovery, and flow rates if gas to surface during test. Attach extra sheet if more space is needed. Attach copy of log.

Drill Stem Tests Taken Yes No
 Samples Sent to Geological Survey Yes No
 Cores Taken Yes No

Formation Description
 Log Sample

Name	Top	Bottom
Sand-Redbed	0'	790'
Redbed-Gyp-Sand	790	1360
Redbed-Gyp	1360	1710
Anhy-Redbed	1710	1910
Shale-Lime	1910	3025
Lime-Shale	3025	6550
TD		6550

CASING RECORD <input type="checkbox"/> New <input type="checkbox"/> Used							
Report all strings set-conductor, surface, intermediate, production, etc.							
Purpose of String	Size Hole Drilled	Size Casing Set (In O.D.)	Weight Lbs/Ft.	Setting Depth	Type of Cement	#Sacks Used	Type and Percent Additives
Surface	12-1/4	8-5/8	24	1709	Poz/Com	650/200	4% gel, 2% ca
Prod-1st stage	7-7/8	4-1/2	11.6	6185	LW/Poz	75/150	6% gel, 10% salt
2nd stage				3028	Common	275	1% Econolite
PERFORATION RECORD				Acid, Fracture, Shot, Cement Squeeze Record			
Shots Per Foot	Specify Footage of Each Interval Perforated			(Amount and Kind of Material Used)		Depth	
2	6016-30 (L. Morrow)			A/3300 gal 70% foamed 7-1/2%			
				FE Acid & Nitrogen			
				E/35,000 gal 70% foamed 2% KCL			
				& Nitrogen + 69,500# 20/40 sand			
TUBING RECORD				Liner Run <input type="checkbox"/> Yes <input checked="" type="checkbox"/> No			
Size	Set At	Packer at					
2-3/8	5960	5960					
Date of First Production	Producing Method						
SI WOPL	<input checked="" type="checkbox"/> Flowing <input type="checkbox"/> Pumping <input type="checkbox"/> Gas Lift <input type="checkbox"/> Other (explain).....						
Estimated Production Per 24 Hours	Oil	Gas	Water	Gas-Oil Ratio	Gravity		
	0 Bbls	1600 MCF	0 Bbls	CFPB			

METHOD OF COMPLETION

Production Interval

Disposition of gas: Vented Open Hole Perforation
 Sold SI WOPL Other (Specify) 6016-30
 Used on Lease Dually Completed L. Morrow
 Conmingled

RELEASED

SEP 17 1990

FROM CONFIDENTIAL

MYRICK A #1
1250' FNL & 1250' FEL Sec. 25-35S-35W
STEVENS COUNTY, KANSAS

COMMENCED: 4-17-88
COMPLETED: 4-27-88
OPERATOR: ANADARKO PETROLEUM CORPORATION

DEPTH

From To Formation Remarks

0	790	Sand-Redbed	Ran 40 jts. of 24# 8 5/8"
790	1360	Redbed-Gyp-Sand	csg LD @ 1709' w/650 sks
1360	1710	Redbed-Gyp	Posmix - 4% Gel - 2% CC
1710	1910	Anhy-Redbed	200 sks Common - 2% CC
1910	3025	Shale-Lime	PD @ 6:30 AM 4-18-88.
3025	6550	Lime-Shale	1" to 60' - 100 sks

RECEIVED
STATE CORPORATION COMMISSION

6550 TD

JUN 17 1988

CONSERVATION DIVISION
Wichita, Kansas

Ran 147 jts of 11.6# 4 1/2"
csg LD @ 6181' w/75 sks
Litwt - 6% Gel - 1/2# Celoflakes
150 sks 50/50 Posmix - 10% Salt
1/4# Celo - 5# Gilsonite
PD @ 11:00 PM 4-27-88
Rig Release 11:30 PM 4-27-88.

STATE OF KANSAS)
COUNTY OF SEDGWICK)

I, the undersigned, being duly sworn on oath, state that the above Drillers' Well Log is true and correct to the best of my knowledge and belief and according to the records of this office.

GABBERT-JONES, INC.

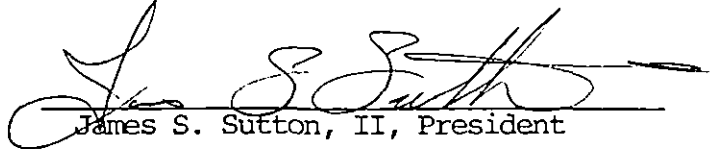
James S. Sutton, II, President

KANSAS GEOLOGICAL SURVEY
WICHITA BRANCH

Subscribed & sworn to before me this 2nd of May 1988.

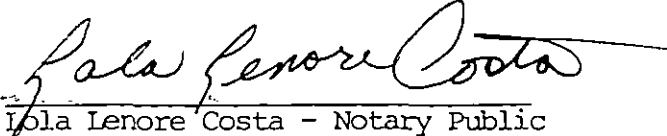
Lola Lenore Costa - Notary Public

My Commission expires 11-21-88.

JUN 22 1988