

15-119-00106-0000

STATE OF KANSAS
STATE CORPORATION COMMISSION

Give All Information Completely
Make Required Affidavit
Mail or Deliver Report to:
Conservation Division
State Corporation Commission
211 No. Broadway
Wichita, Kansas

WELL PLUGGING RECORD

NORTH

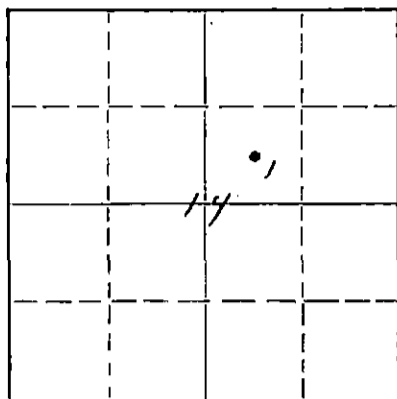

Locate well correctly on above
Section Plat

Meade County, Sec. 14, Twp. 33S, Rge. (E) 28 (W)
Location as "NE/CNW/SW" or footage from lines C SW/4 NE/4
Lease Owner Skelly Oil Company
Lease Name Isaac "A" Well No. 1
Office Address Box 1650, Tulsa, Oklahoma
Character of Well (completed as Oil, Gas or Dry Hole) Dry Hole
Date well completed June 30, 1959
Application for plugging filed July 1, 1959
Application for plugging approved July 2, 1959
Plugging commenced July 1, 1959
Plugging completed July 2, 1959
Reason for abandonment of well or producing formation Dry Hole

If a producing well is abandoned, date of last production 19
Was permission obtained from the Conservation Division or its agents before plugging was commenced? Yes

Name of Conservation Agent who supervised plugging of this well Mr. Merle A. Rives
Producing formation None Depth to top Bottom Total Depth of Well 5950 Feet
Show depth and thickness of all water, oil and gas formations.

OIL, GAS OR WATER RECORDS

CASING RECORD

FORMATION	CONTENT	FROM	TO	OD SIZE	PUT IN	PULLED OUT
Chester	Dry	5807'	5950'	8-5/8"	1398' 10"	None

Describe in detail the manner in which the well was plugged, indicating where the mud fluid was placed and the method or methods used in introducing it into the hole. If cement or other plugs were used, state the character of same and depth placed, from feet to feet for each plug set.

Heavy mud	5950' to 600'
Rubber plug	600'
30 sacks of cement	600' to 503'
Heavy mud	503' to 30'
Rubber plug	30'
23 sacks of cement	30' to 6'
Surface soil	6' to 0'

RECEIVED
STATE CORPORATION COMMISSION
SEP 24 1959
CONSERVATION DIVISION
Wichita, Kansas

(If additional description is necessary, use BACK of this sheet)
Name of Plugging Contractor Claude Wentworth Drilling Co., Inc.
Address 2701 East 15th, Tulsa, Oklahoma

STATE OF Kansas, COUNTY OF Reno, ss.
H. E. Wamsley (employee of owner) of the above-described well, being first duly sworn on oath, says: That I have knowledge of the facts, statements, and matters herein contained and the log of the above-described well as filed and that the same are true and correct. So help me God.

(Signature) [Signature]
Box 391, Hutchinson, Kansas
(Address)

SUBSCRIBED AND SWORN TO before me this 23rd day of September, 1959

My commission expires April 7, 1963

[Signature] Notary Public.

PLUGGING
FILE SEC. 14 T. 33 R. 28
BOOK PAGE 48 LINE 34

15-119-00106-000

SKELLY OIL COMPANY

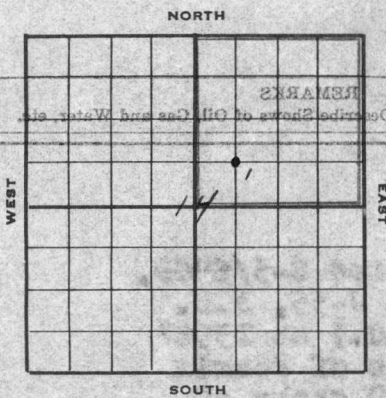

Well Record

Lease Name and No. Isaac "A" Well No. 1 Elev. 2511' DF
2504' CR

Lease Description NE/4 of Section 14-33S-28W, Meade
County, Kansas (160 Acres)

Location made May 26, 19 59 by W. C. Wilson

feet from North line _____ feet from East line NE/4
 feet from South line 660 feet from West line of Sec. 14

Work com'd. 6/2 19 59 Rig comp'd. 6/4 19 59 Drlg. com'd. 6/4 19 59 Drlg. comp'd. 6/30 19 59

Rig Contractor Claude Wentworth Drilling Co., Inc.

Drilling Contractor Claude Wentworth Drilling Co., Inc., Tulsa, Oklahoma

Rotary Drilling from 0' to 5950' Cable Tool Drilling from _____ to _____

Commenced Producing DRY HOLE 19 _____

Initial Prod. before shot or acid _____ Bbls.
 Initial Prod. after shot or acid _____ Bbls.

Dry Gas Well Press. _____ Volume _____ Cu. ft.

Casing Head Gas Pressure _____ Volume _____ Cu. ft.

Braden Head (_____ Size) Gas Pressure _____ Volume _____ Cu. ft.

Braden Head (_____ Size) Gas Pressure _____ Volume _____ Cu. ft.

PRODUCING FORMATION DRY HOLE Top _____ Bottom _____ TOTAL DEPTH 5950'
 (Name)

CASING RECORD

OD Size	Wt.	Thds.	Where Set	PULLED OUT			LEFT IN LTM			KIND	Cond'n	CEMENTING	
				Jts.	Feet	In.	Jts.	Feet	In.			Sacks Used	Method Employed
<u>8-5/8"</u>	<u>24.8R</u>	<u>1398'</u>					<u>42</u>	<u>1387</u>	<u>0</u>	<u>J55 R2 SS A</u>	<u>900</u>	<u>Hallib. 1398'10"</u>	
<u>(8-5/8" casing set 11' below derrick floor)</u>													

RECEIVED
 STATE COMMISSION
 SEP 24 1959
 CONSERVATION DIVISION
 Wichita, Kansas

Liner Set at _____ Length _____ Perforated at _____

Liner Set at _____ Length _____ Perforated at _____

Packer Set at _____ Size and Kind _____

Packer Set at _____ Size and Kind _____

SHOT OR ACID TREATMENT RECORD

	FIRST		SECOND		THIRD		FOURTH	
Date								
Acid Used								
Size Shot								
Shot Between	Ft. and	Ft.	Ft. and	Ft.	Ft. and	Ft.	Ft. and	Ft.
Size of Shell								
Put in by (Co.)								
Length anchor								
Distance below Cas'g								
Damage to Casing or Casing Shoulder								

SIGNIFICANT GEOLOGICAL FORMATIONS

NAME	Top	Bottom	GAS		OIL		REMARKS
			From	To	From	To	
<u>Council Grove</u>	<u>3075'</u>						
<u>Heebner Shale</u>	<u>4476'</u>						
<u>Lansing Linc</u>	<u>4652'</u>						
<u>Marmaton Linc</u>	<u>5268'</u>						
<u>Cherokee</u>	<u>5456'</u>						
<u>Morrow Shale</u>	<u>5750'</u>						
<u>Morrow Sand</u>	<u>5765'</u>						
<u>Chester</u>	<u>5807'</u>						

CLEANING OUT RECORDS

	DATE COMMENCED	DATE COMPLETED	PROD. BEFORE	PROD. AFTER	REMARKS
1st					See Reverse for other details.
2nd					" " " " "
3rd					" " " " "
4th					" " " " "

PLUGGING BACK AND DEEPENING RECORDS

	Date Commenced	Date Completed	No. Feet Plugged Back or Deepened	Prod. Before	Prod. After	REMARKS
1st						See Reverse for other details.
2nd						" " " " "
3rd						" " " " "
4th						" " " " "

(See Reverse for Record of Formation)

100-20100-111-1

RECORD OF FORMATIONS

FORMATION	TOP	BOTTOM	REMARKS
Clay and red bed	0	440	Set and cemented 8-5/8" OD, 24#, 8R, R-2, J-55, S.S. casing (A cond.) at 1398' with 600 sacks of Pozmix cement and 300 sacks of common cement with 2% calcium chloride. Cement circulated.
Shale	440	1124	
Red bed	1124	1399	
Shale	1399	1510	TOP COUNCIL GROVE 3075' Ran Halliburton drill stem test No. 1, packer set at 3064', used 26" anchor, open 1 hour, fair blow for 10 mins. decreasing to weak blow at end of test, recovered 20" drilling mud, IBHP-150# in 20 minutes, IFF-35#, FFP-35#, FBHP-130# 20 minutes.
Shale and lime	1510	1783	
Shale and shells	1783	1975	
Shale with lime streaks	1975	2280	
Lime	2280	2444	
Lime and shale	2444	2664	
Lime	2664	2856	
Sand and lime	2856	3001	
Shale	3001	3015	
Shale and lime	3015	3090	

FORMATION	TOP	BOTTOM	REMARKS
Shale	3090	3218	TOP HEYNER SHALE 4476' TOP LANSING LIME 4652' TOP MARMATON LIME 5268' TOP CHEROKEE 5456' TOP MORROW SHALE 5750' TOP MORROW SAND 5765'
Gray lime	3218	3285	
Shale, lime, and chalk	3285	3655	
Lime and shale	3655	4228	
Shale	4228	4410	
Shale and lime	4410	5033	
Lime	5033	5593	
Lime and shale	5593	5696	
Shale, lime and chert	5696	5726	
Lime and shale	5726	5765	

Sored from 5765' to 5788' - Recovered 23'
 Top 8' - Sand, very fine grained, very limy, slightly re-worked with black shale, poor porosity and permeability
 Last 15' - Shale, black

FORMATION	TOP	BOTTOM	REMARKS
Lime and shale	5788	5853	Ran Halliburton drill stem test No. 2, packer set at 5723', used 65" anchor, open 30 minutes, very weak blow for 2 minutes, then quit, recovered 20" drilling mud, IBHP-151# in 20 mins., IFF-51#, FFP-51#, FBHP-70# in 20 minutes. TOP CHESTER 5807'

FORMATION	TOP	BOTTOM	REMARKS
Shale and lime	5853	5950	Ran Halliburton drill stem test No. 3, packer set at 5771', used 82" anchor, open 35 minutes, very weak blow for 5 minutes, recovered 25" drilling mud, IBHP-373# in 20 minutes, IFF-84#, FFP-84#, FBHP-108# in 20 minutes. Ran Schlumberger Survey

FORMATION	TOP	BOTTOM	REMARKS
Shale and lime	5950	5950	Ran Halliburton drill stem test No. 4, packer set at 5846', used 104" anchor, open 30 mins., very weak blow for 5 minutes, then quit, recovered 20" drilling mud, IBHP-373# in 20 mins., IFF-85#, FFP-85#, FBHP-102# in 20 minutes.

TOTAL DEPTH 5950'

Total Depth Reached: 6/30/59

FORMATION	TOP	BOTTOM	REMARKS

As there were no commercial shows of either oil or gas found in drilling to 5950', regular authority was granted to plug the well as follows:

Heavy mud	5950'	to	600'
Rubber plug			600'
30 sacks of cement	600'	to	503'
Heavy mud	503'	to	30'
Rubber plug			30'
23 sacks of cement	30'	to	6'
Surface soil	6'	to	0'

Plugged and abandoned July 2, 1959.

<u>SLOPE TEST DATA</u>	
<u>DEPTH</u>	<u>ANGLE OF DEFLECTION</u>
280'	0 Degrees
500'	0 "
750'	1/4 "
1250'	1/2 "
1825'	1/2 "
2075'	1/2 "
2970'	1/2 "
2981'	1/2 "
3816'	1 "
4106'	1 "
4410'	3/4 "
4661'	3/4 "
4958'	1/2 "
5340'	3/4 "
5538'	1/2 "

RECEIVED
STATE CORPORATION COMMISSION

SEP 24 1959

CONSERVATION DIVISION
Wichita, Kansas

BOOK PAGE TIME
DATE SEC'S PER 1959
BY: [signature]

PLUGGING
FILE SEC. 14 T. 33 R. 28 W
BOOK PAGE 48 LINE 34

Michigan Conservation Commission

MICHIGAN
CONSERVATION DIVISION
SEP 24 1928
STATE CORPORATION COMMISSION
RECEIVED

Michigan Conservation Commission

Faint, illegible text at the bottom of the page, possibly bleed-through from the reverse side.