

STATE CORPORATION COMMISSION OF KANSAS  
OIL & GAS CONSERVATION DIVISION  
WELL COMPLETION FORM  
ACO-1 WELL HISTORY  
DESCRIPTION OF WELL AND LEASE

Operator: License # 4549

Name: ANADARKO PETROLEUM CORPORATION

Address P. O. BOX 351

**ORIGINAL**

City/State/Zip LIBERAL, KANSAS 67905-0351

Purchaser: CIMARRON RIVER SYSTEM

Operator Contact Person: J. L. ASHTON

Phone (316) 624-6253

Contractor: Name: NA

License: NA

Wellsite Geologist: NA

Designate Type of Completion  
 New Well  Re-Entry  Workover

Oil  SWD  SIOW  Temp. Abd.  
 Gas  ENHR  SIGW  
 Dry  Other (Core, WSW, Expl., Cathodic, etc)

If Workover:

Operator: ANADARKO PETROLEUM CORPORATION

Well Name: LOW "D" NO. 6

Comp. Date 10/5/81 Old Total Depth 5825

**CEMENT SQUEEZE**  
Deepening  Re-perf.  Conv. to Inj/SWD  
 Plug Back 5550 PBTB  
 Commingled  Docket No. \_\_\_\_\_  
 Dual Completion  Docket No. \_\_\_\_\_  
 Other (SWD or Inj?)  Docket No. \_\_\_\_\_

1/31/95 NA 4/9/95  
~~Start~~ Date OF START Date Reached TD Completion Date OF WORKOVER

API NO. 15- 129-20,530-0001

County MORTON

- S/2 - NE - SE Sec. 18 Twp. 33S Rge. 40 E  
X W

1650 Feet from  X (circle one) Line of Section

660 Feet from  X (circle one) Line of Section

Footages Calculated from Nearest Outside Section Corner:  
NE,  SE, NW or SW (circle one)

Lease Name LOW "D" Well # 6

Field Name CIMARRON VALLEY

Producing Formation LOWER MORROW "F" AND "G"

Elevation: Ground 3266 KB 3270

Total Depth 5825 PBTB 5550

Amount of Surface Pipe Set and Cemented at 1484 Feet

Multiple Stage Cementing Collar Used?  Yes  No

If yes, show depth set \_\_\_\_\_ Feet

If Alternate II completion, cement circulated from \_\_\_\_\_

feet depth to \_\_\_\_\_ w/ \_\_\_\_\_ sx cmt.

Drilling Fluid Management Plan REWORK 9/12-20-95  
(Data must be collected from the Reserve Pit)

NOT APPLICABLE

Chloride content \_\_\_\_\_ ppm Fluid volume \_\_\_\_\_ bbls

Dewatering method used \_\_\_\_\_

Location of fluid disposal if hauled offsite: \_\_\_\_\_

Operator Name \_\_\_\_\_

Lease Name \_\_\_\_\_ License No. \_\_\_\_\_

\_\_\_\_\_ Quarter Sec. \_\_\_\_\_ Twp. \_\_\_\_\_ S Rng. \_\_\_\_\_ E/W

County \_\_\_\_\_ Docket No. \_\_\_\_\_

INSTRUCTIONS: An original and two copies of this form shall be filed with the Kansas Corporation Commission, 130 S. Market - Room 2078, Wichita, Kansas 67202, within 120 days of the spud date, recompletion, workover or conversion of a well. Rule 82-3-130, 82-3-106 and 82-3-107 apply. Information on side two of this form will be held confidential for a period of 12 months if requested in writing and submitted with the form (see rule 82-3-107 for confidentiality in excess of 12 months). One copy of all wireline logs and geologist well report shall be attached with this form. ALL CEMENTING TICKETS MUST BE ATTACHED. Submit CP-4 form with all plugged wells. Submit CP-111 form with all temporarily abandoned wells.

All requirements of the statutes, rules and regulations promulgated to regulate the oil and gas industry have been fully complied with and the statements herein are complete and correct to the best of my knowledge.

Signature Leslie I. Barnes  
LESLIE I. BARNES  
Title SENIOR TECHNICAL ASSISTANT Date 4/25/95

Subscribed and sworn to before me this 25 day of April,  
19 95.

Notary Public Cheryl Steers

Date Commission Expires \_\_\_\_\_



K.C.C. OFFICE USE ONLY  
F  Letter of Confidentiality Attached  
C  Wireline Log Received  
C  Geologist Report Received  
  
Distribution  
 KCC  SWD/Rep  NGPA  
 KGS  Plug  Other  
(Specify)

RECEIVED  
Form ACO-1 (7/82) CORPORATION COMMISSION

MAY 01 1995  
5-1-95  
CONSERVATION DIVISION

Operator Name ANADARKO PETROLEUM CORPORATION Lease Name LOW "D" Well # 6

Sec. 18 Twp. 33S Rge. 40  East  West County MORTON

INSTRUCTIONS: Show important tops and base of formations penetrated. Detail all cores. Report all drill stem tests giving interval tested, time tool open and closed, flowing and shut-in pressures, whether shut-in pressure reached static level, hydrostatic pressures, bottom hole temperature, fluid recovery, and flow rates if gas to surface during test. Attach extra sheet if more space is needed. Attach copy of log.

Drill Stem Tests Taken  Yes  No  
 (Attach Additional Sheets.)  
 Samples Sent to Geological Survey  Yes  No  
 Cores Taken  Yes  No  
 Electric Log Run  Yes  No  
 (Submit Copy.)  
 List All E.Logs Run:

Log Formation (Top), Depth and Datums  Sample  
 Name Top Datum  
 SEE ORIGINAL DRILLER'S LOG (ATTACHED)

CASING RECORD <input type="checkbox"/> New <input type="checkbox"/> Used				ORIGINAL COMPLETION			
Report all strings set-conductor, surface, intermediate, production, etc.							
Purpose of String	Size Hole Drilled	Size Casing Set (In O.D.)	Weight Lbs./Ft.	Setting Depth	Type of Cement	# Sacks Used	Type and Percent Additives
SURFACE	12 1/4	8 5/8	24	1484	POZMIX/COMMON	550/200	4%GEL, 2%CC/2%CC
PRODUCTION	7 7/8	5 1/2	15.5	5824	LW/SS POZMIX	100/150	.5% CFR-2/ .5% CFR-2

ADDITIONAL CEMENTING/SQUEEZE RECORD				
Purpose:	Depth Top Bottom	Type of Cement	#Sacks Used	Type and Percent Additives
<input checked="" type="checkbox"/> Perforate <input checked="" type="checkbox"/> Protect Casing <input type="checkbox"/> Plug Back TD <input type="checkbox"/> Plug Off Zone	2782.7-2783.9	Class C	40	None

Shots Per Foot	PERFORATION RECORD - Bridge Plugs Set/Type Specify Footage of Each Interval Perforated	Acid, Fracture, Shot, Cement Squeeze Record (Amount and Kind of Material Used)	Depth
	2	CIBP SET @ 5650' 5232 - 5384, 5398 - 5430	NA ACIDIZE IN 2' INTERVALS, 42 STEPS W/200 GAL 15% FEHCL PER SETTING(100 GAL/FT), TOTAL ACID = 8400 GAL SET CMT RETR @ 5390', FRAC W/38,000 GAL 35# BORAGEL & 171,000# 16/30 SAND, FLUSH W/1950 GAL GELLED 2% KCL WTR
	DO CMT RETR @ 5390, CO TO 5650, CO SAND 5500-5550		

TUBING RECORD	Size	Set At	Packer At	Liner Run <input type="checkbox"/> Yes <input checked="" type="checkbox"/> No
	2-7/8	5423		
Date of First, Resumed Production, SWD or Inj.	Producing Method <input checked="" type="checkbox"/> Flowing <input type="checkbox"/> Pumping <input type="checkbox"/> Gas Lift <input type="checkbox"/> Other (Explain)			
4/5/95				
Estimated Production Per 24 Hours	Oil Bbls. --	Gas Mcf 226	Water Bbls. 58	Gas-Oil Ratio -- Gravity --

Disposition of Gas:  Vented  Sold  Used on Lease (If vented, submit ACO-18.)  
 METHOD OF COMPLETION:  Open Hole  Perf.  Dually Comp.  Commingled 5332-5430 OA  
 Other (Specify) \_\_\_\_\_

KANSAS

WELL COMPLETION REPORT AND  
DRILLER'S LOG

ORIGINAL

S. 18 T. 33 R. 40 W

Loc. 660' FEL & 1650' FSL

County Morton

API No. 15 — 129 — 20,530  
County Number

Operator  
Anadarko Production Company

Address  
P.O. Box 351, Liberal, Kansas 67901

Well No. 6 Lease Name Low "D"

Footage Location  
1650 feet from (N) (S) line 660 feet from (E) (W) line

Principal Contractor Gabbart-Jones Geologist Jim Druyff

Spud Date 7/28/81 Date Completed 10/5/81 Total Depth 5825' P.B.T.D. 5761'

Directional Deviation Not Applicable Oil and/or Gas Purchaser Permian Corporation

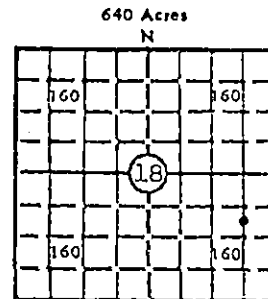

Elev.: Gr. 3266

DF 3269 KB 3270

CASING RECORD

Report of all strings set — surface, intermediates, production, etc.

Purpose of string	Size hole drilled	Size casing set (in O.D.)	Weight lbs/ft.	Setting depth	Type cement	Sacks	Type and percent additives
Surface	12-1/4	8-5/8	24#	1484	Poz Common	550 200	4% gel 2% CC 2% CC
Production	7-7/8	5-1/2	15.5#	5824	LW SS Poz.	100 150	.5% CFR-2 .5% CFR-2

LINER RECORD

PERFORATION RECORD

Top, ft.	Bottom, ft.	Sacks cement	Shots per ft.	Size & type	Depth interval
			2	.41	5674-80'

Size	Setting depth	Packer set at
2-7/8	5671	---

ACID, FRACTURE, SHOT, CEMENT SQUEEZE RECORD

Amount and kind of material used	Depth interval treated
None	

INITIAL PRODUCTION

Date of first production 9/9/81	Producing method (flowing, pumping, gas lift, etc.) Pumping
RATE OF PRODUCTION PER 24 HOURS	Oil 14 bbls. Gas 3.3 MCF Water 266 bbls. Gas-oil ratio 236 CFPB
Disposition of gas (vented, used on lease or sold) Used on lease	Producing interval (s) 5674-80'

RECEIVED  
STATE CORPORATION COMMISSION

MAY 01 1995

WICHITA-KANSAS

INSTRUCTIONS: As provided in KCC Rufe 82-2-125, within 90 days after completion of a well, one completed copy of this Drillers Log shall be transmitted to the State Geological Survey of Kansas, 4150 Monroe Street, Wichita, Kansas 67209. Copies of this form are available from the Conservation Division, State Corporation Commission, 245 No. Water, Wichita, Kansas 67202. Phone AC 316-522-2206. If confidential custody is desired, please note Rule 82-2-125. Drillers Logs will be on an open file in the Oil and Gas Division, State Geological Survey of Kansas, Lawrence, Kansas 66044.

Operator  
Anadarko Production Company

DESIGNATE TYPE OF COMP.: OIL, GAS, DRY HOLE, SWDW, ETC.:  
Oil

Well No. 6 Lease Name Low "D"

S 18 T 33 R 40 <sup>X</sup> W

**WELL LOG**

Show all important zones of porosity and contents thereof; cored intervals, and all drill-stem tests, including depth interval tested, cushion used, time tool open, flowing and shut-in pressures, and recoveries.

SHOW GEOLOGICAL MARKERS, LOGS RUN, OR OTHER DESCRIPTIVE INFORMATION.

FORMATION DESCRIPTION, CONTENTS, ETC.	TOP	BOTTOM	NAME	DEPTH
Sand	0	356		
Sand-Shale	356	941		
Shale-Redbed	941	1485		
Shale	1485	2423		
Shale-Lime	2423	3043		
Lime-Shale	3043	3387		
Shale-Lime	3387	3506		
Lime-Shale	3506	4225		
Shale-Lime	4225	4335		
Lime-Shale	4335	4554		
Shale-Lime	4554	4620		
Lime-Shale	4620	5121		
Lime-Shale-Sand	5121	5172		
Lime-Shale	5172	5380		
Shale-Lime	5380	5510		
Lime-Shale	5510	5588		
Shale-Lime	5588	5701		
Lime-Shale	5701	5825		
TD		5828		

DST #1 5005-5172 (Morrow) 30-60-60-120, Cp w/wk to gd blow thruout. No gas to surface  
Rec'd 135 DM, IFP 117-127, ISIP 284 (60), FFP 133-150, FSIP 404 (120).

USE ADDITIONAL SHEETS, IF NECESSARY, TO COMPLETE WELL RECORD.

Date Received

*Paul Campbell*  
Paul Campbell Signature  
Division Operations Manager Title  
October 21, 1981 Date

CUSTOMER: Pac-Lite PT  
WELL NO.: 6  
JOB TYPE: Hunt hole, Squeeze  
DATE: 2-1-95

WELL DATA

FIELD \_\_\_\_\_ SEC 18 TWP. 33s RNC. 40w COUNTY Marion STATE Ks

FORMATION NAME \_\_\_\_\_ TYPE \_\_\_\_\_

FORMATION THICKNESS \_\_\_\_\_ FROM \_\_\_\_\_ TO \_\_\_\_\_

INITIAL PROD. OIL \_\_\_\_\_ BPD. WATER \_\_\_\_\_ BPD. GAS \_\_\_\_\_ MCFD

PRESENT PROD. OIL \_\_\_\_\_ BPD. WATER \_\_\_\_\_ BPD. GAS \_\_\_\_\_ MCFD

COMPLETION DATE \_\_\_\_\_ MUD TYPE \_\_\_\_\_ MUD WT. \_\_\_\_\_

PACKER TYPE \_\_\_\_\_ SET AT \_\_\_\_\_

BOTTOM HOLE TEMP. \_\_\_\_\_ PRESSURE \_\_\_\_\_

MISC. DATA \_\_\_\_\_ TOTAL DEPTH \_\_\_\_\_

	NEW USED	WEIGHT	SIZE	FROM	TO	MAXIMUM PSI ALLOWABLE
CASING	U	15.5	5 1/2	B.L.		
LINER						
TUBING	U	6.5	2 3/4	C.L.		
OPEN HOLE						SHOTS/FT.
PERFORATIONS						
PERFORATIONS						
PERFORATIONS						

ORIGINAL

JOB DATA

CALLED OUT	ON LOCATION	JOB STARTED	JOB COMPLETED
DATE <u>2-1-95</u>	DATE <u>2-1-95</u>	DATE <u>2-1-95</u>	DATE <u>2-2-95</u>
TIME <u>19:30</u>	TIME <u>15:00</u>	TIME <u>15:45</u>	TIME <u>21:31</u>

PERSONNEL AND SERVICE UNITS

NAME	UNIT NO. & TYPE	LOCATION
<u>R. Tyler</u>	<u>04030</u>	<u>Liberal</u>
<u>R. Crist</u>	<u>07653</u>	<u>Liberal</u>
<u>R. Martinez</u>	<u>52947</u>	<u>Liberal</u>
<u>Patrick Roome</u>	<u>G.2731</u> <u>50737</u>	<u>Liberal</u> <u>Hungate</u>
<u>G.9614</u>	<u>75505</u>	

DEPARTMENT Tools

DESCRIPTION OF JOB Hunt hole, Squeeze

JOB DONE THRU: TUBING  CASING  ANNULUS  TBG/ANN

CUSTOMER REPRESENTATIVE X R. Taylor

HALLIBURTON OPERATOR R. Taylor COPIES REQUESTED 2

CEMENT DATA

STAGE	NUMBER OF SACKS	CEMENT	BRAND	BULK SACKED	ADDITIVES	YIELD CU.FT./SK.	MIXED LBS./GAL.
	<u>40</u>	<u>C</u>			<u>Neat</u>	<u>1.32</u>	<u>14.8</u>

PRESSURES IN PSI

SUMMARY

VOLUMES

CIRCULATING \_\_\_\_\_ DISPLACEMENT \_\_\_\_\_

BREAKDOWN \_\_\_\_\_ MAXIMUM \_\_\_\_\_

AVERAGE \_\_\_\_\_ FRACTURE GRADIENT \_\_\_\_\_

SHUT-IN INSTANT \_\_\_\_\_ 5-MIN \_\_\_\_\_ 15-MIN \_\_\_\_\_

HYDRAULIC HORSEPOWER \_\_\_\_\_

ORDERED \_\_\_\_\_ AVAILABLE \_\_\_\_\_ USED \_\_\_\_\_

AVERAGE RATES IN BPM \_\_\_\_\_

TREATING \_\_\_\_\_ DISPL. \_\_\_\_\_ OVERALL \_\_\_\_\_

CEMENT LEFT IN PIPE \_\_\_\_\_

FEET 420 REASON Block squeeze

PRESLUSH: BBL-GAL \_\_\_\_\_ TYPE \_\_\_\_\_

LOAD & EXON: BBL-GAL \_\_\_\_\_ PAD: BBL-GAL \_\_\_\_\_

TREATMENT: BBL-GAL \_\_\_\_\_ DISPL: BBL-GAL \_\_\_\_\_

CEMENT SLURRY: BBL-GAL 10.00

TOTAL VOLUME: BBL-GAL \_\_\_\_\_

REMARKS See Job log  
2-2-95 Job Start p.800  
2130 on 2-2-95

RECEIVED Job End  
MAY 9 1995



JOB LOG HAL-2013-C

DATE: 2-1-95 PAGE NO. 1  
 TICKET NO. 700013  
 705842

CHART NO.	TIME	RATE (BPM)	VOLUME (BBL) (GAL)	PUMPS		PRESSURE (PSI)		DESCRIPTION OF OPERATION AND MATERIALS
				T	C	TUBING	CASING	
	12:20							Called Out ORIGINAL
	15:30							On location
								Pick up BU Tension Packer, S.N., 8 Sub
	15:45							T.I.H w/ 2 3/4" Tubing
	17:00							Shut down
2-2-95	05:00							Called Out
	07:00							ON location
	08:00							T.I.H
	08:50							Set PK @ 2963 on 94 sts
	09:04		5			1000		Pressure Test, hold
	09:15							Pull 18 sts @ 2399.93 on 76 sts
	09:45		4			100%		Pressure Test, leak
	09:46					500		bled off
	09:50							hunt hole
	10:40							Found hole between 2806 (87 sts) & 2924 (88 sts)
	10:50							Pull out at hole looking for leak
	12:10					1000		Load Annular & Pressure Test (Hold)
	12:15							Shut down w.o.w.
	13:15							T.I.H, isolate hole, exact depth
	14:15							Found hole @ 2983.47 88st + 9'
	14:30							T.I.H
	15:15							O.O.H w/ PK & Tubing
	15:20							Swab casing to 2869'
	16:39							Hook Iron To Well Head w/QCC
	17:04							mix 40 SKS class cement
	17:09	2	10	FR		0		Pump Cement down casing
	17:19							Shut Down wash Pumps & Lines
	17:22	1 1/2	50			0		Start Disp on vacuum
	17:55							Shut Down get more water
	18:00	1/2	5			0		Disp Back on vacuum
	18:10	1/4	2	(5)		0-1000		Pressure up
	18:15							Knock loose to stop leak
	18:21	3/4	3/4			0-1000		Pressure up
	18:22			(5)				Try to fix leak
	18:40		1/8	(5)		0-100		Pressure up

RECEIVED STATE CORPORATION COMMISSION

MAY 1 1995



JOB LOG HAL-2013-C

CHART NO.	TIME	RATE (BPM)	VOLUME (BBL) (GAL)	PUMPS		PRESSURE (PSI)		DESCRIPTION OF OPERATION AND MATERIALS
				T	C	TUBING	CASING	
								High Water Squeeze 706013
	1840		1/4					100-400 Pressure Leaked To 400 PSI
	1851		1/8					400-1000+ Pressured up well head leak
	1855		1/8					400-1000+ Pressured up "
	1902		1/8					100-1000+ Pressured up "
	1907		1/8		5874			400-1000+ Pressured up "
	1917		1/4		52			350-1000+ Pressured up 21
	1920		1/4					750-1000+ Pressured up 41
	1922		1/8					750-1000+ Pressured up "
	1926		1/8					750-1000+ Pressured up "
	1930		1/4					400-1000+ Pressured up "
	1931		1/8					900-1000+ Pressured up "
	1932		1/8		(60)			700-1000+ Pressured up "
	1933							Released pressure & Tagged CMI
	1947							AT 2470'
	1947							Called for another 8 3/8 To
								5 1/2" Adapter
	2100							Terry Lewis Here with Adapter
	2110							0-1000+ Pressured up
	2112							800-1000 Pressured up
	2124							Job End
								Thank you for calling
								Halliburton Energy Service

ORIGINAL

RECEIVED  
STATE CORPORATION COMMISSION  
MAY 3 1995