

STATE CORPORATION COMMISSION OF KANSAS  
OIL & GAS CONSERVATION DIVISION

WELL COMPLETION OR RECOMPLETION FORM  
ACO-1 WELL HISTORY

DESCRIPTION OF WELL AND LEASE

Operator: License # 5447  
Name Cities Service Oil & Gas Corp.  
Address 3545 N.W. 58th Street  
Okla. City, Okla. 73112

Purchaser: CITGO Petroleum  
REPL

Operator Contact Person Raymond Hui  
Phone (405) 949-4400

Contractor: License # 5141  
Name Zentih Drilling, Inc.

Wellsite Geologist  
Phone

Designate Type of Completion  
 New Well  Re-Entry  Workover  
 Oil  SWD  Temp Abd  
 Gas  Inj  Delayed Comp.  
 Dry  Other (Core, Water Supply etc.)

If OWWO: old well info as follows:  
Operator  
Well Name  
Comp. Date Old Total Depth

WELL HISTORY

Drilling Method:  
 Mud Rotary  Air Rotary  Cable  
12-4-85 12-15-85 1-31-86  
Spud Date Date Reached TD Completion Date  
6300' 6258'  
Total Depth PBDT

Amount of Surface Pipe Set and Cemented at 1684 feet  
Multiple Stage Cementing Collar Used?  Yes  No  
If yes, show depth set...feet  
if alternate 2 completion, cement circulated  
from...feet depth to...w/...SX cmt

API NO. 15-175-20885-0000

County Seward  
C.N/2.S.W. SE... Sec. 28.. Twp. 32S. Rge. 34.  East  West

990 Ft North from Southeast Corner of Section  
1980 Ft West from Southeast Corner of Section  
(Note: Locate well in section plat below)

Lease Name Hitch "O" Well # 2

Field Name Holt

Producing Formation Basal Chester SS

Elevation: Ground 2907' KB 2918'

Section Plat

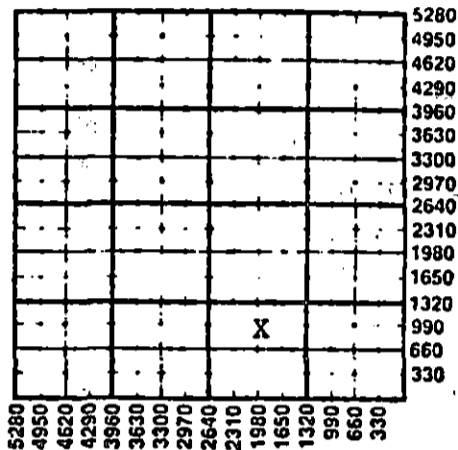

WATER SUPPLY INFORMATION

Disposition of Produced Water:  Disposal  Repressuring  
Docket #

Questions on this portion of the ACO-1 call:  
Water Resources Board (913) 296-3717

Source of Water:  
Division of Water Resources Permit #  
 Groundwater...Ft North from Southeast Corner (Well) ...Ft West from Southeast Corner of Sec Twp Rge  East  West  
 Surface Water...Ft North from Southeast Corner (Stream, pond etc.)...Ft West from Southeast Corner Sec Twp Rge  East  West  
 Other (explain) (purchased from city, R.W.D. #)

INSTRUCTIONS: This form shall be completed in duplicate and filed with the Kansas Corporation Commission, 200 Colorado Derby Building, Wichita, Kansas 67202, within 90 days after completion or recompletion of any well. Rule 82-3-130 and 82-3-107 apply. Information on side two of this form will be held confidential for a period of 12 months if requested in writing and submitted with the form. See rule 82-3-107 for confidentiality in excess of 12 months. One copy of all wireline logs and drillers time log shall be attached with this form. Submit CP-4 form with all plugged wells. Submit CP-111 form with all temporarily abandoned wells.

All requirements of the statutes, rules and regulations promulgated to regulate the oil and gas industry have been fully complied with and the statements hereon are complete and correct to the best of my knowledge.

Signature Del G. Oliver  
Title Engineering Manager Date 2-7-86

Subscribed and sworn to before me this 7th day of February 1986  
Notary Public Teresa Jo Howell  
Date Commission Expires 4-29-89

K.C.C. OFFICE USE ONLY  
 Letter of Confidentiality Attached  
 Wireline Log Received  
 Drillers Time Log Received  
Distribution  
 KCR  SWD/Rep  NGPA  
 KGS  Plug.  Other (Specify)

ver. 28 imp 5/82 34/0

PLAT AND CERTIFICATION OF ACREAGE ATTRIBUTABLE TO AN OIL WELL

State Corporation Commission, Conservation Division  
200 Colorado Derby Bldg. Wichita, Kansas 67202

OPERATOR Cities Service Oil & Gas Corporation LOCATION OF WELL:

LEASE Hitch "Q"

990 feet from the S line

1980 feet from the E line

WELL NUMBER 2

Of the SE of Sec 28 T.32S R.34W

FIELD Holt

COUNTY Seward

\*NUMBER OF ACRES  
ATTRIBUTABLE TO WELL 320

DESCRIPTION OF ACREAGE:

PLAT

(Show location of Well and outline attributable acreage)  
(Show footage to nearest lease or unit boundary line)

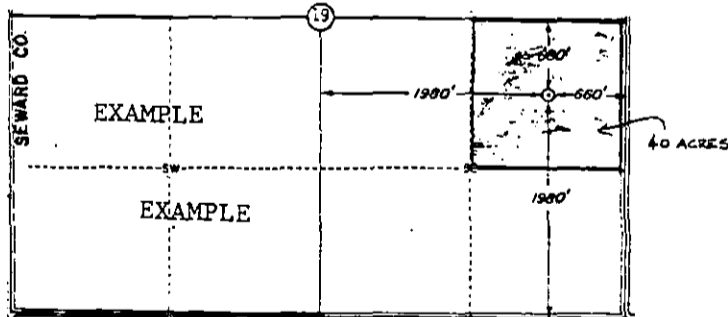
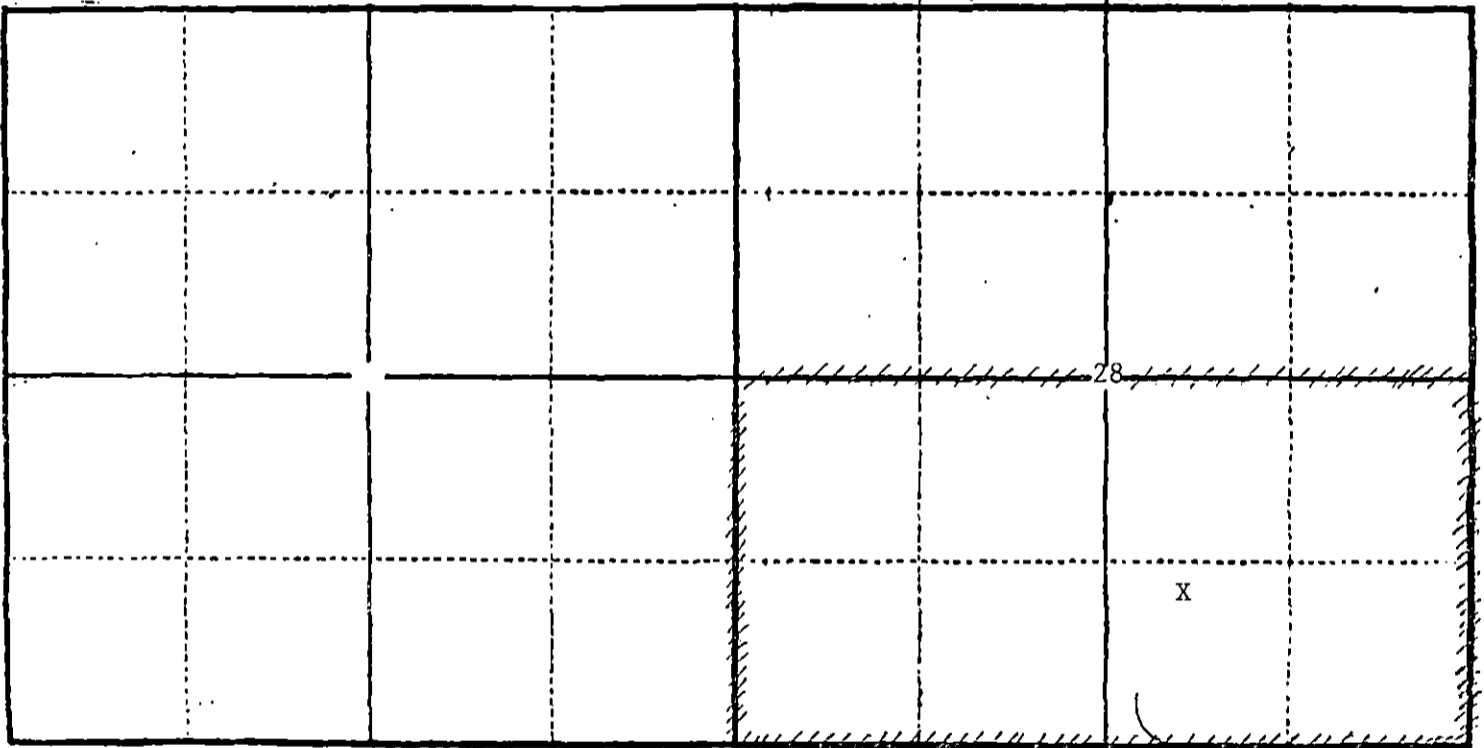

The undersigned hereby certifies that he is Del G. Oliver for Cities Service Oil & Gas Corp., a duly authorized agent, that all information shown hereon is true and correct to the best of his knowledge and belief, and that all acreage claimed as attributable to the well named herein is held by production from that well.

Delbert G. Oliver

Suscribed and sworn to before me on this 12<sup>th</sup> day of February, 1986.

Jeresa J. Powell

Notary Public  
RECEIVED  
STATE CORPORATION COMMISSION

My Commission expires 4-24-89

FEB 14 1986

CONSERVATION DIVISION  
Wichita, Kansas

SIDE TWO

Operator Name Cities Service Oil & Gas Corporation Lease Name Hitchcock Well # 2

Sec. 28 Twp. 32S Rge. 34  East  West County Seward

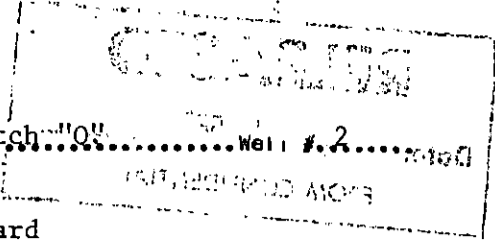

WELL LOG

INSTRUCTIONS: Show important tops and base of formations penetrated. Detail all cores. Report all drill stem tests giving interval tested, time tool open and closed, flowing and shut-in pressures, whether shut-in pressure reached static level, hydrostatic pressures, bottom hole temperature, fluid recovery, and flow rates if gas to surface during test. Attach extra sheet if more space is needed. Attach copy of log.

Drill Stem Tests Taken  Yes  No  
 Samples Sent to Geological Survey  Yes  No  
 Cores Taken  Yes  No

Formation Description  
 Log  Sample

Ran DIL-SFL w/SP & GR, CNL-LDT W/GR & Caliper, Microlog W/GR.

Ran CBL/GR/CCL from PBTD 6239' KB to 5360' KB. Top of cement: 5540' KB

Name	Top	Bottom
Sand	0	40
Sand & Redbed	40	1400
Redbed	1400	1685
Anhydrite	1685	2180
Anhydrite & Shale	2180	3380
Anhydrite	3380	3910
Anhydrite & Shale	3910	4160
Dolomite	4160	4891
Lime & Shale	4891	6300
TD		6300
PBTD		6258

MAY 28 1987

FROM CONFIDENTIAL

CASING RECORD <input checked="" type="checkbox"/> New <input type="checkbox"/> Used							
Report all strings set-conductor, surface, intermediate, production, etc.							
Purpose of String	Size Hole Drilled	Size Casing Set (in O.D.)	Weight Lbs/Ft.	Setting Depth	Type of Cement	#Sacks Used	Type and Percent Additives
Conductor	32"	20"		41'	Redi Mix	4/yds.	
Surface	12-1/4"	8-5/8"	24#	1684'	Poz 65/35 Class H	650	2% CaCl
Production	7-7/8"	5-1/2"	15.5#	6299'	50/50 Poz	150	3% CaCl
PERFORATION RECORD				Acid, Fracture, Shot, Cement Squeeze Record			
Shots Per Foot Specify Footage of each Interval Perforated				(Amount and Kind of Material Used) Depth			
4 (12' : 48 holes) (6147-59)				3000 gal diesel			
				1500 gals diesel containing 10% WSA-1			
TUBING RECORD							
Size 2-3/8"		Set At 6165		Packer at		Liner Run <input type="checkbox"/> Yes <input checked="" type="checkbox"/> No	
Date of First Production 12-31-85		Producing Method <input type="checkbox"/> Flowing <input checked="" type="checkbox"/> Pumping <input type="checkbox"/> Gas Lift <input type="checkbox"/> Other (explain)					
Estimated Production Per 24 hours		Oil 105	Gas 37.6	Water 0	Gas-Oil Ratio	Gravity	
		Bbls	MCF	Bbls	CFPB		

METHOD OF COMPLETION

Production Interval

Disposition of gas:  Vented  Sold  Used on Lease  
 Open Hole  Perforation  Other (Specify) .....  
 Dually Completed  Cumminged

Basal Chester SS

6147-59'