

STATE CORPORATION COMMISSION OF KANSAS
OIL & GAS CONSERVATION DIVISION
WELL COMPLETION FORM
ACO-1 WELL HISTORY
DESCRIPTION OF WELL AND LEASE

API NO. 15- 129-20,993-00-00
County MORTON
SW NE NE Sec. 12 Twp. 33S Rge. 40 East X West

Operator: License # 4549

4030 Ft. North from Southeast Corner of Section

Name: Anadarko Petroleum Corp.

1250 Ft. West from Southeast Corner of Section
(NOTE: Locate well in section plat below.)

Address P.O. Box 351

Lease Name Campbell "B" Well # 1H

City/State/Zip Liberal, KS 67905-0351

Field Name Hugoton

Producing Formation Chase

Purchaser: Panhandle Eastern Pipeline Co.
(Transporter)

Elevation: Ground 3255 KB NA

Operator Contact Person: M. L Pease

Total Depth 2750 PBDT 2730

Phone (316) 624-6253

Contractor: Name: Gabbert-Jones, Inc.

License: 5842

Wellsite Geologist: NA

Designate Type of Completion
 New Well Re-Entry Workover

Oil SWD Temp. Abate
 Gas Inj Delayed Comp.
 Dry Other (Core, Water Supply, etc.)

If OAWD: old well info as follows:

Operator: _____

Well Name: _____

Comp. Date _____ Old Total Depth _____

Drilling Method:
 Mud Rotary Air Rotary Cable

7/7/89 7/9/89 10/25/89
Spud Date Date Reached TD Completion Date

RECEIVED
STATE CORPORATION COMMISSION
Wichita, Kansas
1-23-90

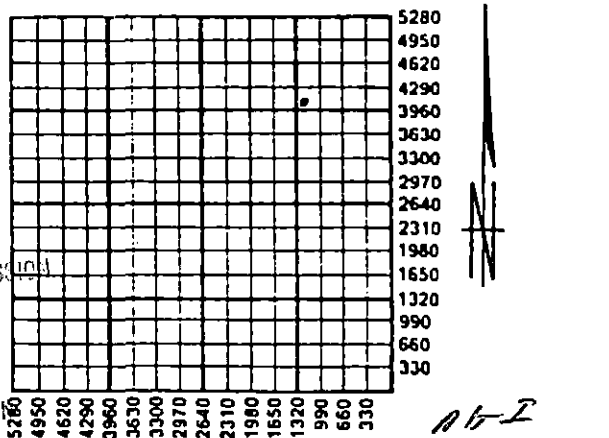

Amount of Surface Pipe Set and Cemented at 519 Feet

Multiple Stage Cementing Collar Used? Yes No

If yes, show depth set _____ Feet

If Alternate II completion, cement circulated from _____

feet depth to _____ w/ _____ sx cmt.

INSTRUCTIONS: This form shall be completed in triplicate and filed with the Kansas Corporation Commission, 200 Colorado Derby Building, Wichita, Kansas 67202, within 120 days of the spud date of any well. Rule 82-3-130, 82-3-107 and 82-3-106 apply. Information on side two of this form will be held confidential for a period of 12 months if requested in writing and submitted with the form. See rule 82-3-107 for confidentiality in excess of 12 months. One copy of all wireline logs and drillers time log shall be attached with this form. ALL CEMENTING TICKETS MUST BE ATTACHED. Submit CP-4 form with all plugged wells. Submit CP-111 form with all temporarily abandoned wells. Any recompletion, workover or conversion of a well requires filing of ACO-2 within 120 days from commencement date of such work.

All requirements of the statutes, rules and regulations promulgated to regulate the oil and gas industry have been fully complied with and the statements herein are complete and correct to the best of my knowledge.

Signature Beverly G. Williams

Title Engineering Technician Date 1-23-90

Subscribed and sworn to before me this 23rd day of January, 1990.

Notary Public Cheryl Steers

Date Commission Expires _____



K.C.C. OFFICE USE ONLY

Letter of Confidentiality Attached
 Wireline Log Received
 Drillers Timelog Received

Distribution

KCC SWD/Rep NGPA
 KGS Plug Other (Specify)

SIDE TWO

Operator Name Anadarko Petroleum Corporation Lease Name Campbell "B" Well # 1H
 Sec. 12 Twp. 33S Rge. 40 East County Morton
 West

INSTRUCTIONS: Show important tops and base of formations penetrated. Detail all cores. Report all drill stem tests giving interval tested, time tool open and closed, flowing and shut-in pressures, whether shut-in pressure reached static level, hydrostatic pressures, bottom hole temperature, fluid recovery, and flow rates if gas to surface during test. Attach extra sheet if more space is needed. Attach copy of log.

Drill Stem Tests Taken <input type="checkbox"/> Yes <input checked="" type="checkbox"/> No (Attach Additional Sheets.) Samples Sent to Geological Survey <input type="checkbox"/> Yes <input checked="" type="checkbox"/> No Cores Taken <input type="checkbox"/> Yes <input checked="" type="checkbox"/> No Electric Log Run <input type="checkbox"/> Yes <input checked="" type="checkbox"/> No (Submit Copy.)	<p style="text-align: center;">Formation Description</p> <p style="text-align: center;"><input checked="" type="checkbox"/> Log <input type="checkbox"/> Sample</p> <table border="1" style="width:100%; border-collapse: collapse;"> <thead> <tr> <th style="width:50%;">Name</th> <th style="width:25%;">Top</th> <th style="width:25%;">Bottom</th> </tr> </thead> <tbody> <tr><td>Blaine</td><td>1099</td><td>1188</td></tr> <tr><td>Cedar Hills</td><td>1224</td><td>1377</td></tr> <tr><td>Stone Corral</td><td>1638</td><td>1656</td></tr> <tr><td>Chase</td><td>2364</td><td>2720</td></tr> <tr><td>Council Grove</td><td>2720</td><td>NA</td></tr> <tr><td>TD</td><td></td><td>2750</td></tr> </tbody> </table>	Name	Top	Bottom	Blaine	1099	1188	Cedar Hills	1224	1377	Stone Corral	1638	1656	Chase	2364	2720	Council Grove	2720	NA	TD		2750
Name	Top	Bottom																				
Blaine	1099	1188																				
Cedar Hills	1224	1377																				
Stone Corral	1638	1656																				
Chase	2364	2720																				
Council Grove	2720	NA																				
TD		2750																				

CASING RECORD <input checked="" type="checkbox"/> New <input type="checkbox"/> Used Report all strings set-conductor, surface, intermediate, production, etc.							
Purpose of String	Size Hole Drilled	Size Casing Set (In O.D.)	Weight Lbs./Ft.	Setting Depth	Type of Cement	# Sacks Used	Type and Percent Additives
Surface	12 1/4	8 5/8	24.0	519	Pozmix & Common	375	2% CC
Production	7 7/8	5 1/2	14.0	2747	Class "C"	230	3% CC 20% DCD 10% DCD
PERFORATION RECORD				Acid, Fracture, Shot, Cement Squeeze Record (Amount and Kind of Material Used)			
Shots Per Foot	Specify Footage of Each Interval Perforated			Depth			
2	2603-29			A/2600 gal 15% fe acid & 63 BS.			
2	2537-78, 2467-2515, 2411-47, 2383-93			Brk dwn w/15,500 gals 2% KCL Wtr & 338 BS. Frac w/72,000 gals gelled 75-55 quality foamed 2% KCL Wtr & 213,200# 12/20 sd.			
TUBING RECORD				Liner Run <input type="checkbox"/> Yes <input checked="" type="checkbox"/> No			
Date of First Production		Producing Method <input checked="" type="checkbox"/> Flowing <input type="checkbox"/> Pumping <input type="checkbox"/> Gas Lift <input type="checkbox"/> Other (Explain)					
SI WO SALES							
Estimated Production Per 24 Hours		Oil Bbls.	Gas Mcf	Water Bbls.	Gas-Oil Ratio		Gravity
			1450 @ 90 psi				

Disposition of Gas: Vented Sold Used on Lease
 (If vented, submit ACO-18.)

METHOD OF COMPLETION

Open Hole Perforation Dually Completed Commingled
 Other (Specify) _____

Production Interval
2383-2629
O.A.



REMIT TO:
 P.O. BOX 951046
 DALLAS, TX 75395-1046

INVOICE

HALLIBURTON SERVICES

A Halliburton Company

INVOICE NO.	DATE
823118	07/07/1989

WELL LEASE NO./PLANT NAME		WELL/PLANT LOCATION		STATE	WELL/PLANT OWNER	
CAMPBELL B-1H		MORTON		KS	SAME	
SERVICE LOCATION		CONTRACTOR	JOB PURPOSE		TICKET DATE	
LIBERAL		GABBERT & JONES #9	CEMENT SURFACE CASING		07/07/1989	
ACCT. NO.	CUSTOMER AGENT	VENDOR NO.	CUSTOMER P.O. NUMBER	SHIPPED VIA	FILE NO.	
019595	DAVID GILMORE		33876	COMPANY TRUCK	79078	

ANADARKO PETROLEUM CORP
 P. O. BOX 351
 LIBERAL, KS 67905-0351

DIRECT CORRESPONDENCE TO:
 SUITE 600
 COLORADO DERBY BUILDING
 WICHITA, KS 67202-0000

PRICE REF. NO.	DESCRIPTION	QUANTITY	U/M	UNIT PRICE	AMOUNT
000-117	PRICING AREA - MID CONTINENT MILEAGE	10	MI	2.20	22.00
001-016	CEMENTING CASING	517	FT	481.80	481.80
030-016	CEMENTING PLUG SW ALUM TOP	1	UNT		
504-043	PREMIUM CEMENT	5/8	IN	90.00	90.00
506-105	POZMIX A	1	EA		
504-043	PREMIUM CEMENT	163	SK	6.85	1,157.65
509-406	ANHYDROUS CALCIUM CHLORIDE	56	SK	3.91	218.96
507-210	FLOCELE	150	SK	6.85	1,027.50
500-207	BULK SERVICE CHARGE	8	SK	25.75	206.00
500-306	MILEAGE CMTG MAT DEL OR RETURN	94	LB	1.21	113.74
		391	CFT	.95	371.45
		174.320	TMI	.70	122.02
	INVOICE SUBTOTAL				3,811.12
	DISCOUNT-(BID)				1,295.76-
	INVOICE BID AMOUNT				2,515.36
	*-KANSAS STATE SALES TAX				92.76
	*-SEWARD COUNTY SALES TAX				21.83
	INVOICE TOTAL - PLEASE PAY THIS AMOUNT				\$2,629.95

RECEIVED
 STATE CORPORATION COMMISSION
 CONSERVATION DIVISION
 Wichita Kansas

Jim Seelow

4343-2041
 KA 7-16

7/14/89

GABBERT-JONES, INC.

CAMPBELL "B" 1H Drillers Well Log
 SEC. 12-33S-40W
 MORTON COUNTY, KANSAS

COMMENCED: 7-7-89
 COMPLETED: 7-10-89
 OPERATOR: ANADARKO PETROLEUM CORPORATION

DEPTH		FORMATION	REMARKS
From	To		
0	360	Clay - Sand	Ran 13 jts of 24# 8 5/8" csg LD @ 519' w/225 sks 25/75 Posmix - 2% CC - 1/4# FS 150 sks Common - 3% CC 1/4# FS PD @ 11:15 PM 7-7-89.
360	1228	Redbed	
1228	1378	Glorietta Sand	
1378	2750	Redbed	
	2750 TD		Ran 64 jts of 14# 5 1/2" csg set @ 2747 w/190 sks Class C - 20% DCD - 2% CC 1/4# FS - 40 sks Class C - 10% Diacel D - 2% CC - 1/4# FS PD @ 2:00 AM 7-10-89. RR @ 3:00 AM 7-10-89.

RECEIVED
 STATE CORPORATION COMMISSION

JAN 23 1990

CONSERVATION DIVISION
 Wichita, Kansas

STATE OF KANSAS]
]
 COUNTY OF SEDGWICK]

I, the undersigned, being duly sworn on oath, state that the above Drillers Well Log is true and correct to the best of my knowledge and belief and according to the records of this office.

GABBERT- JONES, INC.

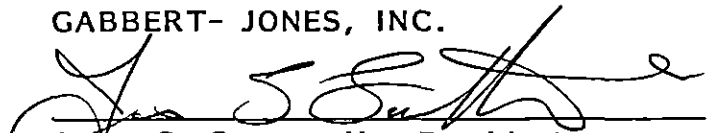
 James S. Sutton, II - President

Subscribed & sworn to before me this
 14th day of JULY , 1989.

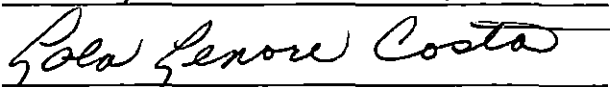

Lola Lenore Costa

LOLA LENORE COSTA
 NOTARY PUBLIC
 STATE OF KANSAS
 My Appt. Exp. 11-21-92