

SIDE ONE

STATE CORPORATION COMMISSION OF KANSAS
OIL & GAS CONSERVATION DIVISION
WELL COMPLETION OR RECOMPLETION FORM
ACO-1 WELL HISTORY
DESCRIPTION OF WELL AND LEASE

Operator: License # 5598
Pan Eastern Exploration Co.
Name
Address P. O. Box 351
City/State/Zip Liberal, KS 67905-0351

Purchaser N/A

Operator Contact Person M. L. Pease
Phone (316) 624-6253

Contractor: License # 5842
Name Gabbert-Jones, Inc.

Wellsite Geologist N/A
Phone

Designate Type of Completion
 New Well Re-Entry Workover

 Oil SWD Temp Abd
 Gas Inj Delayed Comp.
 Dry Other (Core, Water Supply etc.)

If ONWO: old well Info as follows:
Operator
Well Name
Comp. Date Old Total Depth

WELL HISTORY

Drilling Method:
 Mud Rotary Air Rotary Cable

6/8/87 6/11/87 N/A
Spud Date Date Reached TD Completion Date

2930 2920
Total Depth PBTD

Amount of Surface Pipe Set and Cemented at 527 feet
Multiple Stage Cementing Collar Used? Yes No
If yes, show depth set feet
If alternate 2 completion, cement circulated from feet depth to w/ SX cmt
Cement Company Name
Invoice #

API NO. 15-189-21,027-00-00

County Stevens

App. C SW 21 33 37 East
Sec. Twp. Rge. X West

1410 Ft North from Southeast Corner of Section
3960 Ft West from Southeast Corner of Section
(Note: Locate well in section plat below)

Lease Name Patterson "D" Well # 2H

Field Name Hugoton

Producing Formation Chase

Elevation: Ground 3116 KB

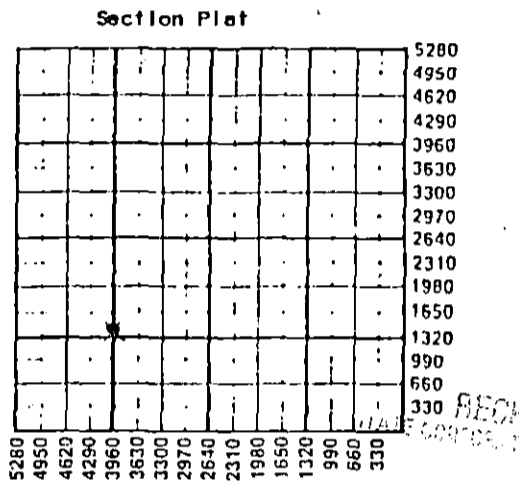

RECEIVED
SEP 23 1987
9-23-1987
KANSAS CORPORATION COMMISSION
OIL & GAS CONSERVATION DIVISION
Topeka, Kansas

WATER SUPPLY INFORMATION

Disposition of Produced Water: Disposal Repressuring
Docket #

Questions on this portion of the ACO-1 call:

Water Resources Board (913) 296-3717
Source of Water:
Division of Water Resources Permit #

 Groundwater.....Ft North from Southeast Corner (Well)Ft West from Southeast Corner of Sec Twp Rge East West

 Surface Water.....Ft North from Southeast Corner (Stream, pond etc).....Ft West from Southeast Corner Sec Twp Rge East West

 Other (explain) Contractor provided water.
(purchased from city, R.W.D. #)

INSTRUCTIONS: This form shall be completed in triplicate and filed with the Kansas Corporation Commission, 200 Colorado Derby Building, Wichita, Kansas 67202, within 120 days of the spud date of any well. Rule 82-3-130, 82-3-107 and 82-3-106 apply. Information on side two of this form will be held confidential for a period of 12 months if requested in writing and submitted with the form. See rule 82-3-107 for confidentiality in excess of 12 months. One copy of all wireline logs and drillers time log shall be attached with this form. Submit CP-4 form with all plugged wells. Submit CP-111 form with all temporarily abandoned wells.

All requirements of the statutes, rules and regulations promulgated to regulate the oil and gas industry have been fully complied with and the statements herein are complete and correct to the best of my knowledge.

Signature M. L. Pease
Title Division Production Manager Date 9/22/87

Subscribed and sworn to before me this 22 day of Sept 1987
Notary Public Beverly J. Williams

K.C.C. OFFICE USE ONLY
 Letter of Confidentiality Attached
 Wireline Log Received
 Drillers Timelog Received
Distribution
 KCC SWD/Rap NGPA
 KGS Plug Other
(Specify)

BEVERLY J. WILLIAMS
NOTARY PUBLIC
STATE OF KANSAS
MY APPT. EXPIRES 11-21-90

Operator Name Pan Eastern Exploration Co. Lease Name Patterson "D" Well # 2H

Sec. 21 Twp. 33 Rge. 37 East West County Stevens

WELL LOG

INSTRUCTIONS: Show important tops and base of formations penetrated. Detail all cores. Report all drill stem tests giving interval tested, time tool open and closed, flowing and shut-in pressures, whether shut-in pressure reached static level, hydrostatic pressures, bottom hole temperature, fluid recovery, and flow rates if gas to surface during test. Attach extra sheet if more space is needed. Attach copy of log.

Drill Stem Tests Taken Yes No
 Samples Sent to Geological Survey Yes No
 Cores Taken Yes No

Formation Description
 Log Sample

Name	Top	Bottom
Surface Sand-Clay	0	155
Redbed	155	1128
Glorietta Sand	1128	1335
Shale	1335	1697
Lime-Shale	1697	2110
Lime	2110	2430
Lime-Shale	2430	2911
Lime	2911	2930
TD	2930	

RELEASED

OCT 20 1988

FROM CONFIDENTIAL

CASING RECORD <input checked="" type="checkbox"/> New <input type="checkbox"/> Used							
Report all strings set-conductor, surface, intermediate, production, etc.							
Purpose of String	Size Hole Drilled	Size Casing Set (In O.D.)	Weight Lbs/Ft.	Setting Depth	Type of Cement	#Sacks Used	Type and Percent Additives
Surface	12 1/4	8 5/8	24	527	75/25 Poz Common	180	2%cc + 1/4# cel
Production	7 7/8	5 1/2	14	210	20% DC-D 10% DC-D	210 40	3%cc + 1/4# cel 2%cc + 1/4# cel
PERFORATION RECORD				Acid, Fracture, Shot, Cement Squeeze Record (Amount and Kind of Material Used)			
Shots Per Foot	Specify Footage of Each Interval Perforated						Depth
TUBING RECORD				Size	Set At	Packer at	Liner Run <input type="checkbox"/> Yes <input type="checkbox"/> No
Date of First Production	Producing Method <input type="checkbox"/> Flowing <input type="checkbox"/> Pumping <input type="checkbox"/> Gas Lift <input type="checkbox"/> Other (explain).....						
Estimated Production Per 24 Hours	Oil	Gas	Water	Gas-Oil Ratio	Gravity		
	Bbls	MCF	Bbls	CFPB			

METHOD OF COMPLETION

Production Interval

Disposition of gas: Vented Open Hole Perforation
 Sold Other (Specify) Delayed
 Used on Lease Dually Completed
 Commingled

