

ORIGINAL

SIDE ONE

STATE CORPORATION COMMISSION OF KANSAS
OIL & GAS CONSERVATION DIVISION
WELL COMPLETION OR RECOMPLETION FORM
ACO-1 WELL HISTORY
DESCRIPTION OF WELL AND LEASE

API NO. 15-189-21,226-00-00
County Stevens FROM CONFIDENTIAL
SE NE SE Sec. 21 Twp. 33S Rge. 37E

Operator: License # 5598
Name APX Corporation
Address P.O. Box 351
City/State/Zip Liberal, Kansas 67905-0351

1390 Ft North from Southeast Corner of Section
200 Ft West from Southeast Corner of Section
(Note: Locate well in section plat below)

Purchaser Panhandle Eastern Pipe Line Co.
(Transporter)

Lease Name Harrison "A" Well # 1H

Field Name Hugoton

Operator Contact Person M. L. Pease
Phone (316) 624-6253

Producing Formation Chase

Elevation: Ground 3109.0 KB

Contractor: License # 5842
Name Gabbert-Jones, Inc.

Wellsite Geologist NA
Phone

Designate Type of Completion
[X] New Well [ ] Re-Entry [ ] Workover

[ ] Oil [ ] SWD [ ] Temp Abd
[X] Gas [ ] Inj [ ] Delayed Comp.
[ ] Dry [ ] Other (Core, Water Supply etc.)

If OWWO: old well info as follows:
Operator
Well Name
Comp. Date Old Total Depth

RECEIVED
STATE CORPORATION COMMISSION
1-17-1989
JAN 17 1989
Wichita, Kansas

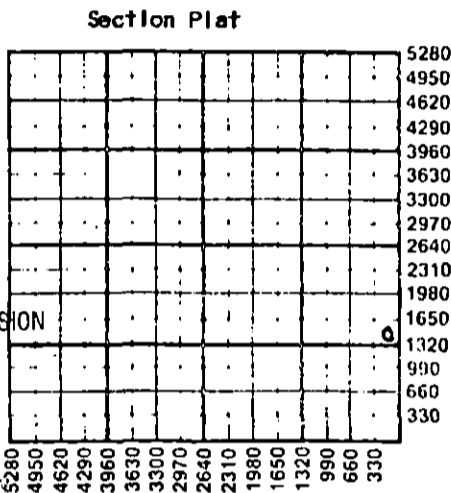

WATER SUPPLY INFORMATION
Disposition of Produced Water: [ ] Disposal [ ] Repressuring
Docket #

Questions on this portion of the ACO-1 call:
Water Resources Board (913) 296-3717
Source of Water:
Division of Water Resources Permit #
Groundwater Ft North from Southeast Corner (Well) Ft West from Southeast Corner of Sec Twp Rge East West
Surface Water Ft North from Southeast Corner (Stream, pond etc) Ft West from Southeast Corner Sec Twp Rge East West
[X] Other (explain) Contractor provided water.. (purchased from city, R.W.D. #)

INSTRUCTIONS: This form shall be completed in triplicate and filed with the Kansas Corporation Commission, 200 Colorado Derby Building, Wichita, Kansas 67202, within 120 days of the spud date of any well. Rule 82-3-130, 82-3-107 and 82-3-106 apply. Information on side two of this form will be held confidential for a period of 12 months if requested in writing and submitted with the form. See rule 82-3-107 for confidentiality in excess of 12 months. One copy of all wireline logs and drillers time log shall be attached with this form. Submit CP-4 form with all plugged wells. Submit CP-111 form with all temporarily abandoned wells.

All requirements of the statutes, rules and regulations promulgated to regulate the oil and gas industry have been fully complied with and the statements herein are complete and correct to the best of my knowledge.

Signature M. L. Pease
Title Division Production Manager Date 1/16/89

Subscribed and sworn to before me this 16th day of Jan 1989
Notary Public Glenna S. Salley

Date Commission Expires

GLENN S. SALLEY
NOTARY PUBLIC
STATE OF KANSAS
MY APPT. EXPIRES 1-6-91

K.C.C. OFFICE USE ONLY
Letter of Confidentiality Attached
Wireline Log Received
Drillers Timelog Received
Distribution
KCC SWD/Rep NGPA
KGS Plug Other (Specify)

Sec 21, Twp 33S, Rge 37E

PI

ORIGINAL

Operator Name APX Corporation Lease Name Harrison Well # 1H

Sec. 21 Twp. 33S Rge. 37 East West County Stevens

WELL LOG

INSTRUCTIONS: Show important tops and base of formations penetrated. Detail all cores. Report all drill stem tests giving interval tested, time tool open and closed, flowing and shut-in pressures, whether shut-in pressure reached static level, hydrostatic pressures, bottom hole temperature, fluid recovery, and flow rates if gas to surface during test. Attach extra sheet if more space is needed. Attach copy of log.

Drill Stem Tests Taken [ ] Yes [X] No
Samples Sent to Geological Survey [ ] Yes [X] No
Cores Taken [ ] Yes [X] No

Formation Description [ ] Log [X] Sample

Table with 3 columns: Name, Top, Bottom. Rows include Sand, Clay, Sand, Sand, Clay, Redbed, Glorietta Sand, Redbed, Anhydrite, Redbed, Lime, Redbed, Lime, Shale, TD.

CASING RECORD, PERFORATION RECORD, TUBING RECORD, and production data table. Includes fields for Purpose of String, Size Hole, Size Casing, Weight, Setting Depth, Type of Cement, #Sacks Used, Type and Percent Additives, Shots Per Foot, Specify Footage of Each Interval Perforated, Acid, Fracture, Shot, Cement Squeeze Record, Date of First Production, Producing Method, and Estimated Production Per 24 Hours.

METHOD OF COMPLETION and Disposition of gas section. Includes checkboxes for Vented, Sold, Used on Lease, Open Hole, Perforation, Other (Specify), Dually Completed, and Commingled.

# HALLIBURTON SERVICES

P.O. BOX 651046  
DALLAS, TX 75265

INVOICE

A Halliburton Company

INVOICE NO.	DATE
720669	10/05/1988

WELL LEASE NO./PLANT NAME	WELL/PLANT LOCATION	STATE	WELL/PLANT OWNER
HARRISON A-1H	STEVENS	KS	SAME
SERVICE LOCATION	CONTRACTOR	JOB PURPOSE	TICKET DATE
LIBERAL	GABBERT & JONES #9	CEMENT SURFACE CASING	10/05/1988
ACCT. NO.	CUSTOMER AGENT	VENDOR NO.	CUSTOMER P.O. NUMBER
001527	JOHN SHILLING		
			SHIPPED VIA
			COMPANY TRUCK
			FILE NO.
			66166

APX CORPORATION  
P. O. BOX 351  
LIBERAL, KS 67905-0351

DIRECT CORRESPONDENCE TO:  
SUITE 600  
COLORADO DERBY BUILDING  
WICHITA, KS 67202-0000

PRICE REF. NO.	DESCRIPTION	QUANTITY	U/M	UNIT PRICE	AMOUNT
000-117	MILEAGE	30	MI	2.20	66.00
		1	UNT		
001-016	CEMENTING CASING PUMP CHARGE	612	FT	519.80	519.80
		1	UNT		
001-018	CEMENTING CASING - ADD HRS	4	HR	140.00	560.00
		1	UNT		
030-018	TYPE SW, PLASTIC TOP PLUG	8 5/8	IN	82.00	82.00
		1	EA		
217-612	CHEMICAL DELIVERY-SEMI-TRAILER	30	MI	2.00	60.00
		1	UNT		
504-043	PREMIUM CEMENT	143	SK	6.85	979.55
506-105	POZMIX A	47	SK	3.91	183.77
504-043	PREMIUM CEMENT	150	SK	6.85	1,027.50
509-406	ANHYDROUS CALCIUM CHLORIDE	7	SK	25.75	180.25
507-210	FLOCELE	85	LB	1.21	102.85
500-207	BULK SERVICE CHARGE	354	CFT	.95	336.30
500-322	MINIMUM MILEAGE	15.833	TMI	45.00	45.00
504-043	PREMIUM CEMENT	400	SK	6.85	2,740.00
509-406	ANHYDROUS CALCIUM CHLORIDE	4	SK	25.75	103.00
500-207	BULK SERVICE CHARGE	408	CFT	.95	387.60
500-322	MINIMUM MILEAGE	18.960	TMI	45.00	45.00
504-043	PREMIUM CEMENT	275	SK	6.85	1,883.75
509-406	ANHYDROUS CALCIUM CHLORIDE	9	SK	25.75	231.75
507-277	HALLIBURTON-GEL BENTONITE	2	%	.37	101.75
		275	SK		
508-127	CAL SEAL	28	SK	14.60	408.80
500-207	BULK SERVICE CHARGE	322	CFT	.95	305.90
500-322	MINIMUM MILEAGE	14.800	TMI	45.00	45.00
SUBTOTAL					10,395.57

RECEIVED

STATE CORPORATION COMMISSION

JAN 17 1989

\*\*\*\*\* CONTINUED ON NEXT PAGE \*\*\*\*\*

TERMS: PAYABLE NET BY THE 20TH OF THE FOLLOWING MONTH AFTER DATE OF INVOICE. UPON CUSTOMER'S DEFAULT IN PAYMENT OF CUSTOMER'S ACCOUNT BY THE LAST DAY OF THE MONTH FOLLOWING THE MONTH IN WHICH THE INVOICE IS DATED, CUSTOMER AGREES TO PAY INTEREST THEREON AFTER DEFAULT AT THE HIGHEST LAWFUL CONTRACT RATE APPLICABLE BUT NEVER TO EXCEED 18% PER ANNUM IN THE EVENT IT BECOMES NECESSARY TO EMPLOY AN ATTORNEY TO ENFORCE COLLECTION OF SAID ACCOUNT. CUSTOMER AGREES TO PAY ALL COLLECTION COSTS AND ATTORNEY FEES IN THE AMOUNT OF 20% OF THE AMOUNT OF THE UNPAID ACCOUNT.

GABBERT-JONES  
DRILLERS WELL LOG

HARRISON "A" 1H  
SEC. 21-33S-37W  
STEVENS COUNTY, KANSAS

Commenced: 10-4-88  
Completed: 10-12-88  
Operator: ANADARKO PETROLEUM CORPORATION

R-9

Depth		Formation	Remarks
From	To		
0	80	Sand	Ran 14 jts of 24# 8 5/8" csg
80	481	Clay-Sand	LD @ 593 w/190 sks
481	511	Sand-Clay	25/75 Posmix - 2% CC - 1/4#
511	1175	Redbed	Celloflake - 150 sks Common
1175	1351	Glorita Sand	3% CC - 1/4# Celloflake
1351	1693	Redbed	PD @ 2:45 AM 10-6-88
1693	1713	Anhy	1" to 200' w/200 sks
1713	2372	Redbed	Common - 2% CC - 200 sks
2372	2637	Lime	Common - JC @ 6:30 AM 10-6-88
2637	2770	Redbed	1" to 105' 2nd time
2770	2941	Lime-Shale	w/91 sks Fixatrophic C @ 1:00 PM 10-7-88.
	2941 TD		Ran 72 jts of 14# 5 1/2" csg LD @ 2940' w/310 sks Class C - 20% DCD - 2% CC 1/4# FS - 40 sks Class C 10% DCD - 2% CC - 1/4# FS PD @ 6:30 PM 10-12-88.

State of Kansas )  
County of Sedgwick ) I, the undersigned, being duly sworn on oath, state  
that the above Drillers ' Well Log is true and correct  
to the best of my knowledge and belief and according  
to the records of this office.

GABBERT-JONES, INC.

RECEIVED  
STATE CORPORATION COMMISSION

JAN 17 1989

  
James S. Sutton, II -- President

Subscribed & sworn to before me this  
18th day of October 1988 Kansas

  
BARBARA ANN MARSHALL

My Commission expires August 15, 1992