

FORM MUST BE TYPED

SIDE ONE

STATE CORPORATION COMMISSION OF KANSAS  
OIL & GAS CONSERVATION DIVISION  
WELL COMPLETION FORM  
ACO-1 WELL HISTORY  
DESCRIPTION OF WELL AND LEASE

API NO. 15- 129-20,220-0001

County MORTON

- C - SE - SE Sec. 1 Twp. 33S Rge. 41 X W

660 Feet from S/N (circle one) Line of Section

660 Feet from E/W (circle one) Line of Section

Footages Calculated from Nearest Outside Section Corner:  
NE, SE NW or SW (circle one)

Lease Name DUNKLE "A" Well # 1

Field Name DUNKLE

Producing Formation WABAUNSEE

Elevation: Ground 3394' KB --

Total Depth 5740' PBDT 3350'

Amount of Surface Pipe Set and Cemented at 1615 Feet

Multiple Stage Cementing Collar Used? Yes X No

If yes, show depth set Feet

If Alternate II completion, cement circulated from

feet depth to w/ sx cmt.

Operator: License # 4549

Name: ANADARKO PETROLEUM CORPORATION

Address P. O. BOX 351

City/State/Zip LIBERAL, KANSAS 67905-0351

Purchaser: ANADARKO TRADING COMPANY

Operator Contact Person: J. L. ASHTON

Phone (316) 624-6253

Contractor: Name: NA

License: NA

Wellsite Geologist: NA

Designate Type of Completion  
New Well Re-Entry X Workover

Oil SWD SIOW Temp. Abd.  
X Gas ENHR SIGW  
Dry Other (Core, WSW, Expl., Cathodic, etc)

If Workover:

Operator: ANADARKO PETROLEUM CORPORATION

Well Name: DUNKLE "A" NO. 1

Comp. Date 12/08/75 Old Total Depth 5740'

Deepening X Re-perf. Conv. to Inj/SWD WICHITA, KS  
Plug Back PBDT  
Commingled Docket No.  
Dual Completion Docket No.  
Other (SWD or Inj?) Docket No.

6/05/96 NA 6/27/96  
Spud Date Date Reached TD Completion Date

Drilling Fluid Management Plan REWORK JPH 12-22-97  
Data must be collected from the Reserve Pit  
NOT APPLICABLE

Chloride content ppm Fluid volume bbls

Dewatering method used

Location of fluid disposal if hauled offsite:

Operator Name

Lease Name License No.

Quarter Sec. Twp. S Rng. E/W

County Docket No.

RECEIVED  
KANSAS CORPORATION COMMISSION  
JUL 22 1996  
CONSERVATION DIVISION  
WICHITA, KS

INSTRUCTIONS: An original and two copies of this form shall be filed with the Kansas Corporation Commission, 130 S. Market - Room 2078, Wichita, Kansas 67202, within 120 days of the spud date, recompletion, workover or conversion of a well. Rule 82-3-130, 82-3-106 and 82-3-107 apply. Information on side two of this form will be held confidential for a period of 12 months if requested in writing and submitted with the form (see rule 82-3-107 for confidentiality in excess of 12 months). One copy of all wireline logs and geologist well report shall be attached with this form. ALL CEMENTING TICKETS MUST BE ATTACHED. Submit CP-4 form with all plugged wells. Submit CP-111 form with all temporarily abandoned wells.

All requirements of the statutes, rules and regulations promulgated to regulate the oil and gas industry have been fully complied with and the statements herein are complete and correct to the best of my knowledge.

Signature John M. Dolan  
Title SENIOR TECHNICAL ASSISTANT Date 7/16/96

Subscribed and sworn to before me this 16th day of July 1996

Notary Public L. Marc Harvey

Date Commission Expires

L. MARC HARVEY  
Notary Public - State of Kansas  
My Appl. Expires 6-12-97

K.C.C. OFFICE USE ONLY  
F Letter of Confidentiality Attached  
C Wireline Log Received  
C Geologist Report Received  
Distribution  
V KCC SWD/Rep NGPA  
KGS Plug Other (Specify)

ORIGINAL

SIDE TWO

Operator Name ANADARKO PETROLEUM CORPORATION Lease Name DUNKLE "A" Well # 1

Sec. 1 Twp. 33S Rge. 41  East  West County MORTON

INSTRUCTIONS: Show important tops and base of formations penetrated. Detail all cores. Report all drill stem tests giving interval tested, time tool open and closed, flowing and shut-in pressures, whether shut-in pressure reached static level, hydrostatic pressures, bottom hole temperature, fluid recovery, and flow rates if gas to surface during test. Attach extra sheet if more space is needed. Attach copy of log.

Drill Stem Tests Taken  Yes  No (Attach Additional Sheets.)  
Samples Sent to Geological Survey  Yes  No  
Cores Taken  Yes  No  
Electric Log Run  Yes  No (Submit Copy.)  
List All E.Logs Run:

Log Formation (Top), Depth and Datums  Sample  
Name Top Datum  
(SEE ORIGINAL DRILLERS LOG - ATTACHED)

**\*\* Original Completion CASING RECORD**  New  Used  
Report all strings set-conductor, surface, intermediate, production, etc.

Purpose of String	Size Hole Drilled	Size Casing Set (In O.D.)	Weight Lbs./Ft.	Setting Depth	Type of Cement	# Sacks Used	Type and Percent Additives
** SURFACE	12-1/4"	8-5/8"	24.0	1615'	LITE/POZ	550/200	4%GEL,2%CC/2%CC
** PRODUCTION	7-7/8"	4-1/2"	10.5	3335'	POZMIX	275	.5% CFR-2

**ADDITIONAL CEMENTING/SQUEEZE RECORD**

Purpose: ___ Perforate ___ Protect Casing ___ Plug Back TD ___ Plug Off Zone	Depth		Type of Cement	#Sacks Used	Type and Percent Additives
	Top	Bottom			

Shots Per Foot	PERFORATION RECORD - Bridge Plugs Set/Type Specify Footage of Each Interval Perforated	Acid, Fracture, Shot, Cement Squeeze Record (Amount and Kind of Material Used)	Depth
4	PERF 2965'-2992' (ADDITIONAL PERFS TO WABAUNSEE)	ACIDIZE W/2000 GAL 7.5% FENCL	
2	3005'-3012' 3248'-3252' CIBP@3050'		
4	3268'-3272' CIBP@3260'		

TUBING RECORD Size 2-3/8" Set At 3024' Packer At -- Liner Run  Yes  No

Date of First, Resumed Production, SWD or Inj. 6/18/96 Producing Method  Flowing  Pumping  Gas Lift  Other (Explain)

Estimated Production Per 24 Hours Oil 0 Bbls. Gas 46 Mcf Water 14 Bbls. Gas-Oil Ratio -- Gravity --

Disposition of Gas:  Vented  Sold  Used on Lease (If vented, submit ACO-18.)  
METHOD OF COMPLETION:  Open Hole  Perf.  Dually Comp.  Commingled 2965'-3012' O.A.  
 Other (Specify)

KANSAS DRILLERS LOG

ORIGINAL

S. 1 T. 33S R. 41 W

API No. 15 — 129 — 20,220  
County Number

Loc. SE SE

Operator  
Anadarko Production Company

County Morton

Address  
P. O. Box 351, Liberal, Kansas 67901

Well No. 1 Lease Name Dunkle "A"

Footage Location  
660 feet from (S) line 660 feet from (E) line

Principal Contractor Gabbert-Jones, Inc. Geologist James E. Nichols, Consultant

Spud Date 10-24-75 Total Depth 5740' P.B.T.D. 3350'

Date Completed 12-8-75 Oil Purchaser

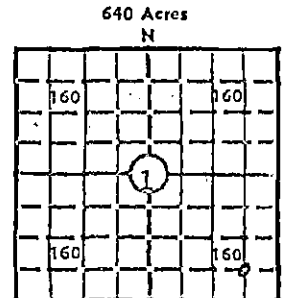

Elev.: Gr. 3393.9'

DF KB

CASING RECORD

Report of all strings set— surface, intermediate, production, etc.

Purpose of string	Size hole drilled	Size casing set (In O.D.)	Weight lbs./ft.	Setting depth	Type cement	Sacks	Type and percent additives
Surface	12-1/4"	8-5/8"	24#	1615'	Lite Wate Common	550 200	4% gel 2% CC 2% CC
Production	7-7/8"	4-1/2"	10.5#	3335'	Pozmix	275	.5% CFR-2

LINER RECORD

PERFORATION RECORD

Top, ft.	Bottom, ft.	Sacks cement	Shots per ft.	Size & type	Depth Interval
			4 SPF		3268-72'
			Set CIBP		3260'
			2 SPF		3248-52'
			Set CIBP		3050'
			2 SPF		3005-12'

ACID, FRACTURE, SHOT, CEMENT SQUEEZE RECORD

Amount and kind of material used	Depth interval treated
Acidized w/1000 gallons 15% 20 ball sealers. F/10,000 gallons	3005-12'
3% geled acid + 10,000# 20-40 sand.	

RECEIVED  
KANSAS CORPORATION COMMISSION  
JUL 22 1996

INITIAL PRODUCTION

Date of first production SI for pipeline connection	Producing method (flowing, pumping, gas lift, etc.) Flowing
RATE OF PRODUCTION PER 24 HOURS	Oil Gas Water Gas-oil ratio
	bbls. CWHOF 2198 MCF bbls. CFPB
Disposition of gas (vented, used on lease or sold) Will be sold	Producing interval(s) 3005-12' Waubaussee

CONSERVATION DIVISION  
WICHITA, KS

INSTRUCTIONS: As provided in KCC Rule 82-2-125, within 90 days after completion of a well, one completed copy of this Drillers Log shall be transmitted to the State Geological Survey of Kansas, 4150 Monroe Street, Wichita, Kansas 67209. Copies of this form are available from the Conservation Division, State Corporation Commission, 3830 So. Meridian (P.O. Box 17027), Wichita, Kansas 66217. Phone AC 316-522-2206. If confidential custody is desired, please note Rule 82-2-125. Drillers Logs will be on open file in the Oil and Gas Division, State Geological Survey of Kansas, Lawrence, Kansas 66044.

Operator  
Anadarko Production Company

DESIGNATE TYPE OF COMP.: OIL, GAS, DRY HOLE, SWD, ETC.:

Well No. 1 Lease Name Dunkle "A" Gas

s 1 T 33S R 41 E W

**WELL LOG**

Show all important zones of porosity and contents thereof; cored intervals, and all drill-stem tests, including depth interval tested, cushion used, time tool open, flowing and shut-in pressures, and recoveries.

SHOW GEOLOGICAL MARKERS, LOGS RUN, OR OTHER DESCRIPTIVE INFORMATION.

FORMATION DESCRIPTION, CONTENTS, ETC.	TOP	BOTTOM	NAME	DEPTH
Surface Clay-Sand	0	102		
Sand-Clay-Redbed-Anhy	102	690		
Redbed-Clay	690	1065		
Redbed	1065	1119		
Glorietta Sand	1119	1234		
Redbed-Shale	1234	1339		
Shale-Shells-Anhy	1339	1616		
Shale	1616	2100		
Shale-Shells	2100	2278		
Shale-Lime	2278	2548		
Lime-Shale	2548	2710		
Shale-Lime	2710	2862		
Lime-Shale	2862	5740		
Total Depth		5740		

DST #1 5129-59' (Morrow), open 30 min, SI 40 min, open 40 min, SI 60 min, weak blow thruout, REC 10' drilling mud. ISIP 86# (tool not closed), IFP 34-34#, FFP 24-24#, FSIP 1127# (60).

DST #2 5145-5354' (Morrow "G"), unable to set hook and packers.

USE ADDITIONAL SHEETS, IF NECESSARY TO COMPLETE WELL RECORD.

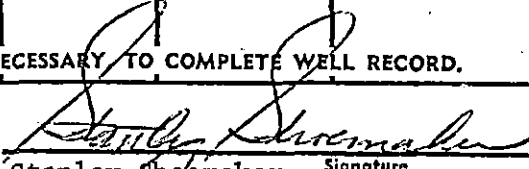
Date Received	
	Stanley Shoemaker Signature
	Division Office Supervisor Title
	December 10, 1975 Date

08121111