

STATE CORPORATION COMMISSION OF KANSAS  
OIL & GAS CONSERVATION DIVISION

WELL COMPLETION OR RECOMPLETION FORM  
ACO-1 WELL HISTORY

DESCRIPTION OF WELL AND LEASE

Operator: License # 9783  
Name Santa Fe Minerals, Inc.  
Address Two Galleria Tower  
13455 Noel Rd., Suite 1100  
City/State/Zip Dallas, Texas 75240

Purchaser Oklahoma Gas Pipeline Co.

Operator Contact Person Jim LaFeyers  
Phone (214) 701-7588

Contractor: License # 05382  
Name Cheyenne Drilling Co.

Wellsite Geologist Gayle Tapp  
Phone (918) 561-7206

Designate Type of Completion  
 New Well  Re-Entry  Workover  
 Oil  SWD  Temp Abd  
 Gas  Inj  Delayed Comp.  
 Dry  Other (Core, Water Supply etc.)

If ONWO: old well info as follows:  
Operator  
Well Name  
Comp. Date Old Total Depth

WELL HISTORY

Drilling Method:  
 Mud Rotary  Air Rotary  Cable  
..11/28/87.. ..12/1/87..... ..3/21/88.....  
Spud Date Date Reached TD Completion Date  
..2850'..... ..2820'.....  
Total Depth PBDT

Amount of Surface Pipe Set and Cemented at 800 feet  
Multiple Stage Cementing Collar Used?  Yes  No  
If yes, show depth set.....feet  
If alternate 2 completion, cement circulated  
from.....feet depth to.....w/.....SX cmt  
AIR I

API NO. 15-175-20982-100-00  
County Seward  
N .. W .. 4 .. Sec. 29 Twp. 34S Rge. 34  East  West

3960 ..... Ft North from Southeast Corner of Section  
3970 ..... Ft West from Southeast Corner of Section  
(Note: Locate well in section plat below)

Lease Name D. T. Gammel Well # 2

Field Name Hugoton

Producing Formation Chase

Elevation: Ground 2940 KB 2949

Section Plat

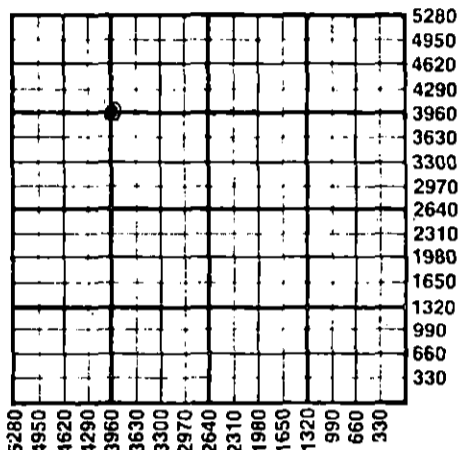

WATER SUPPLY INFORMATION

Disposition of Produced Water:  Disposal  Repressuring  
Docket #

Questions on this portion of the ACO-1 call:  
Water Resources Board (913) 296-3717

Source of Water:  
Division of Water Resources Permit #  
 Groundwater.....Ft North from Southeast Corner  
(Well) .....Ft West from Southeast Corner of  
Sec Twp Rge  East  West  
 Surface Water.....Ft North from Southeast Corner  
(Stream, pond etc).....Ft West from Southeast Corner  
Sec Twp Rge  East  West  
 Other (explain)...bailed in.....  
(purchased from city, R.W.D. #)

INSTRUCTIONS: This form shall be completed in duplicate and filed with the Kansas Corporation Commission, 200 Colorado Derby Building, Wichita, Kansas 67202, within 90 days after completion or recompletion of any well. Rule 82-3-130 and 82-3-107 apply.  
Information on side two of this form will be held confidential for a period of 12 months if requested in writing and submitted with the form. See rule 82-3-107 for confidentiality in excess of 12 months.  
One copy of all wireline logs and drillers time log shall be attached with this form. Submit CP-4 form with all plugged wells. Submit CP-111 form with all temporarily abandoned wells.

All requirements of the statutes, rules and regulations promulgated to regulate the oil and gas industry have been fully complied with and the statements herein are complete and correct to the best of my knowledge.

Signature James B. Anderson Jr.  
Title Engineering Technician Date 4/18/88

Subscribed and sworn to before me this 18th day of April 1988  
Notary Public Barbara D. Anderson

Date Commission Expires BARBARA D. ANDERSON  
Notary Public State of Texas  
My Commission Expires June 29, 1989

K.C.C. OFFICE USE ONLY  
 Letter of Confidentiality Attached  
 Wireline Log Received  
 Time Log Received  
Distribution  
 KCC  SWD/Rep  NGPA  
 Plug  Other (Specify)  
APR 25 1988  
4-25-1988  
CONSERVATION DIVISION  
Wichita, Kansas

SIDE TWO

Operator Name Santa Fe Minerals, Inc. Lease Name D. T. Gamell Well # 2

Sec. 29 Twp. 34S Rge. 34  East  West County Seward

WELL LOG

INSTRUCTIONS: Show important tops and base of formations penetrated. Detail all cores. Report all drill stem tests giving interval tested, time tool open and closed, flowing and shut-in pressures, whether shut-in pressure reached static level, hydrostatic pressures, bottom hole temperature, fluid recovery, and flow rates if gas to surface during test. Attach extra sheet if more space is needed. Attach copy of log.

Drill Stem Tests Taken  Yes  No  
 Samples Sent to Geological Survey  Yes  No  
 Cores Taken  Yes  No

Formation Description  
 Log  Sample

Name	Top	Bottom
Blaine Gypsum	984	
Glorietta	1154	
Tubb	1644	
Red Cave	1699	
Wellington	2234	
Chase Group	2639	

CASING RECORD <input checked="" type="checkbox"/> New <input type="checkbox"/> Used							
Report all strings set-conductor, surface, intermediate, production, etc.							
Purpose of String	Size Hole Drilled	Size Casing Set (In O.D.)	Weight Lbs/Ft.	Setting Depth	Type of Cement	#Sacks Used	Type and Percent Additives
Surface	12-1/4	8-5/8	24	800'	Class "C"	370	2% CaCl
Production	7-7/8	5-1/2	15.5	2850'	Class "C"	410	2% CaCl
PERFORATION RECORD				Acid, Fracture, Shot, Cement Squeeze Record			
Shots Per Foot	Specify Footage of Each Interval Perforated			(Amount and Kind of Material Used)		Depth	
2	Chase 2770-2630			3300 g. 15% acid		2770 -	
				17600 g. 28% acid		2630	
TUBING RECORD				Liner Run <input type="checkbox"/> Yes <input checked="" type="checkbox"/> No			
Size		Set At		Packer at			
2-3/8"		2794"		None			
Date of First Production		Producing Method					
3-16-88		<input type="checkbox"/> Flowing <input checked="" type="checkbox"/> Pumping <input type="checkbox"/> Gas Lift <input type="checkbox"/> Other (explain).....					
Estimated Production Per 24 Hours		Oil	Gas	Water	Gas-Oil Ratio	Gravity	
0 Bbls		728 MCF	3 Bbls	NA	CFPB	NA	

METHOD OF COMPLETION

Production Interval

Disposition of gas:  Vented  Open Hole  Perforation  
 Sold  Other (Specify) .....  
 Used on Lease  Dually Completed  Commingled

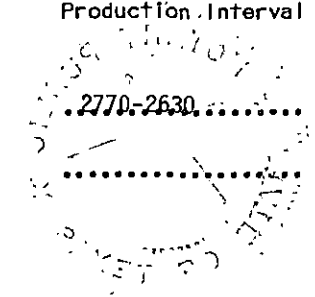

**TOPOGRAPHIC LAND SURVEYORS**

Surveying and Mapping for the Energy Industry

1008 E 17TH ST. • HAYS, KANSAS 67601

TELEPHONES LOCAL (913) 625-2683 • OKLA WATS (800) 522-4273 • OUT OF STATE WATS (800) 654-3219

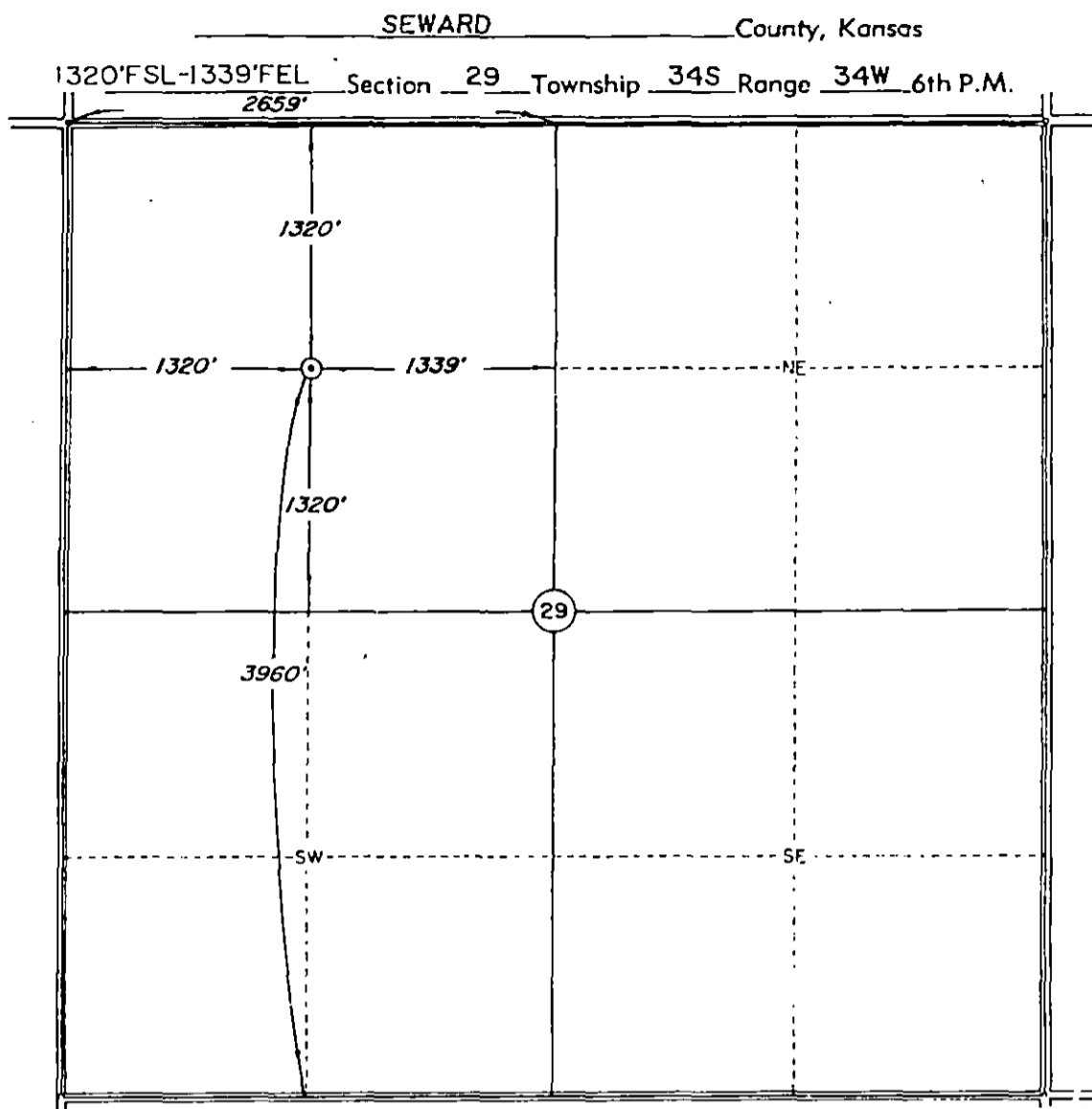

Scale 1" = 1000'

Date Staked October 10, 1987

This location has been very carefully staked on the ground according to the best official survey records, maps, and photographs available to us, but its accuracy is not guaranteed.

Review this plat and notify us immediately of any possible discrepancy.

Operator: SANTA FE MINERALS

ELEVATION:  
2940' Gr. at Stake

Lease Name D.T. Gammell Well No 2

Topography & Vegetation Location fell in planted milo.

RECEIVED  
STATE CORPORATION COMMISSION

Good Drill Site? Yes Reference Stakes or Alternate Location none Stakes Set none

APR 25 1988

Best Accessibility to Location From West.

CONSERVATION DIVISION  
Wichita, Kansas

Distance & Direction from Hwy Jct or Town From Jct. US 83 & US 270 & Tucker Road (North of Liberal),

go 7 miles West to the Northwest Corner of Section 29, T34S-R34W.

KT

**CERTIFICATE:**

I, Roger R. Rowe a Registered Land Surveyor and an authorized agent of Topographic Land Surveyors, do hereby certify that the above described well location was surveyed and staked on the ground as shown herein.

Roger R. Rowe

Kansas Reg. No. 839

