

ORIGINAL

FORM MUST BE TYPED

SIDE ONE

STATE CORPORATION COMMISSION OF KANSAS
OIL & GAS CONSERVATION DIVISION
WELL COMPLETION FORM
ACO-1 WELL HISTORY
DESCRIPTION OF WELL AND LEASE

Operator: License # 4549

Name: ANADARKO PETROLEUM CORPORATION

Address P. O. BOX 351

City/State/Zip LIBERAL, KANSAS 67905-0351

Purchaser: ANADARKO ENEGERY SERVICES

Operator Contact Person: G. B. SMITH

Phone (316) 624-6253

Contractor: Name: NA

License: NA

Wellsite Geologist: NA

Designate Type of Completion
 New Well Re-Entry Workover

Oil SWD SIOW Temp. Abd.
 Gas ENHR SIGW
 Dry Other (Core, WSW, Expl., Cathodic, etc)

If Workover:

Operator: ANADARKO PETROLEUM CORPORATION

Well Name: ALEXANDER B-1

Comp. Date 6-15-67 Old Total Depth 6252

Deepening Re-perf. Conv. to Inj/SWD
 Plug Back PBD
 Commingled Docket No. CO 6973
 Dual Completion Docket No. _____
 Other (SWD or Inj?) Docket No. _____

4-5-97 -- 5-20-97
 Date of START Date Reached TD Completion Date of
of WORKOVER WORKOVER

API No. 15- 2006-0001
175-10076-0001

County SEWARD

-- - C - SW - NE Sec. 4 Twp. 34S Rge. 32 X E W

1980 Feet from S/N (circle one) Line of Section

1980 Feet from E/W (circle one) Line of Section

Footages Calculated from Nearest Outside Section Corner:
(NE) SE, NW or SW (circle one)

Lease Name ALEXANDER "B" 1 Well # 1

Field Name CODNDIT NON-PRORATED

Producing Formation CHESTER, L. MORROW

Elevation: Ground 6750 KB --

Total Depth 6252 PBD 6231

Amount of Surface Pipe Set and Cemented at 1558 Feet

Multiple Stage Cementing Collar Used? Yes No

If yes, show depth set _____ Feet

If Alternate II completion, cement circulated from _____

feet depth to _____ w/ _____ sx cmt.

Drilling Fluid Management Plan REWORK 9/8 4-10-98
(Data must be collected from the Reserve Pit)
NOT APPLICABLE

Chloride content _____ ppm Fluid volume _____ bbls

Dewatering method used _____

Location of fluid disposal if hauled offsite: _____

Operator Name _____

Lease Name _____ License No. _____

____ Quarter Sec. _____ Twp. _____ S Rng. _____ E/W

County _____ Docket No. _____

INSTRUCTIONS: An original and two copies of this form shall be filed with the Kansas Corporation Commission, 130 S. Market - Room 2078, Wichita, Kansas 67202, within 120 days of the spud date, recompletion, workover or conversion of a well. Rule 82-3-130, 82-3-106 and 82-3-107 apply. Information on side two of this form will be held confidential for a period of 12 months if requested in writing and submitted with the form (see rule 82-3-107 for confidentiality in excess of 12 months). One copy of all wireline logs and geologist well report shall be attached with this form. ALL CEMENTING TICKETS MUST BE ATTACHED. Submit CP-4 form with all plugged wells. Submit CP-111 form with all temporarily abandoned wells.

All requirements of the statutes, rules and regulations promulgated to regulate the oil and gas industry have been fully complied with and the statements herein are complete and correct to the best of my knowledge.

Signature Shawn D. Young
SHAWN D. YOUNG

Title DIVISION PRODUCTION ENGINEER Date _____

Subscribed and sworn to before me this 27th day of February
19 98.

Notary Public Shirley J. Childers

Date Commission Expires _____

NOTARY PUBLIC State of Kansas
SHIRLEY J. CHILDERS
My Appt. Exp. 11/14/98

K.C.C. OFFICE USE ONLY
F Letter of Confidentiality Attached
C Wireline Log Received
C Geologist Report Received
Distribution
 KCC SWD/Rep NGPA
 KGS Plug Other
3-4-98
(Specify)

ORIGINAL

SIDE TWO

Operator Name ANADARKO PETROLEUM CORPORATION Lease Name ALEXANDER "B" Well # 1

Sec. 4 Twp. 34S Rge. 32 East West County SEWARD

INSTRUCTIONS: Show important tops and base of formations penetrated. Detail all cores. Report all drill stem tests giving interval tested, time tool open and closed, flowing and shut-in pressures, whether shut-in pressure reached static level, hydrostatic pressures, bottom hole temperature, fluid recovery, and flow rates if gas to surface during test. Attach extra sheet if more space is needed. Attach copy of log.

Drill Stem Tests Taken Yes No (Attach Additional Sheets.)
Samples Sent to Geological Survey Yes No
Cores Taken Yes No
Electric Log Run Yes No (Submit Copy.)
List All E.Logs Run:

Log Formation (Top), Depth and Datums Sample
Name Top Datum

SEE ATTACHED DRILLER'S LOG

** Original Completion		CASING RECORD					
		<input checked="" type="checkbox"/> New <input type="checkbox"/> Used					
Report all strings set-conductor, surface, intermediate, production, etc.							
Purpose of String	Size Hole Drilled	Size Casing Set (In O.D.)	Weight Lbs./Ft.	Setting Depth	Type of Cement	# Sacks Used	Type and Percent Additives
** SURFACE	12-1/4"	8-5/8"	24.0	1558	COMMON POZMIX	200 525	2% CACL 2% CACL 4% GEL
** PRODUCTION	7-7/8"	4-1/2"	10.5	6253	POZMIX	200	.55 CFR-2

ADDITIONAL CEMENTING/SQUEEZE RECORD

Purpose: ___ Perforate ___ Protect Casing ___ Plug Back TD ___ Plug Off Zone	Depth		Type of Cement	#Sacks Used	Type and Percent Additives
	Top	Bottom			

Shots Per Foot	PERFORATION RECORD - Bridge Plugs Set/Type		Acid, Fracture, Shot, Cement Squeeze Record	
	Specify Footage of Each Interval Perforated		(Amount and Kind of Material Used)	Depth
3	5936-5944, 5955-5998, 6096-6104 (U. CHESTER)		ACID:6000 GAL 15% HCL + ADDITIVES	5863-6104
			FRAC'D:40400GAL 25# DELTA FRAC XLINKED GEL & 133000# 16/30 SMD	5863-6104
2	5863'-5916'			
TUBING RECORD	Size 2-3/8	Set At 5866	Packer At --	Liner Run <input type="checkbox"/> Yes <input checked="" type="checkbox"/> No
Date of First, Resumed Production, SMD or Inj. RESUMED: 5-14-97		Producing Method <input checked="" type="checkbox"/> Flowing <input type="checkbox"/> Pumping <input type="checkbox"/> Gas Lift <input type="checkbox"/> Other (Explain)		
Estimated Production Per 24 Hours	Oil 0 Bbls.	Gas 11 Mcf	Water 0 Bbls.	Gas-Oil Ratio -- Gravity --

Disposition of Gas: Vented Sold Used on Lease (If vented, submit ACO-18.) METHOD OF COMPLETION: Open Hole Perf. Dually Comp. Commingled 5863-6104 Other (Specify) _____ Production Interval _____

KANSAS

ALEXANDER B #1
Exhibit B

WELL COMPLETION REPORT AND
DRILLER'S LOG

ORIGINAL

API No. 15 — 175 None Assigned
County 2006 Number

S. 4 T. 34S R. 32 ^{EX} W

Loc. C SW NE

County Seward

Operator
Anadarko Production Company

Address
P. O. Box 351, Liberal, Kansas 67901

Well No. 1 Lease Name ALEXANDER "B"

Footage Location
1980 feet from (N) ~~(S)~~ line 1980 feet from (E) ~~(W)~~ line

Principal Contractor Moran Brothers Geologist B. J. Posey

Spud Date 5/26/67 Date Completed 6/15/67 Total Depth 6252 P.B.T.D. 6026'

Directional Deviation not applicable Oil and/or Gas Purchaser APC-Cimarron River System

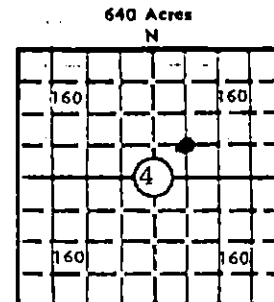

Elev.: Gr. 2750'
OF 2760' KB 2761'

CASING RECORD

Report of all strings set — surface, intermediate, production, etc.

Purpose of string	Size hole drilled	Size casing set (in O.D.)	Weight lbs/ft.	Setting depth	Type cement	Sacks	Type and percent additives
Surface	12-1/4"	8-5/8"	24#	1558'	Common Pozmix	200 525	2% CaCl 2% CaCl 4% gel
Production	7-7/8"	4-1/2"	10.5#	6253	Pozmix	200	.5% CFR-2

LINER RECORD

PERFORATION RECORD

Top, ft.	Bottom, ft.	Sacks cement	Shots per ft.	Size & type	Depth interval
			2		5863-5916'

TUBING RECORD

Size	Setting depth	Packer set at
2-3/8"	5882'	

ACID, FRACTURE, SHOT, CEMENT SQUEEZE RECORD

Amount and kind of material used	Depth interval treated
A/1000 gal 10% NE Acid. F/15,000 gal 5% gelled acid, 15,000# sand.	5863'-5916' O.A.

INITIAL PRODUCTION

Date of first production <u>7/14/67</u>	Producing method (flowing, pumping, gas lift, etc.) <u>Flowing</u>	MAR 4 1967	
RATE OF PRODUCTION PER 24 HOURS	Oil <u>None</u> bbls.	Gas <u>1040</u> MCF	Water <u>None</u> bbls.
Disposition of gas (vented, used on lease or sold) <u>Sold</u>	Gas-oil ratio <u>NA</u>	CFPB	Producing interval (s) <u>5863'-5916' O.A.</u>

INSTRUCTIONS: As provided in KCC Rule 82-2-125, within 90 days after completion of a well, one completed copy of this Drillers Log shall be transmitted to the State Geological Survey of Kansas, 4150 Monroe Street, Wichita, Kansas 67209. Copies of this form are available from the Conservation Division, State Corporation Commission, 245 No. Water, Wichita, Kansas 67202. Phone AC 316-522-2206. If confidential custody is desired, please note Rule 82-2-125. Drillers Logs will be an open file in the Oil and Gas Division, State Geological Survey of Kansas, Lawrence, Kansas 66044.

ALEXANDER B #1
 Exhibit B
 DESIGNATE TYPE OF COMP.: OIL, GAS,
 DRY HOLE, SWDW, ETC.:

Operator Anadarko Production Company		
Well No. 1	Lease Name ALEXANDER B #1	GAS
S 4 T 34S R 32 E W		

WELL LOG

Show all important zones of porosity and contents thereof; cored intervals, and all drill-stem tests, including depth interval tested, cushion used, time tool open, flowing and shut-in pressures, and recoveries.

SHOW GEOLOGICAL MARKERS, LOGS RUN, OR OTHER DESCRIPTIVE INFORMATION.

FORMATION DESCRIPTION, CONTENTS, ETC.	TOP	BOTTOM	NAME	DEPTH
Surface Sand & Red Bed	0'	850'		
Red Bed, Shells & Lime	850'	1558'		
Shale & Anhydrite	1558'	1685'		
Shale	2305'	2555'		
Dolomite- Shale	2555'	2785'		
Lime and Shale	2785'	4620'		
Lime	4620'	4858'		
Lime and Shale	4858'	4950'		
Lime	4950'	5581'		
Lime w/Shale	5581'	5703'		
Shale w/Sandy Lime	5703'	5940'		
Lime and Shale	5940'	6185'		
Lime	6185'	6252'		
Rotary Total Depth		6252'		

USE ADDITIONAL SHEETS, IF NECESSARY, TO COMPLETE WELL RECORD.

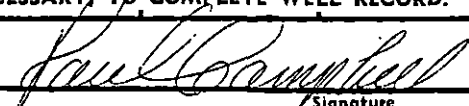
Date Received	 Signature Paul Campbell, Division Production Manager Title June 30, 1981 Date
---------------	---