

STATE CORPORATION COMMISSION OF KANSAS
OIL & GAS CONSERVATION DIVISION

WELL COMPLETION OR RECOMPLETION FORM
ACO-1 WELL HISTORY

DESCRIPTION OF WELL AND LEASE

Operator: License # 9783
Name Santa Fe Minerals, A Division of
Address Santa Fe International Corp.
13455 Noel Rd., St. 1100
City/State/Zip Dallas, Texas 75240

Purchaser Oklahoma Gas Pipeline Co.

Operator Contact Person Jim LaFavers
Phone (214) 701-7588

Contractor: License # 05382
Name Cheyenne Drilling Co.

Wellsite Geologist Gayle Tapp
Phone (918) 561-7206

Designate Type of Completion

New Well Re-Entry Workover

Oil SWD Temp Abd
 Gas Inj Delayed Comp.
 Dry Other (Core, Water Supply etc)

If OWWO: old well info as follows:

Operator
Well Name
Comp. Date Old Total Depth

WELL HISTORY

Drilling Method:

Mud Rotary Air Rotary Cable

5-20-88 5-24-88 8-1-88
Spud Date Date Reached TD Completion Date

2880 2833
Total Depth PBD

Amount of Surface Pipe Set and Cemented at 738 feet
Multiple Stage Cementing Collar Used? Yes No
If yes, show depth set.....feet
If alternate 2 completion, cement circulated
from.....feet depth to.....w/.....SX cmt
Pl J

API NO. 15-175-21006-00-00

County Seward

NW 4 Sec 20 Twp 34 Rge 34 West

3964 Ft North from Southeast Corner of Section
3956 Ft West from Southeast Corner of Section
(Note: Locate well in section plat below)

Lease Name Imbler Bros. Well # 2

Field Name Hugoton

Producing Formation Chase

Elevation: Ground 2951 KB 2960

Section Plat

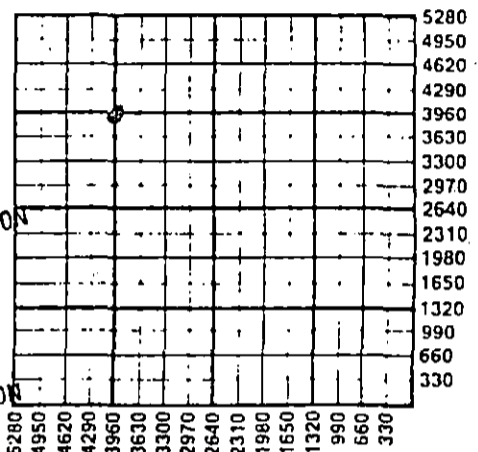

RECEIVED
STATE CORPORATION COMMISSION
AUG 10 1988
CONSERVATION DIVISION
Wichita, Kansas

WATER SUPPLY INFORMATION

Disposition of Produced Water: Disposal
Docket # Repressuring

Questions on this portion of the ACO-1 call:
Water Resources Board (913) 296-3717

Source of Water:
Division of Water Resources Permit #

Groundwater.....Ft North from Southeast Corner
(Well)Ft West from Southeast Corner of
Sec Twp Rge East West

Surface Water.....Ft North from Southeast Corner
(Stream, pond etc).....Ft West from Southeast Corner
Sec Twp Rge East West

Other (explain).....hauled in.....
(purchased from city, R.W.D. #)

INSTRUCTIONS: This form shall be completed in duplicate and filed with the Kansas Corporation Commission, 200 Colorado Derby Building, Wichita, Kansas 67202, within 90 days after completion or recompletion of any well. Rule 82-3-130 and 82-3-107 apply.
Information on side two of this form will be held confidential for a period of 12 months if requested in writing and submitted with the form. See rule 82-3-107 for confidentiality in excess of 12 months.
One copy of all wireline logs and drillers time log shall be attached with this form. Submit CP-4 form with all plugged wells. Submit CP-111 form with all temporarily abandoned wells.

All requirements of the statutes, rules and regulations promulgated to regulate the oil and gas industry have been fully complied with and the statements herein are complete and correct to the best of my knowledge.

Signature James B. LaFavers
Title Engineering Technician Date 8/8/88

Subscribed and sworn to before me this 8th day of August 1988
Notary Public Barbara D. Anderson

Date Commission Expires
BARBARA D. ANDERSON
Notary Public State of Texas
My Commission Expires June 29, 1989

K.C.C. OFFICE USE ONLY
 Letter of Confidentiality Attached
 Wireline Log Received
 Drillers Timelog Received
Distribution
 KCC SWD/Rep NGPA
 KGS Plug Other
(Specify)
8-10-88

Sec. 20 Twp. 34 Rge. 34 W. 4

CONFIDENTIAL
SIDE TWO

Operator Name Santa Fe Minerals Lease Name..... Imbler Bros. Well #..... 2

Sec. 20 Twp. 34 Rge. 34 East West County..... Seward **RELEASED**

MAR 05 1990

WELL LOG

INSTRUCTIONS: Show important tops and base of formations penetrated. Detail all cores. Report all drill stem tests giving interval tested, time tool open and closed, flowing and shut-in pressures, whether shut-in pressure reached static level, hydrostatic pressures, bottom hole temperature, fluid recovery, and flow rates if gas to surface during test. Attach extra sheet if more space is needed. Attach copy of log.

FROM CONFIDENTIAL

Drill Stem Tests Taken Yes No
 Samples Sent to Geological Survey Yes No
 Cores Taken Yes No

Formation Description
 Log Sample

Name	Top	Bottom
Blaine Gypsum	1035	
Lorietta	1165	
Stone Corral	1655	
Red Cave	1705	
Wellington	2230	
CChase Groupe	2625	

CONFIDENTIAL

CASING RECORD <input type="checkbox"/> New <input type="checkbox"/> Used							
Report all strings set-conductor, surface, intermediate, production, etc.							
Purpose of String	Size Hole Drilled	Size Casing Set (In O.D.)	Weight Lbs/Ft.	Setting Depth	Type of Cement	#Sacks Used	Type and Percent Additives
...Surface.....	12-1/4	8-5/8	24	738	Class H	200	---
					Class C	539	---
...Production..	7-7/8	5-1/2	15.5	2880	Class C	350	---
					Surfill	130	---
PERFORATION RECORD				Acid, Fracture, Shot, Cement Squeeze Record (Amount and Kind of Material Used)			
Shots Per Foot	Specify Footage of Each Interval Perforated					Depth	
2	Herington 2632-2650			3600 gal 15% HCL		2632-2650	
2	Upper Krider 2660-2676			3200 gal 28% HCL		2660-2676	
1	Lower Krider 2690-2724			6800 gal 28% HCL		2690-2724	
2	Winfield 2748-2776			5600 gals 28% HCL		2748-2776	
TUBING RECORD				Liner Run <input type="checkbox"/> Yes <input checked="" type="checkbox"/> No			
Size 2-3/8		Set At 2830		Packer at none			
Date of First Production		Producing Method					
7-28-88		<input type="checkbox"/> Flowing <input checked="" type="checkbox"/> Pumping <input type="checkbox"/> Gas Lift <input type="checkbox"/> Other (explain).....					
Estimated Production Per 24 Hours		Oil	Gas	Water	Gas-Oil Ratio	Gravity	
		0 Bbls	735 MCF	0 Bbls	CFPB		

METHOD OF COMPLETION

Production Interval

Disposition of gas: Vented Sold Used on Lease
 Open Hole Perforation Other (Specify) 2776-2632
 Dually Completed Comingled

CONFIDENTIAL

County Seward State Kansas

Township 34S Range 34W Section 20

MAR 05 1990

FROM CONFIDENTIAL

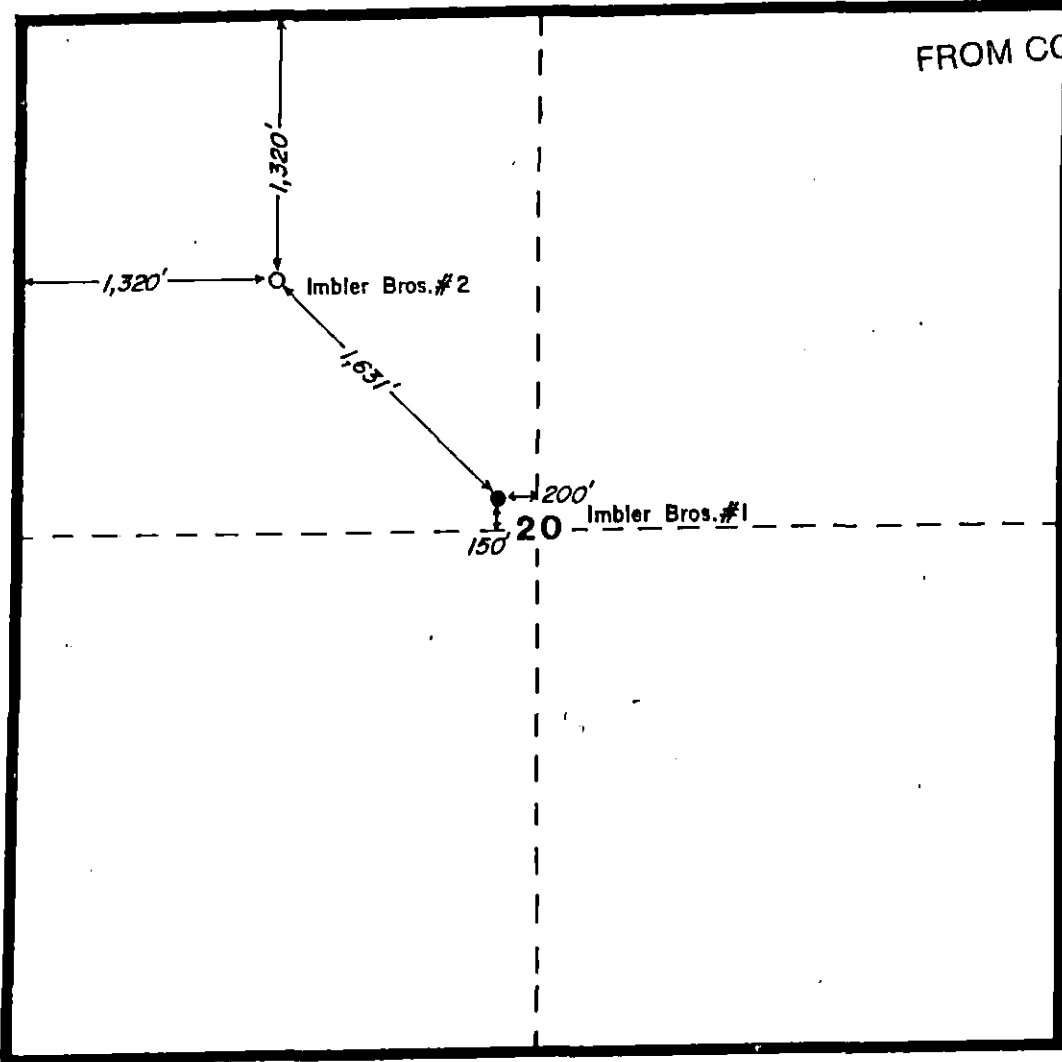

SF		Santa Fe Minerals, Inc.	
<small>A DIVISION OF SANTA FE INTERNATIONAL CORPORATION Four Columbia Square - 11000 North 42nd - Suite 1100 - Tulsa, Texas 74129</small>			
LOCATION PLAT			
DALLAS		Drawn By:	Date:
GEOL	GEOP	ELZIKI	ELZIKI
DATE	1-12-88	DATUM	
CONTOUR INT.		SCALE	1" = 1000'
		FILE NO.	

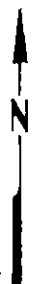

RECEIVED
CORPORATION COMMISSION
AUG 10 1988
CONSERVATION DIVISION
Wichita, Kansas

THIS PLAT WAS DRAWN IN ACCORDANCE WITH THE SURVEYING ACTS OF 1890 AND 1907

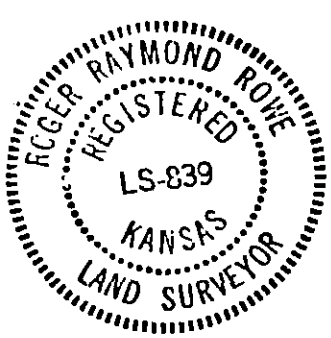

CERTIFICATE:

I, Roger R. Rowe a Registered Land Surveyor and an authorized agent of Topographic Land Surveyors, do hereby certify that the above described well location was surveyed and staked on the ground as shown herein.

Roger Rowe

AUG 9 0 1988

Kansas Reg. No. 839

KANSAS GEOLOGICAL SURVEY

TOPOGRAPHIC LAND SURVEYORS

Surveying and Mapping for the Energy Industry
 1000 E 17TH ST. • HAYS, KANSAS 67601
 TELEPHONES LOCAL (913) 825-2683 • OKLA. WATS (800) 822-4273 • OUT OF STATE WATS (800) 854-3219

SEWARD County, Kansas

RELEASED

1320'FNL-1320'FWL Section 20 Township 34S Range 34W 6th P.M.

MAR 0 5 1990

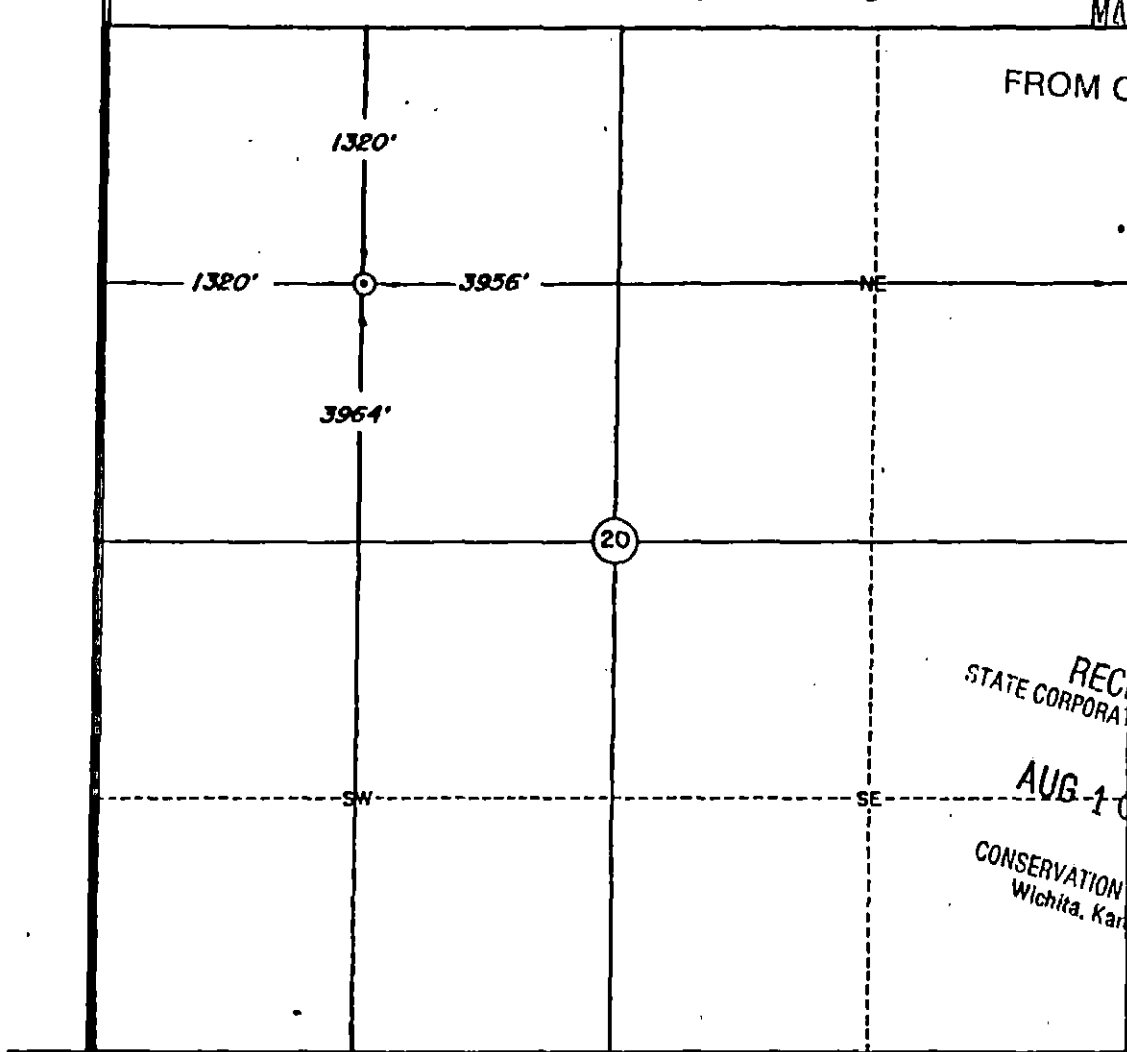

FROM CONFIDENTIAL



RECEIVED
 STATE CORPORATION COMMISSION
 AUG 10 1988
 CONSERVATION DIVISION
 Wichita, Kansas

Scale: 1" = 1000'

Date Staked December 15, 1987

This location has been very carefully staked on the ground according to the best official survey records, maps, and photographs available to us, but its accuracy is not guaranteed.

Review this plat and notify us immediately of any possible discrepancy.

Operator: SANTA FE MINERALS

ELEVATION:

2951' Gr. of Stake

Lease Name: Imbler Brothers Well No.: 2

Topography & Vegetation Location fell in wheat stubble.

Good Drill Site? Yes Reference Stakes or Alternate Location none
 Stakes Set none

Best Accessibility to Location From West.

Distance & Direction from Hwy Jct or Town From Jct. US 83-US 270 & Tucker Road (North side of Liberal), go 7 miles West & 1 mile North to the Northwest Corner of Section 20, T34S-R34W.

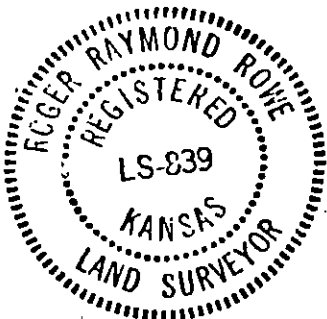

CERTIFICATE:

I, Roger R. Rowe a Registered Land Surveyor and an authorized agent of Topographic Land Surveyors, do hereby certify that the above described well location was surveyed and staked on the ground as shown herein.

Roger R. Rowe

AUG 9 0 1988

Kansas Reg. No. 839

KANSAS GEOLOGICAL SURVEY