

ORIGINAL

STATE CORPORATION COMMISSION OF KANSAS  
OIL & GAS CONSERVATION DIVISION  
WELL COMPLETION FORM  
ACO-1 WELL HISTORY  
DESCRIPTION OF WELL AND LEASE

API NO. 15- 189-21867-0000

County STEVENS  
- - - E/2 - NW Sec. 32 Twp. 33 Rge. 37 X W E

Operator: License # 5208

Name: Mobil Oil Corporation

Address P.O. Box 2173

2319 North Kansas Avenue

City/State/Zip Liberal, KS 67905-2173

Purchaser: N/A

Operator Contact Person: Sharon Cook

Phone (316) 626-1142

Contractor: Name: Catholic Protection Services

License: 31474

Wellsite Geologist: \_\_\_\_\_

Designate Type of Completion  
 New Well  Re-Entry  Workover

Oil  SWD  SIGW  Temp. Abd.  
 Gas  ENHR  SIGW  
 Dry  Other (Gore, USW, Expl., Cathodic, etc)

If Workover:

Operator: \_\_\_\_\_

Well Name: \_\_\_\_\_

Comp. Date \_\_\_\_\_ Old Total Depth \_\_\_\_\_

Deepening  Re-perf.  Conv. to Inj/SWD  
 Plug Back  PBTB  
 Commingled  Docket No. \_\_\_\_\_  
 Dual Completion  Docket No. \_\_\_\_\_  
 Other (SWD or Inj?)  Docket No. \_\_\_\_\_

1/17/95 1/17/95 1/17/95  
Spud Date Date Reached TD Completion Date

3960 FSL Feet from S/N (circle one) Line of Section  
3860 FEL Feet from E/W (circle one) Line of Section  
Footages Calculated from Nearest Outside Section Corner:  
NE, SP, NW or SW (circle one)

Lease Name CP- WILSON Well # E1

Field Name Hugoton

Producing Formation NA **[ANODE REPOSITORY]**

Elevation: Ground 3146 KB NA

Total Depth 100 PBTB NA

Amount of Surface Pipe Set and Cemented at None Feet

Multiple Stage Cementing Collar Used? NA Yes NA No

If yes, show depth set NA Feet

If Alternate II completion, cement circulated from NA

feet depth to NA w/ NA sx cmt.

Drilling Fluid Management Plan ALT 3 9/10-18-95  
(Data must be collected from the Reserve Pit)

Chloride content NA ppm Fluid volume NA bbls

Dewatering method used NA

Location of fluid disposal if hauled offsite: \_\_\_\_\_

Operator Name NA

Lease Name NA License No. \_\_\_\_\_

NA Quarter Sec. NA Twp. NA S Rng. NA E/W

County NA Docket No. NA

**INSTRUCTIONS:** An original and two copies of this form shall be filed with the Kansas Corporation Commission, 200 Colorado Derby Building, Wichita, Kansas 67202, within 120 days of the spud date, recompletion, workover or conversion of a well. Rule 82-3-130, 82-3-106 and 82-3-107 apply. Information on side two of this form will be held confidential for a period of 12 months if requested in writing and submitted with the form (see rule 82-3-107 for confidentiality in excess of 12 months). One copy of all wireline logs and geologist well report shall be attached with this form. ALL CEMENTING TICKETS MUST BE ATTACHED. Submit CP-4 form with all plugged wells. Submit CP-111 form with all temporarily abandoned wells.

All requirements of the statutes, rules and regulations promulgated to regulate the oil and gas industry have been fully complied with and the statements herein are complete and correct to the best of my knowledge.

Signature Sharon A. Cook Sharon A. Cook

Title Regulatory Assistant Date 2-13-95

Subscribed and sworn to before me this 13th day of February, 19 95.

Notary Public Kathleen R. Poulton

Date Commission Expires AUGUST 18, 1998

DEW95097.SAC

NOTARY PUBLIC - State of Kansas  
KATHLEEN R. POULTON  
My Appl. Exp. 08-18-98

**K.C.C. OFFICE USE ONLY**  
F  Letter of Confidentiality Attached  
C  Wireline Log Received  
C  Geologist Report Received  
  
Distribution  
 KCC  SWD/Rep  NGPA  
 KGS  Plug  Other  
(Specify)  
  
COMMISSION

STATE OF KANSAS  
FEB 17 1995  
2-17-95  
Form ACO-1 (7-91)

SIDE TWO

Operator Name Mobil Oil Corporation Lease Name CP- WILSON Well # E1

Sec. 32 Twp. 33 Rge. 37  East  West  
 County STEVENS

**INSTRUCTIONS:** Show important tops and base of formations penetrated. Detail all cores. Report all drill stem tests giving interval tested, time tool open and closed, flowing and shut-in pressures, whether shut-in pressure reached static level, hydrostatic pressures, bottom hole temperature, fluid recovery, and flow rates if gas to surface during test. Attach extra sheet if more space is needed. Attach copy of log.

Drill Stem Tests Taken (Attach Additional Sheets.)	<input type="checkbox"/> Yes <input checked="" type="checkbox"/> No	<input checked="" type="checkbox"/> Log	Formation (Top), Depth and Datum	<input type="checkbox"/> Sample
Samples Sent to Geological Survey	<input type="checkbox"/> Yes <input checked="" type="checkbox"/> No	Name	Top	Datum
Cores Taken	<input type="checkbox"/> Yes <input checked="" type="checkbox"/> No	SEE ATTACHED DRILLER'S LOG		
Electric Log Run (Submit Copy.)	<input type="checkbox"/> Yes <input checked="" type="checkbox"/> No			
List All E.Logs Run:				
Electric Resistance Log - Attached				

CASING RECORD <input type="checkbox"/> New <input type="checkbox"/> Used							
Report all strings set-conductor, surface, intermediate, production, etc.							
Purpose of String	Size Hole Drilled	Size Casing Set (In O.D.)	Weight Lbs./Ft.	Setting Depth	Type of Cement	# Sacks Used	Type and Percent Additives

ADDITIONAL CEMENTING/SQUEEZE RECORD				
Purpose:	Depth Top Bottom	Type of Cement	#Sacks Used	Type and Percent Additives
<input type="checkbox"/> Perforate				
<input type="checkbox"/> Protect Casing				
<input type="checkbox"/> Plug Back TD				
<input checked="" type="checkbox"/> Plug Off Zone	(1) First plug - Bentonite set at 13' - 3' plug.			
	(2) Second plug - Bentonite set at 28' - 26' plug.			

Shots Per Foot	PERFORATION RECORD - Bridge Plugs Set/Type Specify Footage of Each Interval Perforated	Acid, Fracture, Shot, Cement Squeeze Record (Amount and Kind of Material Used)	Depth
First anode set at	65', second anode at 55', third anode at 45'.		

TUBING RECORD		Size	Set At	Packer At	Liner Run	<input type="checkbox"/> Yes <input type="checkbox"/> No	
1" PVC vent from TD to 3' above surface.					NA		
Date of First, Resumed Production, SWD or Inj. Installed <u>1/17/95</u>				Producing Method <input type="checkbox"/> NA <input type="checkbox"/> Flowing <input type="checkbox"/> Pumping <input type="checkbox"/> Gas Lift <input type="checkbox"/> Other (Explain)			
Estimated Production Per 24 Hours	Oil Bbls. NA	Gas Mcf NA	Water Bbls. NA	Gas-Oil Ratio	Gravity		

Disposition of Gas:  Vented  Sold  Used on Lease (If vented, submit ACO-18.)

METHOD OF COMPLETION:  Open Hole  Perf.  Dually Comp.  Commingled

Production Interval:  Other (Specify) \_\_\_\_\_

DATA SHEET

COMPANY MOBILE & P JOB No. 80100370 DATE: 1-17-95  
 WELL: WILSON E-1 PIPELINE: \_\_\_\_\_  
 LOCATION: SEC. 32 TWP. 33 RGE. 37 CO. STEVENS STATE KS  
 ANODE TYPE LIDA ONE FT: ROTARY 100 FT: CASING \_\_\_\_\_ FT.

DEEP GROUND BED LOGGING DATA

DRILL. DEPTH LOG (FT)	ANODE TO STRUCTURE			ANODES NO	TOP DEPTH	DRILL DEPTH LOG (FT)	ANODE TO STRUCTURE		
	EXPLOR	FINAL					EXPLOR	FINAL	
	OHM	OHM					OHM	OHM	
5					205				
<u>HOLE PLUG</u> 10					210				
<u>EARTH FILL</u> 15					215				
20					220				
<u>HOLE PLUG</u> 25					225				
30	<u>.320</u>				230				
35	<u>.540</u>				235				
40	<u>1.05</u>				240				
45	<u>1.24</u>			<u>3</u>	245				
50	<u>1.21</u>				250				
55	<u>1.45</u>			<u>2</u>	255				
60	<u>1.05</u>				260				
65	<u>.440</u>			<u>1</u>	265				
70	<u>.150</u>				270				
75	<u>.210</u>				275				
80	<u>.160</u>				280				
85	<u>.120</u>				285				
90					290				
95					295				
100					300				
105					305				
110					310				
115					315				
120					320				
125					325				
130					330				
135					335				
140					340				
145					345				
150					350				
155					355				
160					360				
165					365				
170					370				
175					375				
180					380				
185					385				
190					390				
195					395				
200					400				

PIT CLOSED 1-17-95

HOLE PLUG SET 1-17-95

COINS

0-80 Clay  
80-100 Sand

ORIGINAL

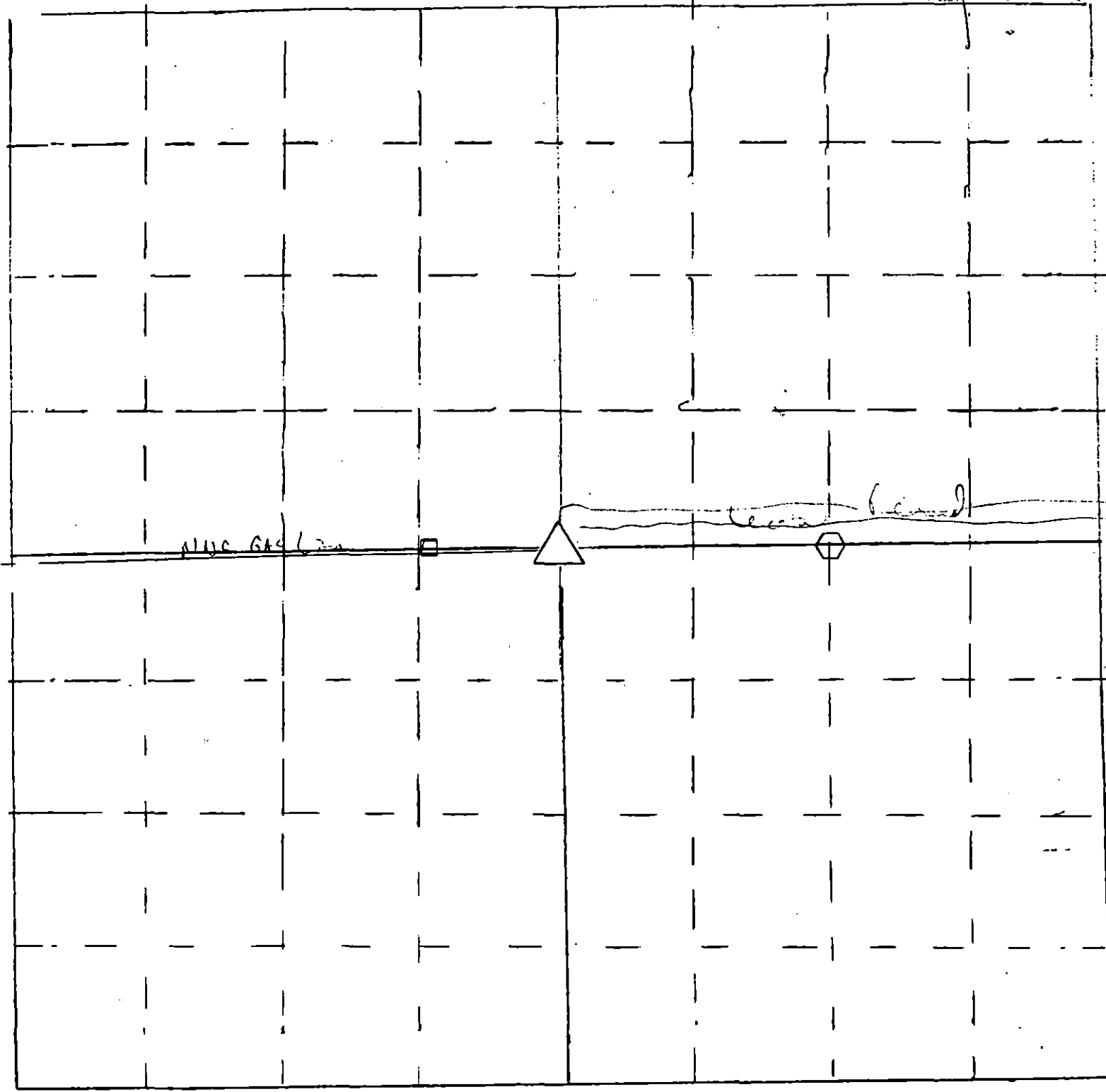
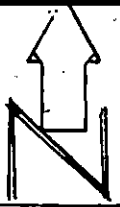

- △ = gas well location
- ⬡ = cathodic deep well location

Scale = 1" = 50'  
□ = Meter house