

2/17/86
2-17-87
2/17/88

RELEASED

STATE CORPORATION COMMISSION OF KANSAS
Date: MAR 1 1988 OIL & GAS CONSERVATION DIVISION

FROM CONFIDENTIAL
WELL COMPLETION OR RECOMPLETION FORM
ACO-1 WELL HISTORY

DESCRIPTION OF WELL AND LEASE

Operator: License # 4549
Name Anadarko Petroleum Corp.
Address Box 351
City/State/Zip Liberal, Kansas 67901

Purchaser: NA

Operator Contact Person Paul Gatlin
Phone (316) 624-6253

Contractor: License # 7860
Name Johnson Drilling Company, Inc.

Wellsite Geologist Charles E. Isbon
Phone (405) 340-0165

Designate Type of Completion
 New Well Re-Entry Workover
 Oil SWD Temp Abd
 Gas Inj Delayed Comp.
 Dry Other (Core, Water Supply etc.)

If OWWO: old well info as follows:
Operator
Well Name
Comp. Date Old Total Depth

WELL HISTORY

Drilling Method:
 Mud Rotary Air Rotary Cable

..11/5/85... ..11/16/85... ..11/17/85...
Spud Date Date Reached TD Completion Date
6210..... 0.....
Total Depth PBDT

Amount of Surface Pipe Set and Cemented at 1649 feet
Multiple Stage Cementing Collar Used? Yes No
If yes, show depth set.....feet
If alternate 2 completion, cement circulated
from.....feet depth to.....w/.....SX cmt

API NO. 15-129-20,777-00-00
County Morton
C NW NW Sec 27 Twp 33S Rge 40 East West

4620 Ft North from Southeast Corner of Section
4620 Ft West from Southeast Corner of Section
(Note: Locate well in section plat below)

Lease Name Mangels "B" Well # 1

Field Name Sandy Loam Prospect

Producing Formation

Elevation: Ground 3303 KB 3313

Section Plat

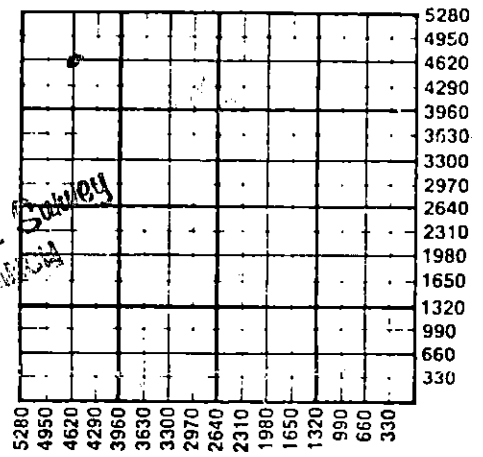

WATER SUPPLY INFORMATION

Disposition of Produced Water: Disposal Repressuring
Docket #

Questions on this portion of the ACO-1 call:
Water Resources Board (913) 296-3717

Source of Water:
Division of Water Resources Permit # T85-938

Groundwater 4470 Ft North from Southeast Corner
(Well) 4560 Ft West from Southeast Corner of
Sec 27 Twp 33S Rge 40 East West

Surface Water.....Ft North from Southeast Corner
(Stream, pond etc).....Ft West from Southeast Corner
Sec Twp Rge East West

Other (explain).....
(purchased from city, R.W.D. #)

INSTRUCTIONS: This form shall be completed in duplicate and filed with the Kansas Corporation Commission, 200 Colorado Derby Building, Wichita, Kansas 67202, within 90 days after completion or recompletion of any well. Rule 82-3-130 and 82-3-107 apply. Information on side two of this form will be held confidential for a period of 12 months if requested in writing and submitted with the form. See rule 82-3-107 for confidentiality in excess of 12 months. One copy of all wireline logs and drillers time log shall be attached with this form. Submit CP-4 form with all plugged wells. Submit CP-111 form with all temporarily abandoned wells.

All requirements of the statutes, rules and regulations promulgated to regulate the oil and gas industry have been fully complied with and the statements herein are complete and correct to the best of my knowledge.

Signature Paul Campbell
Title Division Production Manager Date 12/4/85

Subscribed and sworn to before me this 4th day of December 1985
Notary Public Elizabeth J. Hansen
Date Commission Expires 7/26/87

K.C.C. OFFICE USE ONLY
 Letter of Confidentiality Attached
 Wireline Log Received
 Drillers Time Log Received
 KCC SWD/Rep NGPA
 KGS Plug Other
(Specify)

Sec 271
Page 1/1

Operator Name Anadarko Petroleum Corporation Lease Name Mangels "B" Well # 1

Sec. 27 Twp. 33S Rge. 40 East West County Morton

WELL LOG

INSTRUCTIONS: Show important tops and base of formations penetrated. Detail all cores. Report all drill stem tests giving interval tested, time tool open and closed, flowing and shut-in pressures, whether shut-in pressure reached static level, hydrostatic pressures, bottom hole temperature, fluid recovery, and flow rates if gas to surface during test. Attach extra sheet if more space is needed. Attach copy of log.

Drill Stem Tests Taken Yes No
 Samples Sent to Geological Survey Yes No
 Cores Taken Yes No

Formation Description
 Log Sample

Gearhart ran Dual Induction Laterolog and Compensated Density Compensated Neutron Log

Name	Top	Bottom
Surface, Clay & Sand	0'	266'
Clay & Redbed	266'	639'
Redbed, Sand & Shale	639'	1640'
Anhydrite	1640'	1650'
Shale	1650'	2342'
Lime & Shale	2342'	6210'

RELEASED

MAR 22 1988

FROM CONFIDENTIAL

CASING RECORD <input checked="" type="checkbox"/> New <input type="checkbox"/> Used Report all strings set-conductor, surface, intermediate, production, etc.							
Purpose of String	Size Hole Drilled	Size Casing Set (in O.D.)	Weight Lbs/Ft.	Setting Depth	Type of Cement	#Sacks Used	Type and Percent Additives
Surface	12-1/4	8-5/8	24	1649	Pozmix Class H	550 200	4% CaCl 3% CaCl
PERFORATION RECORD				Acid, Fracture, Shot, Cement Squeeze Record			
Shots Per Foot	Specify Footage of Each Interval Perforated			(Amount and Kind of Material Used)			Depth
TUBING RECORD				Liner Run <input type="checkbox"/> Yes <input type="checkbox"/> No			
Date of First Production		Producing Method <input type="checkbox"/> Flowing <input type="checkbox"/> Pumping <input type="checkbox"/> Gas Lift <input type="checkbox"/> Other (explain).....					
Estimated Production Per 24 Hours		Oil Bbls	Gas MCF	Water Bbls	Gas-Oil Ratio	Gravity	

METHOD OF COMPLETION

Production Interval

Disposition of gas: Vented Open Hole Perforation
 Sold Other (Specify)
 Used on Lease

Dually Completed
 Commingled

STATE COMMISSION

OFF 3 1985

JOHNSON *Drilling Company, Inc.*



OFFICES IN
EVANSVILLE, INDIANA
TEL (812) 428-4911
OKLAHOMA CITY, OKLAHOMA
TEL (405) 943-7667

REPLY TO:

3535 N. W. 58th - Suite 710
Oklahoma City, Oklahoma 73112

CONFIDENTIAL

November 20, 1985

Anadarko Petroleum Corporation
P. O. Box 351
Liberal, Kansas 67901

Attn: Mr. Paul Gatlin

RECEIVED
NOV 22 1985
PRODUCTION DEPT.
LIBERAL, KANSAS

DRILLERS LOG for:

Mangels "B" # 1
Section 27-33S-40W
Morton County, Kansas

0' - 266'
266' - 639'
639' - 1640'
1640' - 1650'
1650' - 2342'
2342' - 6210'

Surface, Clay, & Sand
Clay & Redbed
Redbed, Sand, & Shale
Anhydrite
Shale
Lime & Shale

NOV 11 1985
U.S. Geological Survey
WICHITA BRANCH

JOHNSON DRILLING COMPANY, INC.

Signed by: Claude D. Moore
Claude D. Moore, Manager

STATE OF OKLAHOMA:

COUNTY OF OKLAHOMA:

Subscribed and sworn to before me this 20th day of November, 1985.

Paul R. H. Notary Public

My Commission Expires:

12-19-85

STATE CORPORATION COMMISSION

DEC 9 1985

CONSERVATION DIVISION
Wichita, Kansas

RELEASED

MAR 22 1988

FROM CONFIDENTIAL