

AMENDED REPORT

TYPE

AFFIDAVIT OF COMPLETION FORM

ACO-1 WELL HISTORY

SIDE ONE

Compt. _____

Two (2) copies of this form shall be filed with the Kansas Corporation Commission, 200 Colorado Derby Building, Wichita, Kansas 67202, within thirty (30) days after the completion of a well, regardless of how the well was completed.

F Attach separate letter of request if the information is to be held confidential. If confidential, only file one copy. Information on Side One will be of public record and Side Two will then be held confidential.

Applications must be made on dual completion, commingling, salt water disposal, injection and temporarily abandoned wells.

C Attach one copy only wireline logs (i.e. electrical log, sonic log, gamma ray neutron log, etc.). (Rules 82-2-105 & 82-2-125) KCC# (316) 263-3238. No Log

LICENSE # 5208 EXPIRATION DATE 6/30/83

OPERATOR Mobil Oil Corporation API NO. 15-189-20547-00-00

ADDRESS P. O. Box 5444 COUNTY Stevens

Denver, CO 80217 FIELD Walkemeyer

** CONTACT PERSON C. J. Park PROD. FORMATION Morrow
PHONE 303/572-2696

PURCHASER Northern Natural Gas LEASE Flower Unit #1

ADDRESS 2223 Dodge Street WELL NO. #2

Omaha, Nebraska 68102 WELL LOCATION C NE/4

DRILLING Zenith Drilling Corporation 1320 Ft. from North Line and

CONTRACTOR 505 4th Financial Center 1321 Ft. from East Line of

ADDRESS Wichita, Kansas 67202 the NE/4 (Qtr.) SEC 22 TWP 33S RGE 36W (W).

PLUGGING - WELL PLAT

CONTRACTOR (Office Use Only)

ADDRESS KCC

TOTAL DEPTH 6284' PBTB 6223'

SPUD DATE 9/5/81 DATE COMPLETED 6/7/82

ELEV: GR 3042' DF KB 3053'

DRILLED WITH (CABLE) (ROTARY) (AIR) TOOLS.

DOCKET NO. OF DISPOSAL OR REPRESSURING WELL BEING USED TO DISPOSE OF WATER FROM THIS LEASE CD - 3805 (C - 19820)

Amount of surface pipe set and cemented 1763' DV Tool Used? No

THIS AFFIDAVIT APPLIES TO: (Circle ONE) - Oil, Gas, Shut-in Gas, Dry, Disposal, Injection, Temporarily Abandoned, OWWO. Other

ALL REQUIREMENTS OF THE STATUTES, RULES AND REGULATIONS PROMULGATED TO REGULATE THE OIL AND GAS INDUSTRY HAVE BEEN FULLY COMPLIED WITH.

A F F I D A V I T

C. J. Park, being of lawful age, hereby certifies that:

I am the Affiant, and I am familiar with the contents of the foregoing Affidavit. The statements and allegations contained therein are true and correct.

C. J. Park
(Name)

SUBSCRIBED AND SWORN TO BEFORE ME this 23 day of March, 1983.

Judith A. Olsen
(NOTARY PUBLIC)

MY COMMISSION EXPIRES: 11-28-84

RECEIVED
STATE CORPORATION COMMISSION

** The person who can be reached by phone regarding any questions concerning this information.

MAR 28 1983
3-28-83
CONSERVATION DIVISION
Wichita, Kansas

FORMATION DESCRIPTION, CONTENTS, ETC.		TOP	BOTTOM	NAME	DEPTH
X Check if no Drill Stem Tests Run.					
Sand		0	40	Council Grove	3976
Sand & Red Bed		40	830	Wabanusee	3450
Red Bed		830	1763	Topeka	3754
Lime & Shale		1763	6280	Heebner	4169
				Toronto	4221
				Marmathon	5066
				Morrow	5778
				Morrow Sand	6108
				Chester	6174

If additional space is needed use Page 2, Side 2

Report of all strings set— surface, intermediate, production, etc. CASING RECORD (New) or (Used)

Purpose of string	Size hole drilled	Size casing set (in O.D.)	Weight lbs/ft.	Setting depth	Type cement	Sacks	Type and percent additives
Surface csg.	12 1/4"	8 5/8"	24#	1763'	Class H	550	12% Gel+ 3% CaCl ₂
Prod. csg.	7 7/8"	5 1/2"	DV @ 14#	3265	Class H	200	3% CaCl ₂
				6280	1st Stage-	250	Salt Sat.+1/4#/sk
					Class H		Flocele+15 scratcers
					2nd Stage		
					Halliburton	500	1/4#/sk flocele
					Class H	200	18% salt + .75 CFP

LINER RECORD

PERFORATION RECORD

Top, ft.	Bottom, ft.	Sacks cement	Shots per ft.	Size & type	Depth interval
			2/ft.		6108-32'
Size	short string	Setting depth	2/ft.		
2 1/16" long	string	6062'			6141-49'
		6170'			

ACID, FRACTURE, SHOT, CEMENT SQUEEZE RECORD

Amount and kind of material used	Depth interval treated
2500 gal. MOD - 101 - with 85 ball sealers.	6108/6149'
Fraced with 80,000 gals. versagel 1400 with 135,000# 20/40.	

Date of first production	Producing method (flowing, pumping, gas lift, etc.)	Gravity
7-22-82		70.30
Estimated Production -I.P.	Oil	Gas
	bbbls.	1033 MCF
	Water	%
	Gas-oil ratio	bbbls.
Disposition of gas (vented, used on lease or sold)	Perforations	CFPB
	6108/6149'	

AMENDED REPORT

TYPE

AFFIDAVIT OF COMPLETION FORM

ACO-1 WELL HISTORY

Compt. _____

SIDE ONE

Two (2) copies of this form shall be filed with the Kansas Corporation Commission, 200 Colorado Derby Building, Wichita, Kansas 67202, within thirty (30) days after the completion of a well, regardless of how the well was completed.

F Attach separate letter of request if the information is to be held confidential. If confidential, only file one copy. Information on Side One will be of public record and Side Two will then be held confidential.

Applications must be made on dual completion, commingling, salt water disposal, injection and temporarily abandoned wells.

C Attach one copy only wireline logs (i.e. electrical log, sonic log, gamma ray neutron log, etc.). (Rules 82-2-105 & 82-2-125) KCC# (316) 263-3238. No Log

LICENSE # 5208 EXPIRATION DATE 6/30/83

OPERATOR Mobil Oil Corporation API NO. 15-189-20547

ADDRESS P. O. Box 5444 COUNTY Stevens

Denver, CO 80217 FIELD Walkemeyer

** CONTACT PERSON C. J. Park PROD. FORMATION Morrow
PHONE 303/572-2696

PURCHASER Northern Natural Gas LEASE Flower Unit #1

ADDRESS 2223 Dodge Street WELL NO. #2

Omaha, Nebraska 68102 WELL LOCATION C NE/4

DRILLING Zenith Drilling Corporation 1320 Ft. from North Line and

CONTRACTOR CONTRACTOR 1321 Ft. from East Line of

ADDRESS 505 4th Financial Center the NE/4 (Qtr.) SEC 22 TWP 33S RGE 36W (W).

Wichita, Kansas 67202

PLUGGING -

CONTRACTOR

ADDRESS

WELL PLAT

(Office Use Only)

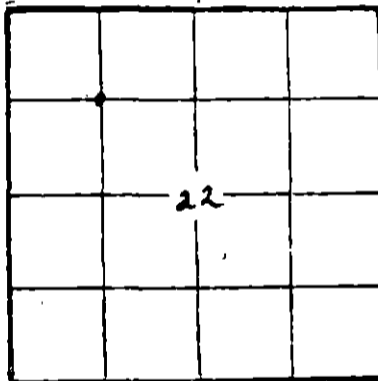

KCC

KGS

SWD/REP

PLG.

TOTAL DEPTH 6284' PBD 6223'

SPUD DATE 9/5/81 DATE COMPLETED 6/7/82

ELEV: GR 3042' DF KB 3053'

DRILLED WITH (CABLE) (ROTARY) (AIR) TOOLS.

DOCKET NO. OF DISPOSAL OR REPRESSURING WELL BEING USED TO DISPOSE OF WATER FROM THIS LEASE CD-3805 (C-1982-05)

Amount of surface pipe set and cemented 1763' DV Tool Used? No

THIS AFFIDAVIT APPLIES TO: (Circle ONE) - Oil, Gas, Shut-in Gas, Dry, Disposal, Injection, Temporarily Abandoned, OWWO. Other

ALL REQUIREMENTS OF THE STATUTES, RULES AND REGULATIONS PROMULGATED TO REGULATE THE OIL AND GAS INDUSTRY HAVE BEEN FULLY COMPLIED WITH.

AFFIDAVIT

C. J. Park, being of lawful age, hereby certifies

that:

I am the Affiant, and I am familiar with the contents of the foregoing Affidavit. The statements and allegations contained therein are true and correct.

(Name)

SUBSCRIBED AND SWORN TO BEFORE ME this 23 day of March

1983.

(NOTARY PUBLIC)

MY COMMISSION EXPIRES: 11-28-84

** The person who can be reached by phone regarding any questions concerning this information.

RECEIVED STATE CORPORATION COMMISSION

APR 12 1983

CONSERVATION DIVISION Wichita, Kansas

SHOW GEOLOGICAL MARKERS, LOGS RUN, OR OTHER DESCRIPTIVE INFORMATION.

FORMATION DESCRIPTION, CONTENTS, ETC.	TOP	BOTTOM	NAME	DEPTH
X Check if no Drill Stem Tests Run.				
Sand	0	40	Council Grove	3976
Sand & Red Bed	40	830	Wabanusee	3450
Red Bed	830	1763	Topeka	3754
Lime & Shale	1763	6280	Heebner	4169
			Toronto	4221
			Marmathon	5066
			Morrow	5778
			Morrow Sand	6108
			Chester	6174

If additional space is needed use Page 2, Side 2

Report of all strings set — surface, intermediate, production, etc. CASING RECORD (New) or (Used)

Purpose of string	Size hole drilled	Size casing set (in O.D.)	Weight lbs/ft.	Setting depth	Type cement	Sacks	Type and percent additives
Surface csg.	12 1/4"	8 5/8"	24#	1763'	Class H	550	12% Gel+ 3% CaCl ₂
Prod. csg.	7 7/8"	5 1/2"	14#	3265'	1st Stage-	200	3% CaCl ₂
					Class H	250	Salt Sat. + 1/4#/sk
					2nd Stage		Flocele + 15 scratcers
					Halliburton	500	1/4#/sk flocele
					Class H	200	18% salt + .75 CFP

LINER RECORD

PERFORATION RECORD

Top, ft.	Bottom, ft.	Sacks cement	Shots per ft.	Size & type	Depth interval
			2/ft.		6108-32'
			2/ft.		6141-49'

TUBING RECORD

Size	Length	Weight	Packer set at
2 1/16" long	short string	6062'	2/ft.
	string	6170'	2/ft.

ACID, FRACTURE, SHOT, CEMENT SQUEEZE RECORD

Amount and kind of material used	Depth interval treated
2500 gal. MOD - 101 - with 85 ball sealers.	6108/6149'
Faced with 80,000 gals. versagel 1400 with 135,000# 20/40.	

Date of first production	Producing method (flowing, pumping, gas lift, etc.)	Gravity
7-22-82		
Estimated Production - I.P.	Oil	Gas
	bbbls.	1033 MCF
Disposition of gas (vented, used on lease or sold)	Water	Gas-oil ratio
	%	bbbls. CFPB
	Perforations	
	6108/6149'	

WELL COMPLETION REPORT AND
DRILLER'S LOG

S. 22 T. 33S R. 36 W

API No. 15 — 189 — 20,547
County Number

Loc. NE/4

County Stevens

Operator
Mobil Oil Corporation

Address
P. O. Box 5444 Denver, Co. 80217

Well No. 2 Lease Name Flower No. 1 Unit

Footage Location
1320 feet from (N) (S) line 1321 feet from (E) (W) line

Principal Contractor Zenith Drilling Co. Geologist V. C. Andresen

Spud Date 9/5/81 Date Completed 12/2/81 Total Depth 6280' P.B.T.D. 6223'

Directional Deviation 1/2° @ 2550'; 3/4° @ 4270' Oil and/or Gas Purchaser Northern Natural Gas

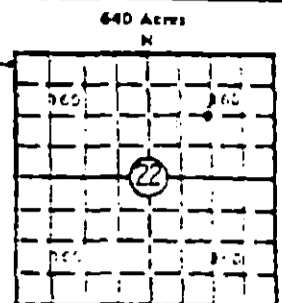

Elev.: Gr. 3042'

DF KB 3052'

CASING RECORD

Report of all strings set—surface, intermediate, production, etc.

Purpose of string	Size hole drilled	Size casing set (in O.D.)	Weight lbs./ft.	Setting depth	Type cement	Sacks	Type and percent additives
Surface casing	12-1/4"	8-5/8"	24#	1763'	Class H Class H	550 200	12% Gel + 3% CaCl ₂ 3% CaCl ₂
Prod. casing	7-7/8"	5-1/2"	14#	DV @ 3265' 6280'	1st Stage- Class H	250	Salt Sat. + 1/4#/s Flocele + 15 scrat chers
					2nd Stage Halliburton lite	500	1/4#/sk Flocele
					Class H	200	18% salt + .75 CFP

LINER RECORD

PERFORATION RECORD

Top, ft.	Bottom, ft.	Sacks cement	Shots per ft.	Size & type	Depth interval
			2		6181-6184 (Chester)
			2		6193-6196

TUBING RECORD

Size	Setting depth	Packer set at
2-7/8"	6184'	6190'

ACID, FRACTURE, SHOT, CEMENT SQUEEZE RECORD

Amount and kind of material used	Depth interval treated
750 g MCA acid; 6 M gal. MOD 202 acid + 6	6181-6196
Verijel 1500 w/1500 SCF CO ₂ /bbl. fluid; 6 ball sealers	

INITIAL PRODUCTION

Date of first production 12/2/81	Producing method (flowing, pumping, gas lift, etc.) Flowing
RATE OF PRODUCTION PER 24 HOURS	Oil Gas Estimate 1200 Water MCF Gas-oil ratio CFPB
Disposition of gas (vented, used on lease or sold) Sold	Producing interval (s) 6181-6196

INSTRUCTIONS: As provided in KCC Rule 82-2-125, within 90 days after completion of a well, one completed copy of this Driller's Log shall be transmitted to the State Geological Survey of Kansas, 4150 Monroe Street, Wichita, Kansas 67209. Copies of this form are available from the Conservation Division, State Corporation Commission, 245 No. Water, Wichita, Kansas 67202. Phone AC 316-522-2206. If confidential custody is desired, please note Rule 82-2-125. Driller's Logs will be on open file in the Oil and Gas Division, State Geological Survey of Kansas, Lawrence, Kansas 66044.

C-10-1972

RECEIVED
COMMISSION

APR 17 1983

Oil Division
Wichita, Kansas

Operator: Mobil Oil Corporation
 DESIGNATE TYPE OF COMP.: Oil Gas
 DRY HOLE, SWDW, ETC.:
 Gas/condensate

Well No. 2 Lease Name: Flower No. 1 Unit

S 22 T 33S R 36 ^{XX} W

WELL LOG

Show all important zones of porosity and contents thereof; cased intervals, and all drill-stem tests, including depth interval tested, cushion used, time tool open, flowing and shut-in pressures, and recoveries.

SHOW GEOLOGICAL MARKERS, LOGS RUN, OR OTHER DESCRIPTIVE INFORMATION.

FORMATION DESCRIPTION, CONTENTS, ETC.	TOP	BOTTOM	NAME	DEPTH
Sand	0	40	Council Grove	3976
Sand & Red Bed	40	830	Wabanusee	3450
Red Bed	830	1763	Topeka	3754
Lime & Shale	1763	6280	Heebner	4169
			Toronto	4221
			Marmaton	5066
			Morrow	5778
			Morrow Sand	6108
			Chester	6174

USE ADDITIONAL SHEETS, IF NECESSARY, TO COMPLETE WELL RECORD.

Date Received	Signature: <u>C. J. Park</u>	C. J. Park
	Title: <u>Producing Accounting Supervisor</u>	
	Date: <u>12-10-81</u>	

