

This form shall be filed in duplicate with the Kansas Corporation Commission, 200 Colorado Derby Building, Wichita, Kansas 67202, within ten days after the completion of the well, regardless of how the well was completed.

Attach separate letter of request if the information is to be held confidential. If confidential, only file one copy. Information on side one will be of public record and side two will then be held confidential.

Circle one: Oil, Gas, Dry, SWD, OWWO, Injection. Type and complete ALL sections.

Applications must be filed for dual completion, commingling, SWD and injection, T.A.

Attach wireline logs (i.e. electrical log, sonic log, gamma ray neutron log, etc.). KCC # (316) 263-3238. (Rules 82-2-105 & 82-2-125)

OPERATOR McCoy Petroleum Corporation

API NO. 15-077-20,783-00-00

ADDRESS Suite 410 / One Main Place

COUNTY Harper

Wichita, Kansas 67202

FIELD Wildcat

**CONTACT PERSON Roger McCoy

PROD. FORMATION Ft. Scott

PHONE 316-265-9697

LEASE Gates "C"

PURCHASER Koch Oil Co. (Oil) Peoples (Gas)

WELL NO. 1

ADDRESS Wichita, Kansas

WELL LOCATION C NW SE

DRILLING Sweetman Drilling, Inc.

1980 Ft. from South Line and

CONTRACTOR

1980 Ft. from East Line of

ADDRESS Suite 410 / One Main Place

the SE/4 SEC. 2 TWP. 34 RGE. 8W

Wichita, Kansas 67202

WELL PLAT

PLUGGING

CONTRACTOR

ADDRESS

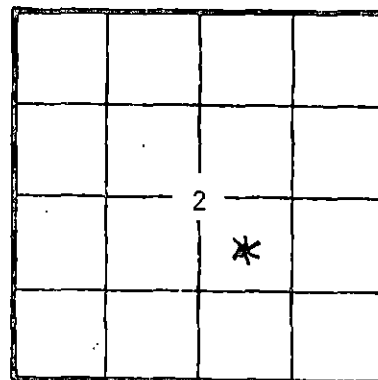

KCC [check]
KGS [check]
(Office Use)

TOTAL DEPTH 4797' PBD 4760'

SPUD DATE 2-13-82 DATE COMPLETED 3-26-82

ELEV: GR 1398' DF 1405' KB 1408'

DRILLED WITH () (ROTARY) () TOOLS

Amount of surface pipe set and cemented 266' DV Tool Used? No

AFFIDAVIT

STATE OF Kansas, COUNTY OF Sedgwick SS, I,

John Roger McCoy OF LAWFUL AGE, BEING FIRST DULY SWORN UPON HIS OATH,

DEPOSES THAT HE IS President () (OF) McCoy Petroleum Corporation

OPERATOR OF THE Gates "C" LEASE, AND IS DULY AUTHORIZED TO MAKE

THIS AFFIDAVIT FOR AND ON THE BEHALF OF SAID OPERATOR, THAT WELL NO. 1 ON

SAID LEASE, WAS COMPLETED AS OF THE 26th DAY OF March, 1982, AND THAT

ALL INFORMATION ENTERED HEREIN WITH RESPECT TO SAID WELL IS TRUE AND CORRECT.

FURTHER AFFIRMED WITH NOT.

CONSERVATION DIVISION
Wichita, Kansas

SUBSCRIBED AND SIGNED BEFORE ME THIS 19th DAY OF April, 1982.

(S) John Roger McCoy
April 19 1982

Christina Louise Sollars
NOTARY PUBLIC

APR 29 1982

MY COMMISSION EXPIRES:



**The person who can be reached by phone regarding any questions concerning this information. Within 45 days of completion, a witnessed initial test by the Commission is required if the well produces more than 25 BOPD or is located in a Basic Order Pool.

WELL LOG

Show all important zones of porosity and contents thereof; corad intervals, and all drill-stem tests, including depth interval tested, cushion used, time tool open, flowing and shut-in pressures, and recoveries.

SHOW GEOLOGICAL MARKERS, LOGS RUN, OR OTHER DESCRIPTIVE INFORMATION.

FORMATION DESCRIPTION, CONTENTS, ETC.	TOP	BOTTOM	NAME	DEPTH
See attached report.				

Report of all strings set — surface, intermediate, production, etc. **CASING RECORD** (New) or ()

Purpose of string	Size hole drilled	Size casing set (in O.D.)	Weight lbs/ft.	Setting depth	Type cement	Sacks	Type and percent additives
Surface	12-1/4"	8-5/8"	24#	266'	Common	200	2% gel, 3% cc
Production	7-7/8"	4-1/2"	10.5#	4795'	Common	175	1/4# Flocele/Sack

LINER RECORD

PERFORATION RECORD

Top, ft.	Bottom, ft.	Sacks cement	Shots per ft.	Size & type	Depth interval
			4	SSB Jet	4487-4492'

Size	Setting depth	Packer set at
2-3/8" EUE	4491'	None

ACID, FRACTURE, SHOT, CEMENT SQUEEZE RECORD

Amount and kind of material used	Depth interval treated
1,000 gallons 15% HCL	4487-4492'

Date of first production 3-24-82	Producing method (flowing, pumping, gas lift, etc.) Pump	Gravity 50°
RATE OF PRODUCTION PER 24 HOURS	Oil 130 BOPD	Gas 166 bbls.
	Water 0 MCF	Gas-oil ratio 12.77 CFPB
Disposition of gas (vented, used on lease or sold) Will be sold		Perforations 4487-4492' (Ft. Scott)



Natural Gas • Crude Oil
Exploration & Production

McCOY PETROLEUM CORPORATION

One Main Place / Suite 410 Wichita, Kansas 67202

John Roger McCoy
President

316-265-9697

Harvey H. McCoy
Vice-President

DAILY REPORT

McCoy Petroleum Corporation
#1 Gates "C"
C NW SE Section 2-34S-8W
Wharton Pool Extension
Harper County, Kansas
API # 15-077-20,783

Contractor: Sweetman Drilling, Inc.
Geologist: Robert E. McCann

Elevations: 1408 KB 1405 DF 1398 GL

- 02-13-82 Move in Rotary Tools. Rig up. Spud @ 5:30 P.M. Set new 8-5/8" OD, 24# surface casing @ 266'. Halliburton cement with 200 sacks common cement, 2% gel, 3% calcium chloride. Cement circulated. P.D. @ 11:30 P.M.
- 02-14-82 W.O.C. @ 266'.
- 02-15-82 Drilling @ 1839'.
- 02-16-82 Drilling @ 2646'.
- 02-17-82 Drilling @ 3386'.
- 02-18-82 Drilling @ 3978'.
- 02-19-82 Drilling @ 4403'.

SAMPLE TOPS

Heebner	3484(-2076)
Stalnaker Sand	3834(-2426)
Kansas City	4077(-2669)
Stark Shale	4228(-2820)
Ft. Scott	4493(-3085)
Cherokee	4502(-3094)
Mississippian	4669(-3261)
RTD	4800(-3392)

McCoy Petroleum Corporation
#1 Gates "C"
C NW SE Section 2-34S-8W
Wharton Pool Extension
Harper County, Kansas
API # 15-077-20,783

Page 2

02-20-82 Taking DST #1 @ 4510'.

DST #1 4482-4510' (Ft. Scott)
Open 30", S.I. 45", Open 60", S.I. 60"
Gas to surface in 4 minutes
Gauge 521,000 CFG in 10 minutes on 1st open,
473,000 CFG in 20 minutes,
429,000 CFG in 30 minutes,
Gauge 493,000 CFG in 10 minutes on 2nd open,
493,000 CFG in 20 minutes,
440,000 CFG in 30 minutes,
381,000 CFG in 40 minutes,
260,000 CFG in 50 minutes,
197,000 CFG in 60 minutes.
Recovered 1,800 feet of fluid as follows:
1,676 feet of gassy oil,
124 feet of heavily oil cut mud.
ISIP 1657# FSIP 1573#
FP 211-211# 275-338#

02-21-82 Drilling @ 4676'.

DST #2 4671-4712' (Mississippian)
Open 30", S.I. 45", Open 60", S.I. 60"
Weak blow.
Recovered 20 feet of mud.
ISIP 73# FSIP 63#
FP 63-63# 63-63#

02-22-82 Taking DST #3 @ 4750'.

DST #3 4712-4750' (Mississippian)
Open 30", S.I. 45", Open 60", S.I. 60"
Weak blow increasing to good.
Recovered 1,300 feet of gas in pipe,
65 feet of heavily oil cut mud,
62 feet of heavily oil cut mud, slightly watery,
62 feet of oil cut muddy water.
ISIP 1741# FSIP 1752#
FP 105-105# 126-126#

McCoy Petroleum Corporation
#1 Gates "C"
C NW SE Section 2-34S-8W
Wharton Pool Extension
Harper County, Kansas
API # 15-077-20,783

Page 3

02-23-82 Rotary Total Depth 4800'. Run Gearhart Dual Induction Laterolog and Neutron-Density Logs.

ELECTRIC LOG TOPS

Heebner	3477(-2069)
Stalnaker Sand	3825(-2417)
Kansas City	4072(-2664)
Stark Shale	4223(-2815)
Ft. Scott	4486(-3078)
Cherokee	4497(-3089)
Mississippian Lime	4670(-3262)
LTD	4797(-3389)

Set new 4-1/2" OD, 10.5#, J-55, ERW, R-3 casing @ 4795'. Halliburton cement with 175 sacks common cement, 1/4# Flocele per sack. P.D. @ 5:00 P.M. Shoe joint is 35.13' long.

03-10-82 Rig up Hayes Well Service Completion Unit. Run Gearhart GR-CCL Log from PBTD @ 4760' up to 4000'. Perforate Ft. Scott zone from 4487' to 4492' with 4 SSB Jet shots/ft. Run 2-3/8" EUE, J-55 tubing as follows: 24.84' long open end mud anchor, 3.10' perforated nipple, seating nipple, 140 joints of tubing and (2) 6' subs. Total tally = 4484.45'. Swing @ 4491' KB. Make up well head. Rig up tubing swab. Swab down 1000'. (3500' load water still in hole.) Having trouble getting swab down due to paraffin in tubing. Shut in for night.

03-11-82 SICP 170# SITP 240# Open tubing valve. Flow 1/2 bbl. oil. Start swabbing. Swab load. Swab and flow 8 BOPH/2 hours. CP 360#. Halliburton acidized with 1,000 gallons 15% HCL. Load hole. Spot acid across perforations. Start feeding 1/4 BPM @ 250#, increase rate to 2 BPM @ 500#, increase rate to 5 BPM and treat @ 1100#. ISIP 600#. Pressure drop to 250# in 10 minutes. Rig down Halliburton. Bleed back and start swabbing. Total load = 88 barrels. Swab down to 1200' and well kicked off flowing. (3300' of fluid in hole.) Casing on vacuum. Well made 135 barrels of fluid in 3-1/2 hours. Last 2 hours the well flowed 22 BFPH on 45/64" choke. Oil % increased from 28% at start of 2 hour period to 53% during last hour. Flowing casing pressure increased from 20# to 160#. Gas volume variable from less than 100 MCF to more than 500 MCFPD. Well started flowing by heads during last hour. Shut in for night. Will run pump and rods in the morning.

McCoy Petroleum Corporation
#1 Gates "C"
C NW SE Section 2-34S-8W
Wharton Pool Extension
Harper County, Kansas
API # 15-077-20,783

Page 4

03-12-82 SICP 770# SITP 770# Flow 17 BOPH/3 hrs. Kill well with 29 barrels water down tubing. Run new 2" X 1-1/2" X 12' RWAC pump, 177 new Axelson "60" sucker rods, (1) 6' pony rod, (3) 4' pony rods and (1) 2' pony rod. Well kicked off flowing again with 65 rods in hole. Pump additional 17 barrels water down tubing. Seat pump. Pack off polish rod. Release Hayes Well Service. Will make roads and grades next week and set surface equipment the following week.

03-22-82 Set new Lufkin C114D-143-64 Pumping Unit with used C-96 engine. Build tank battery grade and lease road.

03-24-82 Start well pumping.

03-25-82 Pump 123 BOPD with 108,000 CFGPD. CP 825# GOR=878/1.

03-26-82 Pump 130 BOPD, no water, with 166,000 CFGPD. FCP 772#. GOR=1277/1.

F.P. Pump 130 BOPD, no water, with 166,000 CFGPD. FCP 772#.
GOR=1277/1.

Complete 3-26-82

STATE CORPORATION COMMISSION
 CONSERVATION DIVISION
 500 INSURANCE BLDG.
 212 NORTH MARKET
 WICHITA 2, KANSAS

Township 34s Range 8W County HARPER Pool WHARTON

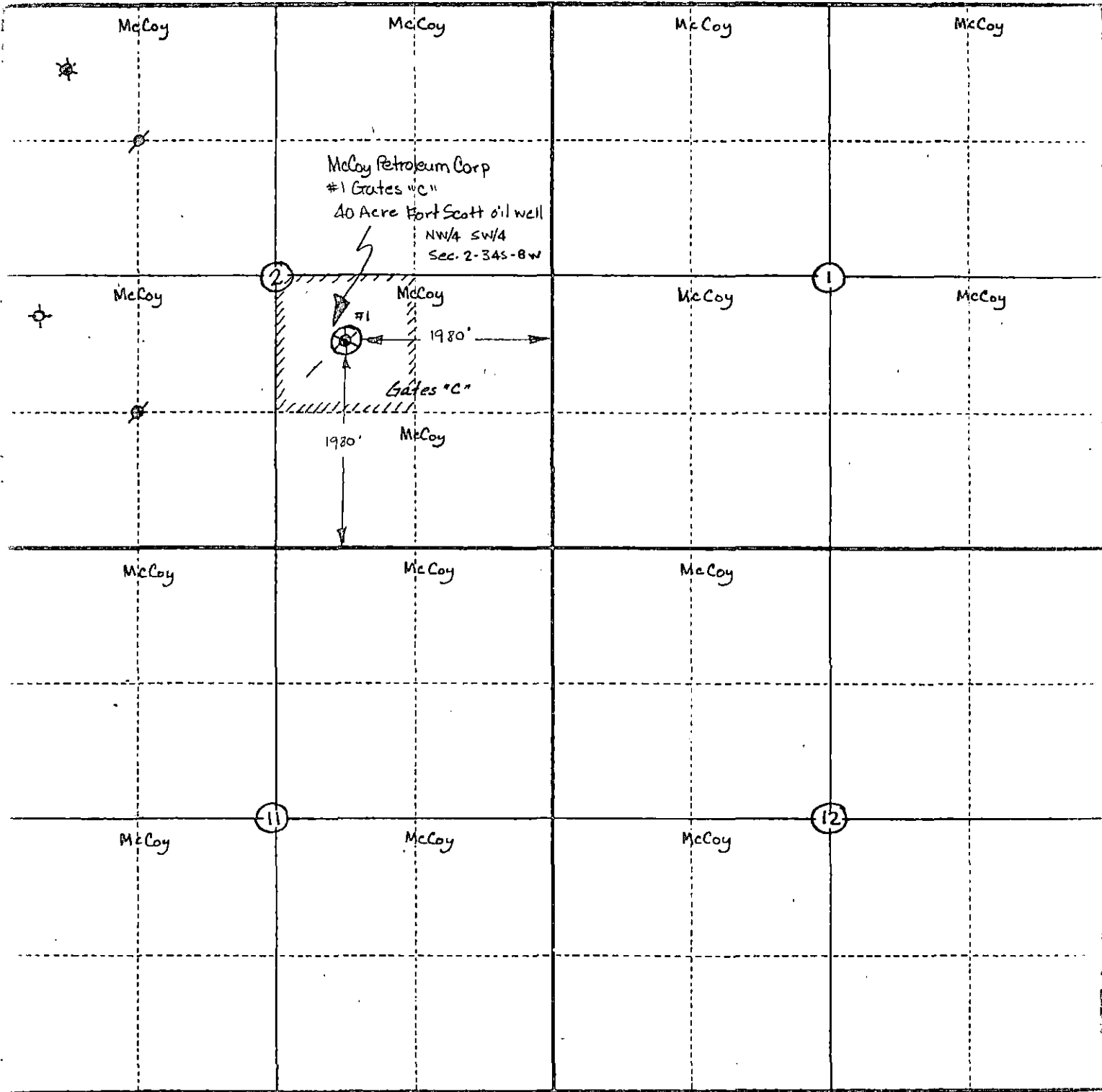

STATE OF KANSAS,
 COUNTY OF SEDGWICK

I, John Roger McCoy, President
 of McCoy Petroleum Corporation, do hereby certify
 that the above locations, feet measurements and areas are true and correct to the best of my knowledge.

Subscribed and sworn to before me this 19th day of April, 1982

My commission expires 2-20-86

John Roger McCoy
Christina Louise Sollars
 NOTARY PUBLIC

