

STATE OF KANSAS  
STATE CORPORATION COMMISSION  
CONSERVATION DIVISION  
P. O. BOX 17027  
WICHITA, KANSAS 67217

WELL PLUGGING RECORD

Meade County, Sec. 22 Twp. 33 Rge. 28 ~~W~~ W (W)

Location as "NE/CNW/SE/SW" or footage from lines C NE SW NE

Lease Owner Ferguson Oil Company, Inc.

Lease Name FRIESEN "C" Well No. 1

Office Address 2700 Liberty Tower; Oklahoma City, Oklahoma 73102

Character of Well (completed as Oil, Gas or Dry Hole) Gas

Date well completed January 20 1978

Application for plugging filed January 1978

Application for plugging approved January 1978

Plugging commenced January 1/18 1978

Plugging completed January 25 1978

Reason for abandonment of well or producing formation Uneconomical to operate

If a producing well is abandoned, date of last production 1/2/ 1978

Was permission obtained from the Conservation Division or its agents before plugging was commenced? Yes

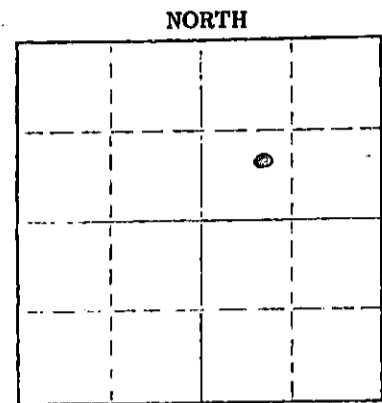

Locate well correctly on above Section Plot

Name of Conservation Agent who supervised plugging of this well Leo Massey, 109 W. 15th; Hays, Kansas 67601

Producing formation Morrow Depth to top 5748' Bottom 5750' Total Depth of Well 5972'

Show depth and thickness of all water, oil and gas formations.

OIL, GAS OR WATER RECORDS

CASING RECORD

FORMATION	CONTENT	FROM	TO	SIZE	PUT IN	PULLED OUT
				8 5/8"	1577'	None
				4 1/2"	5969'	4223.88'

Describe in detail the manner in which the well was plugged, indicating where the mud fluid was placed and the method or methods used in introducing it into the hole. If cement or other plugs were used, state the character of same and depth placed, from 5574' feet to feet for each plug set.

Set 15 sx cement from 5574' to 5750' in 4 1/2" casing; pumped 50 sacks cement from 1527' to 1627'; cleaned out cellar, capped surface with 10 sacks cement, 4' to 34'. Cut off well head, welded on plate.

RECEIVED  
STATE CORPORATION COMMISSION  
FEB 10 1978  
2-10-1978  
CONSERVATION DIVISION  
Wichita, Kansas

Name of Plugging Contractor Lillard & Wilson, Inc. (If additional description is necessary, use BACK of this sheet)

Address Box 962; Woodward, Oklahoma 73801

STATE OF OKLAHOMA COUNTY OF OKLAHOMA, ss.

W. D. Stancliffe, Vice-President (employee of owner) or (owner or operator) of the above-described

well, being first duly sworn on oath, says: That I have knowledge of the facts, statements, and matters herein contained and the log of the above-described well as filed and that the same are true and correct. So help me God.

FERGUSON OIL COMPANY, INC.

(Signature)

2700 Liberty Tower; Oklahoma City, Okla. 73102

(Address)

Subscribed and sworn to before me this 8th day of February, 1978

My commission expires 2/2/80

Janine Walker  
Notary Public

15-119-30099-0000

**KANSAS DRILLERS LOG**

S. 22 T. 33 R. 28 <sup>XEX</sup>  
W

API No. 15 — Meade —  
County Number

Loc. C NE SW NE

County Meade

Operator  
Ferguson Oil Company, Inc.

Address  
2700 Liberty Tower; Oklahoma City, Oklahoma 73102

Well No. 1 Lease Name FRIESEN "C"

Footage Location  
990 feet from ~~XX~~ (S) line 990' feet from ~~XX~~(W) line

Principal Contractor Zenith Drilling Company Geologist William M. Capps

Spud Date 12/2/66 Total Depth 5972' P.B.T.D. 5970'

Date Completed 1/26/67 Oil Purchaser Koch Oil Co.

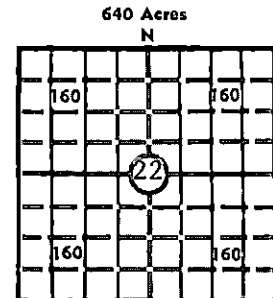

Locate well correctly  
Elev.: Gr. 2507'

DF \_\_\_\_\_ KB 2514'

**CASING RECORD**

Report of all strings set— surface, intermediate, production, etc.

Purpose of string	Size hole drilled	Size casing set (in O.D.)	Weight lbs/ft.	Setting depth	Type cement	Sacks	Type and percent additives
Surface	12 1/4"	8 5/8	23#	1577'	Pozmix & Reg.	776	
Production	7 7/8"	4 1/2"	11.6#	5970'	Regular	200	

**LINER RECORD**

**PERFORATION RECORD**

Top, ft.	Bottom, ft.	Sacks cement	Shots per ft.	Size & type	Depth interval
			2		5748' - 5750'

**TUBING RECORD**

Size	Setting depth	Packer set at
2 3/8"	5748'	None

**ACID, FRACTURE, SHOT, CEMENT SQUEEZE RECORD**

Amount and kind of material used	Depth interval treated
800 gals mud acid	5748-50'

RECEIVED  
STATE CORPORATION COMMISSION  
FEB 10 1978  
CONSERVATION DIVISION  
Kansas

**INITIAL PRODUCTION**

Date of first production July, 1967 Producing method (flowing, pumping, gas lift, etc.) Flowing

RATE OF PRODUCTION PER 24 HOURS	Oil	Gas	Water	Gas-oil ratio
	5 bbls cond. bbls.	1,250 MCF	90 bbls.	CFPB

Disposition of gas (vented, used on lease or sold) Sold to Panhandle Eastern Pipeline Co. Producing interval(s) 5748-50' - Morrow

INSTRUCTIONS: As provided in KCC Rule 82-2-125, within 90 days after completion of a well, one completed copy of this Drillers Log shall be transmitted to the State Geological Survey of Kansas, 4150 Monroe Street, Wichita, Kansas 67209. Copies of this form are available from the Conservation Division, State Corporation Commission, 3830 So. Meridian (P.O. Box 17027), Wichita, Kansas 66217. Phone AC 316-522-2206. If confidential custody is desired, please note Rule 82-2-125. Drillers Logs will be on open file in the Oil and Gas Division, State Geological Survey of Kansas, Lawrence, Kansas 66044.

Operator  
Ferguson Oil Company, Inc.

DESIGNATE TYPE OF COMP.: OIL, GAS, DRY HOLE, SWDW, ETC.:  
Gas well, now plugged

Well No. 1 Lease Name FRIESEN 'C'

S 22 T 33 R 28 ~~EX~~ W

**WELL LOG**  
Show all important zones of porosity and contents thereof; cored intervals, and all drill-stem tests, including depth interval tested, cushion used, time tool open, flowing and shut-in pressures, and recoveries.

SHOW GEOLOGICAL MARKERS, LOGS RUN, OR OTHER DESCRIPTIVE INFORMATION.

FORMATION DESCRIPTION, CONTENTS, ETC.	TOP	BOTTOM	NAME	DEPTH
Council Grove: Shale	3016	3022	HEEBNER SHALE	4442'
Lansing: Limestone	5078	5084	LANSING.	4596'
Marmaton: Limestone, gray to tan	5258	5265	MARMATON	5256'
Morrow Sand: Sandstone,	5744	5781	CHEROKEE	5430'
Mississippian (Chester): Limestone,	5807	5970	MORROW SHALE	5730'
			MORROW SAND	5744'
			MISSISSIPPIAN (Chester)	5807'

USE ADDITIONAL SHEETS, IF NECESSARY, TO COMPLETE WELL RECORD.

Date Received

*W. D. Stancliffe*  
W. D. Stancliffe Signature  
Vice-President Title  
February 8, 1978 Date