

plugged 12-14-87

SIDE ONE

STATE CORPORATION COMMISSION OF KANSAS  
OIL & GAS CONSERVATION DIVISION  
WELL COMPLETION OR RECOMPLETION FORM  
ACO-1 WELL HISTORY  
DESCRIPTION OF WELL AND LEASE

API NO. 15-151-21,865-00-00  
County Pratt  
C W/2 SE/4 SE/4 Sec 15 28S 12W East  
..... Ft North from Southeast Corner of Section  
..... Ft West from Southeast Corner of Section

Operator: License # 3246  
Name J. B. Gas Detectors, Inc.  
Address P. O. Box 801  
City/State/Zip Pratt, Kansas 67124

660  
990  
(Note: Locate well in section plat below)

Purchaser.....  
Operator Contact Person Mr. W. K. Black  
Phone 316-672-6910

Lease Name Chitwood Well # 1  
Field Name Chitwood North

Contractor: License # 5302  
Name Red Tiger Drilling Company  
Wellsite Geologist Ron Falwell  
Phone 316-549-3963

Producing Formation D. & A.  
Elevation: Ground 1875' KB 1880'

Designate Type of Completion  
 New Well  Re-Entry  Workover  
 Oil  SWD  Temp Abd  
 Gas  Inj  Delayed Comp.  
 Dry  Other (Core, Water Supply etc.)

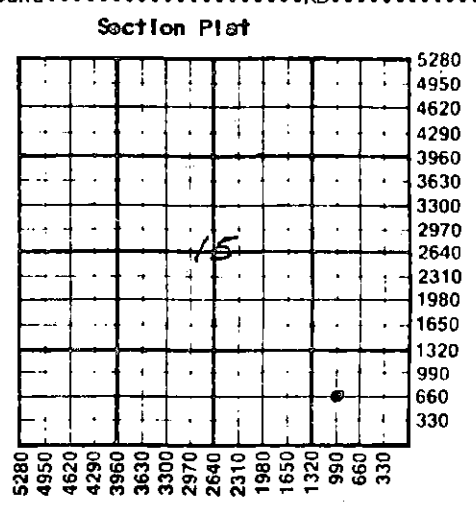

If **OWNO**: old well info as follows:  
Operator.....  
Well Name.....  
Comp. Date.....Old Total Depth.....

Section Plat  
WATER SUPPLY INFORMATION  
Disposition of Produced Water:  Disposal  
Docket #.....  Repressuring

WELL HISTORY  
Drilling Method:  Mud Rotary  Air Rotary  Cable  
12/4/87 12/14/87 12/14/87  
Spud Date Date Reached TD Completion Date  
4,450'  
Total Depth PBTD  
Amount of Surface Pipe Set and Cemented at 252 feet  
Multiple Stage Cementing Collar Used?  Yes  No  
If yes, show depth set.....feet  
If alternate 2 completion, cement circulated from.....feet depth to.....w/.....SX cmt  
Cement Company Name.....  
Invoice #.....

Questions on this portion of the ACO-1 call:  
Water Resources Board (913) 296-3717  
Source of Water:  
Division of Water Resources Permit # T 87-547  
 Groundwater 1300 Ft North from Southeast Corner  
(Well) 1900 Ft West from Southeast Corner of  
Sec 15 Twp 28S Rge 12 East  West  
 Surface Water.....Ft North from Southeast Corner  
(Stream, pond etc).....Ft West from Southeast Corner  
Sec Twp Rge East West  
 Other (explain).....  
(purchased from city, R.W.D. #)

INSTRUCTIONS: This form shall be completed in triplicate and filed with the Kansas Corporation Commission, 200 Colorado Derby Building, Wichita, Kansas 67202, within 120 days of the spud date of any well. Rule 82-3-130, 82-3-107 and 82-3-106 apply. Information on side two of this form will be held confidential for a period of 12 months if requested in writing and submitted with the form. See rule 82-3-107 for confidentiality in excess of 12 months. One copy of all wireline logs and drillers time log shall be attached with this form. Submit CP-4 form with all plugged wells. Submit CP-111 form with all temporarily abandoned wells.

All requirements of the statutes, rules and regulations promulgated to regulate the oil and gas industry have been fully complied with and the statements herein are complete and correct to the best of my knowledge.

Signature *W. K. Black*  
Title President Date 12/18/87

Subscribed and sworn to before me this 18 day of December 1987.  
Notary Public *Mary A. Hergenreder*  
Date Commission Expires *2-5-89*

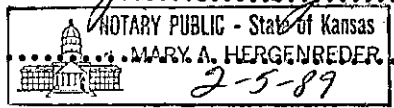

K.C.C. OFFICE USE ONLY  
F  Letter of Confidentiality Attached  
C  Wireline Log Received  
C  Drillers Time Log Received  
Distribution  
 KCC  SWD/Rep  NGPA  
 KGS  Plug  Other  
(Specify)

Form ACO-1 (5-86) DEC 2 1987 12-2387

CONSERVATION DIVISION  
Wichita, Kansas

Sec. 15 Twp 28S Rge 12W

Operator Name **J B Gas Dectectors, Inc.** Lease Name **Chitwood** Well # **1**

Sec. **15** Twp. **28S** Rge. **12W**  East  West County **Pratt**

WELL LOG

INSTRUCTIONS: Show important tops and base of formations penetrated. Detail all cores. Report all drill stem tests giving interval tested, time tool open and closed, flowing and shut-in pressures, whether shut-in pressure reached static level, hydrostatic pressures, bottom hole temperature, fluid recovery, and flow rates if gas to surface during test. Attach extra sheet if more space is needed. Attach copy of log.

Drill Stem Tests Taken  Yes  No  
 Samples Sent to Geological Survey  Yes  No  
 Cores Taken  Yes  No

Formation Description  Log  Sample

DST #1  
 3498 - 3600 Interval. 30-30-30-60  
 IFP 593 - 1112 FSIP 1350  
 ISIP 1350 IHH 1713 - 1682  
 FFP  
 1215 - 1340  
 Recovered 2700' Water. CL 128,000.  
 DST #2  
 3942 - 3982 Interval. 30-45-60-60  
 IFP 82 - 118 FSIP 1287  
 ISIP 1346 IHH 2038  
 FFP 165' - 236  
 Rec 500' MCGW Cl 68,000.  
 DST #3  
 4313 - 4397 Interval. 30-30  
 IFP 23 - 23  
 ISIP 23  
 Recovered 25' mud.

Name	Top	Bottom
Woodsiding	2739	-859
Tarkio	2932	-1052
Topeka	3190	-1310
Heebner	3564	-1684
Brown Lime	3751	-1871
Lansing	3766	-1886
Base Kansas City	4143	-2263
Mississippian Chert	4232	-2352
Viola	4389	-2509

CASING RECORD <input checked="" type="checkbox"/> New <input type="checkbox"/> Used							
Report all strings set-conductor, surface, intermediate, production, etc.							
Purpose of String	Size Hole Drilled	Size Casing Set (In O.D.)	Weight Lbs/Ft.	Setting Depth	Type of Cement	#Sacks Used	Type and Percent Additives
Surface	12 1/4"	8 5/8"	24#	260'	Common	160	3%CC, 2% Gel
PERFORATION RECORD				Acid, Fracture, Shot, Cement Squeeze Record			
Shots Per Foot	Specify Footage of Each Interval Perforated			(Amount and Kind of Material Used)		Depth	
TUBING RECORD				Liner Run <input type="checkbox"/> Yes <input type="checkbox"/> No			
Date of First Production	Producing Method <input type="checkbox"/> Flowing <input type="checkbox"/> Pumping <input type="checkbox"/> Gas Lift <input type="checkbox"/> Other (explain).....						
Estimated Production Per 24 Hours	Oil	Gas	Water	Gas-Oil Ratio		Gravity	
	Bbls	MCF	Bbls	CFPB			

METHOD OF COMPLETION

Production Interval

Disposition of gas:  Vented  Open Hole  Perforation  
 Sold  Other (Specify) .....  
 Used on Lease  Dually Completed .....  
 Conmingled .....