

STATE CORPORATION COMMISSION OF KANSAS
OIL & GAS CONSERVATION DIVISION
RECOMPLETION FORM
ACQ-2 AMENDMENT TO WELL HISTORY

API NO. 15- 189-21,029-00-00
County Stevens
N/2 N/2 SE Sec 9 Twp 33S Rge 38 X East West

Operator: License # 5598
Name APX Corporation
Address P. O. Box 351
City/State/Zip Liberal, Kansas 67905-0351

2310 Ft North from Southeast Corner of Section
1320 Ft West from Southeast Corner of Section
(Note: Locate well in section plat below)

Purchaser Panhandle Eastern Pipe Line Co.
(Transporter)
Operator Contact Person M. L. Pease
Phone (316) 624-6253

Lease Name Miller "0" Well # 1H
Field Name Hugoton

Name of New Formation Chase
Elevation: Ground 3157.0 KB —

Designate Type of Original Completion
 New Well Re-Entry Workover

Oil SWD Temp Abd
 Gas Inj Delayed Comp.
 Dry Other (Core, Water Supply et

Date of Original Completion: 9/26/88

DATE OF RECOMPLETION:

Commenced _____ Completed _____

Designate Type of Recompletion/Workover:

_____ Deepening _____ Delayed Completion

_____ Plug Back _____ Re-perforation

_____ Conversion to Injection/Disposal

Is recompleted production:

_____ Commingled; Docket No. _____

_____ Dual Completion; Docket No. _____

_____ Other (Disposal or Injection)?

RECEIVED
DEC 23 1988
12-22-88
CONSERVATION DIVISION
Wichita, Kansas

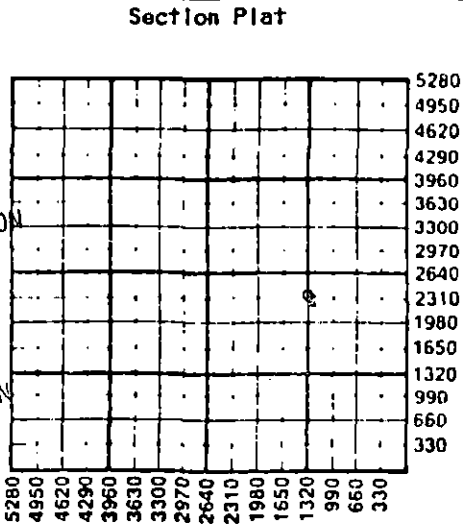

K.C.C. OFFICE USE ONLY
 Letter of Confidentiality Attached
 Wireline Log Received
 Drillers Timelog Received
Distribution
 KCC SWD/Rep NGPA
 KGS Plug Other (Specify)
12-22-88

INSTRUCTIONS: This form shall be completed in triplicate and filed with the Kansas Corporation Commission, 200 Colorado Derby Building, Wichita, Kansas 67202, within 120 days of the recompletion of any well. Rules 82-3-107 and 82-3-141 apply. Information on side two of this form will be held confidential for a period of 12 months if requested in writing and submitted with the form. See rule 82-3-107 for confidentiality in excess of 12 months. One copy of any additional wireline logs and driller's time logs (not previously submitted) shall be attached with this form. Submit ACQ-4 prior to or with this form for approval of commingling or dual completions. Submit CP-4 with all plugged wells. Submit CP-111 with all temporarily abandoned wells. NOTE: Conversion of wells to either disposal or injection must receive approval before use; submit form U-1.

All requirements of the statutes, rules and regulations promulgated to regulate the oil and gas industry have been fully complied with and the statements herein are complete and correct to the best of my knowledge.

Signature M. L. Pease Title Division Production Mgr. Date 12/21/88
M. L. Pease

Subscribed and sworn to before me this 21st day of December 19 88

Notary Public Glenn A. Salley Date Commission Expires _____

GLENN A. SALLEY
NOTARY PUBLIC
STATE OF KANSAS
12-16-91