

FORM MUST BE TYPED

SIDE ONE

STATE CORPORATION COMMISSION OF KANSAS  
OIL & GAS CONSERVATION DIVISION  
WELL COMPLETION FORM  
ACO-1 WELL HISTORY  
DESCRIPTION OF WELL AND LEASE

API NO. 15- 129-20322-000 ORIGINAL

County MORTON

       -        - NW - SW Sec. 4 Twp. 33S Rge. 40 X W

1980 Feet from SX (circle one) Line of Section

660 Feet from XW (circle one) Line of Section

Footages Calculated from Nearest Outside Section Corner:  
NE, SE, NW or SW (circle one)

Lease Name LOW "H" Well # 1

Field Name SANTA FE TRAIL

Producing Formation ALTMONT, MORROW F/G

Elevation: Ground 3306 KB       

Total Depth 5900 PBDT 5564

Amount of Surface Pipe Set and Cemented at 1575 Feet

Multiple Stage Cementing Collar Used?        Yes X No

If yes, show depth set        Feet

If Alternate II completion, cement circulated from       

feet depth to        w/        sx cmt.

Drilling Fluid Management Plan Re-work, 7-23-98 U.C.  
(Data must be collected from the Reserve Pit)  
NOT APPLICABLE

Chloride content        ppm Fluid volume        bbls

Dewatering method used       

Location of fluid disposal if hauled offsite:       

Operator Name       

Lease Name        License No.       

       Quarter Sec.        Twp.        S Rng.        E/W

County        Docket No.       

Operator: License # 4549

Name: ANADARKO PETROLEUM CORPORATION

Address P. O. BOX 351

City/State/Zip LIBERAL, KANSAS 67905-0351

Purchaser: ANADARKO ENERGY SERVICES

Operator Contact Person: SHAWN D. YOUNG

Phone (316) 624-6253 RECEIVED

Contractor: Name: NA STATE CORPORATION COMMISSION

License: NA JUL 9 1998

Wellsite Geologist: NA 7-15-98

Designate Type of Completion        New Well        Re-Entry X Workover

       Oil        SWD        SLOW        Temp. Abd.  
X Gas        ENHR        SIGW  
       Dry        Other (Core, WSW, Expl., Cathodic, etc)

If Workover:

Operator: ANADARKO PETROLEUM CORPORATION

Well Name: LOW\_H-1

Comp. Date 10-14-77 Old Total Depth 5900

       Deepening X Re-perf.        Conv. to Inj/SWD  
X Plug Back 5564 PBDT  
X Commingled Docket No. PENDING  
       Dual Completion Docket No.         
       Other (SWD or Inj?) Docket No.       

2-25-98        3-8-98  
~~Spud~~ Date of        Date Reached TD        Completion Date       

Start of workover

INSTRUCTIONS: An original and two copies of this form shall be filed with the Kansas Corporation Commission, 130 S. Market - Room 2078, Wichita, Kansas 67202, within 120 days of the spud date, recompletion, workover or conversion of a well. Rule 82-3-130, 82-3-106 and 82-3-107 apply. Information on side two of this form will be held confidential for a period of 12 months if requested in writing and submitted with the form (see rule 82-3-107 for confidentiality in excess of 12 months). One copy of all wireline logs and geologist well report shall be attached with this form. ALL CEMENTING TICKETS MUST BE ATTACHED. Submit CP-4 form with all plugged wells. Submit CP-111 form with all temporarily abandoned wells.

All requirements of the statutes, rules and regulations promulgated to regulate the oil and gas industry have been fully complied with and the statements herein are complete and correct to the best of my knowledge.

Signature Shawn D. Young  
SHAWN D. YOUNG  
Title DIVISION PRODUCTION ENGINEER Date 7/13/98

Subscribed and sworn to before me this 12<sup>th</sup> day of July  
19 98

Notary Public Shirley J. Childers  
Date Commission Expires       

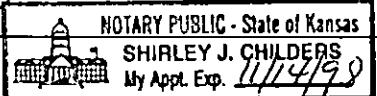

K.C.C. OFFICE USE ONLY  
F        Letter of Confidentiality Attached  
C        Wireline Log Received  
C        Geologist Report Received  
Distribution  
 KCC        SWD/Rep        NGPA  
       KGS        Plug        Other  
(Specify)

SIDE TWO

Operator Name ANADARKO PETROLEUM CORPORATION Lease Name LOW "H" Well # 1  
 Sec. 4 Twp. 33 Rge. 40  East County MORTON  
 West

INSTRUCTIONS: Show important tops and base of formations penetrated. Detail all cores. Report all drill stem tests giving interval tested, time tool open and closed, flowing and shut-in pressures, whether shut-in pressure reached static level, hydrostatic pressures, bottom hole temperature, fluid recovery, and flow rates if gas to surface during test. Attach extra sheet if more space is needed. Attach copy of log.

Drill Stem Tests Taken  Yes  No  
 (Attach Additional Sheets.)  
 Samples Sent to Geological Survey  Yes  No  
 Cores Taken  Yes  No  
 Electric Log Run  Yes  No  
 (Submit Copy.)  
 List All E.Logs Run:

Log Formation (Top), Depth and Datums  Sample  
 Name Top Datum

SEE ATTACHED DRILLERS LOG

** Original Completion CASING RECORD <input checked="" type="checkbox"/> New <input type="checkbox"/> Used							
Report all strings set-conductor, surface, intermediate, production, etc.							
Purpose of String	Size Hole Drilled	Size Casing Set (In O.D.)	Weight Lbs./Ft.	Setting Depth	Type of Cement	# Sacks Used	Type and Percent Additives
** SURFACE	12-1/4"	8-5/8"	24.0	1575	SS POZ COMMON	600 200	4% GEL, 2%CC
** PRODUCTION	7-7/8"	4-1/2"	10.5	5899	SS POZ	700	.5% CFR-2, 12 1/2 GILSONITE

ADDITIONAL CEMENTING/SQUEEZE RECORD

Purpose:	Depth Top Bottom	Type of Cement	#Sacks Used	Type and Percent Additives
___ Perforate				
___ Protect Casing				
___ Plug Back TD				
___ Plug Off Zone				

Shots Per Foot	PERFORATION RECORD - Bridge Plugs Set/Type Specify Footage of Each Interval Perforated	Acid, Fracture, Shot, Cement Squeeze Record (Amount and Kind of Material Used)	Depth
4	4495-4503	ACID W/ 600 GAL FENCL	4495-4503
	CIBO @ 5564		

TUBING RECORD	Size	Set At	Packer At	Liner Run <input type="checkbox"/> Yes <input checked="" type="checkbox"/> No
	2-3/8	5502		
Date of First, Resumed Production, SWD or Inj.	Producing Method <input type="checkbox"/> Flowing <input checked="" type="checkbox"/> Pumping <input type="checkbox"/> Gas Lift <input type="checkbox"/> Other (Explain)			
RESUMED : 3-5-98				
Estimated Production Per 24 Hours	Oil Bbls.	Gas Mcf	Water Bbls.	Gas-Oil Ratio Gravity
	0	47	16	--

Disposition of Gas:  Vented  Sold  Used on Lease (If vented, submit ACO-18.)

METHOD OF COMPLETION:  Open Hole  Perf.  Dually Comp.  Commingled

Production Interval: 4495-4503  
5307-5594

KANSAS DRILLERS LOG

ORIGINAL

S. 4 T. 33S R. 40 E W

API No. 15 — 129 — 20,322  
County Number

Loc. 1980' FSL & 660' FWL

Operator  
ANADARKO PRODUCTION COMPANY

Address  
P. O. BOX 351, LIBERAL, KANSAS 67901

Well No. 1 Lease Name LOW "H"

Footage Location  
1980 feet from (N) (S) line 660 feet from (E) (W) line

Principal Contractor Rains-Williamson Geologist Bob Posey

Spud Date 8/2/77 Total Depth 5900' P.B.T.D.

Date Completed 10/14/77 Oil Purchaser

County MORTON

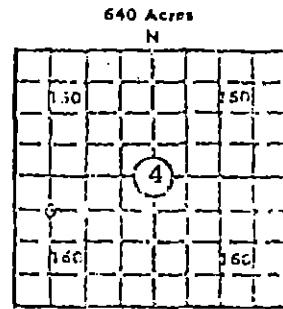

Elev.: Gr. 3306'

DF KB

CASING RECORD

Report of all strings set— surface, intermediate, production; etc.

Purpose of string	Size hole drilled	Size casing set (in O.D.)	Weight lbs/ft.	Setting depth	Type cement	Sacks	Type and percent additives
Surface	12-1/4"	8-5/8"	24#	1575'	SS Poz	600	4% gel, 2%
					Common	200	2% cc
Production	7-7/8"	4-1/2"	10.5#	5899'	SS Poz (1st Stage)	400	.5% CFR-2, 12-1/2 Gilsonite
					SS Poz (2nd Stage)	300	.5% CFR-2 12-1/2 Gilsonite.

LINER RECORD

PERFORATION RECORD

Top, ft.	Bottom, ft.	Sacks cement	Shots per ft.	Size & type	Depth interval
			2		5488-94'
			1		5418-37'
			1		5441-56'

ACID, FRACTURE, SHOT, CEMENT SQUEEZE RECORD

Amount and kind of material used	Depth interval treated
A/1000 gals 7-1/2% spearhead + 14BS, F/15,000 gals 3% 75% foamed acid + 16,000 10-20 sand	5488-94'
A/4000 gals 7.5% spearhead + 45BS, N <sub>2</sub> in last 2000 gals acid & flush	5418-37' 5441-56'
F/45,000 gals 3% 75% foamed acid + 37,500 10-20 sand w/15BS A/2000 gals 7-1/2% spearhead + 15BS w/N <sub>2</sub> in last 1000 gals acid & flush--F/24,500 gals 3% acid 75% stable foam, 24,000 10-20 sand	5370-80'

Date of first production SI FOR PL--WILL TST WHEN CONNECTED Producing method (flowing, pumping, gas lift, etc.) Flowing

RATE OF PRODUCTION PER 24 HOURS	Oil	Gas	Water	Gas-oil ratio
	bbls.	Morr F 1020 Morr G 4430	MCF	bbls. CFPB

Disposition of gas (vented, used on lease or sold) Producing interval(s) 5488-94, 5418-37, 5441-56 Morr "G"; 5370-80 Morr "F"

INSTRUCTIONS: As provided in KCC Rule 82-2-125, within 90 days after completion of a well, one completed copy of this Drillers Log shall be transmitted to the State Geological Survey of Kansas, 4150 Monroe Street, Wichita, Kansas 67209. Copies of this form are available from the Conservation Division, State Corporation Commission, 3830 So. Meridian (P.O. Box 17027), Wichita, Kansas 66217. Phone AC 316-522-2206. If confidential custody is desired, please note Rule 82-2-125. Drillers Logs will be an open file in the Oil and Gas Division, State Geological Survey of Kansas, Lawrence, Kansas 66044.

Operator

ANADARKO PRODUCTION COMPANY

DESIGNATE TYPE OF COMP.: OIL, GAS, DRY HOLE, SWDW, ETC.:

DUAL GAS

Well No.

Lease Name

7

LOW "H"

S 4 T 33S R 40 <sup>NE</sup> W

WELL LOG

Show all important zones of porosity and contents thereof; cored intervals, and all drill-stem tests, including depth interval tested, cushion used, time tool open, flowing and shut-in pressures, and recoveries.

SHOW GEOLOGICAL MARKERS, LOGS RUN, OR OTHER DESCRIPTIVE INFORMATION.

FORMATION DESCRIPTION, CONTENTS, ETC.	TOP	BOTTOM	NAME	DEPTH
Sand, Redbed & Clay	0'	480'		
Sand & Redbed	480'	655'		
Redbed, Sand & Lime	655'	1095'		
Redbed & Sand	1095'	1500'		
Shale	1500'	2253'		
Lime & Shale	2253'	4539'		
Lime	4539'	4603'		
Lime & Shale	4603'	5802'		
Lime	5802'	5900'		
ROTARY TOTAL DEPTH		5900'		

DST #1 5362-5500 (Morr) 20MPF, GTS 8M, 20M ga 156 Mcfd, op 40M, 5M ga 245 Mcfd, 10M 251 Mcfd, 20M 259 Mcfd, 30M 344 Mcfd & stab. rec 600' HGC muddy oil, 60' thin mud, ISIP 1513 (40), IFP 323-333, FFP 323-333, FSIP 1513 (120), HP 2662-2662.

USE ADDITIONAL SHEETS, IF NECESSARY, TO COMPLETE WELL RECORD.

Date Received

*Paul Campbell*

Signature

Paul Campbell, Division Production Manager

Title

November 22, 1977

Date