

STATE CORPORATION COMMISSION OF KANSAS
OIL & GAS CONSERVATION DIVISION

WELL COMPLETION OR RECOMPLETION FORM
ACO-1 WELL HISTORY

DESCRIPTION OF WELL AND LEASE

Operator license # 5469
name Anadarko Production Company
address Box 351
City State/Zip Liberal, Kansas 67901

Operator Contact Person Paul Gatlin
Phone (316) 624-6253

Contractor license # 5842
name Gabbert-Jones, Inc.

Wellsite Geologist None
Phone
Purchaser NA

Designate Type of Completion
 New Well Re-Entry Workover
 Oil SWD Temp Abd
 Gas Inj Delayed Comp.
 Dry Other (Core, Water Supply etc.)

If OWWO: old well info as follows:
Operator Anadarko Production Company
Well Name Low "E" No. 2
Comp. Date 7/30/66 Old Total Depth 5970

WELL HISTORY

Drilling Method: Mud Rotary Air Rotary Cable
11/17/84 11/18/84 12/20/84
Spud Date Date Reached TD Completion Date
5530 5463
Total Depth PBD
Amount of Surface Pipe Set and Cemented at 1591 feet
Multiple Stage Cementing Collar Used? Yes No
If Yes, Show Depth Set feet
Alternate 2 completion, cement circulated from feet depth to w/ SX cmt

API NO. 15-129-01-000

County Morton

C SW SE Sec 7 Twp 33S Rge 40

660 Ft North from Southeast Corner of Section
1980 Ft West from Southeast Corner of Section
(Note: locate well in section plat below)

Lease Name Santa Fe Trail Unit "B" Well# 3-2

Field Name Santa Fe Trail Unit "B"

Producing Formation Morrow

Elevation: Ground 3344 KB 3350

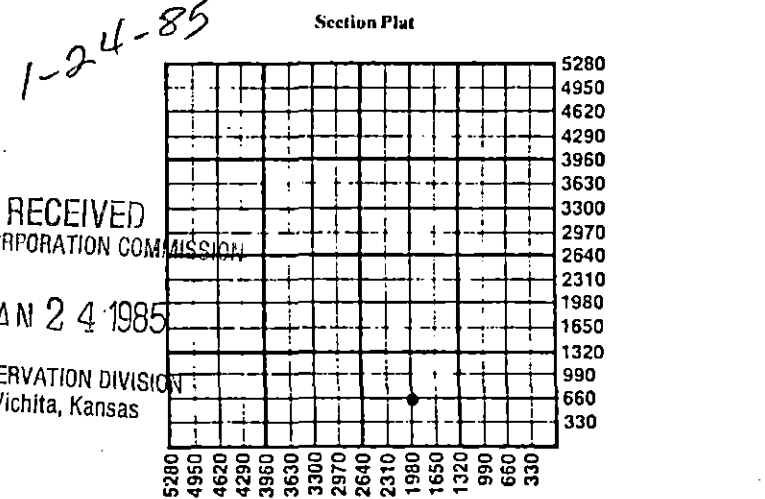

WATER SUPPLY INFORMATION

Source of Water:
Division of Water Resources Permit # T-84-824
 Groundwater 3080 Ft North From Southeast Corner and
4450 Ft. West From Southeast Corner of
Sec 18 Twp 33S Rge 40 East West
 Surface Water Ft North From Southeast Corner and
(Stream, Pond etc.) Ft West From Southeast Corner
Sec. Twp Rge East West
 Other (explain)
(purchased from city, R.W.D.#)

Disposition of Produced Water: Disposal Repressuring
Docket # Repressuring No. Pending

INSTRUCTIONS: This form shall be completed in duplicate and filed with the Kansas Corporation Commission, 200 Colorado Derby Building, Wichita, Kansas 67202, within 90 days after completion or recompletion of any well. Rules 82-3-130 and 82-3-107 apply.

Information on side two of this form will be held confidential for a period of 12 months if requested in writing and submitted with the form. See rule 82-3-107 for confidentiality in excess of 12 months.

One copy of all wireline logs and drillers time log shall be attached with this form. Submit CP-4 form with all plugged wells. Submit CP-111 form with all temporarily abandoned wells.

All requirements of the statutes, rules, and regulations promulgated to regulate the oil and gas industry have been fully complied with and the statements herein are complete and correct to the best of my knowledge.

Signature Paul Campbell
Title Division Operations Manater Date 12/26/84

Subscribed and sworn to before me this 28th day of December 19 84
Notary Public Elizabeth J. Hooper
Seward County, Kansas
Commission Expires 1/26/87

K.C.C. OFFICE USE ONLY
F Letter of Confidentiality Attached
C Wireline Log Received
C Drillers Timelog Received
Distribution
 KCC SWD/Rep NGPA
 KGS Plug Other
(Specify)

Sec. 7, Twp. 33, Rge. 40

SIDE TWO

Operator Name Anadarko Production Co. Santa Fe Trail Unit B Lease Name Well# 3-2 SEC 7 TWP. 33S RGE. 40 East West
 County: Morton

WELL LOG

INSTRUCTIONS: Show important tops and base of formations penetrated. Detail all cores. Report all drill stem tests giving interval tested, time tool open and closed, flowing and shut-in pressures, whether shut-in pressure reached static level, hydrostatic pressures, bottom hole temperature, fluid recovery, and flow rates if gas to surface during test. Attach extra sheet if more space is needed. Attach copy of log.

Drill Stem Tests Taken Yes No
 Samples Sent to Geological Survey Yes No
 Cores Taken Yes No

Formation Description
 Log Sample

Name	Top	Bottom
Cement	0'	65'
Cement & Heavy Mud	65'	5400'
Heavy Mud - Cement	5400'	5530'
TD	5530'	

CASING RECORD <input checked="" type="checkbox"/> new <input type="checkbox"/> used							
Report all strings set - conductor, surface, intermediate, production, etc.							
Purpose of string	size hole drilled	size casing set (in O.D.)	weight lbs/ft.	setting depth	type of cement	# sacks used	type and percent additives
Surface	12-1/4"	8-5/8"	24	1591	Class H	800	3% CaCl
Production	7-7/8"	5-1/2"	15.5	5513	Pozmix	225	10% Salt

PERFORATION RECORD		Acid, Fracture, Shot, Cement Squeeze Record	
shots per foot	specify footage of each interval perforated	(amount and kind of material used)	Depth
2	5347-72	A/2500 gals 7.5% FE + 63 BS	5347-72

TUBING RECORD				Liner Run <input type="checkbox"/> Yes <input checked="" type="checkbox"/> No	
size	set at	packer at			
2-3/8	5295	5299			

Date of First Production	Producing method <input type="checkbox"/> flowing <input type="checkbox"/> pumping <input type="checkbox"/> gas lift <input type="checkbox"/> Other (explain) <u>Injection</u>				
12/18/84					

Estimated Production Per 24 Hours	Oil	Gas	Water	Gas-Oil Ratio	Gravity
	Bbls	MCF	Bbls	CFPB	
	NA	NA	NA	NA	NA

Disposition of gas: vented sold used on lease

METHOD OF COMPLETION open hole perforation other (specify)

PRODUCTION INTERVAL 5347-72'

Dually Completed. Commingled