

ORIGINAL

1/24/91
RELEASED

SIDE ONE

JAN 29 1991

STATE CORPORATION COMMISSION OF KANSAS
OIL & GAS CONSERVATION DIVISION
RECOMPLETION FORM
ACO-2 AMENDMENT TO WELL HISTORY

API NO. 15- 175-21085-0001
County Seward FROM CONFIDENTIAL

Operator: License # 5447
Name: OXY USA Inc.
Address: P. O. Box 26100
City/State/Zip: Okla. City, OK 73126-0100

Approx. NE SW SW Sec. 15 Twp. 32S Rge. 34 East West
1220 Ft. North from Southeast Corner of Section
4060 Ft. West from Southeast Corner of Section
(NOTE: Locate well in section plat below.)

Purchaser: Enron Pipeline Co.

Lease Name Kapp B Well # 3
Field Name Kansas Hugoton Gas

Operator Contact Person: Raymond Hui
Phone: (405) 749-2471

Producing Formation Chase
Elevation: Ground 2927' KB 2937'

Designate Type of Original Completion
 New Well Re-Entry Workover
Date of Original Completion 7-6-1989
Name of Original Operator OXY USA Inc.
Original Well Name Kapp B #3

JAN 30 1990

Date of Recompletion: 10-3-1989 1-17-1990
Commenced _____ Completed _____
Re-entry Workover

KANSAS GEOLOGICAL SURVEY
WICHITA BRANCH

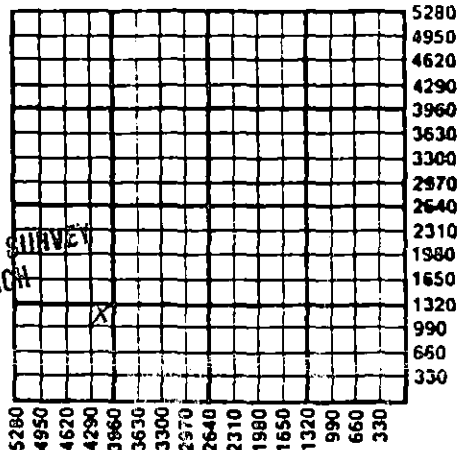

Designate Type of Recompletion/Workover:
 Oil SWD Temp. Abd.
 Gas Inj Delayed Comp.
 Dry Other (Core, Water Supply, etc.)
 Deepening Re-perforation
 Plug Back 2900' PBTD
 Conversion to Injection/Disposal

RECEIVED

JAN 24 1990
1-24-1990
STATE CORPORATION COMMISSION
CONSERVATION DIVISION
Wichita, Kansas

K.C.C. OFFICE USE ONLY
F Letter of Confidentiality Attached
C Wireline Log Received
C Drillers Timelog Received
Distribution
 KCC SWD/Rep NGPA
 KGS Plug Other
(Specify)

Is recompleted production:
 Commingled Docket No. _____
 Dual Completion Docket No. _____
 Other (Disposal or Injection?) Docket No. _____

INSTRUCTIONS: This form shall be completed in triplicate and filed with the Kansas Corporation Commission, 200 Colorado Derby Building, Wichita, Kansas 67202, within 120 days of the recompletion of any well. Rules 82-3-107 and 82-3-141 apply. Information on side two of this form will be held confidential for a period of 12 months if requested in writing and submitted with the form. See rule 82-3-107 for confidentiality in excess of 12 months. One copy of any additional wireline logs and driller's time logs (not previously submitted) shall be attached with this form. Submit ACO-4 or ACO-5 prior to or with this form for approval of commingling or dual completions. Submit CP-1 with all plugged wells. Submit CP-111 with all temporarily abandoned wells. NOTE: Conversion of wells to either disposal or injection must receive approval before use; submit form U-1.

All requirements of the statutes, rules and regulations promulgated to regulate the oil and gas industry have been fully complied with and the statements herein are complete and correct to the best of my knowledge.
Signature Bryan Humphries Title Manager Engineering Date 1-22-1990
Subscribed and sworn to before me this 22nd day of January 19 90
Notary Public Nancy C. Hawn Date Commission Expires 8-8-91

SIDE TWO

Operator Name OXY USA Inc. Lease Name Kapp B Well # 3

Sec. 15 Twp. 32S Rge. 34
 East
 West

County Seward

RELEASED

JAN 29 1991

RECOMPLETION FORMATION DESCRIPTION

FROM CONFIDENTIAL

Log Sample

Name	Top	Bottom
Winfield	2690	2720'
Krider	2646	2678'
Herington	2622	2630'
Hollenberg	2588	2597'
TD		6350'
PBTD		2900'

ADDITIONAL CEMENTING/SQUEEZE RECORD

Purpose: <input checked="" type="checkbox"/> Perforate <input type="checkbox"/> Protect Casing <input type="checkbox"/> Plug Back TD <input type="checkbox"/> Plug Off Zone	Depth		Type of Cement	# Sacks Used	Type and Percent Additives
	Top	Bottom			
	2588	2720	No additional cementing/squeeze record.		

Shots Per Foot	PERFORATION RECORD		Acid, Fracture, Shot, Cement Squeeze Record (Amount and Kind of Material Used)
	Specify Footage of Each Interval Perforated		
1	2690-2720' (30'; 33 holes)		Acidized Chase w/5000 gals. 15% HCL;
	2646-2678' (32'; 36 holes)		flushed w/100 bbls. 2% KCLW.
	2622-2630' (8'; 9 holes)		
	2588-2597' (9'; 10 holes)		

PBTD 2900' Plug Type CIBD at 4140'

TUBING RECORD

Size --- Set At --- Packer At --- Was Liner Run --- N

Date of Resumed Production, Disposal or Injection ---

Estimated Production Per 24 Hours Oil --- Bbls. Water --- Bbls. Gas-Oil-Ratio ---

Gas 259 Mcf on 1/4" choke

Disposition of Gas: ---

Vented Sold Used on Lease (If vented, submit ACO-18.)