

STATE CORPORATION COMMISSION OF KANSAS
OIL & GAS CONSERVATION DIVISION
WELL COMPLETION OR RECOMPLETION FORM
ACO-1 WELL HISTORY
DESCRIPTION OF WELL AND LEASE

API NO. 15-189-21,104-00-00
County Stevens
.....C... SW. Sec. 10. Twp 33S. Rge. 38W. East West

FROM CONFIDENTIAL

Operator: License # 5598
Name APX Corporation
Address P. O. Box 351
City/State/Zip Liberal, Kansas 67905-0351

1320
3960
..... Ft North from Southeast Corner of Section
..... Ft West from Southeast Corner of Section
(Note: Locate well in section plat below)

Purchaser Panhandle Eastern Pipe Line Co.
(Transporter)

Lease Name Gaskill "A" Well # 3H

Operator Contact Person M. L. Pease
Phone (316) 624-6253

Field Name Hugoton

Producing Formation Chase

Contractor: License # 5842
Name Gabbert-Jones, Inc.

Elevation: Ground 3158.0 KB

Wellsite Geologist NA
Phone

Designate Type of Completion
 New Well Re-Entry Workover
 Oil SWD Temp Abd
 Gas Inj Delayed Comp.
 Dry Other (Core, Water Supply etc.)

KANSAS GEOLOGICAL SURVEY
STATE CORPORATION COMMISSION
WICHITA BRANCH
10-31-89
OCT 31 1989
CONSERVATION DIVISION
Wichita, Kansas

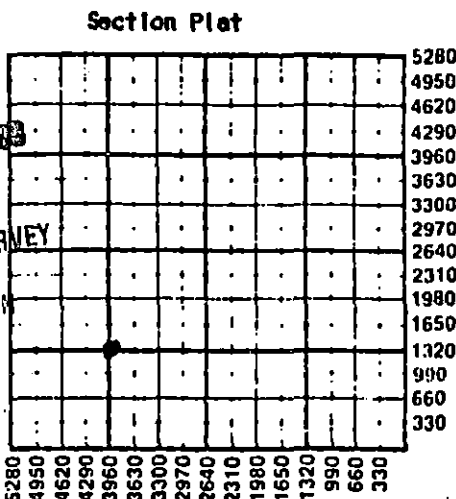

If ONWO: old well info as follows:
Operator
Well Name
Comp. Date Old Total Depth

WATER SUPPLY INFORMATION

Disposition of Produced Water: Disposal
Docket # Repressuring

WELL HISTORY
Drilling Method: Mud Rotary Air Rotary Cable
8/21/87 8/24/87 9/28/88
Spud Date Date Reached TD Completion Date
2862 2844
Total Depth PBTD

Questions on this portion of the ACO-1 call:
Water Resources Board (913) 296-3717
Source of Water:
Division of Water Resources Permit #
 Groundwater.....Ft North from Southeast Corner
(Well)Ft West from Southeast Corner of
Sec Twp Rge East West
 Surface Water.....Ft North from Southeast Corner
(Stream, pond etc).....Ft West from Southeast Corner
Sec Twp Rge East West
 Other (explain) Contractor provided water
(purchased from city, R.W.D. #)

Amount of Surface Pipe Set and Cemented at 519 feet
Multiple Stage Cementing Collar Used? Yes No
If yes, show depth set.....feet
If alternate 2 completion, cement circulated
from.....feet depth to.....w/.....SX cmt
Cement Company Name Halliburton Services
Invoice # 584733

INSTRUCTIONS: This form shall be completed in triplicate and filed with the Kansas Corporation Commission, 200 Colorado Derby Building, Wichita, Kansas 67202, within 120 days of the spud date of any well. Rule 82-3-130, 82-3-107 and 82-3-106 apply. Information on side two of this form will be held confidential for a period of 12 months if requested in writing and submitted with the form. See rule 82-3-107 for confidentiality in excess of 12 months. One copy of all wireline logs and drillers time log shall be attached with this form. Submit CP-4 form with all plugged wells. Submit CP-111 form with all temporarily abandoned wells.

All requirements of the statutes, rules and regulations promulgated to regulate the oil and gas industry have been fully complied with and the statements herein are complete and correct to the best of my knowledge.

Signature M. L. Pease
Title Division Production Manager Date 12/22/88

Subscribed and sworn to before me this 22nd day of December 1988
Notary Public Kathryn A. Rowley
Date Commission Expires 8-1-92

K.C.C. OFFICE USE ONLY
F Letter of Confidentiality Attached
C Wireline Log Received
C Drillers Timelog Received
Distribution
 KCC SWD/Rep NGPA
 KGS Plug Other
(Specify)

KATHRYN A. ROWLEY
Notary Public - State of Kansas
My Appt. Expires 8-1-92

Operator Name **APX Corporation** Lease Name **Gaskill "A"** Well # **3H**

Sec. **10** Twp. **33S** Rge. **38** East West County **Stevens**

WELL LOG

INSTRUCTIONS: Show important tops and base of formations penetrated. Detail all cores. Report all drill stem tests giving interval tested, time tool open and closed, flowing and shut-in pressures, whether shut-in pressure reached static level, hydrostatic pressures, bottom hole temperature, fluid recovery, and flow rates if gas to surface during test. Attach extra sheet if more space is needed. Attach copy of log.

Drill Stem Tests Taken Yes No
 Samples Sent to Geological Survey Yes No
 Cores Taken Yes No

Formation Description
 Log Sample

Name	Top	Bottom
Sand, Redbed	0'	520'
Redbed	520	585
Sand, Shale	585	1097
Shale, Redbed	1097	1160
Glorietta Sand	1160	1360
Shale	1360	1930
Shale, Lime	1930	2775
Lime	2775	2862
TD		2862

CASING RECORD Now Used
 Report all strings set-conductor, surface, intermediate, production, etc.

Purpose of String	Size Hole Drilled	Size Casing Set (In O.D.)	Weight Lbs/Ft.	Setting Depth	Type of Cement	#Sacks Used	Type and Percent Additives
Surface	12-1/4"	8-5/8"	24.0	519	Pozmix & Common	300	3% CC
Production	7-7/8"	5-1/2"	14.0	2861	Class C	240	10% DCD, 20% DCD

Shots Per Foot	Specify Footage of Each Interval Perforated	Acid, Fracture, Shot, Cement Squeeze Record (Amount and Kind of Material Used)	Depth
2	2482-2492, 2510-2550, 2560-2594, 2622-2670, 2681-2714, 2738-2748, 2768-2780	Brk dwn w/20,700 gals. 2% KCl wtr. Frac w/134,900 gals. gelled 2% KCl wtr + 367,800# 12/20 sd	2482-2780 OA

TUBING RECORD Size Set At Packer at Liner Run Yes No

Date of First Production **10/10/88** Producing Method Flowing Pumping Gas Lift Other (explain).....

Estimated Production Per 24 Hours	Oil Bbls	Gas MCF	Water Bbls	Gas-Oil Ratio	Gravity
		2310 MCF @ 90 psig		CFPB	

METHOD OF COMPLETION Production Interval

Disposition of gas: Vented Sold Used on Lease Open Hole Perforation Other (Specify) **2482-2780 OA**
 Dually Completed Commingled

