

NEW ACO-1 FORM

SIDE ONE

**STATE CORPORATION COMMISSION OF KANSAS
OIL & GAS CONSERVATION DIVISION**

**WELL COMPLETION OR RECOMPLETION FORM
ACO-1 WELL HISTORY**

DESCRIPTION OF WELL AND LEASE

Operator: license #5023
name Kansas Petroleum, Inc.
address 225 N. Market, Suite 310
City/State/Zip Wichita, KS. 67202

Operator Contact Person: James Tasheff
Phone 316-267-2266

Contractor: license # 5427
name D. R. Lauck Oil Company, Inc.

Wellsite Geologist: Roger L. Martin
Phone 316-263-4248

PURCHASER: Northern Gas Products Company

Designate Type of Completion
 New Well Re-Entry Workover
 Oil SWD Temp Abd
 Gas Inj Delayed Comp.
 Dry Other (Core, Water Supply etc.)

If **OWWO:** old well info as follows:
 Operator _____
 Well Name _____
 Comp. Date _____ Old Total Depth _____

WELL HISTORY

Drilling Method: Mud Rotary Air Rotary Cable
 11-15-83 11-27-83 3-8-84
 Spud Date Date Reached TD Completion Date
 5697
 Total Depth PBDT
 Amount of Surface Pipe Set and Cemented at 858 feet
 Multiple Stage Cementing Collar Used? Yes No
 If Yes, Show Depth Set _____ feet
 If alternate 2 completion, cement circulated from _____ feet depth to _____ w/ _____ SX cmt

API NO. 15 - 025-20,747-00-00

County Clark

SW SW Sec 7 Twp 34 Rge 24 West
(location)

660 Ft North from Southeast Corner of Section
 4620 Ft West from Southeast Corner of Section
 (Note: locate well in section plat below)

Lease Name Klinger Well# 1-7

Field Name McKinney East

Producing Formation Miss. Chester

Elevation: Ground 1970 KB 1975

Section Plat

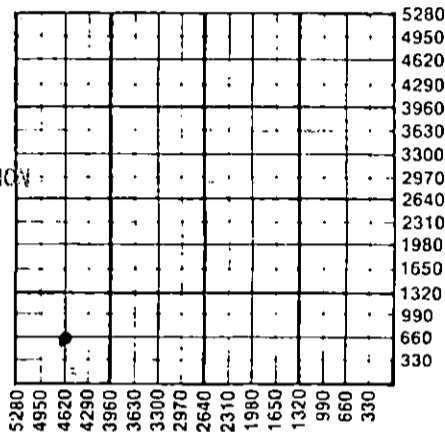

RECEIVED

STATE CORPORATION COMMISSION
 10-30-84
 OCT 30 1984

CONSERVATION DIVISION
 Wichita, Kansas

WATER SUPPLY INFORMATION

Source of Water: _____
 Division of Water Resources Permit # Don't know
 Groundwater 630 Ft North From Southeast Corner and
 (Well) 4520 Ft. West From Southeast Corner of
 Sec 7 Twp 34 Rge 24 East West
 Surface Water _____ Ft North From Southeast Corner and
 (Stream, Pond etc.) _____ Ft West From Southeast Corner
 Sec Twp Rge East West
 Other (explain) _____
 (purchased from city, R.W.D.#)

Disposition of Produced Water: Disposal Repressuring

Docket # _____

INSTRUCTIONS: This form shall be completed in duplicate and filed with the Kansas Corporation Commission, 200 Colorado Derby Building, Wichita, Kansas 67202, within 90 days after completion or recompletion of any well. Rules 82-3-130 and 82-3-107 apply.

Information on side two of this form will be held confidential for a period of 12 months if requested in writing and submitted with the form. See rule 82-3-107 for confidentiality in excess of 12 months.

One copy of all wireline logs and drillers time log shall be attached with this form. Submit CP-4 form with all plugged wells. Submit CP-111 form with all temporarily abandoned wells.

All requirements of the statutes, rules, and regulations promulgated to regulate the oil and gas industry have been fully complied with and the statements herein are complete and correct to the best of my knowledge.

Signature *James Tasheff*

Title President Date 9/30/84

Subscribed and sworn to before me this 30 day of Sept. 19 84

Notary Public *Irene LaGrange*
 Date Commission Expires _____



K.C.C. OFFICE USE ONLY
 F Letter of Confidentiality Attached
 C Wireline Log Received
 C Drillers Timelog Received
Distribution
 KCC SWD/Rep NGPA
 KGS Plug Other
 (Specify) _____

Form ACO-1 (7-84)

Sec 7 Twp 34 Rge 24 West

SIDE TWO

Operator Name Kansas Petroleum, Inc. Lease Name Klinger Well# 1-7 SEC. 7 TWP. 34 RGE. 24 East West

WELL LOG

INSTRUCTIONS: Show important tops and base of formations penetrated. Detail all cores. Report all drill stem tests giving interval tested, time tool open and closed, flowing and shut-in pressures, whether shut-in pressure reached static level, hydrostatic pressures, bottom hole temperature, fluid recovery, and flow rates if gas to surface during test. Attach extra sheet if more space is needed. Attach copy of log.

Drill Stem Tests Taken Yes No
 Samples Sent to Geological Survey Yes No
 Cores Taken Yes No

Formation Description
 Log Sample

Name	Top	Bottom
Heebner	4238	-2263
Toronto	4258	-2283
Lansing	4418	-2443
Swope	4960	-2985
Hertha	4996	-3021
B/K.C.	5031	-3056
Pawnee	5175	-3200
Cherokee	5245	-3260
Atoka	5404	-3429
Miss. Chester	5496	-3521

CASING RECORD new used

Report all strings set - conductor, surface, intermediate, production, etc.

Purpose of string	size hole drilled	size casing set (in O.D.)	weight lbs/ft.	setting depth	type of cement	# sacks used	type and percent additives
Conductor	30"	20"		90'	(welded)	10½ yards	Redi-mix, 10% sk mix
Surface (new)	12 1/4	8 5/8	24#	858	Light/Com	450	3% C.C.
Production (new & used)	7 7/8	4 1/2	11.60#	5702	60-40 Poz	175	10% salt, 3/4% CFR2

PERFORATION RECORD

Acid, Fracture, Shot, Cement Squeeze Record

shots per foot	specify footage of each interval perforated	(amount and kind of material used)	Depth
2	5556-63 & 5584-98	250 gal. 10% acetic acid	5620-5220
2	5498-5502 & 5518-5525	250 gal. 10% acetic acid	5530-5130
		5000 gal. 28% acid, .75% quality foam (bottom zones)	
		w/ 340,000 SCF nitrogen	
		3000 gal. 28% acid, .75% quality foam (top zones)	

TUBING RECORD

size 2 3/8 set at 5620 packer at 5535 w/ 208,000 SCF nitrogen
 Liner Run Yes No

Date of First Production Shut in

Producing method flowing pumping gas lift Other (explain)

Estimated Production Per 24 Hours	Oil Bbls	Gas MCF	Water Bbls	Gas-Oil Ratio CFPB	Gravity
0		440 lower zones 600 upper zones			

METHOD OF COMPLETION

Disposition of gas: vented sold used on lease
 open hole perforation other (specify) Dually Completed. Commingled

PRODUCTION INTERVAL

5498-5502 5518-5525
 5556-3365 5584-5598