

STATE CORPORATION COMMISSION OF KANSAS
OIL & GAS CONSERVATION DIVISION

WELL COMPLETION OR RECOMPLETION FORM
ACO-1 WELL HISTORY

DESCRIPTION OF WELL AND LEASE

Operator: license # 6568
name KAISER-FRANCIS OIL COMPANY
address P.O. BOX 21468
City/State/Zip TULSA, OKLAHOMA 74121-1468

Operator Contact Person CHARLOTTE VAN VALKENBURG
Phone 1 (918) 494-0000

Contractor: license # 5842 (RIG TAG # 383)
name GABBERT-JONES INC.

Wellsite Geologist BOB ANDERSON
Phone (918) 494-0000

PURCHASER NONE

Designate Type of Completion
 New Well Re-Entry Workover
 Oil SWD Temp Abd
 Gas Inj Delayed Comp.
 Dry Other (Core, Water Supply etc.)

If OWWO: old well info as follows:
Operator
Well Name
Comp. Date Old Total Depth

WELL HISTORY

Drilling Method: Mud Rotary Air Rotary Cable
3-20-84 8-29-84 10-4-84
Spud Date Date Reached TD Completion Date
6200 5730 (CIBP)
Total Depth PBTD

Amount of Surface Pipe Set and Cemented at 850 feet
Multiple Stage Cementing Collar Used? Yes No
If Yes, Show Depth Set feet

If alternate 2 completion, cement circulated from feet depth to w/ SX cmt

ALTERNATE 1 COMPLETION

API NO. 15 119-20,673-00-00
County MEADE
NE NE NE Sec 10 Twp 34S Rge 26 X East West

4950 Ft North from Southeast Corner of Section
330 Ft West from Southeast Corner of Section
(Note: locate well in section plat below)

Lease Name DAVID WILSON Well# 1-10

Field Name MCKINNEY

Producing Formation NONE - DRY HOLE

Elevation: Ground 2250 KB 2259

RECEIVED
STATE CORPORATION COMMISSION
DEC 20 1984
CONSERVATION DIVISION
Wichita, Kansas

12-20-84

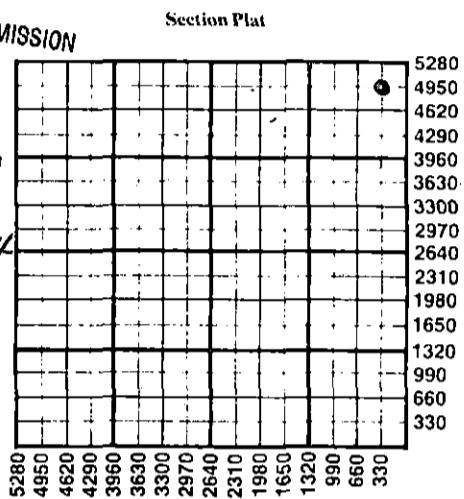

WATER SUPPLY INFORMATION

Source of Water: NONE REQUIRED -
Division of Water Resources Permit # EXISTING WATER WELL

Groundwater 2640 Ft North From Southeast Corner and
(Well) 2640 Ft. West From Southeast Corner of
Sec II Twp 34S Rge 26 East West

Surface Water Ft North From Southeast Corner and
(Stream, Pond etc.) Ft West From Southeast Corner
Sec Twp Rge East West

Other (explain)
(purchased from city, R.W.D.#)

Disposition of Produced Water: Disposal Repressuring

Docket # --
TRUCKED BY GENERAL, INC. TO THEIR DISPOSAL
WELL IN OKLAHOMA.

INSTRUCTIONS: This form shall be completed in duplicate and filed with the Kansas Corporation Commission, 200 Colorado Derby Building, Wichita, Kansas 67202, within 90 days after completion or recompletion of any well. Rules 82-3-130 and 82-3-107 apply.

Information on side two of this form will be held confidential for a period of 12 months if requested in writing and submitted with the form. See rule 82-3-107 for confidentiality in excess of 12 months.

One copy of all wireline logs and drillers time log shall be attached with this form. Submit CP-4 form with all plugged wells. Submit CP-111 form with all temporarily abandoned wells.

All requirements of the statutes, rules, and regulations promulgated to regulate the oil and gas industry have been fully complied with and the statements herein are complete and correct to the best of my knowledge.

T.T. JACOBSON

Signature [Signature]
Title ENGINEER Date 12-17-84

Subscribed and sworn to before me this 17th day of DECEMBER 19 84

Notary Public Sue Mills
Date Commission Expires 10-4-87

K.C.C. OFFICE USE ONLY
F Letter of Confidentiality Attached
C Wireline Log Received
C Drillers Timelog Received
Distribution
 KCC SWD/Rep NGPA
 KGS Plug Other (Specify)

Sec. 10 Twp. 34S Rge. 26W

SIDE TWO

Operator Name KAISER-FRANCIS OIL CO. Lease Name DAVID WILSON Well# 1-10 SEC 10 TWP. 34S RGE. 26 East West

WELL LOG

INSTRUCTIONS: Show important tops and base of formations penetrated. Detail all cores. Report all drill stem tests giving interval tested, time tool open and closed, flowing and shut-in pressures, whether shut-in pressure reached static level, hydrostatic pressures, bottom hole temperature, fluid recovery, and flow rates if gas to surface during test. Attach extra sheet if more space is needed. Attach copy of log.

Drill Stem Tests Taken Yes No
 Samples Sent to Geological Survey Yes No
 Cores Taken Yes No

Formation Description
 Log Sample

DST # 1 - 5760-5825'. FIRST FLOW: OPEN 30 MIN. CLOSE 60 MIN. FINAL FLOW: OPEN 60 MIN. CLOSE 120 MIN. PACKER FAILED.

DST # 2 - PKR WOULD NOT SET.

DST # 3 - 4870-4920'. FIRST FLOW: OPEN 60 MIN. CLOSE 120 MIN. FINAL FLOW: SAME. PACKER FAILED.

Name	Top	Bottom
TORONTO	4420'	
LANSING	4578'	
MARM	5248	
ATOKA	5676	
MORROW	5715	
CHESTER	5776	
ST. GEN.	6080	

CASING RECORD <input type="checkbox"/> new <input type="checkbox"/> used							
Report all strings set - conductor, surface, intermediate, production, etc.							
Purpose of string	size hole drilled	size casing set (in O.D.)	weight lbs/ft.	setting depth	type of cement	# sacks used	type and percent additives
SURFACE	12 1/4	8 5/8	24	850	HLC & CLH	450	1/4 # FLOSEAL, 2%CC
PRODUCTION	7 7/8	5 1/2	15.5	6202	THIX-SET	75	3%CC
		D.V. TOOL		5010	THIX-SET	55	12.5#GILSONITE/SX
PERFORATION RECORD				Acid, Fracture, Shot, Cement Squeeze Record			
shots per foot	specify footage of each interval perforated			(amount and kind of material used)			Depth
1 SP2F	6118-33			4000 g 15% NE HCL			6000-6133
1 SPF	6056-62, 6000-14						
1 SPF	5866-82			2500 g 15% NE HCL			5866-82
1 SPF	5798-5804, 5810-16			2500 g 15% NE HCL			5798-5816
2 SPF	4906-10			750 g 15% NE HCL			4906-10
TUBING RECORD				Liner Run <input type="checkbox"/> Yes <input checked="" type="checkbox"/> No			
size NONE set at -- packer at NONE							
Date of First Production	Producing method <input type="checkbox"/> flowing <input type="checkbox"/> pumping <input type="checkbox"/> gas lift <input type="checkbox"/> Other (explain) DRY HOLE						
NONE							
Estimated Production Per 24 Hours	Oil	Gas	Water	Gas-Oil Ratio	Gravity		
	--	--	--				
	Bbls	MCF	Bbls	CFPB			

Disposition of gas: vented
 sold
 used on lease
 NONE

METHOD OF COMPLETION
 open hole perforation
 other (specify) _____
 Dually Completed.
 Commingled

PRODUCTION INTERVAL
 NONE