

RELEASED
2/9/89

ORIGINAL

SIDE ONE

STATE CORPORATION COMMISSION OF KANSAS
OIL & GAS CONSERVATION DIVISION
WELL COMPLETION OR RECOMPLETION FORM
ACO-1 WELL HISTORY
DESCRIPTION OF WELL AND LEASE

API NO. 15-189-21,277-00-00
County Stevens FROM CONFIDENTIAL
Sec. 25 Twp. 33S Rge. 39 East
West

Operator: License # 5598
Name APX Corporation
Address P. O. Box 351
City/State/Zip Liberal, Kansas 67905-0351

1390 Ft North from Southeast Corner of Section
4030 Ft West from Southeast Corner of Section
(Note: Locate well in section plat below)

Purchaser Panhandle Eastern Pipe Line Co.
(Transporter)

Lease Name Ahrens "B" Well # 1H
Field Name Hugoton

Operator Contact Person M. L. Pease
Phone (316) 624-6253

Producing Formation Chase
Elevation: Ground 3220.9 KB NA

Contractor License # 5842
Name Gabbert-Jones, Inc.

Wellsite Geologist NA
Phone

Designate Type of Completion
 New Well Re-Entry Workover

Oil SWD Temp Abd
 Gas Inj Delayed Comp.
 Dry Other (Core; Water Supply etc.)

If OWN: old well info as follows:
Operator
Well Name
Comp. Date Old Total Depth

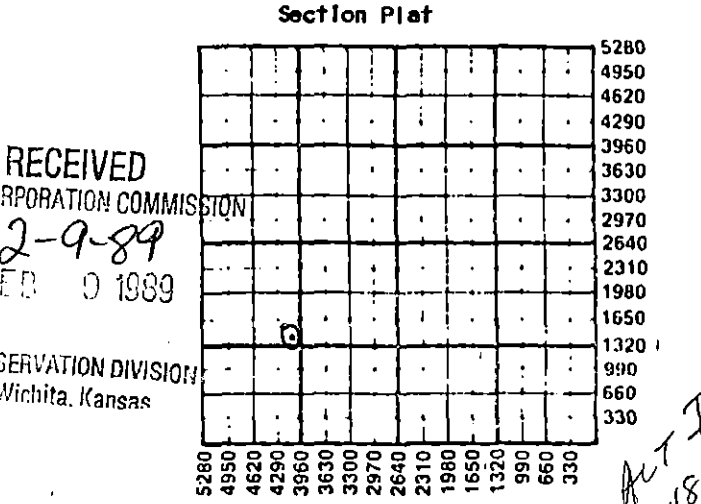

WATER SUPPLY INFORMATION
Disposition of Produced Water: Disposal
Docket # Repressuring

Questions on this portion of the ACO-1 call:
Water Resources Board (913) 296-3717
Source of Water:
Division of Water Resources Permit #
 Groundwater (Well) Ft North from Southeast Corner
Ft West from Southeast Corner of
Sec Twp Rge East West
 Surface Water (Stream, pond etc.) Ft North from Southeast Corner
Ft West from Southeast Corner
Sec Twp Rge East West
 Other (explain) Contractor provided water
(purchased from city, R.W.D. #)

INSTRUCTIONS: This form shall be completed in triplicate and filed with the Kansas Corporation Commission, 200 Colorado Derby Building, Wichita, Kansas 67202, within 120 days of the spud date of any well. Rule 82-3-130, 82-3-107 and 82-3-106 apply. Information on side two of this form will be held confidential for a period of 12 months if requested in writing and submitted with the form. See rule 82-3-107 for confidentiality in excess of 12 months. One copy of all wireline logs and drillers time log shall be attached with this form. Submit CP-4 form with all plugged wells. Submit CP-111 form with all temporarily abandoned wells.

All requirements of the statutes, rules and regulations promulgated to regulate the oil and gas industry have been fully complied with and the statements herein are complete and correct to the best of my knowledge.

Signature M. L. Pease

Title Division Production Manager Date 2/7/89

Subscribed and sworn to before me this 8th day of Feb. 1989
Notary Public Glenna S. Salley

Date Commission Expires

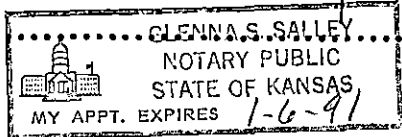

K.C.C. OFFICE USE ONLY
 Letter of Confidentiality Attached
 Wireline Log Received
 Drillers Time Log Received
Distribution
 KCC SWD/Rep NGPA
 KGS Plug Other
(Specify)

Sec 25, Twp. 33, Rge. 39, C 2
PI

Operator Name APX Corporation Lease Name Ahrens "B" Well # 1H

Sec. 25 Twp. 33S Rge. 39 East West County Stevens

WELL LOG

INSTRUCTIONS: Show important tops and base of formations penetrated. Detail all cores. Report all drill stem tests giving interval tested, time tool open and closed, flowing and shut-in pressures, whether shut-in pressure reached static level, hydrostatic pressures, bottom hole temperature, fluid recovery, and flow rates if gas to surface during test. Attach extra sheet if more space is needed. Attach copy of log.

Drill Stem Tests Taken Yes No
 Samples Sent to Geological Survey Yes No
 Cores Taken Yes No

Formation Description
 Log Sample

Name	Top	Bottom
Sand, Clay	0'	495'
Redbed	495	905
Shale	905	1215
Glorietta Sand	1215	1408
Shale	1408	1665
Shale, Lime	1665	2909
TD		2909

RELEASED

BY 2 A 101

FROM [unclear]

CASING RECORD <input checked="" type="checkbox"/> New <input type="checkbox"/> Used							
Report all strings set-conductor, surface, intermediate, production, etc.							
Purpose of String	Size Hole Drilled	Size Casing Set (in O.D.)	Weight Lbs/Ft.	Setting Depth	Type of Cement	#Sacks Used	Type and Percent Additives
Surface	12-1/4"	8-5/8"	24.0	564	Pozmix & Common	350	3% CC
Production	7-7/8"	5-1/2"	14.0	2904	Class C	250	10% DCD, 20% DCD
PERFORATION RECORD				Acid, Fracture, Shot, Cement Squeeze Record			
Shots Per Foot	Specify Footage of Each Interval Perforated			(Amount and Kind of Material Used)		Depth	
2	2529-2544, 2554-2587, 2617-2640, 2668-2696, 2731-2757, 2784-2793, 2819-2825, 2830-2840			Brk dwn w/17,000 gal 2% KCL wtr. Frac w/135,000 gal x-link gelled 2% KCL wtr & 367,800# 12/20 sd.		2529-2840 OA	
TUBING RECORD				Liner Run <input type="checkbox"/> Yes <input checked="" type="checkbox"/> No			
Date of First Production	Producing Method						
1/3/89	<input checked="" type="checkbox"/> Flowing <input type="checkbox"/> Pumping <input type="checkbox"/> Gas Lift <input type="checkbox"/> Other (explain).....						
Estimated Production Per 24 Hours	Oil	Gas	Water	Gas-Oil Ratio		Gravity	
	Bbls	1630 MCF @ 100 PSI	Bbls	CFPB			

METHOD OF COMPLETION

Production Interval

Disposition of gas: Vented Sold Used on Lease Open Hole Perforation Other (Specify) 2529-2840 OA
 Dually Completed Commingled

RELEASED

FEB 2 8 1991

API # 15 189 21,277
Ahrens "B" Lease Well #1H
SE NW SW 25 33 39W

FROM CONFIDENTIAL

<u>NAME</u>	<u>TOP</u>	<u>BOTTOM</u>
Blaine	1090	1211
Cedar Hills	1242	1406
Stone Corral	1677	1708
Chase	2506	2842
Panoma Council Grove	2842	NA
TD		2909

RECEIVED
STATE CORPORATION COMMISSION

FEB 1 8 1991

CONSERVATION DIVISION
Wichita, Kansas

GABBERT-JONES
DRILLERS WELL LOG

RELEASED

FEB 28 1991

AHRENS "B" 1H
SEC. 25-33S-39W
STEVENS COUNTY, KANSAS

FROM CONFIDENTIAL

Commenced: 10-22-88
Completed: 10-25-88
Operator: ANADARKO PETROLEUM CORPORATION

Depth		Formation	Remarks
From	To		
0	495	Sand - Clay	Ran 13 jts of 24# 8 5/8" csg LD @ 564' w/200 sks 25/75 Posmix - 2% CC - 1/4# CF 150 sks Common, 3% CC 1/4# CF PD @ 10:15 PM 10-22-88.
495	905	Redbed	
905	1215	Shale	
1215	1408	Glorita Sand	
1408	1665	Shale	
1665	2909	Shale - Lime	
	2909 TD		Ran 71 jts of 14# 5 1/2" csg LD @ 2904' w/210 sks Class C - 20% DCD - 2% CC 1/4# CF - 40 sks Class C 10% DCD - 2% CC - 1/4# CF PD @ 6:15 AM 10-25-88.

RECEIVED
STATE CORPORATION COMMISSION

FEB 9 1989

CONSERVATION DIVISION
Wichita, Kansas

State of Kansas)
County of Sedgwick) I, the undersigned, being duly sworn on oath, state that the above Drillers ' Well Log is true and correct to the best of my knowledge and belief and according to the records of this office.

GABBERT-JONES, INC.

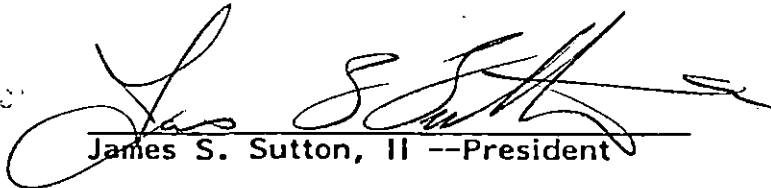
James S. Sutton, II --President

Subscribed & sworn to before me this
27th day of October 1988

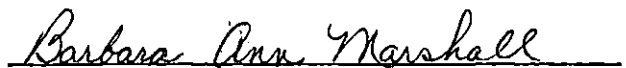
BARBARA ANN MARSHALL

My Commission expires August 15, 1992

INVOICE

HALLIBURTON SERVICES

A Halliburton Company

FEB 28 1991

INVOICE NO. 720929 DATE 10/22/1988

FROM CONFIDENTIAL

WELL LEASE NO./PLANT NAME		WELL/PLANT LOCATION		STATE	WELL/PLANT OWNER	
AHRENS B-1H		STEVENS		KS	SAME	
SERVICE LOCATION		CONTRACTOR		JOB PURPOSE		TICKET DATE
LIBERAL		GABBERT & JONES #6		CEMENT SURFACE CASING		10/22/1988
ACCT. NO.	CUSTOMER AGENT	VENDOR NO.	CUSTOMER P.O. NUMBER		SHIPPED VIA	FILE NO.
001527	PAUL GATLIN				COMPANY TRUCK	66834

RECEIVED
 APX CORPORATION STATE CORPORATION COMMISSION DIRECT CORRESPONDENCE TO:
 P. O. BOX 351 SUITE 600
 LIBERAL, KS 67905-0351 FEB 9 1989 COLORADO DERBY BUILDING
 WICHITA, KS 67202-0000

CONSERVATION DIVISION

PRICE REF. NO.	DESCRIPTION	QUANTITY	U/M	UNIT PRICE	AMOUNT
000-117	MILEAGE	10	MI	2.20	22.00
		1	UNT		
001-016	CEMENTING CASING PUMP CHARGE	569	FT	502.60	502.60
		1	UNT		
030-018	TYPE 5W, PLASTIC TOP PLUG	8 5/8	IN	82.00	82.00 *
		1	EA		
504-043	PREMIUM CEMENT	150	SK	6.85	1,027.50 *
506-105	POZMIX A	50	SK	3.91	195.50 *
504-043	PREMIUM CEMENT	150	SK	6.85	1,027.50 *
509-406	ANHYDROUS CALCIUM CHLORIDE	8	SK	25.75	206.00 *
507-210	FLOCELE	88	LB	1.21	106.48 *
500-207	BULK SERVICE CHARGE	366	CFT	.95	347.70 *
500-306	MILEAGE	163.14	TMI	.70	114.20 *
INVOICE SUBTOTAL					3,631.48
DISCOUNT-(BID)					689.95-
INVOICE BID AMOUNT					2,941.53
*-KANSAS STATE SALES TAX					100.66
*-SEWARD COUNTY SALES TAX					25.16
<p>2106-2041</p> <p>KA 11-2</p>					
INVOICE TOTAL - PLEASE PAY THIS AMOUNT =====>					\$3,067.35

FINAL APPROVAL	
AP#	LOCATION
LIBERAL OPERATIONS RECEIVED	
NOV 01 1988	
APPROVED	IOC
CATE	TANGIBLE
COPIED BY	OPERATIONS

TERMS INVOICES PAYABLE NET BY THE 20TH OF THE FOLLOWING MONTH AFTER DATE OF INVOICE. UPON CUSTOMER'S DEFAULT IN PAYMENT OF CUSTOMER'S ACCOUNT BY THE LAST DAY OF THE MONTH FOLLOWING THE MONTH IN WHICH THE INVOICE IS DATED, CUSTOMER AGREES TO PAY INTEREST THEREON AFTER DEFAULT AT THE HIGHEST LAWFUL CONTRACT RATE APPLICABLE BUT NEVER TO EXCEED 18% PER ANNUM. IN THE EVENT IT BECOMES NECESSARY TO EMPLOY AN ATTORNEY TO ENFORCE COLLECTION OF SAID ACCOUNT, CUSTOMER AGREES TO PAY ALL COLLECTION COSTS AND ATTORNEY FEES IN THE AMOUNT OF 20% OF THE AMOUNT OF THE UNPAID ACCOUNT.