

STATE CORPORATION COMMISSION OF KANSAS
OIL & GAS CONSERVATION DIVISION
WELL COMPLETION FORM
ACO-1 WELL HISTORY
DESCRIPTION OF WELL AND LEASE

Operator: License # 5208
Name: Mobil Oil Corporation
Address P.O. Box 2173
2319 North Kansas Avenue
City/State/Zip Liberal, KS 67905-2173
Purchaser: N/A
Operator Contact Person: Sharon Cook
Phone (316) 626-1142
Contractor: Name: Catholic Protection Services
License: 31474
Wellsite Geologist: _____

Designate Type of Completion
 New Well Re-Entry Workover
 Oil SWD SLOW Temp. Abd.
 Gas ENHR SIGW
 Dry Other (Core, USU, Expl., Cathodic, etc)

If Workovers:
Operator: _____
Well Name: _____
Comp. Date _____ Old Total Depth _____
 Deepening Re-perf. Conv. to Inj/SWD
 Plug Back PBTD
 Commingled Docket No. _____
 Dual Completion Docket No. _____
 Other (SWD or Inj?) Docket No. _____
1/14/95 _____ 1/14/95 _____ 1/14/95 _____
Spud Date Date Reached TD Completion Date

API NO. 15- 189-21743 ⁰⁰⁻⁰⁰ ORIGINAL
County STEVENS
SW - NE - NE Sec. 21 Twp. 33 Rge. 38 X W
4060 FSL Feet from S/N (circle one) Line of Section
1270 FEL Feet from E/W (circle one) Line of Section
Footages Calculated from Nearest Outside Section Corner:
NE, SE, NW or SW (circle one)
Lease Name CP- FARRAR HOLE #2 Well # 1
Field Name Hugoton
Producing Formation NA [ANODE REPOSITORY]
Elevation: Ground 3172 KB NA
Total Depth 100 PBTD NA
Amount of Surface Pipe Set and Cemented at None Feet
Multiple Stage Cementing Collar Used? NA Yes NA No
If yes, show depth set NA Feet
If Alternate II completion, cement circulated from NA
feet depth to NA w/ NA sx cmt.

Drilling Fluid Management Plan ALT 3 JFH 10-18-95
(Data must be collected from the Reserve Pit)
Chloride content NA ppm Fluid volume NA bbls
Dewatering method used NA
Location of fluid disposal if hauled offsite:
Operator Name NA
Lease Name NA License No. _____
NA Quarter Sec. NA Twp. NA S Rng. NA E/W
County NA Docket No. NA

INSTRUCTIONS: An original and two copies of this form shall be filed with the Kansas Corporation Commission, 200 Colorado Derby Building, Wichita, Kansas 67202, within 120 days of the spud date, recompletion, workover or conversion of a well. Rule 82-3-130, 82-3-106 and 82-3-107 apply. Information on side two of this form will be held confidential for a period of 12 months if requested in writing and submitted with the form (see rule 82-3-107 for confidentiality in excess of 12 months). One copy of all wireline logs and geologist well report shall be attached with this form. ALL CEMENTING TICKETS MUST BE ATTACHED. Submit CP-4 form with all plugged wells. Submit CP-111 form with all temporarily abandoned wells.

All requirements of the statutes, rules and regulations promulgated to regulate the oil and gas industry have been fully complied with and the statements herein are complete and correct to the best of my knowledge.

Signature Sharon A. Cook Sharon A. Cook
Title Regulatory Assistant Date 2-13-95
Subscribed and sworn to before me this 13th day of February,
19 95.
Notary Public Kathleen R. Poulton
Date Commission Expires AUGUST 18, 1998

K.C.C. OFFICE USE ONLY
F Letter of Confidentiality Attached
C Wireline Log Received
C Geologist Report Received
Distribution
 KCC SWD/Rep NGPA
 KGS Plug Other
(Specify)

DEW95097.SAC

NOTARY PUBLIC - State of Kansas
KATHLEEN R. POULTON
My Appl. Exp. 08-18-98

Form ACO-1 (7-91)
FEB 17 1995
2-17-95
CONSERVATION DIVISION
WICHITA, KANSAS

SIDE TWO

Operator Name Mobil Oil Corporation Lease Name CP- FARRAR HOLE #2 Well # 1

Sec. 21 Twp. 33 Rge. 38 East West County STEVENS

INSTRUCTIONS: Show important tops and base of formations penetrated. Detail all cores. Report all drill stem tests giving interval tested, time tool open and closed, flowing and shut-in pressures, whether shut-in pressure reached static level, hydrostatic pressures, bottom hole temperature, fluid recovery, and flow rates if gas to surface during test. Attach extra sheet if more space is needed. Attach copy of log.

Drill Stem Tests Taken <input type="checkbox"/> Yes <input checked="" type="checkbox"/> No (Attach Additional Sheets.) Samples Sent to Geological Survey <input type="checkbox"/> Yes <input checked="" type="checkbox"/> No Cores Taken <input type="checkbox"/> Yes <input checked="" type="checkbox"/> No Electric Log Run <input type="checkbox"/> Yes <input checked="" type="checkbox"/> No (Submit Copy.) List All E.Logs Run: Electric Resistance Log - Attached	<input checked="" type="checkbox"/> Log <input type="checkbox"/> Sample Formation (Top), Depth and Datum Name Top Datum SEE ATTACHED DRILLER'S LOG
---	---

CASING RECORD <input type="checkbox"/> New <input type="checkbox"/> Used							
Report all strings set-conductor, surface, intermediate, production, etc.							
Purpose of String	Size Hole Drilled	Size Casing Set (In O.D.)	Weight Lbs./ft.	Setting Depth	Type of Cement	# Sacks Used	Type and Percent Additives

ADDITIONAL CEMENTING/SQUEEZE RECORD				
Purpose:	Depth Top Bottom	Type of Cement	#Sacks Used	Type and Percent Additives
<input type="checkbox"/> Perforate				
<input type="checkbox"/> Protect Casing				
<input type="checkbox"/> Plug Back TD				
<input checked="" type="checkbox"/> Plug Off Zone				

Shots Per Foot	PERFORATION RECORD - Bridge Plugs Set/Type Specify Footage of Each Interval Perforated	Acid, Fracture, Shot, Cement Squeeze Record (Amount and Kind of Material Used) Depth
First anode set at	70', second anode at 60', third anode at 40'.	

TUBING RECORD	Size Set At	Packer At	Liner Run <input type="checkbox"/> Yes <input type="checkbox"/> No
1" PVC vent from TD to 3' above surface.			
Date of First, Resumed Production, SMD or Inj. Installed <u>1/14/95</u>	Producing Method <input type="checkbox"/> NA <input type="checkbox"/> Flowing <input type="checkbox"/> Pumping <input type="checkbox"/> Gas Lift <input type="checkbox"/> Other (Explain)		
Estimated Production Per 24 Hours	Oil Bbls. NA	Gas Mcf NA	Water Bbls. NA Gas-Oil Ratio Gravity

Disposition of Gas: Vented Sold Used on Lease (If vented, submit ACO-18.)

METHOD OF COMPLETION Open Hole Perf. Dually Comp. Commingled Other (Specify) _____

Production Interval _____

2025 RELEASE UNDER E.O. 14176
 NATIONAL ARCHIVES
 COLLEGE PARK, MARYLAND

DATA SHEET

COMPANY MOBILE E & P JOB No. 80100370 DATE: 1-19-95
 WELL: FARRAR 1 Hole #10 PIPELINE: _____
 LOCATION: SEC. 21 TWP. 33 RGE. 38 CO. STEVENS STATE KS
 ANODE TYPE LIDA ONE FT: ROTARY 75 FT: CASING _____ FT.

DEEP GROUND BED LOGGING DATA

DRILL. DEPTH LOG (FT)	ANODE TO STRUCTURE		ANODES		DRILL DEPTH LOG (FT)	ANODE TO STRUCTURE		ANODES	
	EXPLOR OHM	FINAL OHM	NO	TOP DEPTH		EXPLOR OHM	FINAL OHM	NO	TOP DEPTH
5					205				
HOLE PLUG 10				3'-13'	210				
EARTH FILL 15				13'-38'	215				
20					220				
25					225				
30	.190				230				
HOLE PLUG 35	.330			38'-40'	235				
40	.360		3		240				
45	.250				245				
50	.250				250				
55	.360				255				
60	.760		2		260				
65	.900				265				
70	.820		1		270				
75	.820				275				
80	.240				280				
85	.260				285				
90					290				
95					295				
100					300				
105					305				
110					310				
115					315				
120					320				
125					325				
130					330				
135					335				
140					340				
145					345				
150					350				
155					355				
160					360				
165					365				
170					370				
175					375				
180					380				
185					385				
190					390				
195					395				
200					400				

PIT CLOSED 1-19-95 HOLE PLUG SET 1-19-95

15

Dave:
Locate

Need to locate 12" Plastic
ORIGINAL

Hang Rectifier
No AC until wheat

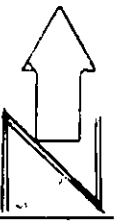

0-5

gray

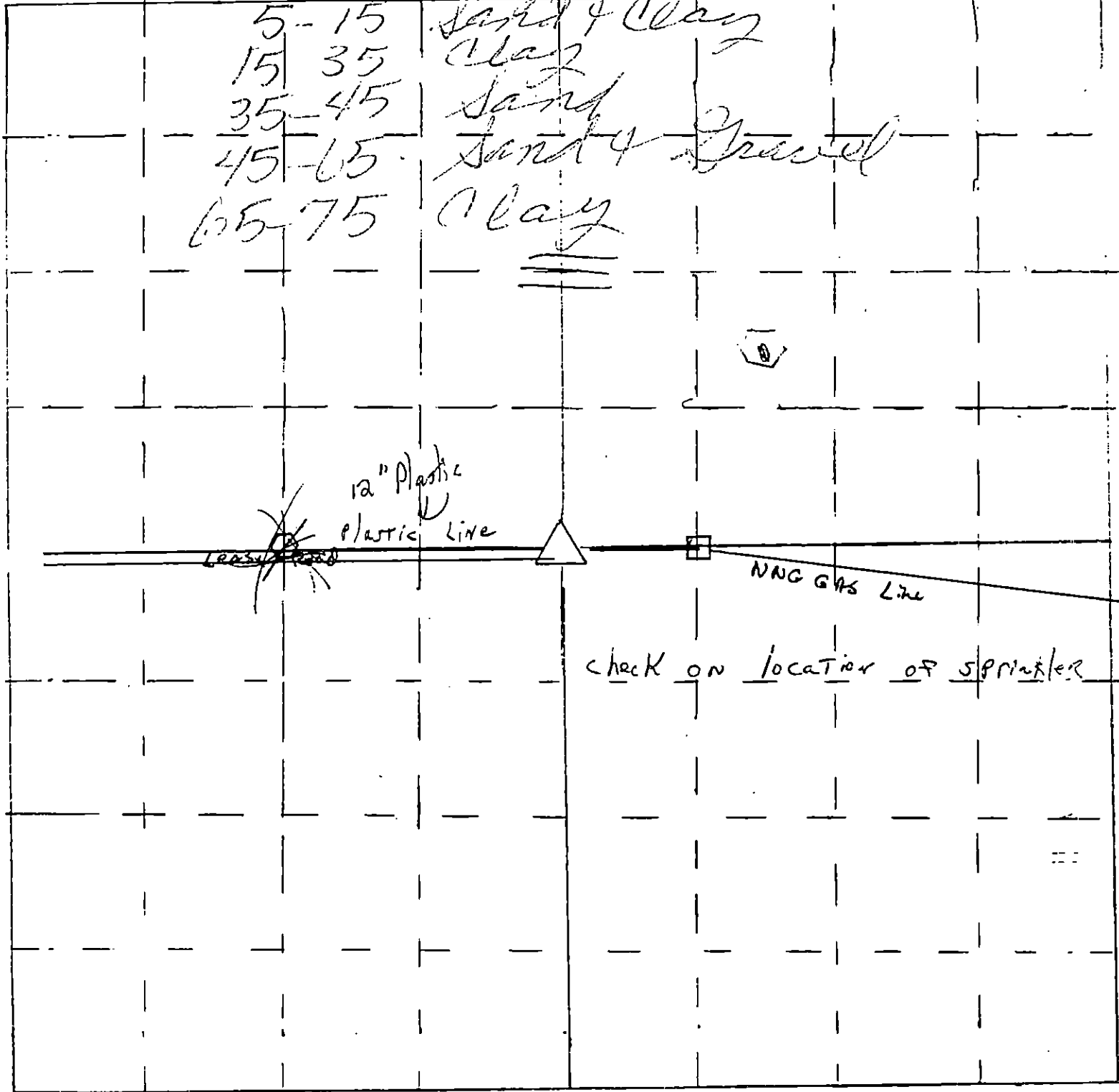

- △ = gas well location
- ◻ = cathodic deep well location

Scale = 1" = 50'

◻ = meter house