

ORIGINAL SIDE ONE

RELEASED

2/14/92

2/14/91

MAR 05 1992

STATE CORPORATION COMMISSION OF KANSAS OIL & GAS CONSERVATION DIVISION

API NO. 15 175-21,056-00

WELL COMPLETION OR RECOMPLETION FORM ACO-1 WELL HISTORY

County Seward FROM CONFIDENTIAL

DESCRIPTION OF WELL AND LEASE

NW NE Sec. 1 Twp. 35S Rge. 32W

660 660 Ft North from Southeast Corner of Section 3300 3300 Ft West from Southeast Corner of Section (Note: locate well in section plat below)

Lease Name KIVETT Well# A-1

Field Name

Producing Formation

Elevation: Ground 2738 KB 2751

Operator: license # name BEREXCO, INC. address 970 Fourth Financial Center City/State/Zip Wichita, KS, 67202

Operator Contact Person Phone

Contractor: license # 5147 name BEREDCO, INC.

Wellsite Geologist Ed. Grieves Phone

PURCHASER

Designate Type of Completion [X] New Well [] Re-Entry

RECEIVED STATE CORPORATION COMMISSION WORKOVER

FEB 14 1989

CONSERVATION DIVISION Wichita, Kansas

MAR 01 1989

KANSAS GEOLOGICAL SURVEY WICHITA BRANCH

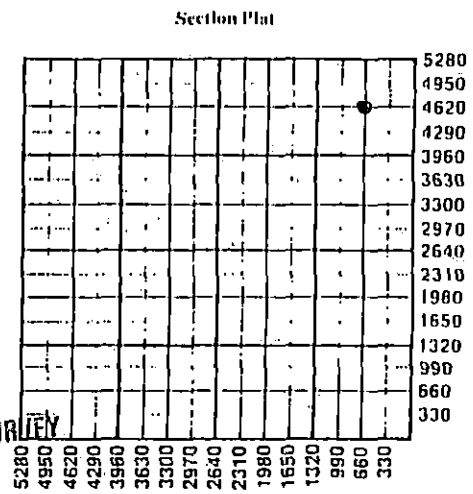

ACT I DSA

- Oil [] Gas [] Dry [X] SWD [] Inj [] Other (Core, Water Supply etc.) [] Temp Abd [] Delayed Comp. []

If OWWO: old well info as follows: Operator Well Name Comp. Date Old Total Depth

WELL HISTORY

Drilling Method: [X] Mud Rotary [] Air Rotary [] Cable

11/07/88 11/22/88 11-23-88 Spud Date Date Reached TD Completion Date

6552' Total Depth PBTD

Amount of Surface Pipe Set and Cemented at 6552' feet

Multiple Stage Cementing Collar Used? [] Yes [X] No

If Yes, Show Depth Set feet

If alternate 2 completion, cement circulated from feet depth to w/ SX cml

WATER SUPPLY INFORMATION

Source of Water: Water Well Division of Water Resources Permit # T. 88-548

Groundwater Ft North From Southeast Corner and Ft West From Southeast Corner of Sec Twp Rge [] East [] West

Surface Water Ft North From Southeast Corner and (Stream, Pond etc.) Ft West From Southeast Corner Sec Twp Rge [] East [] West

Other (explain) (purchased from city, R.W.D.#)

Disposition of Produced Water: [] Disposal [] Repressuring

Docket #

CONFIDENTIAL

INSTRUCTIONS: This form shall be completed in duplicate and filed with the Kansas Corporation Commission, 200 Colorado Derby Building, Wichita, Kansas 67202, within 90 days after completion or recompletion of any well.

Information on side two of this form will be held confidential for a period of 12 months if requested in writing and submitted with the form.

One copy of all wireline logs and drillers time log shall be attached with this form. Submit CP-4 form with all plugged wells. Submit CP-111 form with all temporarily abandoned wells.

All requirements of the statutes, rules, and regulations promulgated to regulate the oil and gas industry have been fully complied with and the statements herein are complete and correct to the best of my knowledge.

Signature Eron M. Oyer District Engineer Date

Subscribed and sworn to before me this 13th day of February, 1989

Notary Public Laurie I. Noble State Commission Expires

K.C.C. OFFICE USE ONLY: Letter of Confidentiality Attached, Wireline Log Received, Drillers Timelog Received, Distribution: KCC, KGS, SWD/Rep, Plug, NGPA, Other (Specify)

Form ACO-1 (7-84)

Laurie I. Noble Notary Public - State of Kansas My Appl. Expires 6/27/92

Sec. 1 Twp. 35S Rge. 32W

ORIGINAL SIDE TWO

RELEASED

Operator Name BEREEXO, Inc. Lease Name Kivett A #1 Well# SEC. 1 TWP. 35S RGE. 32W East West

MAR 05 1992

WELL LOG

INSTRUCTIONS: Show important tops and base of formations penetrated from all cores. Report all drill stem tests giving interval tested, time tool open and closed, flowing and shut-in pressures, whether shut-in pressure reached static level, hydrostatic pressures, bottom hole temperature, fluid recovery, and flow rates if gas to surface during test. Attach extra sheet if more space is needed. Attach copy of log.

Drill Stem Tests Taken Yes No
Samples Sent to Geological Survey Yes No
Cores Taken Yes No

Formation Description
 Log Sample

DST #1 - 5040-5061, 30 (60) 60 (120). KC "A". 1st open-weak inc. to strong blow. 2nd open - weak inc. to strong blow. Rec 20' Sl.OCM (5% gas, 10% oil, 85% mud), 280' G&OCM (50% gas, 20% oil, 30% mud), 190' SW. Chl. 28,000 PPM. FP's 64-74, 138-192. IBHP. 1454; FBHP 1454. HP's 2443, 2377. Temp. 121°

Table with 3 columns: Name, Top, Bottom. Rows include B/Heebner, Lansing, KC "A", KC "B", Marmaton, Morrow.

DST #2 - 5153-5171, 30 (60) 60 (120). KC"B". 1st open - weak bldg. to strong blow in 8". 2nd open-weak bldg to strong blow in 13". Rec. 765' SW. Chl 27,000 PPM. FP's 74-170, 245-341. IBHP 1671, FBHP 1671. HP's 2475, 2421. Temp. 122°

Dst #3 - 5350-5373, 30 (60) 60 (120). Marmaton. 1st open weak, dec to very weak blow. 2nd open - very weak blow. Rec. 20' mud, 30' G&OCM (40% gas, 5% oil, 55% mud), 70' G&WCM (35% gas, 45% water, 20% water), 90' Sl.G&WCM (10% gas, 45% mud, 45% water). Chl. 42,000 PPM. FP's 42-42, 96-106. IBHP 1681, FBHP 1741. HP's 2585, 2541.

DST #4 - 6074-6114, 30 (60) 60 (120). Lower Morrow. 1st open - weak inc. to 5" blow, bled off. 2nd open - weak inc. to 12" blow. (surging). Rec. 20' DM w/no show. FP's 32-32, 42-42. IBHP 85, FBHP 1379. HP's 3000, 2984. Temp. 127°

CONFIDENTIAL

Form sections: Purpose of string, PERFORATION RECORD, TUBING RECORD, and production data tables.

Disposition of gas: vented sold used on lease
METHOD OF COMPLETION: open hole perforation other (specify)
PRODUCTION INTERVAL: Dually Completed. Commingled