

15-025-20101-00-61

WELL PLUGGING RECORD

Give All Information Completely  
 Make Required Affidavit

COUNTY Clark SEC. 6 TWP. 31S RGE. 21W E/W  
 Location as in quarters or footage from lines:  
2086' FSL & 2086' FEL

Locate Well  
 correctly on above  
 Section Platt.

Lease Owner Mesa Petroleum Co.  
 Lease Name Daily 3-6 Well No. SWD # 1  
 Office Address Box 2009 Amarillo, Texas 79189  
 Character of Well (Completed as Oil, Gas or Dry Hole): SWD  
 Date Well Completed 4-8-76  
 Application for plugging filed 11-22-83  
 Plugging commenced 1-27-84  
 Plugging completed 1-30-84  
 Reason for abandonment of well or producing formation  
Non-economic to operate.  
 Was permission obtained from the Conservation Division or it's  
 Agent's before plugging was commenced? Yes

Name of Conservation Agent who supervised plugging of this well Paul Luthi  
 Producing formation N/A Depth to top          bottom T.D. 5250

Show depth and thickness of all water, oil and gas formations.

OIL, GAS OR WATER RECORDS Casing Record

Formation	Content	From	To	Size	Put in	Pulled Out
Injection zone	Salt Water	5144'	5146'	8 5/8	604	none
				4 1/2	5250'	3020'

Describe in detail the manner in which the well was plugged, indicating where the mud fluid was placed and the method or methods used in introducing it into the hold. If cement or other plugs were used, state the character of same and depth placed, from 5150 feet to Surface feet for each plug set.

- Pump 25 sks. of cement @ 5150 to 4750
- Pump 50 sks. of cement @ 1200 to 1100
- Pump 50 sks. of cement @ 650 to 500
- Put 10 sks. of cement @ 40 to 0
- Cut off & cap 8 5/8 3' below ground level

(If additional description is necessary, use BACK of this sheet)

Name of Plugging Contractor Sargents Casing Pulling Service Box 506 Liberal, Kansas 67901

STATE OF Texas COUNTY OF Potter, ss.  
R. E. Mathis (employee of owner) ~~or (owner or operator)~~ of the  
 above-described well, being first duly sworn on oath, says: That I have knowledge of the  
 facts, statements, and matters herein contained and the log of the above-described well as  
 filed and that the same are true and correct. So help me God.

(Signature) R. E. Mathis  
P. O. Box 2009/Amarillo, TX 79189  
 (Address)

SUBSCRIBED AND SWORN TO before me this 27 day of February, 19 84

My Commission expires: 4/13/85

Jan Rogers  
 Notary Public

RECEIVED  
 STATE CORPORATION COMMISSION

GABBERT-JONES, INC.  
 WICHITA, KANSAS  
 DRILLERS' WELL LOG

Dailey 3-6  
 2086' FS & EL Sec 6-31S-21W  
 Clark County Kansas

Commenced: 2-23-76

Completed: 3-9-76

OPERATOR: MESA PETROLEUM

From	Depth To	Formation	Remarks
0	180	Surface Clay-Sand	Ran 15 jts of New 20# 8 5/8"
180	1099	Sand-Shale	csg set @ 604' Cemented w/
1099	1600	Shale	230 sks Lite Weight - 4% Gel
1600	2200	Shale-Lime	2% CC+200 sks Regular
2200	2943	Lime-Shale	3% CC PD @ 9-15 P.M. 2-24-76
2943	3105	Shale-Lime	
3105	5070	Lime-Shale	
5070	5150	Lime	
5150	5172	Lime-Shale	Ran 134 jts of 10 1/2" 4 1/2"
5172	5250	Lime	csg set @ 5249' Cemented w/
			225 sks 50/50 Posmix, 10%
			Salt - 12% Colite .5 <sup>D59</sup>
			.20 <sup>D46</sup> PD @ 5:00 a.m.
			3-9-76
	5250-TD		

I, James S. Sutton II, certify this as a correct copy of the Drillers' Log for the well drilled 2086' FS & EL, Sec 6-31S-21W, Clark County Kansas to the best of my knowledge and belief.

*James S. Sutton II*  
 JAMES S. SUTTON II

STATE OF KANSAS )  
 ) SS  
 COUNTY OF SEDGWICK)

Before me, the undersigned, a Notary Public within and for said County and State, on this 11th day of March, 1976, personally appeared James S. Sutton II to me personally known to be the identical person who executed the within and foregoing instrument and acknowledged to me that he executed the same as his free and voluntary act and deed for the uses and purposes therein set forth.

IN WITNESS WHEREOF, I have hereunto set my hand and official seal the day and year last above written.

*Elizabeth J. Edwards*  
 ELIZABETH J. EDWARDS-NOTARY PUBLIC

My Commission Expires: February 6, 1979.

*4-8-76 Copies to K.G.S. & Mineral Office*



RECEIVED

KANSAS DRILLERS LOG

FEB 20 1976

S. 6 T. 31 R. 21 E W

Loc. 2086' FSL & 2086' FEL

County Clark

API No. 15 — 025 — 20,101-0000 AMA. PROD.  
County Number

Operator  
Mesa Petroleum Company

Address  
Box 2009 Amarillo, Texas 79105

Well No. #3-6 Lease Name Daily

Footage Location  
2086 feet from (S) line 2086 feet from (E) line

Principal Contractor Geologist  
Gabbert-Jones, Inc. Dave Ward, Denver Office

Spud Date Total Depth P.B.T.D.  
2/23/76 5250' 5204'

Date Completed Oil Purchaser  
3/24/76 Koch

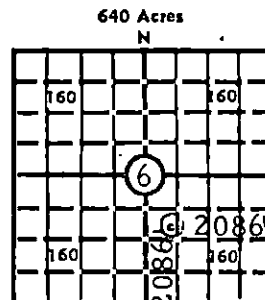

Elev.: Gr. 2161'  
DF 2167' KB

CASING RECORD

Report of all strings set— surface, intermediate, production, etc.

Purpose of string	Size hole drilled	Size casing set (In O.D.)	Weight lbs/ft.	Setting depth	Type cement	Sacks	Type and percent additives
Surface	12-1/4"	8-5/8"	20#	604'	Dowell lite "H"	230 200	4% gel, 2% CaCl 3% CaCl
Production	7-7/8"	4-1/2"	10.5#	5250'	50-50 Poz	225	10% salt, 12-1/2# 0.5% D-59, 0.2% D-46

LINER RECORD

PERFORATION RECORD

Top, ft.	Bottom, ft.	Sacks cement	Shots per ft.	Size & type	Depth Interval
TUBING RECORD			2	3-1/8" csg gun	5172-80'
Size	Setting depth	Packer set at			
2-3/8"	5198'	none			

ACID, FRACTURE, SHOT, CEMENT SQUEEZE RECORD

Amount and kind of material used	Depth Interval treated
1000 gals 15% & 25 balls, 2000 gals gelled KCL Water Pad,	5172-80'
8000 gals retarded 20% Acid, & 2000 gals gelled KCL Water	
Flush	

INITIAL PRODUCTION

Date of first production 4/6/76	Producing method (flowing, pumping, gas lift, etc.) Pumping
RATE OF PRODUCTION PER 24 HOURS	Oil 29 bbls. Gas 30 MCF Water 86 bbls. Gas-oil ratio 1034 CFPB
Disposition of gas (vented, used on lease or sold) Vented	Producing interval (s) 5172-80'

INSTRUCTIONS: As provided in KCC Rule 82-2-125, within 90 days after completion of a well, one completed copy of this Drillers Log shall be transmitted to the State Geological Survey of Kansas, 4150 Monroe Street, Wichita, Kansas 67209. Copies of this form are available from the Conservation Division, State Corporation Commission, 3830 So. Meridian (P.O. Box 17027), Wichita, Kansas 66217. Phone AC 316-522-2206. If confidential custody is desired, please note Rule 82-2-125. Drillers Logs will be on an open file in the Oil and Gas Division, State Geological Survey of Kansas, Lawrence, Kansas 66044. XC: KGS (1), Denver Office (1)

File

Operator MESA PETROLEUM CO. DESIGNATE TYPE OF COMP.: OIL, GAS, DRY HOLE, SWDW, ETC.:

Well No: 3-6 Lease Name Daily OIL

S 6 T 31SR 21 W Clark County, Kansas

WELL LOG SHOW GEOLOGICAL MARKERS, LOGS RUN, OR OTHER DESCRIPTIVE INFORMATION. Show all important zones of porosity and contents thereof; cored intervals, and all drill-stem tests, including depth interval tested, cushion used, time tool open, flowing and shut-in pressures, and recoveries.

FORMATION DESCRIPTION, CONTENTS, ETC.	TOP	BOTTOM	NAME	DEPTH
SEE ATTACHED DRILLER'S LOG.				

USE ADDITIONAL SHEETS, IF NECESSARY, TO COMPLETE WELL RECORD.

Date Received

  
 S. E. Dobler  
 Signature  
 Supervisor, Drilling & Production  
 Title  
 April 8, 1976  
 Date

RECEIVED  
 STATE CORPORATION COMMISSION  
 NOV 28 1983  
 CONSERVATION DIVISION  
 Wichita, Kansas