

15-151-20325-00-00

STATE OF KANSAS  
STATE CORPORATION COMMISSION  
CONSERVATION DIVISION  
P. O. BOX 17027  
WICHITA, KANSAS 67217

FORM CP-4

WELL PLUGGING RECORD

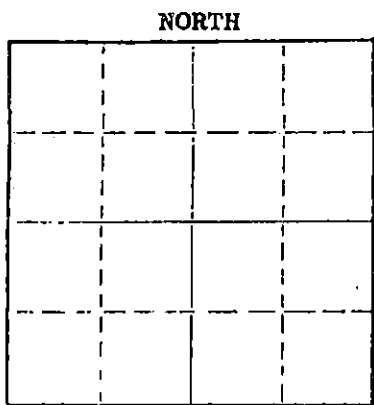

Pratt County, Sec. 23 Twp. 28S Rge. (E) 12W (W)  
Location as "NE/CNW/SE" or footage from lines NW SE  
Lease Owner Raymond Oil Company, Inc.  
Lease Name Hayes Well No. 1  
Office Address 200 West Douglas, Suite 800, Wichita, Ks. 67202  
Character of Well (completed as Oil, Gas or Dry Hole) Dry Hole  
Date well completed March 22 1976  
Application for plugging filed March 21 1976  
Application for plugging approved March 21 1976  
Plugging commenced March 22 1976  
Plugging completed March 22 1976  
Reason for abandonment of well or producing formation Dry Hole  
If a producing well is abandoned, date of last production 19  
Was permission obtained from the Conservation Division or its agents before plugging was commenced? Yes

Name of Conservation Agent who supervised plugging of this well Russell Beaverstein  
Producing formation \_\_\_\_\_ Depth to top \_\_\_\_\_ Bottom \_\_\_\_\_ Total Depth of Well \_\_\_\_\_ Feet  
Show depth and thickness of all water, oil and gas formations.

OIL, GAS OR WATER RECORDS CASING RECORD

FORMATION	CONTENT	FROM	TO	SIZE	PUT IN	FULLED OUT
		0	299 KB	8 5/8	292.35	None

Describe in detail the manner in which the well was plugged, indicating where the mud fluid was placed and the method or methods used in introducing it into the hole. If cement or other plugs were used, state the character of same and depth placed, from \_\_\_\_\_ feet to \_\_\_\_\_ feet for each plug set.  
Plugged: 35 sacks @ 275 ft. Mud up to 40.  
Plug 1/2 sack hulls, bridge, 15 sack to base of cellar, 2 sacks in rathole, 2 sacks in mousehole. Completed 1:30 PM by Allied.

(If additional description is necessary, use BACK of this sheet)  
Name of Plugging Contractor DaMac Drilling Company, Inc.  
Address Box 1164, Great Bend, Kansas 67530

STATE OF Kansas COUNTY OF Barton ss.  
Martha J. McKown (employee of owner) or (owner or operator) of the above-described well, being first duly sworn on oath, says: That I have knowledge of the facts, statements, and matters herein contained and the log of the above-described well as filed and that the same are true and correct. So help me God.

(Signature) Martha J. McKown  
Box 1164, Great Bend, Kansas 67530  
(Address)

SUBSCRIBED AND SWORN TO before me this 1st day of April, 1976.  
My commission expires 11-11-78  
Notary Public.

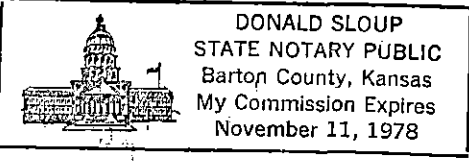

**KANSAS DRILLERS LOG**

S. 23 T. 28S R. 12W <sup>E</sup>/<sub>W</sub>

API No. 15 \_\_\_\_\_  
 County \_\_\_\_\_ Number \_\_\_\_\_

Loc. NW SE

County Pratt

Operator  
Raymond Oil Company, Inc.  
 Address  
200 West Douglas, Suite 800, Wichita, Kans. 67202

Well No. 1 Lease Name Hayes

Footage Location  
 feet from (N) (S) line \_\_\_\_\_ feet from (E) (W) line \_\_\_\_\_

Principal Contractor DaMac Drilling Company, Inc. Geologist \_\_\_\_\_

Spud Date 3-17-76 Total Depth 3200 P.B.T.D. \_\_\_\_\_

Date Completed 3-22-76 Oil Purchaser \_\_\_\_\_

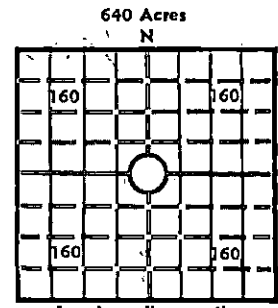

Elev.: Gr. \_\_\_\_\_

DF \_\_\_\_\_ KB \_\_\_\_\_

**CASING RECORD**

Report of all strings set—surface, intermediate, production, etc.

Purpose of string	Size hole drilled	Size casing set (in O.D.)	Weight lbs/ft.	Setting depth	Type cement	Sacks	Type and percent additives
Surface Casing	12 1/4	8 5/8	28	299	2%ge1 3%CC	300	

**LINER RECORD**

**PERFORATION RECORD**

Top, ft.	Bottom, ft.	Sacks cement	Shots per ft.	Size & type	Depth Interval

**TUBING RECORD**

Size	Setting depth	Packer set at

**ACID, FRACTURE, SHOT, CEMENT SQUEEZE RECORD**

Amount and kind of material used	Depth interval treated

APR 05 1976

STATE GEOLOGICAL SURVEY DIVISION  
 Wichita, Kansas

**INITIAL PRODUCTION**

Date of first production _____	Producing method (flowing, pumping, gas lift, etc.) _____				
<b>RATE OF PRODUCTION PER 24 HOURS</b>	Oil _____ bbls.	Gas _____ MCF	Water _____ bbls.	Gas-oil ratio _____ CFPB	
Disposition of gas (vented, used on lease or sold) _____			Producing interval (s) _____		

**INSTRUCTIONS:** As provided in KCC Rule 82-2-125, within 90 days after completion of a well, one completed copy of this Drillers Log shall be transmitted to the State Geological Survey of Kansas, 4150 Monroe Street, Wichita, Kansas 67209. Copies of this form are available from the Conservation Division, State Corporation Commission, 3830 So. Meridian (P.O. Box 17027), Wichita, Kansas 66217. Phone AC 316-522-2206. If confidential custody is desired, please note Rule 82-2-125. Drillers Logs will be on an open file in the Oil and Gas Division, State Geological Survey of Kansas, Lawrence, Kansas 66044.

Operator

Raymond Oil Company

DESIGNATE TYPE OF COMP.: OIL, GAS, DRY HOLE, SWDW, ETC.:

Well No.

1

Lease Name

Hays

Dry Hole

S 23 T 28S R 12W<sup>E</sup><sub>W</sub>

**WELL LOG**

Show all important zones of porosity and contents thereof; cored intervals, and all drill-stem tests, including depth interval tested, cushion used, time tool open, flowing and shut-in pressures, and recoveries.

SHOW GEOLOGICAL MARKERS, LOGS RUN, OR OTHER DESCRIPTIVE INFORMATION.

FORMATION DESCRIPTION, CONTENTS, ETC.	TOP	BOTTOM	NAME	DEPTH
Sand & Clay	0	195		
Sand	195	260		
RedBed	260	300		
RedBed & Shale	300	734		
Shale	734	1095		
Lime & Shale	1095	3200		
		3200RTD		

USE ADDITIONAL SHEETS, IF NECESSARY, TO COMPLETE WELL RECORD.

Date Received

Martha J. McKown  
Signature

Vice President  
Title

Title

4-1-76  
Date

Date