

STATE OF KANSAS  
STATE CORPORATION COMMISSION

Give All Information Completely  
Make Required Affidavits  
Mail or Deliver Report to:  
Conservation Division  
State Corporation Commission  
211 No. Broadway  
Wichita, Kansas

WELL PLUGGING RECORD

NORTH

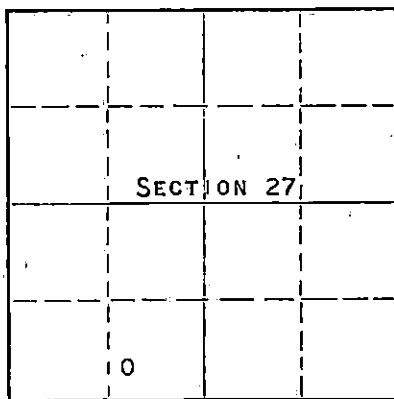

Locate well correctly on above  
Section Plat

KINGMAN County, Sec. 27 Twp. 29 Rge. 8 (NW) W (W)  
Location as "NE/CNW/SW" or footage from lines SW SE SW  
Lease Owner PETROLEUM, INC.  
Lease Name DUCKWORTH "D" Well No. 1  
Office Address ROUTE 2, GREAT BEND, KANSAS  
Character of Well (completed as Oil, Gas or Dry Hole) DRY HOLE  
Date well completed NOVEMBER 5 19 58  
Application for plugging filed NOVEMBER 5 19 58  
Application for plugging approved NOVEMBER 5 19 58  
Plugging commenced NOVEMBER 5 19 58  
Plugging completed NOVEMBER 5 19 58  
Reason for abandonment of well or producing formation  
NO PRODUCIBLE ZONES

If a producing well is abandoned, date of last production NONE 19  
Was permission obtained from the Conservation Division or its agents before plugging was commenced? YES

Name of Conservation Agent who supervised plugging of this well FRED W. HAMPEL  
Producing formation --- Depth to top --- Bottom --- Total Depth of Well 4232 Feet  
Show depth and thickness of all water, oil and gas formations.

OIL, GAS OR WATER RECORDS

CASING RECORD

FORMATION	CONTENT	FROM	TO	SIZE	PUT IN	PULLED OUT
				8-5/8"	270'	NONE

Describe in detail the manner in which the well was plugged, indicating where the mud fluid was placed and the method or methods used in introducing it into the hole. If cement or other plugs were used, state the character of same and depth placed, from --- feet to --- feet for each plug set.

MUD UP WITH HEAVY MUD TO 240' FOLLOWED BY A WOODEN PLUG AND 1/4 SACK HULLS.  
PLACED 20 SACKS CEMENT THROUGH DRILL PIPE ON TOP OF PLUG. MUD UP TO 40'  
FOLLOWED BY A WOODEN PLUG AND 1/4 SACK HULLS. FILLED HOLE TO BASE OF WELL  
CELLAR WITH 10 SACKS CEMENT.

RECEIVED  
STATE CORPORATION COMMISSION

NOV 13 1958

(If additional description is necessary, use BACK of this sheet)

Name of Plugging Contractor GARVEY DRILLING COMPANY  
Address ROUTE 2, GREAT BEND, KANSAS

STATE OF KANSAS, COUNTY OF BARTON, ss.  
DON SEARLE (employee of owner) or (owner) of the above-described well, being first duly sworn on oath, says: That I have knowledge of the facts, statements, and matters herein contained and the log of the above-described well as filed and that the same are true and correct. So help me God.

(Signature) Don Searle  
ROUTE 2, GREAT BEND, KANSAS  
(Address)

SUBSCRIBED AND SWORN TO before me this 12TH day of NOVEMBER, 19 58

My commission expires JULY 11, 1960

[Signature]  
Notary Public.

PLUGGING  
FILE SEC. 27 T. 29 R. 8 W.  
BOOK PAGE 144 LINE 20

# WELL LOG

COMPANY PETROLEUM, INCORPORATED

SEC. 27 T. 29S R. 8W

FARM DUCKWORTH "D" NO. 1

LOC. SW, SE, SW

TOTAL DEPTH 4232'

COUNTY KINGMAN CO., KANSAS

COMM. October 25, 1958 COMP. November 5, 1958

CONTRACTOR GARVEY DRILLING COMPANY

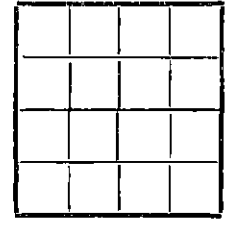

CASING 8 5/8" @ 270' W/175 sax.

ELEVATION 1557' DF

PRODUCTION D & A

FIGURES INDICATE BOTTOM OF FORMATIONS

35	Surface clay & sand
270	Red bed & shale
980	Shale
1385	Shale & lime
1960	Lime
2760	Shale & lime
3039	Shale w/lime & shells
3120	Lime
3225	Lime & shale
3460	Shale, sand & lime
3883	Lime
3956	Lime & shale
4001	Lime
4038	Lime & shale
4164	Shale & lime
4185	Mississippi chert
4232	Chert & lime
4232	T. D.

RECEIVED  
 NOV 13 1958  
 CONSERVATION DIVISION  
 Wichita, Kansas

PLUGGING  
 FILE SEC. 27 T. 29 R. 8W  
 BOOK PAGE 144 LINE 20

State of KANSAS  
 County of BARTON } ss:

I, VERNE A. MORRIS of GARVEY DRILLING COMPANY

upon oath state that the above and foregoing is a true and correct copy of the log of the #1 DUCKWORTH "D" well

*Verne A. Morris*

Subscribed and sworn to before me this 11th day of November 19 58

My Commission Expires: July 11, 1960

*John T. Brown*  
 NOTARY PUBLIC