

STATE CORPORATION COMMISSION OF KANSAS
OIL & GAS CONSERVATION DIVISION
WELL COMPLETION FORM
ACO-1 WELL HISTORY
DESCRIPTION OF WELL AND LEASE

Operator: License # 4549

Name: ANADARKO PETROLEUM CORPORATION

Address P. O. BOX 351

City/State/Zip LIBERAL, KANSAS 67905-0351

Purchaser: TEXACO TRADING & TRANSPORTATION

Operator Contact Person: J. L. ASHTON

Phone (316) 624-6253

Contractor: Name: NORSEMAN DRILLING, INC.

License: 3779

Wellsite Geologist: NA

Designate Type of Completion
 New Well Re-Entry Workover

Oil SWD SIOW Temp. Abd.
 Gas ENHR SIGW
 Dry Other (Core, WSW, Expl., Cathodic, etc)

If Workover:

Operator: _____

Well Name: _____

Comp. Date _____ Old Total Depth _____

Deepening Re-perf. Conv. to Inj/SWD
 Plug Back PBTB
 Commingled Docket No. _____
 Dual Completion Docket No. _____
 Other (SWD or Inj?) Docket No. _____

10/4/94 10/14/94 1/10/95
Spud Date Date Reached TD Completion Date

API NO. 15- _____ 189-21,795 - 0000

County STEVENS

NW - SE - NW - SE Sec. 14 Twp. 31S Rge. 35 X W

1940 Feet from (S)X (circle one) Line of Section

1950 Feet from (E)X (circle one) Line of Section

Footages Calculated from Nearest Outside Section Corner:
NE, (SE), NW or SW (circle one)

Lease Name MOORHEAD "C" Well # 4

Field Name LAHEY

Producing Formation CHESTER

Elevation: Ground 2966.6 KB 2977.6

Total Depth 5820 PBTB 5768

Amount of Surface Pipe Set and Cemented at 1778 Feet

Multiple Stage Cementing Collar Used? Yes No

If yes, show depth set 3098 Feet

If Alternate II completion, cement circulated from _____

feet depth to _____ w/ _____ sx cmt.

Drilling Fluid Management Plan alt I 3-26-96
(Data must be collected from the Reserve Pit)

Chloride content 40,692 ppm Fluid volume 5000 bbls

Dewatering method used NATURAL EVAPORATION

Location of fluid disposal if hauled offsite: _____

RELEASED

Operator Name _____

Lease Name _____ License No. 1006

Quarter _____ Sec. _____ Twp. _____ S Rng. _____ E/W

County _____ Docket No. _____

FROM CONFIDENTIAL

INSTRUCTIONS: An original and two copies of this form shall be filed with the Kansas Corporation Commission, 200 Colorado Derby Building, Wichita, Kansas 67202, within 120 days of the spud date, recompletion, workover or conversion of a well. Rule 82-3-130, 82-3-106 and 82-3-107 apply. Information on side two of this form will be held confidential for a period of 12 months if requested in writing and submitted with the form (see rule 82-3-107 for confidentiality in excess of 12 months). One copy of all wireline logs and geologist well report shall be attached with this form. ALL CEMENTING TICKETS MUST BE ATTACHED. Submit CP-4 form with all plugged wells. Submit CP-111 form with all temporarily abandoned wells.

All requirements of the statutes, rules and regulations promulgated to regulate the oil and gas industry have been fully complied with and the statements herein are complete and correct to the best of my knowledge.

Signature Leslie J. Barnes
LESLIE T. BARNES
Title SR. TECHNICAL ASSISTANT Date 1/25/95

Subscribed and sworn to before me this 25th day of January, 1995.

Notary Public Cheryl Steers

Date Commission Expires _____



K.C.C. OFFICE USE ONLY
F Letter of Confidentiality Attached
C Wireline Log Received
C Geologist Report Received

Distribution
 KCC SWD/Rep NGPA
 KGS Plug Other
(Specify)

Form ACO-1 (7-91) RECEIVED
STATE CORPORATION COMMISSION

FEB 01 1995

CONSERVATION DIVISION
WICHITA, KANSAS

SIDE TWO

CONFIDENTIAL

Operator Name ANADARKO PETROLEUM CORPORATION Lease Name MOORHEAD "C" Well # 4

Sec. 14 Twp. 31S Rge. 35 East West
 County STEVENS

INSTRUCTIONS: Show important tops and base of formations penetrated. Detail all cores. Report all drill stem tests giving interval tested, time tool open and closed, flowing and shut-in pressures, whether shut-in pressure reached static level, hydrostatic pressures, bottom hole temperature, fluid recovery, and flow rates if gas to surface during test. Attach extra sheet if more space is needed. Attach copy of log.

Drill Stem Tests Taken Yes No
 (Attach Additional Sheets.)
 Samples Sent to Geological Survey Yes No
 Cores Taken Yes No
 Electric Log Run Yes No
 (Submit Copy.)
 List All E.Logs Run:

Log Formation (Top), Depth and Datums Sample
 Name Top Datum
 SEE ATTACHMENT

ORIGINAL

CASING RECORD <input checked="" type="checkbox"/> New <input type="checkbox"/> Used							
Report all strings set-conductor, surface, intermediate, production, etc.							
Purpose of String	Size Hole Drilled	Size Casing Set (In O.D.)	Weight Lbs./Ft.	Setting Depth	Type of Cement	# Sacks Used	Type and Percent Additives
SURFACE	12 1/4	8 5/8	24	1778	50/50 POZMIX/ COMMON	625/200	4%GEL, 2%CC/3%CC 6%GEL, 1/4#SX FLOC
PRODUCTION	7 7/8	5 1/2	15.5	5808	65/35 POZ, 50/50-80/200 POZ/CLASS H	50	.75%FRIC RED/10% SALT, 5%/SX GILS, 1/4#SX FLOC/10% SALT, 5%/SX GILS, 1/4#SX FLOC
		FO TOOL @		3098	65/35 POZMIX	95	6%GEL, 1/4#SX FLOC

ADDITIONAL CEMENTING/SQUEEZE RECORD					
Purpose:	Depth Top Bottom	Type of Cement	#Sacks Used	Type and Percent Additives	
<input type="checkbox"/> Perforate <input type="checkbox"/> Protect Casing <input type="checkbox"/> Plug Back TD <input type="checkbox"/> Plug Off Zone					

Shots Per Foot	PERFORATION RECORD - Bridge Plugs Set/Type Specify Footage of Each Interval Perforated	Acid, Fracture, Shot, Cement Squeeze Record (Amount and Kind of Material Used) Depth
2	5604-5624	ACIDIZE W/1500 GALS 7.5% FEHCL &, 50 B.S.(1.3 SG) FRAC W/24,000 GALS 35# BORATE CROSS-LINKED 2% KCL WTR & 129,320# 16/30 SAND 5604-5624

TUBING RECORD Size 2-7/8 Set At 5543 Packer At _____ Liner Run Yes No

Date of First, Resumed Production, SWD or Inj. 12/31/94 Producing Method Flowing Pumping Gas Lift Other (Explain)

Estimated Production Per 24 Hours Oil 137 Bbls. Gas -- Mcf Water 3 Bbls. Gas-Oil Ratio -- Gravity --

Disposition of Gas: NONE METHOD OF COMPLETION
 Vented Sold Used on Lease (If vented, submit ACO-18.) Open Hole Perf. Dually-Comp. Commingled 5604-5624
 Other (Specify) _____

CONFIDENTIAL

ORIGINAL

ATTACHMENT

API # 15-189-21995

MOORHEAD "C" NO. 4
SECTION 14-31S-35W
STEVENS COUNTY, KANSAS

<u>FORMATION</u>	<u>TOP</u>
B. STONE CORRAL	1792
WELLINGTON	2226
CHASE	2570
COUNCIL GROVE	2886
WABAUNSEE	3384
HEEBNER	4023
TORONTO	4074
LANSING	4168
KANSAS CITY	4649
MARMATON	4830
CHEROKEE	5026
ATOKA	5208
MORROW	5362
CHESTER	5538
ST. LOUIS	5674

RELEASED

APR 9 1996

FROM CONFIDENTIAL

RECEIVED
STATE CORPORATION COMMISSION

FEB 01 1995

CONSERVATION DIVISION
WICHITA, KANSAS

CONFIDENTIAL

ORIGINAL

NORSEMAN DRILLING, INC.
WICHITA, KANSAS
DRILLERS' WELL LOG

WELL NAME: MOORHEAD C-4 API# 15-189-21795
SECTION 14-31S-35W
STEVENS COUNTY, KANSAS
COMMENCED: OCTOBER 4, 1994
COMPLETED: OCTOBER 15, 1994
OPERATOR: ANADARKO PETROLEUM CORPORATION

Depth		Formation	Remarks
From	To		
0	1184	Sand & Redbed	Ran 43 jts of 24#
1185	1385	Glorietta Sand	8 5/8" csg set @
1386	2363	Redbed & Shale	1785'; w/625 SX of
2364	5822	Lime & Shale	50/50 Pozmix; 4% Gel; 1/4# SX Flocele; Tailed w/200 SX Common; 3% CC; 1/4# sx Flocele; Plug down at 11:00 a.m. on 10/06/94.

RELEASED
APR 9 1996
FROM CONFIDENTIAL

Ran 138 jts 5 1/2" 15.5#, Set @ 5800'; w/80 SX 65/35
Poz; 6% Gel; 3/4% CFR-3; Tailed w/200 SX Class H; 10%
EA-2; 10% Salt; 3/4% Halad 322; 1/4# SX Flocele;
Plug down at 4:45 a.m., on 10/14/94.

STATE OF KANSAS)I, the undersigned, being duly sworn on
)oath, state that the above Drillers' Well
)Log is true and correct to the best of my
)knowledge and belief and according to the
COUNTY OF SEDGWICK)records of this office.

NORSEMAN DRILLING, INC.

James P. Reilly

JAMES P. REILLY, PRESIDENT

Subscribed & sworn to before me this

October 24, 1994

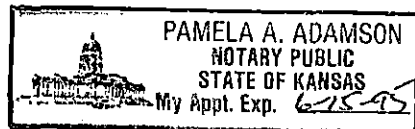

My Appointment Expires:

June 15, 1995

Pamela A. Adamson

Pamela A. Adamson, Notary Public
340 Seville
Wichita, KS 67209

RECEIVED
STATE CORPORATION COMMISSION

FEB 01 1995

CONSERVATION DIVISION
WICHITA, KANSAS



JOB LOG HAL-2013-C

CUSTOMER Anadarko Pet	WELL NO. C-4	LEASE morehead	JOB TYPE 85% Surface	TICKET NO. 635628
--------------------------	-----------------	-------------------	-------------------------	----------------------

CHART NO.	TIME	RATE (BPM)	VOLUME (BBL) (GAL)	PUMPS		PRESSURE (PSI)		DESCRIPTION OF OPERATION AND MATERIALS
				T	C	TUBING	CASING	
	0200							Called out Ready now
	0430							on location
								Safety meeting
								Rig up ORIGINAL
								Run pipe
								Drop Ball
								Circulate with Rig pump
	0946							Hook up cement Iron
	0949		1602					Start head cement
	1012		327					Start tail cement
	1022				✓			Release plug
	1023		60		✓		250/800	Displace plug
	1040							Ran out of water
	1046				✓			Hook up mud line
	1048		51.8				600/800	Start Disp with mud
	1058				✓		1200	Land plug
	1054							Release psl check float OK
								Circulated cement to surface

RELEASED

APR 9 1996

FROM CONFIDENTIAL

RECEIVED
STATE CORPORATION COMMISSION
FEB 01 1995
CONSERVATION DIVISION
WICHITA, KANSAS



JOB SUMMARY

HALLIBURTON DIVISION

OK CITY

HALLIBURTON LOCATION

Liberal ks

BILLED ON TICKET NO.

635628

FIELD Lahey SEC. 14 TWP. 31S RNG. 35W COUNTY STEWART STATE Ks

FORMATION NAME _____ TYPE _____

FORMATION THICKNESS _____ FROM _____ TO _____

INITIAL PROD: OIL _____ BPD. WATER _____ BPD. GAS _____ MCFD

PRESENT PROD: OIL _____ BPD. WATER _____ BPD. GAS _____ MCFD

COMPLETION DATE _____ MUD TYPE _____

PACKER TYPE _____ SET AT _____

BOTTOM HOLE TEMP. _____ PRESSURE _____

MISC DATA _____ TOTAL DEPTH _____

CONFIDENTIAL

	NEW USED	WEIGHT	SIZE	FROM	TO	MAXIMUM PSI ALLOWABLE
CASING	N	24	8 5/8	GL	1784	
LINER						
TUBING						
OPEN HOLE						SHOTS/FT.
PERFORATIONS						
PERFORATIONS						
PERFORATIONS						

ORIGINAL

JOB DATA

CALLED OUT	ON LOCATION	JOB STARTED	JOB COMPLETED
DATE <u>10-6-94</u>	DATE <u>10-6-94</u>	DATE <u>10-6-94</u>	DATE _____
TIME <u>0200</u>	TIME <u>0430</u>	TIME _____	TIME _____

TOOLS AND ACCESSORIES

TYPE AND SIZE	QTY.	MAKE
FLOAT COLLAR <u>Auto Fill</u>	<u>1</u>	<u>Howco</u>
FLOAT SHOE <u>Basent float</u>	<u>1</u>	
GUIDE SHOE <u>Reg</u>	<u>1</u>	
CENTRALIZERS <u>S3</u>	<u>4</u>	
BOTTOM PLUG		
TOP PLUG <u>SW</u>	<u>1</u>	
HEAD <u>PC</u>	<u>1</u>	
PACKER <u>BASKET</u>	<u>1</u>	
OTHER <u>weld A</u>	<u>1</u>	

PERSONNEL AND SERVICE UNITS

NAME	UNIT NO. & TYPE	LOCATION
<u>O Nicholas</u>	<u>40078</u>	<u>Liberal</u>
<u>W Fox</u>	<u>50404</u>	<u>LI</u>
<u>D4437</u>	<u>7131</u>	
<u>C Cornelison</u>	<u>52827</u>	
<u>Boone</u>	<u>5839</u>	<u>Hugoton</u>
<u>62569</u>	<u>4449</u>	
<u>69614</u>	<u>75505</u>	<u>LI</u>

MATERIALS

TREAT. FLUID _____ DENSITY _____ LB/GAL. °API

DISPL. FLUID _____ DENSITY _____ LB/GAL. °API

PROP. TYPE _____ SIZE _____ LB.

ACID TYPE _____ GAL. _____ %

SURFACTANT TYPE _____ GAL. _____ IN

NE AGENT TYPE _____ GAL. _____ IN

FLUID LOSS ADD. TYPE _____ GAL.-LB. _____ IN

GELLING AGENT TYPE _____ GAL.-LB. _____ IN

FRIC. RED. AGENT TYPE _____ GAL.-LB. _____ IN

BREAKER TYPE _____ GAL.-LB. _____ IN

BLOCKING AGENT TYPE _____ GAL.-LB. _____

PERFPAC BALLS TYPE _____ QTY. _____

OTHER _____

OTHER _____

DEPARTMENT Acement

DESCRIPTION OF JOB 8 5/8" Surface

JOB DONE THRU: TUBING CASING ANNULUS TBG./ANN.

CUSTOMER REPRESENTATIVE X [Signature]

HALLIBURTON OPERATOR [Signature] COPIES REQUESTED _____

CEMENT DATA

STAGE	NUMBER OF SACKS	CEMENT	BRAND	BULK SACKED	ADDITIVES	YIELD CU.FT./SK.	MIXED LBS./GAL.
	<u>1225</u>	<u>H 50/50 Koz</u>			<u>4% Gel 2% CC</u>	<u>1.44</u>	<u>13.5</u>
	<u>200</u>	<u>H</u>			<u>3% CC</u>	<u>1.06</u>	<u>16.4</u>

PRESSURES IN PSI

CIRCULATING _____ DISPLACEMENT _____

BREAKDOWN _____ MAXIMUM _____

AVERAGE _____ FRACTURE GRADIENT _____

SHUT-IN: INSTANT _____ 5-MIN _____ 15-MIN _____

HYDRAULIC HORSEPOWER _____

ORDERED _____ AVAILABLE _____ USED _____

AVERAGE RATES IN BPM _____

TREATING _____ DISPL. _____ OVERALL _____

CEMENT LEFT IN PIPE _____

FEET 38.58 REASON Insert float

SUMMARY

VOLUMES

PRESLUSH: BBL.-GAL. _____ TYPE _____

LOAD & BKDN: BBL.-GAL. _____ PAD: BBL.-GAL. _____

TREATMENT: BBL.-GAL. _____ DISPL: BBL.-GAL. 111.8

CEMENT SLURRY: BBL.-GAL. 160.2 - 37.7 RECEIVED _____

TOTAL VOLUME: BBL.-GAL. _____

REMARKS

FEB 07 1995

CONSERVATION DIVISION
MICHIGAN, KANSAS

CUSTOMER: Andarko Petroleum
LEASE: Morehead
WELL NO.: C-4
JOB TYPE: 8 5/8" surface
DATE: 10-6-94



CHARGE TO: Amadanko Petroleum
 ADDRESS: _____
 CITY, STATE, ZIP CODE: Liberal

COPY

TICKET 4

No.

635628 - 4

FORM 1906 R-13

SERVICE LOCATIONS 1. <u>Liberal 25540</u>	WELL/PROJECT NO. <u>C-4</u>	LEASE <u>manhood</u>	COUNTY/PARISH <u>Stevens</u>	STATE <u>KS</u>	CITY/OFFSHORE LOCATION	DATE <u>10-6-94</u>	OWNER <u>Som</u>
2. <u>Hugoton 25535</u>	TICKET TYPE <input checked="" type="checkbox"/> SERVICE	NITROGEN JOB? <input type="checkbox"/> YES	CONTRACTOR <u>Norsman</u>	RIG NAME/NO. <u>3</u>	SHIPPED VIA	DELIVERED TO <u>Location</u>	ORDER NO.
3.	<input type="checkbox"/> SALES	<input checked="" type="checkbox"/> NO	WELL TYPE <u>D1</u>	WELL CATEGORY <u>D1</u>	JOB PURPOSE <u>D/O 8 3/8 surface</u>	WELL PERMIT NO.	WELL LOCATION
4.	REFERRAL LOCATION	INVOICE INSTRUCTIONS					

PAGE 1 OF 1
 RECEIVED
 FEB 01 1995
 CONSERVATION DIVISION

PRICE REFERENCE	SECONDARY REFERENCE / PART NUMBER	ACCOUNTING	DESCRIPTION	QTY.		UNIT PRICE		AMOUNT
				QTY.	U/M	QTY.	U/M	
000-117			MILEAGE	64	mi	2	75	176 00
001-016			Pump charge	1784	ft			1320 00
030-018			Swiper Plug	1	Eq	8 3/8	in	130 00
12 A	825 217		Guide shoe	1	Eq	5 7/8	in	216 00
24 A	815-19502		Insert float	1	Eq	"	"	171 00
27	815-19415		Auto fill	1	Eq	"	"	55 00
40	806-61648		Centralizer	4	Eq	"	"	65 00
320	806 70060		Basket	1	Eq	"	"	122 00
350	890-10802		weld A	1	Lb	"	"	14 50

ORIGINAL

CONFIDENTIAL

LEGAL TERMS: Customer hereby acknowledges and agrees to the terms and conditions on the reverse side hereof which include, but are not limited to: PAYMENT, RELEASE, INDEMNITY, and LIMITED WARRANTY provisions.		SUB SURFACE SAFETY VALVE WAS: <input type="checkbox"/> PULLED & RETURN <input type="checkbox"/> PULLED <input type="checkbox"/> RUN		SURVEY: <input checked="" type="checkbox"/> AGREE <input type="checkbox"/> UN-DECIDED <input type="checkbox"/> DIS-AGREE		PAGE TOTAL		2469 50
CUSTOMER OR CUSTOMER'S AGENT SIGNATURE <u>X</u>		TYPE LOCK DEPTH		OUR EQUIPMENT PERFORMED WITHOUT BREAKDOWN?		FROM CONTINUATION PAGE(S)		9936 50
DATE SIGNED: <u>10-6-94</u> TIME SIGNED: <u>0715</u> <input checked="" type="checkbox"/> A.M. <input type="checkbox"/> P.M.		BEAN SIZE SPACERS		WE UNDERSTOOD AND MET YOUR NEEDS?		SUB-TOTAL APPLICABLE TAXES WILL BE ADDED ON INVOICE		12401 00
TUBING SIZE TUBING PRESSURE WELL DEPTH		TYPE OF EQUALIZING SUB. CASING PRESSURE		OUR SERVICE WAS PERFORMED WITHOUT DELAY?				
TREE CONNECTION TYPE VALVE				WE OPERATED THE EQUIPMENT AND PERFORMED JOB CALCULATIONS SATISFACTORILY?				
<input type="checkbox"/> do <input type="checkbox"/> do not require IPC (Instrument Protection). <input type="checkbox"/> Not offered				ARE YOU SATISFIED WITH OUR SERVICE? <input type="checkbox"/> YES <input type="checkbox"/> NO				
				<input type="checkbox"/> CUSTOMER DID NOT WISH TO RESPOND				

CUSTOMER ACCEPTANCE OF MATERIALS AND SERVICES The customer hereby acknowledges receipt of the materials and services listed on this ticket.

CUSTOMER OR CUSTOMER'S AGENT (PLEASE PRINT)	CUSTOMER OR CUSTOMER'S AGENT (SIGNATURE)	HALLIBURTON OPERATOR/ENGINEER	EMP #	HALLIBURTON APPROVAL
	<u>X</u>	<u>Orville Neuhodus</u>	<u>41525</u>	

DATA

HALLIBURTON

TICKET CONTINUATION

FIELD COPY

TICKET No. 147125

HALLIBURTON ENERGY SERVICES

CUSTOMER Anadarko Petroleum Corp.	WELL Moorehead C-4	DATE 10-06-94	PAGE 1	OF 1
--------------------------------------	-----------------------	------------------	-----------	---------

FORM 1911 R-10

PRICE REFERENCE	SECONDARY REFERENCE/ PART NUMBER	ACCOUNTING			DESCRIPTION	QTY.		UNIT PRICE	AMOUNT
		LOC	ACCT	DF		U/M	U/M		
504-043	516.00272				Premium Cement	200	sk	10.61	2122.00
					625 50/50 Premium Pozmix Cement				
504-043	516.00272				Premium Cement	313	sk	10.61	3320.93
506-105	516.00286				Pozmix A	23098	lb	.074	1708.26
506-121	516.00259				Halliburton Gel 2 1/2	11	sk		N/C
507-277	516.00259				Halliburton Gel Added 2 1/2	11	sk	18.60	204.60
507-210	890.50071				Flocele 1/4W/ 625	156	lb	1.65	257.40
509-406g	890.50812				Calcium Chloride 20W625 3W/ 200	16	sk	36.75	588.00
500-207					SERVICE CHARGE				
						CUBIC FEET	890	1.35	1201.50
500-306					MILEAGE CHARGE				
					TOTAL WEIGHT 74,886	LOADED MILES 15	TON MILES 561.645	95	533.56

ORIGINAL

CONFIDENTIAL

No. B. 262978

CONTINUATION TOTAL 7926.52

JOB LOG HAL-2013-C

CUSTOMER A. U. A. J. A. R. K. O.	WELL NO. C-4	LEASE MOOREHEAD	JOB TYPE 5 1/2 L.S.	TICKET NO. 635657
-------------------------------------	-----------------	--------------------	------------------------	----------------------

CHART NO.	TIME	RATE (BPM)	VOLUME (BBL) (GAL)	PUMPS		PRESSURE (PSI)		DESCRIPTION OF OPERATION AND MATERIALS
				T	C	TUBING	CASING	
	23:00							called out
	01:45							on loc
								ORIGINAL
	10:55	5	20			250		Pump KCL water
	10:59	5	30			250		Pump mud Flush
	11:05	5	20			250		Pump KCL water
	11:09	6	26			250		Pump lead cement
	11:13	6	46			250		Pump Tail cement
	11:22							wash up to P.t
	11:24							Drop Plug
	11:26		30					start displacement
	11:31	6				250		Pump mud
	11:43	2	130					slow Rate down
	11:49		180			500		Plug down
	11:50					800		ck fit o.k
	11:51							Prep DU opening plug
	12:08					1200		open DU tool
	12:10							Turn over to Rig Pump
	13:45	5	20			250		Pump KCL water
	13:49	5	30			250		Pump mud Flush
	13:50	5	20			250		Pump KCL water
	13:54	6	35			250		Mix cement
	14:00							wash up to P.t
	14:02							Release plug
	14:03							start Displacement
	16:20	4	100					slow Rate down
	16:25	2	108			300		Plug down
	16:26					1100		close DU tool
	16:28					1500		Release Pressure o.k

CONFIDENTIAL

RECEIVED
 STATE CORPORATION COMMISSION
 FEB 01 1995
 CONSERVATION DIVISION
 WICHITA, KANSAS

WELL DATA

FIELD _____ SEC. _____ TWP. _____ RNG. _____ COUNTY Stroms STATE Kansas

FORMATION NAME _____ TYPE _____
FORMATION THICKNESS _____ FROM _____ TO _____
INITIAL PROD: OIL _____ BPD. WATER _____ BPD. GAS _____ MCFD
PRESENT PROD: OIL _____ BPD. WATER _____ BPD. GAS _____ MCFD
COMPLETION DATE _____ MUD TYPE _____ MUD WT. _____
PACKER TYPE _____ SET AT _____
BOTTOM HOLE TEMP. _____ PRESSURE _____
MISC. DATA _____ TOTAL DEPTH _____

	NEW USED	WEIGHT	SIZE	FROM	TO	MAXIMUM PSI ALLOWABLE
CASING	N	15.5	5 1/2	0	5823	
LINER						
TUBING						
OPEN HOLE						SHOTS/FT.
PERFORATIONS						
PERFORATIONS						
PERFORATIONS						

ORIGINAL

JOB DATA

CALLED OUT	ON LOCATION	JOB STARTED	JOB COMPLETED
DATE <u>10-14-94</u>	DATE <u>10-15-94</u>	DATE <u>10-15-94</u>	DATE <u>10-15-94</u>
TIME <u>23:00</u>	TIME <u>01:45</u>	TIME	TIME <u>16:35</u>

TOOLS AND ACCESSORIES

TYPE AND SIZE	QTY.	MAKE
FLOAT COLLAR		
FLOAT SHOE		
GUIDE SHOE <u>Reg 5 1/2</u>	<u>1</u>	<u>Halliburton</u>
CENTRALIZERS <u>5-4 5 1/2</u>	<u>20</u>	
BOTTOM PLUG		
TOP PLUG		
HEAD		
PACKER <u>Insert fit</u>	<u>1</u>	
OTHER <u>DU Tool</u>	<u>1</u>	

PERSONNEL AND SERVICE UNITS

NAME	UNIT NO. & TYPE	LOCATION
<u>K. Boone</u>	<u>47841</u>	<u>Liberal</u>
<u>T. Bohannon</u>	<u>87748</u>	<u> </u>
<u>D. McIntyre</u>	<u>D9704</u>	<u>Husoton</u>
<u>P. Boone</u>	<u>69614</u>	<u> </u>

MATERIALS

TREAT. FLUID _____ DENSITY _____ LB/GAL. °API
 DISPL. FLUID _____ DENSITY _____ LB/GAL. °API
 PROP. TYPE _____ SIZE _____ LB.
 PROP. TYPE _____ SIZE _____ LB.
 ACID TYPE _____ GAL. _____ %
 ACID TYPE _____ GAL. _____ %
 ACID TYPE _____ GAL. _____ %
 SURFACTANT TYPE _____ GAL. _____ IN
 NE AGENT TYPE _____ GAL. _____ IN
 FLUID LOSS ADD. TYPE _____ GAL.-LB. _____ IN
 GELLING AGENT TYPE _____ GAL.-LB. _____ IN
 FRIC. RED. AGENT TYPE _____ GAL.-LB. _____ IN
 BREAKER TYPE _____ GAL.-LB. _____ IN
 BLOCKING AGENT TYPE _____ GAL.-LB. _____
 PERFPAC BALLS TYPE _____ QTY. _____
 OTHER _____
 OTHER _____

CONFIDENTIAL

DEPARTMENT Cement
DESCRIPTION OF JOB Cement 5823' of 5 1/2 casing

DU Tool @ 456'
F.O. Tool @

JOB DONE THRU: TUBING CASING ANNULUS TBG./ANN.

CUSTOMER REPRESENTATIVE X Job Shree

HALLIBURTON OPERATOR K. Boone COPIES REQUESTED _____

CEMENT DATA

STAGE	NUMBER OF SACKS	CEMENT	BRAND	BULK SACKED	ADDITIVES	YIELD CU.FT./SK.	MIXED LBS./GAL.
<u>1</u>	<u>80</u>	<u>LS/35</u>	<u>P</u>	<u>B</u>	<u>LS, Gel, 1/4 # Floate, 1256 CFR-3</u>	<u>1.84</u>	<u>12.7</u>
	<u>200</u>	<u>50/50 P02</u>	<u>P</u>	<u>B</u>	<u>10% Salt, 5# G.I., 1/4 # Floate</u>	<u>1.3</u>	<u>14.3</u>
<u>2</u>	<u>150</u>	<u>50/50 P02</u>	<u>P</u>	<u>B</u>	<u>10% Salt, 5# G.I., 1/4 # Floate</u>	<u>1.3</u>	<u>14.3</u>

PRESSURES IN PSI

SUMMARY

VOLUMES

CIRCULATING _____ DISPLACEMENT _____ PRESFLUSH: BBL.-GAL. 20/30/20 TYPE KCL / mud flush
 BREAKDOWN _____ MAXIMUM _____ LOAD & BKDN: BBL.-GAL. _____ PAD: BBL.-GAL. _____
 AVERAGE _____ FRACTURE GRADIENT _____ TREATMENT: BBL.-GAL. _____ DISPL: BBL.-GAL. 137.5
 SHUT-IN: INSTANT _____ 5-MIN _____ 15-MIN _____ CEMENT SLURRY: BBL.-GAL. 26.46 -35
 HYDRAULIC HORSEPOWER _____ TOTAL VOLUME: BBL.-GAL. _____

ORDERED _____ AVAILABLE _____ USED _____
AVERAGE RATES IN BPM

TREATING _____ DISPL. _____ OVERALL _____
CEMENT LEFT IN PIPE

FEET 94 REASON shoe joint

REMARKS

CUSTOMER Anadarko
LEASE Marblehead
WELL NO. C-4
JOB TYPE 5 1/2 L-5
DATE 10-15-94



HALLIBURTON

HALLIBURTON ENERGY SERVICES

CHARGE TO: Anadarko
 ADDRESS:
 CITY, STATE, ZIP CODE:

COPY

TICKET WP
 No. 635657 - 0

PAGE 1 OF 2

FORM 1906 R-13

SERVICE LOCATIONS <u>12. bepal 025540</u> <u>2thugator 025535</u>	WELL/PROJECT NO. <u>C.4</u>	LEASE <u>Moorehead</u>	COUNTY/PARISH <u>Stephens</u>	STATE <u>KS</u>	CITY/OFFSHORE LOCATION	DATE <u>10-15-94</u>	OWNER <u>Anadarko</u>
TICKET TYPE <input checked="" type="checkbox"/> SERVICE <input type="checkbox"/> SALES	NITROGEN JOB? <input type="checkbox"/> YES <input checked="" type="checkbox"/> NO	CONTRACTOR <u>Nopsman</u>	RIG NAME/NO. <u>3</u>	SHIPPED VIA <u>Co Trk</u>	DELIVERED TO <u>Loc.</u>	ORDER NO.	
3.	WELL TYPE <u>02</u>	WELL CATEGORY <u>01</u>	JOB PURPOSE <u>035</u>	WELL PERMIT NO.	WELL LOCATION		
4.	REFERRAL LOCATION	INVOICE INSTRUCTIONS					

PRICE REFERENCE	SECONDARY REFERENCE/ PART NUMBER	ACCOUNTING			DESCRIPTION	QTY.		U/M		UNIT PRICE	AMOUNT
		LOC	ACCT	DF							
000-117		1			MILEAGE	68	mi	1		2.75	187.00
007-013	001-016	1			Pump charge 1 st stage	5823	ft	1			2000.00
007-161		1			Pump charge 2 nd stage	1	EA	1			1400.00
314-163		1			CLAY FIT II	8	Gal	1		24.00	192.00
018-315		1			mud Flush	2500	Gal	1		.65	1638.00
12A	825.205	1			Guide shoe	1	EA	5/2			121.00
24A	815.19251	1			Insert fit. valve	1	EA	5/2			110.00
27	815.19311	1			Auto Fillup Assy.	1	EA	5/2			55.00
40	804.60022	1			Centralizers	20	EA	5/2		44.00	880.00
71	813.50300	1			P.V. Tool	1	EA	5/2			2450.00
75	813.16510	1			Plug set	1	EA	5/2			460.00
320	808.12050	1			Basket	1	EA	5/2			110.00

ORIGINAL

CONFIDENTIAL

LEGAL TERMS: Customer hereby acknowledges and agrees to the terms and conditions on the reverse side hereof which include, but are not limited to, **PAYMENT, RELEASE, INDEMNITY, and LIMITED WARRANTY** provisions.

CUSTOMER OR CUSTOMER'S AGENT SIGNATURE: X.P. D...

DATE SIGNED: 10/15/94 TIME SIGNED: 5:00 A.M. P.M.

do do not require IPC (Instrument Protection). Not offered

SUB SURFACE SAFETY VALVE WAS: <input type="checkbox"/> PULLED & RETURN <input type="checkbox"/> PULLED <input type="checkbox"/> RUN		SURVEY		AGREE	UN-DECIDED	DIS-AGREE	PAGE TOTAL <u>9603.00</u>
TYPE LOCK	DEPTH	OUR EQUIPMENT PERFORMED WITHOUT BREAKDOWN?	<input checked="" type="checkbox"/>				
BEAN SIZE	SPACERS	WE UNDERSTOOD AND MET YOUR NEEDS?	<input checked="" type="checkbox"/>				FROM CONTINUATION PAGE(S) <u>7109.24</u>
TYPE OF EQUALIZING SUB.	CASING PRESSURE	OUR SERVICE WAS PERFORMED WITHOUT DELAY?	<input checked="" type="checkbox"/>				
TUBING SIZE	TUBING PRESSURE	WE OPERATED THE EQUIPMENT AND PERFORMED JOB CALCULATIONS SATISFACTORILY?	<input checked="" type="checkbox"/>				
WELL DEPTH		ARE YOU SATISFIED WITH OUR SERVICE?	<input type="checkbox"/> YES <input type="checkbox"/> NO				SUB-TOTAL APPLICABLE TAXES WILL BE ADDED ON INVOICE <u>16712.24</u>
TREE CONNECTION	TYPE VALVE	<input type="checkbox"/> CUSTOMER DID NOT WISH TO RESPOND					

CUSTOMER ACCEPTANCE OF MATERIALS AND SERVICES The customer hereby acknowledges receipt of the materials and services listed on this ticket.

CUSTOMER OR CUSTOMER'S AGENT (PLEASE PRINT) <u>X.P. D...</u>	CUSTOMER OR CUSTOMER'S AGENT (SIGNATURE) <u>X.P. D...</u>	HALLIBURTON OPERATOR/ENGINEER <u>Keith Boone</u>	EMP # <u>47891</u>	HALLIBURTON APPROVAL
---	--	---	-----------------------	----------------------

state statute to the extent

HALLIBURTON

TICKET CONTINUATION

CUSTOMER COPY

TICKET No. 635657

is made in HALLIBURTON ENERGY SERVICES

FORM 1911 R-10

CUSTOMER Anadarko Petroleum Corp. WELL Moorehead C-4 DATE 10-14-94 PAGE 2 OF 2

PRICE REFERENCE	SECONDARY REFERENCE/ PART NUMBER	ACCOUNTING			DESCRIPTION	WELL		DATE	PAGE	
		LOC	ACCT	DF		QTY.	U/M		QTY.	U/M
504-118					Premium Lite Cement	80	sk		9.61	768.80
504-043	516.00272					52	sk			
506-105	516.00286					2072	lb			
506-121	516.00259					4	sk			
504-131					50/50 Premium Pozmix Cement	350	sk		8.32	2912.00
504-043	516.00272					175	sk			
506-105	516.00286					12950	lb			
506-121	516.00259					6	sk			
507-210	890.50071				Flocele 4#W/ 350 & 80	108	lb		1.65	178.20
508-291	516.00337				Gilsonite 12.5#W/ 350	1750	lb		.42	735.00
507-153	516.00161				KCFR-3 .75#W/ 80	52	lb		4.85	252.20
509-968	5516.00315				Granulated Salt 10#W/ 350	1749	lb		.15	262.35
007203		1			Other items	4	HR		225.00	940.00
500-207					SERVICE CHARGE					
						CUBIC FEET	497		1.35	670.95
500-306					MILEAGE CHARGE	TOTAL WEIGHT	41025	LOADED MILES	20	
						TON MILES	410.25		.95	389.74

ORIGINAL

CONFIDENTIAL

No. B 263015

CONTINUATION TOTAL 6109.24



JOB LOG FORM 2013 R-4

CUSTOMER: *Armadillo* WELL NO.: *C-4* LEASE: *Moorehead* JOB TYPE: *Re cement F.O. Tool* TICKET NO.: *635617*

CHART NO.	TIME	RATE (BPM)	VOLUME (BBL) (GAL)	PUMPS		PRESSURE (PSI)		DESCRIPTION OF OPERATION AND MATERIALS
				T	C	TUBING	CASING	
	0700							Called out
	1000							on location
	1038	1	5			1000		Pressure Test F.O. Tool
	1045							Shut Down
	1053							Try to Open F.O. Tool Failed
	1054	1	7			400		Pressure up on Tool
	1101	1	7			400		Pump while opening Tool
	1110	2	13					Pump water @ Head
	1112							m. & cement 13.1
	1115	2	28.5			11		Pump cement
	1130	1.5	11.5			0-300		Pump Displacement
	1138							Shut Down ^{Shut Tool} & Knock Iron Case
	1143							Run 2 Joints
	1149							Hook Iron to casing
	1155	1	20			0-750-100		Reverse out
	1210							Shut Down - Job End.
								Did NOT circulate cement to pit

CONFIDENTIAL



HALLIBURTON JOB SUMMARY

HALLIBURTON DIVISION
HALLIBURTON LOCATION

Well Location: Stevens

BILLED ON TICKET NO. 135617

WELL DATA

FIELD _____ SEC _____ TWP _____ RNG _____ COUNTY Stevens STATE KS

FORMATION NAME _____ TYPE _____

FORMATION THICKNESS _____ FROM _____ TO _____

INITIAL PROD: OIL _____ BPD. WATER _____ BPD. GAS _____ MCFD _____

PRESENT PROD: OIL _____ BPD. WATER _____ BPD. GAS _____ MCFD _____

COMPLETION DATE _____ MUD TYPE _____ MUD WT. _____

PACKER TYPE _____ SET AT _____

BOTTOM HOLE TEMP. _____ PRESSURE _____

MISC. DATA _____ TOTAL DEPTH _____

	NEW USED	WEIGHT	SIZE	FROM	TO	MAXIMUM PSI ALLOWABLE
CASING						
LINER						
TUBING						
OPEN HOLE						SHOTS/FT.
PERFORATIONS						
PERFORATIONS						
PERFORATIONS						

JOB DATA

CALLED OUT	ON LOCATION	JOB STARTED	JOB COMPLETED
DATE <u>11-18-94</u>	DATE <u>11-18-94</u>	DATE <u>11-18-94</u>	DATE <u>11-18-94</u>
TIME <u>0700</u>	TIME <u>1000</u>	TIME <u>1030</u>	TIME <u>1220</u>

PERSONNEL AND SERVICE UNITS

NAME	UNIT NO. & TYPE	LOCATION
<u>R. Coit</u>	<u>38242</u>	<u>Liberal</u>
<u>D. 7653</u>	<u>PU</u>	
<u>G. Martin</u>	<u>75496</u>	
<u>G. 7731</u>	<u>RCM</u>	
<u>T. Adams</u>	<u>7649</u>	<u>Hugoton</u>
<u>D. 9382</u>	<u>BULK</u>	

ORIGINAL

CONFIDENTIAL

DEPARTMENT _____

DESCRIPTION OF JOB _____

JOB DONE THRU: TUBING CASING ANNULUS TBG/ANN:

CUSTOMER REPRESENTATIVE X. Donald Williams

HALLIBURTON OPERATOR Ronald Coit COPIES REQUESTED 2

CEMENT DATA

STAGE	NUMBER OF SACKS	CEMENT	BRAND	BULK SACKED	ADDITIVES	YIELD CU.FT/SK	MIXED LBS./GAL
<u>1-9-94</u>	<u>6735</u>	<u>Poz</u>	<u>B</u>	<u>6%</u>	<u>Total gel 1/2 Flocc</u>	<u>1.69</u>	<u>13.1</u>

PRESSURES IN PSI

SUMMARY

VOLUMES

CIRCULATING _____ DISPLACEMENT _____

BREAKDOWN _____ MAXIMUM _____

AVERAGE _____ FRACTURE GRADIENT _____

SHUT-IN: INSTANT _____ 5-MIN _____ 15-MIN _____

HYDRAULIC HORSEPOWER _____

ORDERED _____ AVAILABLE _____ USED _____

AVERAGE RATES IN BPM _____

TREATING _____ DISPL _____ OVERALL _____

CEMENT LEFT IN PIPE _____

FEET _____ REASON _____

PRESLUSH: BBL-GAL _____ TYPE _____

LOAD & BKDN: BBL-GAL _____ PAD: BBL-GAL _____

TREATMENT: BBL-GAL _____ DISPL: BBL-GAL _____

CEMENT SLURRY: BBL-GAL _____

TOTAL VOLUME: BBL-GAL _____

REMARKS _____

FIELD OFFICE

M 2025-R4

OWNER: ANADARKO
LEASE: PeT Moore Head
WELL NO: C-4
JOB TYPE: Recement
DATE: 11-18-94



HALLIBURTON

HALLIBURTON ENERGY SERVICES

FORM 1906 R-13

ADDRESS: Anadarko Petroleum
 CITY, STATE, ZIP CODE: _____

COPY No. 635617-^{USA}4

PAGE 1 OF 2

1. Liberal	WELL/PROJECT NO. C-4	LEASE MooreHead	COUNTY/PARISH Stevens	STATE KS	CITY/OFFSHORE LOCATION	DATE 11-18-94	OWNER Anadarko
2. Hugoten	TICKET TYPE <input checked="" type="checkbox"/> SERVICE	NITROGEN JOB? <input type="checkbox"/> YES <input checked="" type="checkbox"/> NO	CONTRACTOR Bruce Well	RIG NAME/NO.	SHIPPED VIA	DELIVERED TO Local w/ safety	ORDER NO.
3.	WELL TYPE 02	WELL CATEGORY 02	JOB PURPOSE 205	WELL PERMIT NO.	WELL LOCATION		
4.	REFERRAL LOCATION	INVOICE INSTRUCTIONS					

PRICE REFERENCE	SECONDARY REFERENCE PART NUMBER	ACCOUNTING			DESCRIPTION	QTY.		U/M		UNIT PRICE	AMOUNT	
		LOC	ACCT	DF								
000-117		1			MILEAGE	50		mi		2.75	137	50
009-019		1			Pump Charge	3100		ft			1590	00

ORIGINAL

CONFIDENTIAL

LEGAL TERMS: Customer hereby acknowledges and agrees to the terms and conditions on the reverse side hereof which include, but are not limited to; **PAYMENT, RELEASE, INDEMNITY, and LIMITED WARRANTY** provisions.

CUSTOMER OR CUSTOMER'S AGENT SIGNATURE: X *[Signature]*

DATE SIGNED: 11-18-94 TIME SIGNED: 1220 A.M. P.M.

do do not require IPC (Instrument Protection). Not offered

SUB SURFACE SAFETY VALVE WAS: PULLED & RETURN PULLED RUN

TYPE LOCK	DEPTH	SURVEY <input type="checkbox"/> AGREE <input type="checkbox"/> UN-DECIDED <input type="checkbox"/> DIS-AGREE OUR EQUIPMENT PERFORMED WITHOUT BREAKDOWN? WE UNDERSTOOD AND MET YOUR NEEDS? OUR SERVICE WAS PERFORMED WITHOUT DELAY? WE OPERATED THE EQUIPMENT AND PERFORMED JOB CALCULATIONS SATISFACTORILY? ARE YOU SATISFIED WITH OUR SERVICE? <input type="checkbox"/> YES <input type="checkbox"/> NO <input type="checkbox"/> CUSTOMER DID NOT WISH TO RESPOND	PAGE TOTAL <u>1727</u> FROM CONTINUATION PAGE(S) <u>3</u> SUB-TOTAL APPLICABLE TAXES WILL BE ADDED ON INVOICE <u>2914</u>
BEAN SIZE	SPACERS		
TYPE OF EQUALIZING SUB.	CASING PRESSURE		
TUBING SIZE	TUBING PRESSURE		
TREE CONNECTION	TYPE VALVE		

CUSTOMER ACCEPTANCE OF MATERIALS AND SERVICES The customer hereby acknowledges receipt of the materials and services listed on this ticket.

CUSTOMER OR CUSTOMER'S AGENT (PLEASE PRINT): David Colmore

CUSTOMER OR CUSTOMER'S AGENT SIGNATURE: X *[Signature]*

HALLIBURTON OPERATOR/ENGINEER: Ronald Crist EMP # 07653

HALLIBURTON APPROVAL: _____

CO-7

PLAT AND CERTIFICATION OF ACREAGE ATTRIBUTABLE TO AN OIL WELL

State Corporation Commission, Conservation Division
200 Colorado Derby Bldg. Wichita, Kansas 67202

OPERATOR Anadarko Petroleum Corporation
LEASE NAME Moorhead "C"
WELL NUMBER 4
FIELD Lahey
NUMBER OF ACRES ATTRIBUTED TO WELL 80

LOCATION OF WELL:
1980 feet north of SE corner
1980 feet west of SE corner
14 Sec. 31S T. 35W R.
COUNTY Stevens

N/2 SE/4 SEC. 14-31S-35W, Stevens Co., Kansas

PLAT

(Show location of well and shade attributable acreage)
(Show footage to nearest lease or unit boundary line)

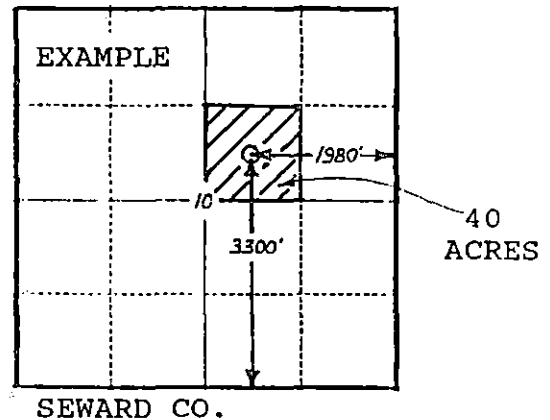
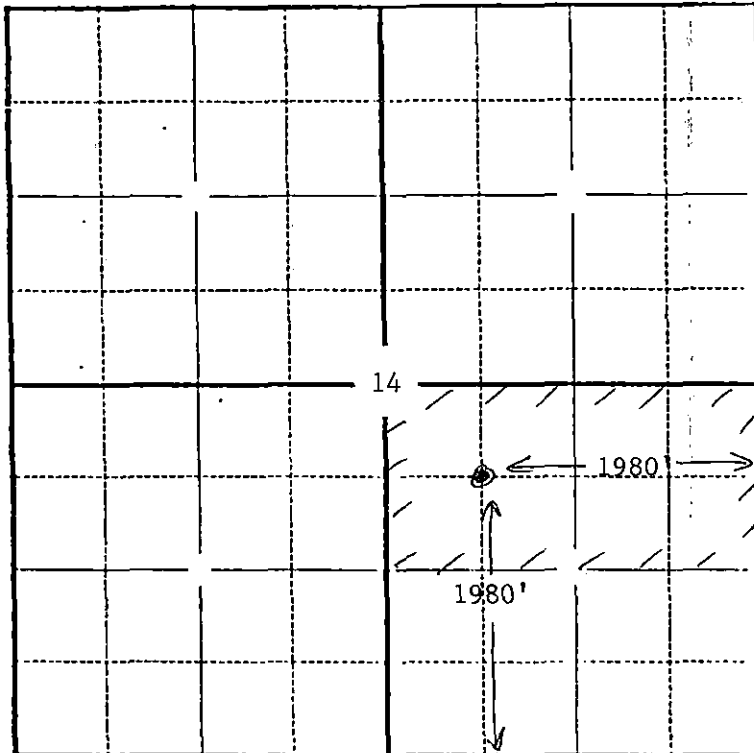

RECEIVED
STATE CORPORATION COMMISSION

SEP 06 1994

The undersigned hereby certifies that he is Division Production Engineering for Anadarko Petroleum Corporation (Co.), a duly authorized agent, that all information shown hereon is true and correct to the best of his knowledge and belief, and that all acreage claimed as attributable to the well named herein is held by production from that well.

Subscribed and sworn to before me on this 2nd day of September 19 94

David W. Kopp

Cheryl Steers

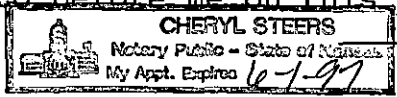

My Commission expires

Notary Public