

STATE OF KANSAS
STATE CORPORATION COMMISSION

Form CP-4

Give All Information Completely
Make Required Affidavit
Mail or Deliver Report to:
Conservation Division
State Corporation Commission
211 No. Broadway
Wichita, Kansas

WELL PLUGGING RECORD

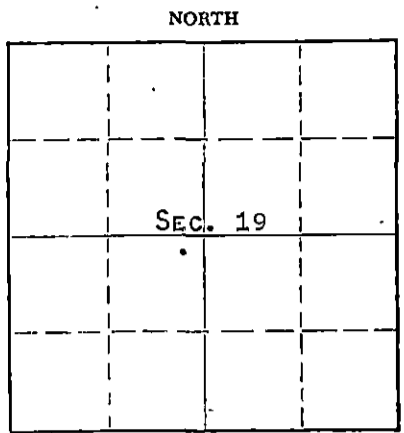

KINGMAN County. Sec. 19 Twp. 30 Rge. 6W (X) (W)
Location as "NE/CNWxSWx" or footage from lines NE NE SW
Lease Owner PETROLEUM, INC.,
Lease Name STEVENS AND REIDA W.W.D.S. Well No. 1
Office Address ROUTE 2, GREAT BEND, KANSAS
Character of Well (completed as Oil, Gas or Dry Hole) OIL
Date well completed MARCH 22 19 57
Application for plugging filed MAY 27 19 65
Application for plugging approved MAY 28 19 65
Plugging commenced MAY 28 19 65
Plugging completed JUNE 10 19 65
Reason for abandonment of well or producing formation: DEPLETION OF PRODUCING ZONE
If a producing well is abandoned, date of last production MAY 21 19 65
Was permission obtained from the Conservation Division or its agents before plugging was commenced? YES

Locate well correctly on above Section Plat

Name of Conservation Agent who supervised plugging of this well A. ELVING, BOX 248, PRATT, KANSAS
Producing formation MISSISSIPPI Depth to top 4151 Bottom Total Depth of Well 4730 Feet
Show depth and thickness of all water, oil and gas formations.

OIL, GAS OR WATER RECORDS

CASING RECORD

FORMATION	CONTENT	FROM	TO	SIZE	PUT IN	PULLED OUT
MISSISSIPPI	SMALL AMOUNTS	4170	4178	8-5/8"	250'	NONE
	OF OIL, GAS &			5-1/2"	4315'	2294'
	WATER					
KANSAS CITY	DISPOSING	3748	3754			
	WATER	3786	3796			

Describe in detail the manner in which the well was plugged, indicating where the mud fluid was placed and the method or methods used in introducing it into the hole. If cement or other plugs were used, state the character of same and depth placed, from feet to feet for each plug set.

SET PLUG AT 3775'. FILLED HOLE FROM 3775 TO 3725' WITH SAND. PLACED 5 SACKS CEMENT FROM 3725 TO 3685'. MUDDED UP WITH HEAVY MUD FROM 3685' TO 250'. PLACED SOLID ROCK BRIDGE AT 250', FOLLOWED BY 25 SACKS CEMENT TO 165'. MUDDED UP WITH HEAVY MUD FROM 165' TO 40'. PLACED SOLID ROCK BRIDGE FROM 40' TO 30' FOLLOWED BY 10 SACKS CEMENT TO BASE OF WELL CELLAR.

RECEIVED
STATE CORPORATION COMMISSION

7-9-65 JUL 9 1965

CONSERVATION DIVISION
Wichita, Kansas

(If additional description is necessary, use BACK of this sheet)

Name of Plugging Contractor SANTA FE PIPE AND SUPPLY, INC.,
Address P. O. Box 562, GREAT BEND, KANSAS

STATE OF KANSAS, COUNTY OF BARTON, ss.
MONTE CHADD (employee of owner) or (owner or operator) of the above-described well, being first duly sworn on oath, says: That I have knowledge of the facts, statements, and matters herein contained and the log of the above-described well as filed and that the same are true and correct. So help me God. MONTE CHADD, DIST. PROD. SUPT.

(Signature) *Monte Chadd*
ROUTE #2, GREAT BEND, KANSAS
(Address)

SUBSCRIBED AND SWORN to before me this 7TH day of JULY, 19 65

My commission expires APRIL 14, 1967

Arthur J. Wales
Notary Public.

15-095-00586-0000
3

WELL LOG

COMPANY PETROLEUM, INCORPORATED

SEC. 19 T. 30SR. 6W

FARM STEVENS

NO. 1

LOC. NE, NE, SW

TOTAL DEPTH 4730'

COUNTY Kingman Co., Kansas

COMM. February 27, 1957 COMP. March 16, 1957

CONTRACTOR GARVEY DRILLING COMPANY

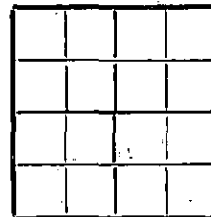

CASING 8 5/8" @ 250' W/175 sax.
5 1/2" @ 4315' W/125 sax.

ELEVATION 1471' DF

PRODUCTION Mississippian

FIGURES INDICATE BOTTOM OF FORMATIONS

40	Surface clay	Anhydrite	1035
252	Red bed & shale	Heebner	3083
1030	Shale & gyp	Douglas	3173
1048	Anhydrite	Lansing	3315
1086	Shale & anhydrite	Kansas City	3594
1300	Gyp & shale		
1405	Shale & lime		
1965	Lime		
2910	Lime & shale		
2975	Lime		
3214	Shale & sand		
3316	Shale & sandy lime		
3342	Sand & shale		
3493	Lime		
3600	Lime & shale		
3820	Lime		
3888	Lime & pyrite		
4064	Lime		
4136	Lime & shale		
4169	Lime & chert		
4229	Chert		
4395	Lime & chert		
4423	Lime		
4457	Lime & shale		
4514	Lime		
4559	Shale		
4620	Shale & sand		
4675	Shale		
4730	Lime		
4730	T. D.		

RECEIVED
STATE CORPORATION COMMISSION

JUL 9 1965

CONSERVATION DIVISION
Wichita, Kansas

State of KANSAS }
County of BARTON } ss:

I, Verne A. Morris of Garvey Drilling Co.

upon oath state that the above and foregoing is a true and correct copy of the log of the #1 Stevens well

Verne A. Morris

Subscribed and sworn to before me this 5th day of April 19 57

My Commission Expires: July 11, 1960

L. J. Brown
NOTARY PUBLIC