

STATE CORPORATION COMMISSION OF KANSAS
OIL & GAS CONSERVATION DIVISION
WELL COMPLETION OR RECOMPLETION FORM
ACO-1 WELL HISTORY
DESCRIPTION OF WELL AND LEASE

5

API NO. 15-095-21,590-0000
County Kingman
W/2 E/2 NW NW Sec. 24 Twp 29S Rge 8W East
X West

Operator: License # 5123
Name Pickrell Drilling Company, Inc.
Address 110 N. Market, Suite 205
City/State/Zip Wichita, KS 67202

4620 Ft North from Southeast Corner of Section
4490 Ft West from Southeast Corner of Section
(Note: Locate well in section plat below)

Purchaser Wichita Industrial Energy Corp.

Lease Name Young "JJ" Unit Well # 2

Field Name Spivey Grabs-Basil Belmont Center

Operator Contact Person Jay McNeil
Phone 262-8427

Producing Formation Toronto

Elevation: Ground 1597 KB 1602

Contractor: License # 5123
Name Pickrell Drilling Company, Inc.

Wellsite Geologist Billy Klaver
Phone 721-4051

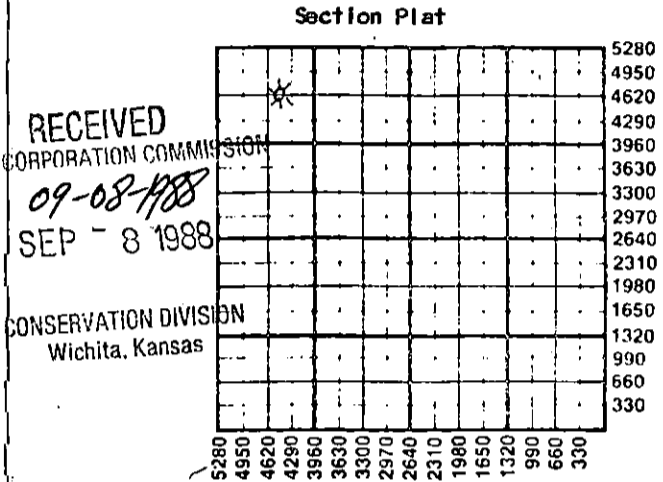

Designate Type of Completion
X New Well Re-Entry Workover

Oil SWD Temp Abd
X Gas Inj Delayed Comp.
Dry Other (Core, Water Supply etc.)

If OWWO: old well info as follows:
Operator
Well Name
Comp. Date Old Total Depth

WELL HISTORY

Drilling Method: X Mud Rotary Air Rotary Cable
5-31-88 6-9-88 8-24-88
Spud Date Date Reached TD Completion Date
4197 3503'
Total Depth PBTD

Amount of Surface Pipe Set and Cemented at 224 feet
Multiple Stage Cementing Collar Used? Yes X No
If yes, show depth set feet
If alternate 2 completion, cement circulated from 3533 feet depth to 2645 w/ 150 SX cmt
Cement Company Name Allied Cementing Co.
Invoice #

WATER SUPPLY INFORMATION
Disposition of Produced Water: Disposal
Docket # Repressuring

Questions on this portion of the ACO-1 call:
Water Resources Board (913) 296-3717
Source of Water:
Division of Water Resources Permit # N/A
Groundwater Ft North from Southeast Corner (Well) Ft West from Southeast Corner of Sec Twp Rge East West
X Surface Water Ft North from Southeast Corner (Stream, pond etc.) Ft West from Southeast Corner Sec 24 Twp 29S Rge 8 East X West
Other (explain) (purchased from city, R.W.D. #)

INSTRUCTIONS: This form shall be completed in triplicate and filed with the Kansas Corporation Commission, 200 Colorado Derby Building, Wichita, Kansas 67202, within 120 days of the spud date of any well. Rule 82-3-130, 82-3-107 and 82-3-106 apply. Information on side two of this form will be held confidential for a period of 12 months if requested in writing and submitted with the form. See rule 82-3-107 for confidentiality in excess of 12 months. One copy of all wireline logs and drillers time log shall be attached with this form. Submit CP-4 form with all plugged wells. Submit CP-111 form with all temporarily abandoned wells.

All requirements of the statutes, rules and regulations promulgated to regulate the oil and gas industry have been fully complied with and the statements herein are complete and correct to the best of my knowledge.

Signature C.W. Sebitts, President
Title Date 8-31-88

Subscribed and sworn to before me this 31st day of August 1988
Notary Public Katherine J. Rule

Date Commission Expires June 29, 1992

K.C.C. OFFICE USE ONLY
F Letter of Confidentiality Attached
C Wireline Log Received
C Drillers Timelog Received
Distribution
KCC SWD/Rep NGPA
KGS Plug Other
(Specify)
9-8-88



Operator Name Pickrell Drilling Company, Inc. Lease Name Young 'JJ' Unit Well # 2

Sec. 24 Twp. 29S Rge. 8 East West County Kingman

WELL LOG

INSTRUCTIONS: Show important tops and base of formations penetrated. Detail all cores. Report all drill stem tests giving interval tested, time tool open and closed, flowing and shut-in pressures, whether shut-in pressure reached static level, hydrostatic pressures, bottom hole temperature, fluid recovery, and flow rates if gas to surface during test. Attach extra sheet if more space is needed. Attach copy of log.

Drill Stem Tests Taken Yes No
 Samples Sent to Geological Survey Yes No
 Cores Taken Yes No

Formation Description
 Log Sample

DST #1 3138-3198, 30"-45"-60"-90", GTS 1", GA 907MCF/10", 1120MCF/20", 1162MCF/30", 2nd op GA 1331MCF/10"-stab. thru 60", rec. 150' mud (no wtr), IFP 222#-254#, FFP 307#-307#, ISIP 1029#, FSIP 1029#.

DST #2 3197-3236, 30"-45"-90"-90", Rec. 280' MW, IFP 63#-84#, FFP 127#-158#, ISIP 1238#, FSIP 1228#.

DST #3 3743-3809, 30"-45"-90"-90", Rec. 180' GIP, 70' OSM, IFP 21#-31#, FFP 52#-52#, ISIP 914#, FSIP 1318#.

DST#4 4174'-4187', 30"-45"-90"-90", Rec. 40' O&GCM (10% O, 10% G), 120' mdy wtr, IFP 52#-63#, FFP 95#-95# ISIP 945#, FSIP 1029#.

Name	Top	Bottom
Heebner	3166(-1564)	
Toronto	3180(-1578)	
Lansing	3396(-1794)	
Stark	3797(-2195)	
B/Kansas City	3886(-2284)	
Cherokee	4050(-2448)	
Mississippi	4176(-2574)	

CASING RECORD <input checked="" type="checkbox"/> New <input type="checkbox"/> Used							
Report all strings set-conductor, surface, intermediate, production, etc.							
Purpose of String	Size Hole Drilled	Size Casing Set (in O.D.)	Weight Lbs/Ft.	Setting Depth	Type of Cement	#Sacks Used	Type and Percent Additives
Surface	12 1/4"	8 5/8"	20#	244' KB	60/40poz	160	2% gel 3% cc
Production	7 7/8"	4 1/2"	10.5#	3533'	Common	150	7# Gil/sx
PERFORATION RECORD				Acid, Fracture, Shot, Cement Squeeze Record			
Shots Per Foot	Specify Footage of Each Interval Perforated			(Amount and Kind of Material Used)		Depth	
2	3184-3194			none			
TUBING RECORD				Liner Run <input type="checkbox"/> Yes <input checked="" type="checkbox"/> No			
Date of First Production		Producing Method					
8-24-88		<input checked="" type="checkbox"/> Flowing <input type="checkbox"/> Pumping <input type="checkbox"/> Gas Lift <input type="checkbox"/> Other (explain).....					
Estimated Production Per 24 Hours		Oil	Gas	Water	Gas-Oil Ratio	Gravity	
-		0- bbls	994 MCF	0- bbls	CFPB		

METHOD OF COMPLETION Production Interval

Disposition of gas: Vented during test Open Hole Perforation 3184-3194
 Sold Other (Specify)
 Used on Lease

Dually Completed
 Commingled

NOTE: Well is SIGW awaiting P.L. connection, expected in 60 to 90 days.

SEARCHED
 SERIALIZED
 INDEXED
 FILED