

STATE CORPORATION COMMISSION OF KANSAS
OIL & GAS CONSERVATION DIVISION
WELL COMPLETION OR RECOMPLETION FORM
ACO-1 WELL HISTORY
DESCRIPTION OF WELL AND LEASE

API NO. 15-095,21,596-2000
County.....Kingman
Approx. S/2. S/2. NE.... Sec. 24.. Twp. 29.. Rge. 8.... X East X West

Operator: License # 6581
NameBison Energy Corp.
AddressP.O. Box 782317
City/State/ZipWichita, KS. 67278

2904..... Ft North from Southeast Corner of Section
1437..... Ft West from Southeast Corner of Section
(Note: Locate well in section plat below)

Purchaser.....NONE

Lease Name.....C.J. Williams.....Well #. 1A-24.
Field Name.....

Operator Contact PersonC.J. Lett III
Phone(316) 689-8393

Producing Formation.....
Elevation: Ground.....1563.....KB.....1570

Contractor: License # 5929
NameDuke Drilling Co., Inc.

Wellsite Geologist.....Dean Pattisson
Phone.....316-689-8393

Designate Type of Completion
 New Well Re-Entry Workover
 Oil SWD Temp Abd
 Gas Inj Delayed Comp.
 Dry Other (Core, Water Supply etc.)

If OHWO: old well info as follows:
Operator
Well Name
Comp. DateOld Total Depth.....

RECEIVED
STATE CORPORATION COMMISSION
01-12-1989
JAN 12 1989
CONSERVATION DIVISION
Wichita, Kansas

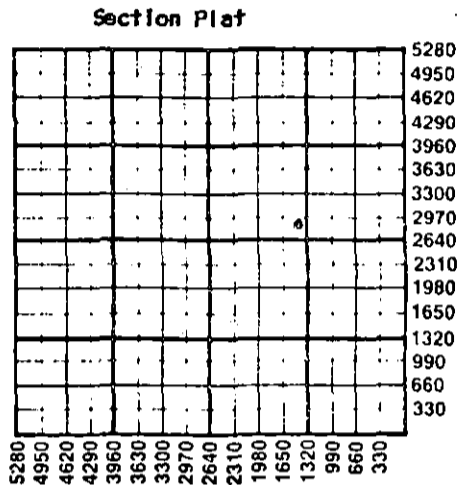

WELL HISTORY

Drilling Method:
 Mud Rotary Air Rotary Cable
..12-07-88.. ..12-14-88.. ..12-15-88..
Spud Date Date Reached TD Completion Date
..4190'.....
Total Depth PBTD
Amount of Surface Pipe Set and Cemented at.....213 feet
Multiple Stage Cementing Collar Used? Yes No
If yes, show depth set.....feet
If alternate 2 completion, cement circulated from.....feet depth to.....w/.....SX cmt
Cement Company Name
Invoice #
A H I D x 6

WATER SUPPLY INFORMATION
Disposition of Produced Water: Disposal Repressuring
Docket #

Questions on this portion of the ACO-1 call:
Water Resources Board (913) 296-3717
Source of Water:
Division of Water Resources Permit #.....
 Groundwater.....Ft North from Southeast Corner (Well)Ft West from Southeast Corner of Sec Twp Rge East West
 Surface Water.....2244 Ft North from Southeast Corner (Stream, pond etc).....777 Ft West from Southeast Corner Sec 24 Twp 29 Rge 8 East XX West
 Other (explain).....
(purchased from city, R.W.D. #)

INSTRUCTIONS: This form shall be completed in triplicate and filed with the Kansas Corporation Commission, 200 Colorado Derby Building, Wichita, Kansas 67202, within 120 days of the spud date of any well. Rule 82-3-130, 82-3-107 and 82-3-106 apply. Information on side two of this form will be held confidential for a period of 12 months if requested in writing and submitted with the form. See rule 82-3-107 for confidentiality in excess of 12 months. One copy of all wireline logs and drillers time log shall be attached with this form. Submit CP-4 form with all plugged wells. Submit CP-111 form with all temporarily abandoned wells.

All requirements of the statutes, rules and regulations promulgated to regulate the oil and gas industry have been fully complied with and the statements herein are complete and correct to the best of my knowledge.

Signature
Title.....President..... Date ..1-10-89

Subscribed and sworn to before me this 10th day of January 1989.
Notary Public.....Marilynn Evenson-Koob
Date Commission Expires.....

Marilynn Evenson-Koob
Notary Public - State of Kansas
My Appt. Expires 7-17-91

K.C.C. OFFICE USE ONLY
F Letter of Confidentiality Attached
C Wireline Log Received
C Drillers Timelog Received
Distribution
 KCC SWD/Rep NGPA
 KGS Plug Other (Specify)
1-12-89
Form ACO-1 (5-86)

Section Twp 29 Rge 8

Operator Name Bison Energy Corp. Lease Name C.J. Willimas Well # 1A-24

Sec. 24 Twp. 29 Rge. 8 East West County Kingman

WELL LOG

INSTRUCTIONS: Show important tops and base of formations penetrated. Detail all cores. Report all drill stem tests giving interval tested, time tool open and closed, flowing and shut-in pressures, whether shut-in pressure reached static level, hydrostatic pressures, bottom hole temperature, fluid recovery, and flow rates if gas to surface during test. Attach extra sheet if more space is needed. Attach copy of log.

Drill Stem Tests Taken Yes No
 Samples Sent to Geological Survey Yes No
 Cores Taken Yes No

Formation Description
 Log Sample

DST #1 3167'-3184', 30-0-0-0
 Recovered 70' of mud and watery mud.
 IHP: 1569#. IFP: 64-51#

DST #2 4141'-4170', 30-30-30-30
 Recovered 120' mud(trace gas); 100' VSGCM,
 150' sgcm, 150' gcm(trace oil in tool).
 Mis-run, no pressures recorded.

DST #3 4060'-4170', 30-60-60-90
 Recovered 125' mud, no show oil or gas.
 IFP: 110-92#; 139-123#. SIP 648#-789#.

Name	Top	Bottom
Heebner Shale	3144'	(-1574)
Toronto Limestone	3158'	(-1538)
Douglas Group	3174'	(-1604)
Lansing Group	3383'	(-1813)
Kansas City Group	3628'	(-2058)
Stark Shale	3779'	(-2209)
Hushpuckney Shale	3818'	(-2248)
BKC Group	3869'	(-2299)
Marmaton Limestone	3922'	(-2352)
Pawnee Limestone	3977'	(-2407)
Labette Shale	4008'	(-2438)
Cherokee Group	4029'	(-2459)
Mississippi Chert	4157'	(-2587)

CASING RECORD <input checked="" type="checkbox"/> New <input type="checkbox"/> Used							
Report all strings set-conductor, surface, intermediate, production, etc.							
Purpose of String	Size Hole Drilled	Size Casing Set (in O.D.)	Weight Lbs/Ft.	Setting Depth	Type of Cement	#Sacks Used	Type and Percent Additives
Surface	12 1/4"	8-5/8"	20#	213'	145	60/40poz	2% gel 3% ec.

PERFORATION RECORD		Acid, Fracture, Shot, Cement Squeeze Record	
Shots Per Foot	Specify Footage of Each Interval Perforated	(Amount and Kind of Material Used)	Depth

TUBING RECORD	Size	Set At	Packer at	Liner Run <input type="checkbox"/> Yes <input type="checkbox"/> No

Date of First Production	Producing Method				
	<input type="checkbox"/> Flowing <input type="checkbox"/> Pumping <input type="checkbox"/> Gas Lift <input type="checkbox"/> Other (explain).....				
Estimated Production Per 24 Hours	Oil	Gas	Water	Gas-Oil Ratio	Gravity
	Bbls	MCF	Bbls	CFPB	

METHOD OF COMPLETION Production Interval

Disposition of gas: Vented Open Hole Perforation
 Sold Other (Specify)
 Used on Lease Dually Completed
 Commingled