

ORIGINAL

5/11/90
RELEASED

SIDE ONE

STATE CORPORATION COMMISSION OF KANSAS
OIL & GAS CONSERVATION DIVISION
WELL COMPLETION OR RECOMPLETION FORM
ACO-1 WELL HISTORY
DESCRIPTION OF WELL AND LEASE

Operator: License # 3711
Name Shepler & Thomas, Inc
Address P.O. Box 1162
City/State/Zip Liberal, KS 67905-1162

Purchaser N/A

Operator Contact Person R. F. Burke
Phone (316) 624-0750

Contractor: License # 3098
Name Exeter Drilling

Wellsite Geologist Don Huber
Phone (316) 624-8222

Designate Type of Completion
 New Well Re-Entry Workover
 Oil SWD Temp Abd
 Gas Inj Delayed Comp.
 Dry Other (Core, Water Supply etc.)

If OWNO: old well Info as follows:
Operator
Well Name
Comp. Date Old Total Depth

WELL HISTORY

Drilling Method:
 Mud Rotary Air Rotary Cable

1-20-89 1-29-89
Spud Date Date Reached TD Completion Date

6000 5639
Total Depth PBDT

Amount of Surface Pipe Set and Cemented at 1620.53 feet
Multiple Stage Cementing Collar Used? Yes No
If yes, show depth set feet
If alternate 2 completion, cement circulated from feet depth to w/ SX cmt.
Cement Company Name
Invoice #

API NO. 15-175-21,076-0000 SEP 24 1990
County Seward FROM CONFIDENTIAL
C... SW... NW... Sec. 29. Twp 32S. Rge. 31... X East West
3300 Ft North from Southeast Corner of Section
4620 Ft West from Southeast Corner of Section
(Note: Locate well in section plat below)

Lease Name Siemens Well # 1-29
Field Name N/A
Producing Formation N/A
Elevation: Ground 2783 KB 2794

Section Plat

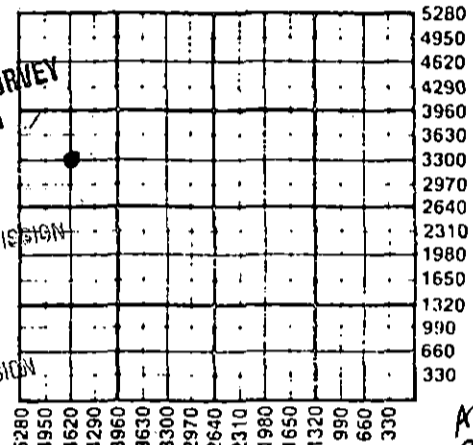

MAY 12 1989
KANSAS GEOLOGICAL SURVEY
WICHITA BRANCH

RECEIVED
STATE CORPORATION COMMISSION
MAY 11 1989
CONSERVATION DIVISION
Wichita, Kansas

ALT I
9-24-90

WATER SUPPLY INFORMATION

Disposition of Produced Water: Disposal
Docket # Repressuring

Questions on this portion of the ACO-1 call:
Water Resources Board (913) 296-3717

Source of Water:
Division of Water Resources Permit #
Groundwater Ft North from Southeast Corner (Well) Ft West from Southeast Corner of Sec Twp Rge East West
Surface Water Ft North from Southeast Corner (Stream, pond etc) Ft West from Southeast Corner Sec Twp Rge East West
 Other (explain) Irrigation Well (purchased from city; R.W.D. #)

INSTRUCTIONS: This form shall be completed in triplicate and filed with the Kansas Corporation Commission, 200 Colorado Derby Building, Wichita, Kansas 67202, within 120 days of the spud date of any well. Rule 82-3-130, 82-3-107 and 82-3-106 apply. Information on side two of this form will be held confidential for a period of 12 months if requested in writing and submitted with the form. See rule 82-3-107 for confidentiality in excess of 12 months. One copy of all wireline logs and drillers time log shall be attached with this form. Submit CP-4 form with all plugged wells. Submit CP-111 form with all temporarily abandoned wells.

All requirements of the statutes, rules and regulations promulgated to regulate the oil and gas industry have been fully complied with and the statements herein are complete and correct to the best of my knowledge.

Signature R. F. BURKE
Title Agent Date 5-10-89

Subscribed and sworn to before me this 10th day of May 1989
Notary Public Jody Phelps
Date Commission Expires January 28, 1991

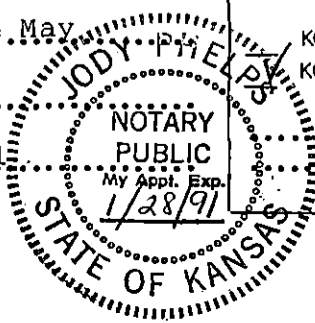

K.C.C. OFFICE USE ONLY
 Letter of Confidentiality Attached
 Wireline Log Received
 Drillers Time Log Received
Distribution
KCC SWD/Rep NGPA
KGS Plug Other (Specify)

Sec 29 Twp 32 Rge 31 W

ORIGINAL

Operator Name Shepler & Thomas, Inc. Lease Name Siemens Well # 1-29

Sec. 29 Twp. 32S Rge. 31 East West County Seward **RELEASED**

WELL LOG

SEP 24 1990

INSTRUCTIONS: Show important tops and base of formations penetrated. Detail all cores. ~~FROM CONFIDENTIAL~~ tests giving interval tested, time tool open and closed, flowing and shut-in pressures, whether shut-in pressure reached static level, hydrostatic pressures, bottom hole temperature, fluid recovery, and flow rates if gas to surface during test. Attach extra sheet if more space is needed. Attach copy of log.

Drill Stem Tests Taken Yes No
Samples Sent to Geological Survey Yes No
Cores Taken Yes No

Formation Description
 Log Sample

DST #1: 5010-5023; 30-60-60-120; IH 2421; IF 53-74; ISIP 1541; FF 96-138; FSIP 1562; FH 2368, BHT 119°, recover 90' gocm, 720' gmcw; Chl 53000; Rw .12 @ 94°

Name	Top	Bottom
Heebner	4246	
Toronto	4271	
Lansing	4361	
Marmaton	5002	
Cherokee	5166	
Morrow	5478	
St. Gen	5754	
St. Louis	5835	

DST #2: 5475-5584; 30-60-60-120; IH 2652; IF 104-114, strong blow; ISIP 1782; FF 104-114; FSIP 1722; FH 2573, BHT 123°, recover 30' gcm, 180' slightly ocm

<p align="center">CASING RECORD <input type="checkbox"/> New <input type="checkbox"/> Used</p> <p align="center">Report all strings set-conductor, surface, intermediate, production, etc.</p>							
Purpose of String	Size Hole Drilled	Size Casing Set (in O.D.)	Weight Lbs/Ft.	Setting Depth	Type of Cement	#Sacks Used	Type and Percent Additives
Surface	12 1/4	8 5/8	24#	1630	HLW	700	2% CC
Production	7 7/8	4 1/2	10.5	5680	50/50 port	250	6% Halad 322 10% salt
<p align="center">PERFORATION RECORD N/A</p>				<p align="center">Acid, Fracture, Shot, Cement Squeeze Record</p>			
Shots Per Foot	Specify Footage of Each Interval Perforated			(Amount and Kind of Material Used)		Depth	
.....	
.....	
.....	
.....	
TUBING RECORD				Liner Run <input type="checkbox"/> Yes <input type="checkbox"/> No			
Size		Set At		Packer at			
N/A							
Date of First Production		Producing Method					
N/A		<input type="checkbox"/> Flowing <input type="checkbox"/> Pumping <input type="checkbox"/> Gas Lift <input type="checkbox"/> Other (explain).....					
Estimated Production Per 24 Hours		Oil	Gas	Water	Gas-Oil Ratio	Gravity	
N/A		Bbls	MCF	Bbls	CFPB		

METHOD OF COMPLETION Production Interval

Disposition of gas: Vented Open Hole Perforation
 Sold Other (Specify) N/A
 Used on Lease Dually Completed
 Comingled

STATE CORPORATION COMMISSION OF KANSAS
OIL & GAS CONSERVATION DIVISION
WELL COMPLETION OR RECOMPLETION FORM
ACO-1 WELL HISTORY
DESCRIPTION OF WELL AND LEASE

Operator: License # 3711
Name Shepler & Thomas, Inc.
Address P.O. Box 1162
City/State/Zip Liberal, KS 67905-1162

Purchaser: N/A

Operator Contact Person R. F. Burke
Phone (316) 624-0750

Contractor: License # 3098
Name Exeter Drilling

Wellsite Geologist Don Huber
Phone (316) 624-8222

Designate Type of Completion

New Well Re-Entry Workover
 Oil SWD Temp Abd
 Gas Inj Delayed Comp.
 Dry Other (Core, Water Supply etc.)

If OWO: old well info as follows:

Operator
Well Name
Comp. Date Old Total Depth

WELL HISTORY

Drilling Method:

Mud Rotary Air Rotary Cable

1-20-89 1-29-89
Spud Date Date Reached TD Completion Date
6000 5639
Total Depth PBD

Amount of Surface Pipe Set and Cemented at 1620.53 feet
Multiple Stage Cementing Collar Used? Yes No
If yes, show depth set feet
If alternate 2 completion, cement circulated from feet depth to w/ SX cmt
Cement Company Name
Invoice # D-I

API NO. 15-175-21,076
County Seward
C... SW... NW Sec. 29 Twp 32S Rge. 31... East West
3300 Ft North from Southeast Corner of Section
4620 Ft West from Southeast Corner of Section
(Note: Locate well in section plat below)

Lease Name Siemens Well # 1-29
Field Name N/A
Producing Formation N/A
Elevation: Ground 2783 KB 2794

Section Plat

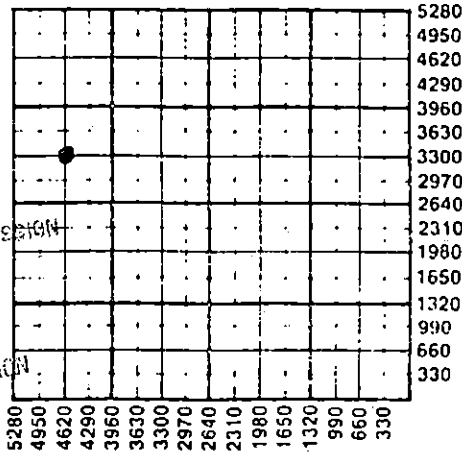

WATER SUPPLY INFORMATION

Disposition of Produced Water: Disposal Repressuring
Docket #

Questions on this portion of the ACO-1 call:
Water Resources Board (913) 296-3717

Source of Water:
Division of Water Resources Permit #
Groundwater Ft North from Southeast Corner (Well) Ft West from Southeast Corner of Sec Twp Rge East West
Surface Water Ft North from Southeast Corner (Stream, pond etc) Ft West from Southeast Corner Sec Twp Rge East West
 Other (explain) Irrigation Well (purchased from city, R.W.D. #)

INSTRUCTIONS: This form shall be completed in triplicate and filed with the Kansas Corporation Commission, 200 Colorado Derby Building, Wichita, Kansas 67202, within 120 days of the spud date of any well. Rule 82-3-130, 82-3-107 and 82-3-106 apply. Information on side two of this form will be held confidential for a period of 12 months if requested in writing and submitted with the form. See rule 82-3-107 for confidentiality in excess of 12 months. One copy of all wireline logs and drillers time log shall be attached with this form. Submit CP-4 form with all plugged wells. Submit CP-111 form with all temporarily abandoned wells.

All requirements of the statutes, rules and regulations promulgated to regulate the oil and gas industry have been fully complied with and the statements herein are complete and correct to the best of my knowledge.

Signature R. F. BURKE
Title Agent Date 5-10-89

Subscribed and sworn to before me this 10th day of May 1989
Notary Public JODY PHELPS
Date Commission Expires January 28, 1991

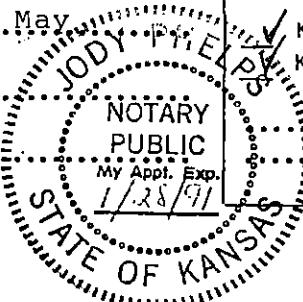

K.C.C. OFFICE USE ONLY
 Letter of Confidentiality Attached
 Wireline Log Received
 Drillers Time Log Received
Distribution
KCC SWD/Rep NGPA
KGS Plug Other (Specify)
5-11-89
Form ACO-1 (5-86)

Sec. 29 Twp. 32S Rge. 31W