

Pd 2-26-90 SIDE ONE

STATE CORPORATION COMMISSION OF KANSAS
OIL & GAS CONSERVATION DIVISION
WELL COMPLETION OR RECOMPLETION FORM
ACO-1 WELL HISTORY
DESCRIPTION OF WELL AND LEASE

API NO. 15-175-20-412A
County Seward
NW NE NE 23 32S 31 West

Operator: License # 5152
Name Lee Banks
Address 200 W. Douglas, Suite 550
Wichita, Kansas 67202

4950 Ft North from Southeast Corner of Section
1175 Ft West from Southeast Corner of Section
(Note: Locate well in section plat below)

Purchaser

Lease Name Fieser Well # 1-23

Operator Contact Person Lee Banks
Phone 316-267-0783

Field Name none

Contractor: License # 5147
Name BEREDCO INC.

Producing Formation none-Marmaton washdown attempt

Wellsite Geologist none
Phone

Elevation: Ground 2783 KB

Designate Type of Completion
New Well Re-Entry X Workover
Oil SWD Temp Abd
Gas Inj Delayed Comp.
X Dry Other (Core, Water Supply etc.)

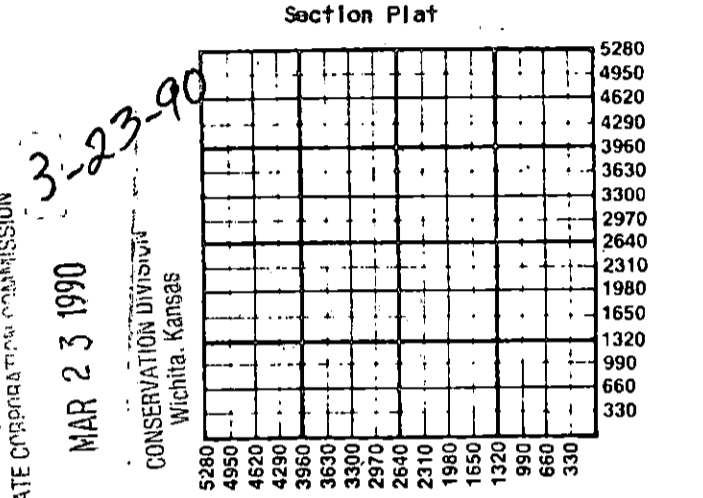

If OKWO: old well info as follows:
Operator Calvin Exploration
Well Name #1-23 Fieser
Comp. Date 11/5/79 Old Total Depth 5665

5661 WATER SUPPLY INFORMATION

WELL HISTORY
Drilling Method: X Mud Rotary Air Rotary Cable
8/26/89 8/26/89 Well plugged 2-26-90
Spud Date Date Reached TD Completion Date
Wash down to 5176
Total Depth PBTD
pipe previously set @1575'
Amount of Surface Pipe Set/and Cemented at...feet
Multiple Stage Cementing Collar Used? Yes No
If yes, show depth set...feet
If alternate 2 completion, cement circulated from...feet depth to...w/.SX cmt
Cement Company Name
Invoice #

Disposition of Produced Water: Disposal
Docket # Repressuring

Questions on this portion of the ACO-1 call:
Water Resources Board (913) 296-3717
Source of Water: old existing irrigation well
Division of Water Resources Permit #
Groundwater...Ft North from Southeast Corner (Well) ...Ft West from Southeast Corner of Sec Twp Rge East West
Surface Water...Ft North from Southeast Corner (Stream, pond etc)...Ft West from Southeast Corner Sec Twp Rge East West
Other (explain) (purchased from city, R.W.D. #)

INSTRUCTIONS: This form shall be completed in duplicate and filed with the Kansas Corporation Commission, 200 Colorado Derby Building, Wichita, Kansas 67202, within 90 days after completion or recompletion of any well. Rule 82-3-130 and 82-3-107 apply. Information on side two of this form will be held confidential for a period of 12 months if requested in writing and submitted with the form. See rule 82-3-107 for confidentiality in excess of 12 months. One copy of all wireline logs and drillers time log shall be attached with this form. Submit CP-4 form with all plugged wells. Submit CP-111 form with all temporarily abandoned wells.

All requirements of the statutes, rules and regulations promulgated to regulate the oil and gas industry have been fully complied with and the statements herein are complete and correct to the best of my knowledge.

Signature [Signature]
Title owner Date 3-22-90

K.C.C. OFFICE USE ONLY
F Letter of Confidentiality Attached
C Wireline Log Received
C Drillers Time Log Received
Distribution
KCC SWD/Rap NGPA
KGS Plug Other (Specify)

Subscribed and sworn to before me this 22nd March 1990
Notary Public [Signature]

Date Commission Expires August 28 1992
DARLENE J. MAY
Notary Public - State of Kansas
My Appt. Expires

SIDE TWO

Operator Name Lee Banks Lease Name..... Fieser Well #..... 1-23

Sec..... 23 Twp..... 32S Rge..... 31 East West County..... Seward

WELL LOG

INSTRUCTIONS: Show important tops and base of formations penetrated. Detail all cores. Report all drill stem tests giving interval tested, time tool open and closed, flowing and shut-in pressures, whether shut-in pressure reached static level, hydrostatic pressures, bottom hole temperature, fluid recovery, and flow rates if gas to surface during test. Attach extra sheet if more space is needed. Attach copy of log.

Drill Stem Tests Taken Yes No
 Samples Sent to Geological Survey Yes No
 Cores Taken Yes No

Formation Description
 Log Sample

Name Top Bottom

Well was re-entered with an attempt to complete in Marmaton formation

CASING RECORD <input type="checkbox"/> New <input type="checkbox"/> Used							
Report all strings set-conductor, surface, intermediate, production, etc.							
Purpose of String	Size Hole Drilled	Size Casing Set (In O.D.)	Weight Lbs/Ft.	Setting Depth	Type of Cement	#Sacks Used	Type and Percent Additives
Production		4-1/2	10-1/2#	5148	Thick Set	125	5% KCL
PERFORATION RECORD				Acid, Fracture, Shot, Cement Squeeze Record			
Shots Per Foot	Specify Footage of Each Interval Perforated			(Amount and Kind of Material Used)		Depth	
4shot/ft	5061 to 5066			600 gal 15% MCF 3000 gal 20% acid			
TUBING RECORD		Size	Set At	Packer at	Liner Run	<input type="checkbox"/> Yes <input checked="" type="checkbox"/> No	
		2-3/8"	5108				
Date of First Production	Producing Method						
none	<input type="checkbox"/> Flowing <input type="checkbox"/> Pumping <input type="checkbox"/> Gas Lift <input type="checkbox"/> Other (explain).....						
Estimated Production Per 24 Hours	Oil	Gas	Water	Gas-Oil Ratio	Gravity		
	Bbls	MCF	Bbls	CFPB			
Well non-commercial was abandoned and plugged							

METHOD OF COMPLETION Production Interval

Disposition of gas: Vented Open Hole Perforation
 Sold Other (Specify)
 Used on Lease Dually Completed
 Commingled