

STATE CORPORATION COMMISSION OF KANSAS
OIL & GAS CONSERVATION DIVISION
WELL COMPLETION OR RECOMPLETION FORM
ACO-1 WELL HISTORY
DESCRIPTION OF WELL AND LEASE

API NO. 15-173-20,815-0000
County Sedgwick
E/2 SW NE 12 29S 1 East
..... Sec..... Twp..... Rge..... X West

Operator: License # 4656
Name DAVIS PETROLEUM, INC.
Address R. R. 1, BOX 183, B
GREAT BEND, KANSAS 67530
City/State/Zip

3300 Ft North from Southeast Corner of Section
1650 Ft West from Southeast Corner of Section
(Note: Locate well in section plat below)

Purchaser

Lease Name HOOFFER Well # 1

Field Name

Operator Contact Person L. D. Davis
Phone (316) 793-3051

Producing Formation

Elevation: Ground 1287 KB 1292

Contractor: License # 6039
Name L. D. Drilling, Inc.

Wellsite Geologist Kim Shoemaker
Phone (316) 682-1537

Designate Type of Completion
X New Well Re-Entry Workover
Oil SWD Temp Abd
Gas Inj Delayed Completion
X Dry Other (Core, Water Supply etc.)

If ONWO: old well info as follows:
Operator
Well Name
Comp. Date Old Total Depth

RECEIVED
STATE CORPORATION COMMISSION
AUG 25 1988
OIL & GAS CONSERVATION DIVISION
Wichita, Kansas

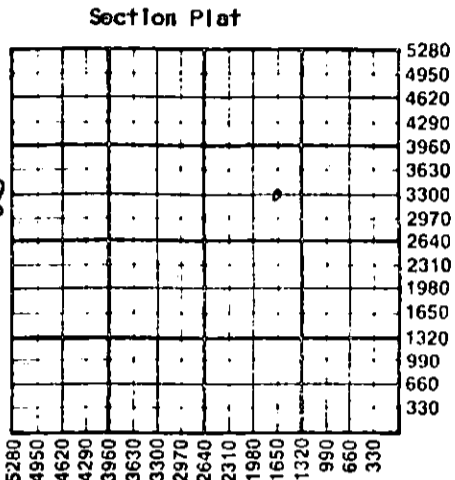

WATER SUPPLY INFORMATION

Disposition of Produced Water: Disposal
Docket # Repressuring

Questions on this portion of the ACO-1 call:
Water Resources Board (913) 296-3717

Source of Water:
Division of Water Resources Permit #

Groundwater Ft North from Southeast Corner
(Well) Ft West from Southeast Corner of
Sec Twp Rge East West

Surface Water Ft North from Southeast Corner
(Stream, pond etc) Ft West from Southeast Corner
Sec Twp Rge East West

Other (explain) City of Haysville water
hailed (purchased from city, R.W.D. #)

WELL HISTORY

Drilling Method:
X Mud Rotary Air Rotary Cable

8-9-88 8-20-88 8-20-88
Spud Date Date Reached TD Completion Date

3790'
Total Depth PBTD

Conductor String set at 76'
Amount of Surface Pipe Set and Cemented at 261 feet
Multiple Stage Cementing Collar Used? Yes No
If yes, show depth set feet
If alternate 2 completion, cement circulated
from feet depth to w/ SX cmt
Cement Company Name
Invoice #

ATI DRA

INSTRUCTIONS: This form shall be completed in triplicate and filed with the Kansas Corporation Commission, 200 Colorado Derby Building, Wichita, Kansas 67202, within 120 days of the spud date of any well. Rule 82-3-130, 82-3-107 and 82-3-106 apply. Information on side two of this form will be held confidential for a period of 12 months if requested in writing and submitted with the form. See rule 82-3-107 for confidentiality in excess of 12 months. One copy of all wireline logs and drillers time log shall be attached with this form. Submit CP-4 form with all plugged wells. Submit CP-111 form with all temporarily abandoned wells.

All requirements of the statutes, rules and regulations promulgated to regulate the oil and gas industry have been fully complied with and the statements herein are complete and correct to the best of my knowledge.

Signature L. D. Davis
Title President Date 8-23-88

Subscribed and sworn to before me this 23rd day of August 1988
Notary Public Bessie M. DeWerff
Date Commission Expires 5-20-88

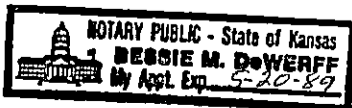

K.C.C. OFFICE USE ONLY
F Letter of Confidentiality Attached
C Wireline Log Received
C Drillers Timelog Received
Distribution
KCC SWD/Rep NGPA
KGS Plug Other (Specify)

8-25-88
Form ACO-1 (5-86)

Sec 12 Twp 29 Rge 1 E

Operator Name DAVIS PETROLEUM, INC. Lease Name..... HOOFFER Well #... 1.....

Sec. 12 Twp. 29S Rge. 1 East West County..... SEDGWICK.....

WELL LOG

INSTRUCTIONS: Show important tops and base of formations penetrated. Detail all cores. Report all drill stem tests giving interval tested, time tool open and closed, flowing and shut-in pressures, whether shut-in pressure reached static level, hydrostatic pressures, bottom hole temperature, fluid recovery, and flow rates if gas to surface during test. Attach extra sheet if more space is needed. Attach copy of log.

Drill Stem Tests Taken Yes No
 Samples Sent to Geological Survey Yes No
 Cores Taken Yes No

Formation Description
 Log Sample

DST # 1 2743-2765 Times: 45-45-45-45
 Blow: 1st Open: 7 1/2" blow
 2nd open: 3" blow
 Recovery: 210' Water IFP: 28-44 FFP:72-89
 ISIP: 1152 FSIP: 1133

DST #2 2842-2858 TIMES: 30-30-30-30
 Blow: 1st open: 3 1/2" blow
 2nd open: 1" blow
 Recovery: 2' free oil 90' water IFP: 26-28 FFP:48-52
 ISIP: 1152 FSIP:1133

DST #3 2866-2904 Times: 45-45-45-45
 Blow: 1st open: 6 1/2" blow 2nd open: 1" blow
 Recovery: 160' GIP, 5' Free Oil, 75' Mdy wtr.
 IF: 44-50 FFP: 58-70 ISIP: 1084 FSIP: 1049

DST #4 3260-3276 Times: 45-45-45-45
 Blow: 1st open: off bb immediately
 2nd open: GTS 10 Min. & GTS through-out
 Recovery: 45' SOGCM 5% oil
 IFP: 24-28 FFP: 28-28 ISIP:1461 FSIP: 1480

Name	Top	Bottom
Brown Lime	2410	(-1118)
K/C	2731	(-1439)
Stark	2844	(-1552)
Base K/C	2931	(-1639)
Marm.	3012	(-1720)
Chke Shale	3141	(-1849)
Miss.	3256	(-1964)
Kinderhook	3623	(-2331)
Simp. Sand	3694	(-2402)
Arbuckle	3758	(-2466)
Log T.D.	3793	(-2501)

DST #5 3274-3294 Times: 45-45-45-45
 Blow: 1st Open: blt to bb in 23 min. GTS 30 Min.
 2nd Open: GTS through-out
 Recovery: 65' gassy mud
 IFP: 62-64 FFP: 64-66
 ISIP: 1461 FSIP: 1480

DST #6 3652-3700 Times: 20-20
 Blow: 1st open: weak blow died 8 min.
 Recovery: 2' DM IFP:34-34 ISIP: 36

CASING RECORD <input checked="" type="checkbox"/> New <input type="checkbox"/> Used							
Report all strings set-conductor, surface, intermediate, production, etc.							
Purpose of String	Size Hole Drilled	Size Casing Set (in O.D.)	Weight Lbs/Ft.	Setting Depth	Type of Cement	#Sacks Used	Type and Percent Additives
Conductor	15 3/4"	13 3/8"	55#	76'	50/50 Poz	35	2% Gel, 3% CC
Surface	12 1/4"	8 5/8"	20#	261'	50/50 Poz	165	2% Gel, 3% CC

PERFORATION RECORD		Acid, Fracture, Shot, Cement Squeeze Record	
Shots Per Foot	Specify Footage of Each Interval Perforated	(Amount and Kind of Material Used)	Depth

TUBING RECORD	Size	Set At	Packer at	Liner Run	<input type="checkbox"/> Yes <input type="checkbox"/> No

Date of First Production	Producing Method				
	<input type="checkbox"/> Flowing <input type="checkbox"/> Pumping <input type="checkbox"/> Gas Lift <input type="checkbox"/> Other (explain).....				
Estimated Production Per 24 Hours	Oil	Gas	Water	Gas-Oil Ratio	Gravity
	Bbls	MCF	Bbls	CFPB	

METHOD OF COMPLETION

Production Interval

Disposition of gas: Vented Open Hole Perforation
 Sold Other (Specify)
 Used on Lease Dually Completed
 Commingled

