

TIGHT HOLE

STATE CORPORATION COMMISSION OF KANSAS
OIL & GAS CONSERVATION DIVISION
WELL COMPLETION OR RECOMPLETION FORM
ACO-1 WELL HISTORY
DESCRIPTION OF WELL AND LEASE

API No. 15-...173-20,620-A
County...Sedgwick
150' E of East
SE. SW. SE. Sec. 12. Twp. 29. Rge. 1... West

Operator: License # 4569
Name Jay Boy Oil, Inc.
Address Fourth Financial Center
100 N. Broadway, Suite 535
City/State/Zip Wichita, KS 67202

330 Ft North from Southeast Corner of Section
1500 Ft West from Southeast Corner of Section
(Note: Locate well in section plat below)

Purchaser Koch Oil
Wichita, KS

Lease Name Seely 'A' Well # 1

Field Name Pool Ext. *Brumley, NW*

Producing Formation Simpson Sand

Operator Contact Person Jay Ablah
Phone (316) 264-3700

Elevation: Ground 1284' KB 1290'

Contractor: License # 5426
Name Hayes Well Service

Wellsite Geologist None
Phone

Designate Type of Completion
 New Well Re-Entry Workover
 Oil SWD Temp Abd
 Gas Inj Delayed Comp.
 Dry Other (Core, Water Supply etc.)

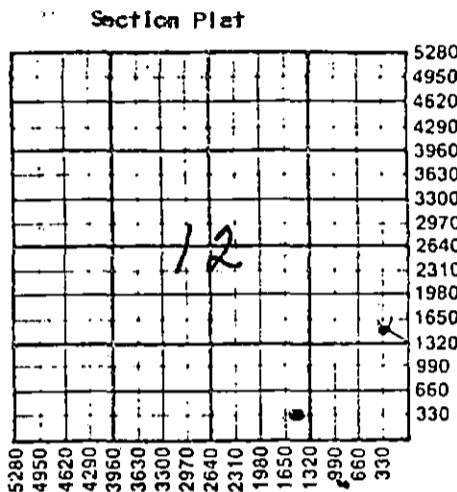

If OWO: old well info as follows:
Operator Donald C. Slawson
Well Name #1 Seely 'A'
Comp. Date 12/10/83 Old Total Depth 3800'

WATER SUPPLY INFORMATION

Disposition of Produced Water: Disposal
Docket # Repressuring

WELL HISTORY

Drilling Method:
 Mud Rotary Air Rotary Cable
3/16/87 3/19/87 4/23/87
Spud Date Date Reached TD Completion Date
3775' 3721'
Total Depth PBD

Questions on this portion of the ACO-1 call:
Water Resources Board (913) 296-3717
Source of Water:
Division of Water Resources Permit #

Amount of Surface Pipe Set and Cemented at...feet
Multiple Stage Cementing Collar Used? Yes No
If yes, show depth set...feet
If alternate 2 completion, cement circulated from...feet depth to...w/...SX cmt
Cement Company Name
Invoice #

Groundwater...Ft North from Southeast Corner (Well) ...Ft West from Southeast Corner of Sec Twp Rge East West
 Surface Water...Ft North from Southeast Corner (Stream, pond etc)...Ft West from Southeast Corner Sec Twp Rge East West
Miller Tank Serv. hauled wtr from creek approx. 2 mi E
 Other (explain) (purchased from city, R.W.D. #)

INSTRUCTIONS: This form shall be completed in triplicate and filed with the Kansas Corporation Commission, 200 Colorado Derby Building, Wichita, Kansas 67202, within 120 days of the spud date of any well. Rule 82-3-130, 82-3-107 and 82-3-106 apply. Information on side two of this form will be held confidential for a period of 12 months if requested in writing and submitted with the form. See rule 82-3-107 for confidentiality in excess of 12 months. One copy of all wireline logs and drillers time log shall be attached with this form. Submit CP-4 form with all plugged wells. Submit CP-111 form with all temporarily abandoned wells.

All requirements of the statutes, rules and regulations promulgated to regulate the oil and gas industry have been fully complied with and the statements herein are complete and correct to the best of my knowledge.

Signature *Jay Ablah*
Jay Ablah
Title President Date 7/10/87

Subscribed and sworn to before me this 10th day of July 1987
Notary Public *Betty B. Herring*
Date Commission Expires 10-07-89

K-C-C. OFFICE USE ONLY
 Letter of Confidentiality Attached
 Wireline Log Received
 Drillers Time Log Received
Distribution
 KCC SWD/Rep NGPA
 KGS Plug Other (Specify)

BETTY B. HERRING
NOTARY PUBLIC
STATE OF KANSAS
My Appt. Exp. 10-07-89

Operator Name Jay Boy Oil, Inc. Lease Name Seely 'A' Well # 1

Sec. 12 Twp. 29 Rge. 1 East West County Sedgwick **TIGHT HOLE!**

WELL LOG

INSTRUCTIONS: Show important tops and base of formations penetrated. Detail all cores. Report all drill stem tests giving interval tested, time tool open and closed, flowing and shut-in pressures, whether shut-in pressure reached static level, hydrostatic pressures, bottom hole temperature, fluid recovery, and flow rates if gas to surface during test. Attach extra sheet if more space is needed. Attach copy of log.

Drill Stem Tests Taken Yes No
 Samples Sent to Geological Survey Yes No
 Cores Taken Yes No

Formation Description
 Log Sample

Name Top Bottom

RTD = 3775'

RELEASED
AUG 16 1988
FROM CONFIDENTIAL

CASING RECORD <input type="checkbox"/> New <input checked="" type="checkbox"/> Used							
Report all strings set-conductor, surface, intermediate, production, etc.							
Purpose of String	Size Hole Drilled	Size Casing Set (In O.D.)	Weight Lbs/Ft.	Setting Depth	Type of Cement	#Sacks Used	Type and Percent Additives
Production		4-1/2"	10.5	3765	50-50 Poz Surefill	50	2% Gel
						115	10% Salt 4% FL-10
						5#	Gilsonite
PERFORATION RECORD				Acid, Fracture, Shot, Cement Squeeze Record			
Shots Per Foot	Specify Footage of Each Interval Perforated			(Amount and Kind of Material Used)		Depth	
4	3702'-06'			500 ga Diesel 10% OSA		3702-06	
TUBING RECORD				Liner Run <input checked="" type="checkbox"/> Yes <input type="checkbox"/> No			
Size		Set At	Packer at				
2-3/8"		3717					
Date of First Production		Producing Method					
4/24/87		<input type="checkbox"/> Flowing <input checked="" type="checkbox"/> Pumping <input type="checkbox"/> Gas Lift <input type="checkbox"/> Other (explain).....					
Estimated Production Per 24 Hours		Oil	Gas	Water	Gas-Oil Ratio	Gravity	
21 Bbls		0 MCF		2 Bbls	CFPB		

METHOD OF COMPLETION

Production Interval

Disposition of gas: Vented Open Hole Perforation
 Sold Other (Specify) 3702-06
 Used on Lease Dually Completed
 Commingled