

15-095-20561-0000

KANSAS DRILLERS LOG

API No. 15 — 095 — 20,561-0000
 County Number

S. 7 T. 30S R. 6 E
 Loc. 1320' FEL & 1320' FSL
 County Kingman County

Operator
 Texas Oil & Gas Corp.

Address
 200 West Douglas, Suite 300, Wichita, Kansas 67202

Well No. 1 Lease Name Messenger

Footage Location
 1320 feet from (N) (S) line 1320 feet from (E) (W) line

Principal Contractor Xplor Drilling Company Geologist High Plains Consulting Ltd.

Spud Date 3-20-77 Total Depth 4126' P.B.T.D. 4106'

Date Completed 4-19-77 Oil Purchaser N/A

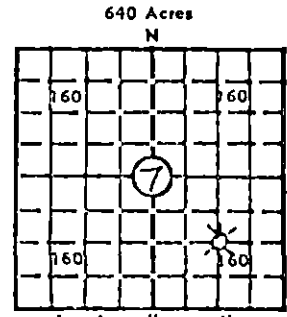

Locate well correctly
 Elev.: Gr. 1401'
 DF 1406' KB 1409'

CASING RECORD

Report of all strings set — surface, intermediate, production, etc.

Purpose of string	Size hole drilled	Size casing set (in O.D.)	Weight lbs/ft.	Setting depth	Type cement	Sacks	Type and percent additives
Surface	12 1/2"	8 5/8"	24#	258'	Common	250	2% Gel, 3% CaCl
Production	7 7/8"	4 1/2"	10.5#	4125'	50/50 Pozmix	175	2% Gel, 18% NaCl

LINER RECORD

PERFORATION RECORD

Top, ft.	Bottom, ft.	Sacks cement	Shots per ft.	Size & type	Depth interval
N/A	N/A	N/A			
TUBING RECORD			4 JSPF	Deep Penet.	4079-82'
Size	Setting depth	Packer set at			
2 3/8"	4041'	N/A			

ACID, FRACTURE, SHOT, CEMENT SQUEEZE RECORD

Amount and kind of material used	Depth interval treated
Acidized w/500 gallons acid	4079-82'
	RECEIVED STATE CORPORATION COMMISSION 4-17-85 APR 17 1985

INITIAL PRODUCTION

CONSERVATION DIVISION
 Wichita, Kansas

Date of first production Shut-in Producing method (flowing, pumping, gas lift, etc.) Flowing

RATE OF PRODUCTION PER 24 HOURS	Oil	Gas	Water	Gas-oil ratio
	N/A	375 bbls.	13 MCF	N/A

Disposition of gas (vented, used on lease or sold) Shut-in Producing interval(s) 4079-82'

INSTRUCTIONS: As provided in KCC Rule 82-2-125, within 90 days after completion of a well, one completed copy of this Drillers Log shall be transmitted to the State Geological Survey of Kansas, 4150 Monroe Street, Wichita, Kansas 67209. Copies of this form are available from the Conservation Division, State Corporation Commission, 3830 So. Meridian (P.O. Box 17027), Wichita, Kansas 66217. Phone AC 316-522-2206. If confidential custody is desired, please note Rule 82-2-125. Drillers Logs will be an open file in the Oil and Gas Division, State Geological Survey of Kansas, Lawrence, Kansas 66044.

13-095-20561-0000

DESIGNATE TYPE OF COMP.: OIL, GAS, DRY HOLE, SWDW, ETC.:

Oil & Gas Corp.

Lease Name
Messenger

Gas Well

7 T 30S R 6 E W

WELL LOG

Show all important zones of porosity and contents thereof; cored intervals, and all drill-stem tests, including depth interval tested, cushion used, time tool open, flowing and shut-in pressures, and recoveries.

SHOW GEOLOGICAL MARKERS, LOGS RUN, OR OTHER DESCRIPTIVE INFORMATION.

FORMATION DESCRIPTION, CONTENTS, ETC.	TOP	BOTTOM	NAME	DEPTH
Herrington	1175	+234		
Winfield	1243	+166		
Towanda	1310	+99		
Fort Riley	1363	+46		
Florence	1403	-44		
Wreford	1515	-106		
Cottonwood	1700	-291		
Foraker	1861	-452		
Onaga	1981	-572		
Wabaunsee	2020	-611		
Root	2146	-737		
Stotler	2175	-766		
Tarkio	2258	-849		
Howard	2452	-1043		
Topeka	2591	-1182		
Heebner	3006	-1597		
Toronto	3024	-1615		
Iatan	3240	-1831		
Lansing	3246	-1837		
Swope	3669	-2260		
Hertha	3706	-2297		
B/KC	3770	-2361		
Altamont	3830	-2421		
Pawnee	3885	-2476		
Cherokee	3930	-2521		
Mississippi	4079	-2670		
TD	4126	-2717		
PBTD	4106	-2697		
DST #1, 1310-43', (Towanda) w/results as follows:				
IFP/30": 40-122#				
ISIP/60": 532#				
FFP/45": 153-194#				
FSIP/90": 542#				
Rec 127' MW & 310' SW.				
DST #2, 4072-86', (Mississippi) w/results as follows:				
IFP/30": 53-85#, GTS 5" @ 260 MCFD				
ISIP/60": 1401#				
FFP/45": 74-85#, gauged 311 MCFD				
FSIP/90": 1390#				
USE ADDITIONAL SHEETS, IF NECESSARY, TO COMPLETE WELL RECORD.				

RECEIVED
STATE CORPORATION COMMISSION

APR 17 1985

CONSERVATION DIVISION
Wichita, Kansas

Date Received
Rec 120' WM.

Harold A. Brown
Signature
District Geologist
Title
June 3, 1977
Date